

# MICRO SWITCH

FREEPORT ILLINOIS, U.S.A  
A DIVISION OF HONEYWELL

FED. MFG. CODE 91929

# MAGNET

CATALOG LISTING

# 103MG5

CATALOG LISTING

# 103MG5

PAGE 1 OF 1

REPLACES

PR-9248

CHECK

CHECK

80

3

SEP

CHECK

80

# M

ISSUE

4

REVISIONS

A	C082965	DLT	5 DEC 96
B	C095439	G J W	4 AUG 99
C	206549	C S L	1 OCT 02

RASTER

FO-52848-A

DRAWN

R J H 28 AUG 80

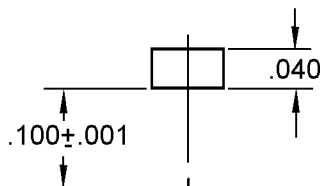
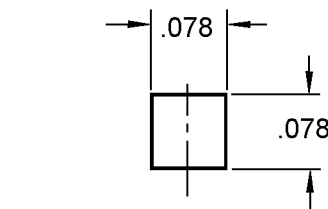

LOCATION OF HALL PROBE

NOTES

- 1 - THE MAGNET IS RARE EARTH MAGNETIZED AND CONDITIONED FOR OPERATION
- 2 - READING IN GAUSS WITH F.W. BELL 620 GAUSS METER AND PROBE STJ4-0402 AT .100±.001 INCHES FROM SOUTH POLE AT TEMPERATURE OF 25±1° C SHALL BE 100 GAUSS MINIMUM
- 3 - POLES NOT MARKED
- 4 - PACKED 125 PIECES EACH TUBE, TUBES TO BE MARKED WITH RED DOT INDICATING NORTH POLE
- 5 - ABSOLUTE MAXIMUM TEMPERATURE RATING 200° C, MAGNETIC PERFORMANCE DEGRADES ABOVE THIS TEMPERATURE

THIS DRAWING COVERS A PROPRIETARY ITEM AND IS THE PROPERTY OF MICRO SWITCH, A DIVISION OF HONEYWELL. THIS DRAWING IS NOT TO BE COPIED OR USED WITHOUT THE APPROVAL OF MICRO SWITCH.

THIRD ANGLE PROJECTION

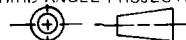

CHARACTERISTICS

ELECTRICAL DATA

SCALE 5:1

CONTACT ARRANGEMENT

DO NOT SCALE PRINT

TOLERANCES

APPLY TO DESIGN UNITS. CONVERSIONS ARE ONLY FOR REFERENCE. UNLESS NOTED, TOLERANCES ARE ±

DIM.	TOL.	DIM.	TOL.
mm	mm/in	in	mm/in
NO PLACES	X	1/.04	
ONE PLACE	X,X	0.4/.015	X,X 0.8/.03
TWO PLACES	X,XX	0.15/.006	X,XX 0.38/.015
THREE PLACES	X,XXX		X,XXX 0.13/.005
ANGLES			

SI METRIC

US CUSTOMARY

DESIGN UNITS

WEIGHT