

ALL RIGHTS RESERVED. NO PORTION OF THIS PUBLICATION, WHETHER IN WHOLE OR IN PART CAN BE REPRODUCED WITHOUT THE EXPRESS WRITTEN CONSENT OF SPC TECHNOLOGY.

REVISIONS			DOC. NO. SPC-F005 * Effective: 12/21/98 * DCP No: 680					
DCP #	REV	DESCRIPTION	DRAWN	DATE	CHECKD	DATE	APPRVD	DATE
	B	Revised & Redrawn					JL	1/5/93
522	C	Revised & Redrawn	JMM	2/3/99	JC	4/5/00	JC	4/5/00

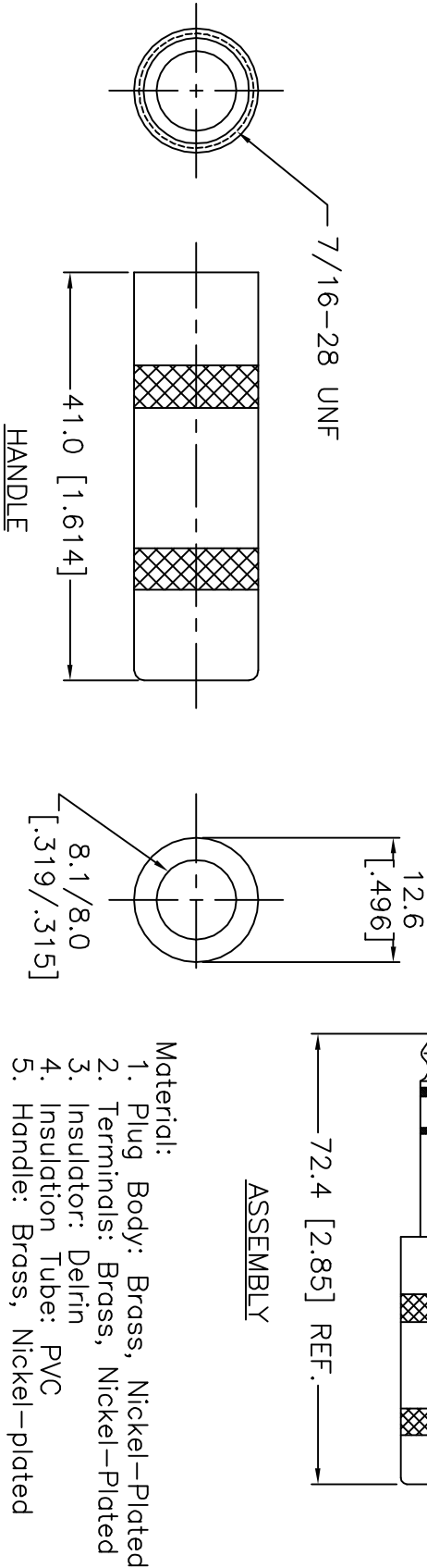

- Material:
1. Plug Body: Brass, Nickel-Plated
  2. Terminals: Brass, Nickel-Plated
  3. Insulator: Delrin
  4. Insulation Tube: PVC
  5. Handle: Brass, Nickel-plated

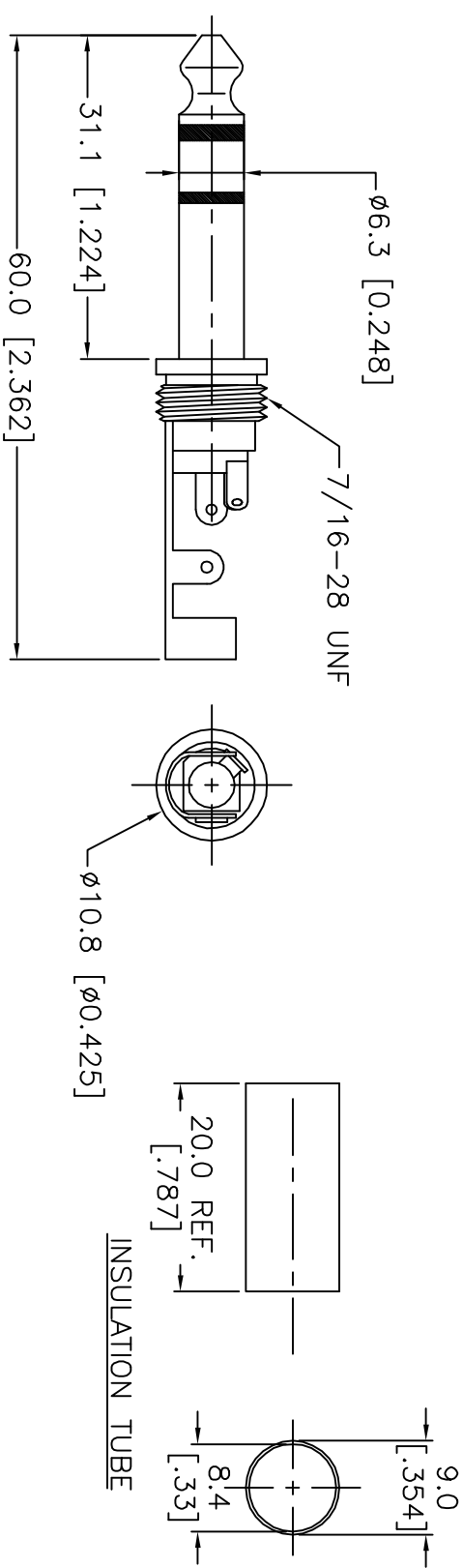

DISCLAIMER  
ALL STATEMENTS AND TECHNICAL INFORMATION CONTAINED HEREIN ARE BASED UPON INFORMATION AND/OR TESTS WE BELIEVE TO BE ACCURATE AND RELIABLE. SINCE CONDITIONS OF USE ARE BEYOND OUR CONTROL, THE USER SHALL DETERMINE THE SUITABILITY OF THE PRODUCT FOR THE INTENDED USE AND ASSUME ALL RISK AND LIABILITY WHATSOEVER IN CONNECTION THEREWITH.

DRAWING TITLE:				DRAWING FILE			
6.3mm Three Conductor Phone Plug				44N934.dwg			
Tolerances Unless Otherwise Specified:				REV			
.X=±0.2 [.008]				C			
.XX=±0.12 [.005]							
DRAWN BY:				DATE:			
JP				1/5/93			
CHECKED BY:				DATE:			
JC				1/7/93			
APPROVED BY:				DATE:			
JL				1/8/93			
SCALE: NTS				SHEET: 1 OF 1			