

© COPYRIGHT 1998 BY SPC TECHNOLOGY.  
 ALL RIGHTS RESERVED. NO PORTION OF  
 THIS PUBLICATION, WHETHER IN WHOLE  
 OR IN PART CAN BE REPRODUCED  
 WITHOUT THE EXPRESS WRITTEN CONSENT  
 OF SPC TECHNOLOGY.

REVISIONS				DOC. NO. SPC-F004, Total Pages: 2 Effective: 7/15/97. DCP No: 229 Supersedes DCP No: 103				
DCP #	REV	DESCRIPTION	DRAWN	DATE	CHECKD	DATE	APPRVD	DATE
139	A	RELEASED	JWM	7/23/97	J.C.	7/23/97	B.B.	8/1/97
512	B	ADD P6KE24C	DJC	4/27/98	JC	4/27/98	JC	4/27/98

Part No.	Reverse Stand-Off Voltage VRWM (V)	Breakdown Voltage VBR (V) Min @ IT	Breakdown Voltage VBR (V) Max @ IT	Test Current IT (mA)	Maximum Clamping Voltage @Ipp Vc (V)	Peak Pulse Current Ipp (A)	Reverse Leakage @VRWM IR (uA)
P6KE100A	85.50	95.00	105.00	1	137.0	4.4	5
P6KE100C	81.00	90.00	110.00	1	144.0	4.2	5
P6KE10A	8.55	9.50	10.50	1	14.5	41.0	10
P6KE10C	8.10	9.00	11.00	1	15.0	40.0	20
P6KE12A	10.20	11.40	12.60	1	16.7	36.0	5
P6KE12C	9.72	10.80	13.20	1	17.3	35.0	5
P6KE12CA	10.20	11.40	12.60	1	16.7	36.0	5
P6KE15A	12.80	14.30	15.80	1	21.2	28.0	5
P6KE15C	12.10	13.50	16.50	1	22.0	27.0	5
P6KE16A	13.60	15.20	16.80	1	22.5	27.0	5
P6KE16C	12.90	14.40	17.60	1	23.5	26.0	5
P6KE18A	15.30	17.10	18.90	1	25.2	24.0	5
P6KE18C	14.50	16.20	19.80	1	26.5	23.0	5
P6KE200A	171.00	190.00	210.00	1	274.0	2.2	5
P6KE200C	162.00	180.00	220.00	1	287.0	2.1	5
P6KE200CA	171.00	190.00	210.00	1	274.0	2.2	5
P6KE20A	17.10	19.00	21.00	1	27.7	22.0	5
P6KE20C	16.20	18.00	22.00	1	29.1	21.0	5
P6KE22A	18.80	20.90	23.10	1	30.6	20.0	5
P6KE22C	17.80	19.80	24.20	1	31.9	19.0	5
P6KE24A	20.50	22.80	25.20	1	33.2	18.0	5
P6KE24C	19.40	21.60	26.40	1	34.7	17.0	5
P6KE24CA	20.50	22.80	25.20	1	33.2	18.0	5
P6KE250A	214.00	237.00	263.00	1	344.0	2.0	5
P6KE250C	202.00	225.00	275.00	1	360.0	2.0	5
P6KE250CA	214.00	237.00	263.00	1	344.0	2.0	5
P6KE27A	23.10	25.70	28.40	1	37.5	16.0	5
P6KE27C	21.80	24.30	29.70	1	39.1	15.0	5
P6KE51A	43.60	48.50	53.60	1	70.1	8.6	5
P6KE51C	41.30	45.90	56.10	1	73.5	8.2	5

C or CA suffix denotes Bi-Directional - Electrical Characteristics apply in both directions.

SPC-F004.DWG

**DISCLAIMER:**  
 ALL STATEMENTS AND TECHNICAL INFORMATION CONTAINED HEREIN ARE BASED UPON INFORMATION AND/OR TESTS WE BELIEVE TO BE ACCURATE AND RELIABLE. SINCE CONDITIONS OF USE ARE BEYOND OUR CONTROL, THE USER SHALL DETERMINE THE SUITABILITY OF THE PRODUCT FOR THE INTENDED USE AND ASSUME ALL RISK AND LIABILITY WHATSOEVER IN CONNECTION THEREWITH.



UNLESS OTHERWISE STATED, DIMENSIONS ARE FOR REFERENCE PURPOSES ONLY.	DRAWN BY:	DATE:	DRAWING TITLE:			
	JEFF MCVICKER	7/23/97	JUNCTION TRANSIENT VOLTAGE SUPPRESSOR			
	CHECKED BY:	DATE:	SIZE	DWG. NO.	ELECTRONIC FILE	REV
	JOHN COLE	7/23/97	A	TA-103	TA-103.DWG	B
APPROVED BY:	DATE:	SCALE: NTS		U.O.M.: INCHES [mm]		SHEET: 1 OF 3
BRETT BRAATZ	8/1/97					

### FEATURES

- \*Plastic package has Underwriters Laboratory Flammability Classification UL 94V-0
- \*Glass passivated chip junction in DO-15 package
- \*600W surge capability at 1 ms
- \*Excellent clamping capability
- \*Low zener impedance
- \*Fast response time: typically less than 1.0 ps from 0 volts to BV min.
- \*Typical I less than 1 uA above 10V
- High temperature soldering guaranteed: 260°C/10 seconds/.375" [9.5mm] lead length/5lbs [2.3kg] tension

### MECHANICAL DATA

Case: JEDEC DO-15 Molded Plastic  
 Terminals: Axial leads, solderable per MIL-STD-202, Method 208.  
 Polarity: Color band denoted cathode except Bipolar  
 Mounting Position: Any  
 Weight: 0.015 ounce, 0.4 gram.

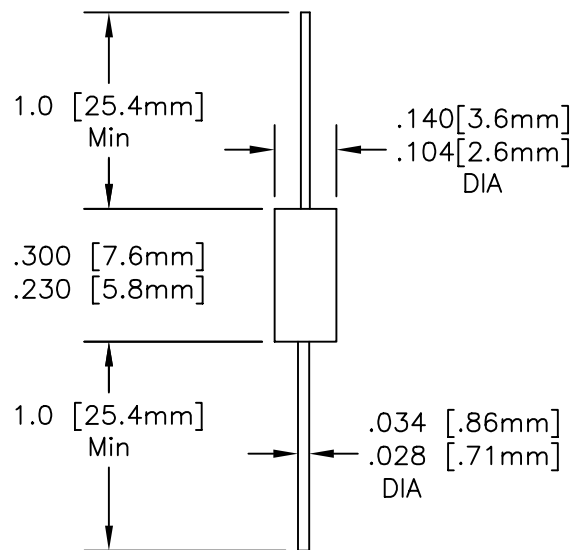

**DO-15**

### MAXIMUM RATINGS AND CHARACTERISTICS

Rating (At 2°C ambient temperature unless otherwise specified)	Symbol	Value	Units
Peak Power Dissipation at $T_A=25^\circ\text{C}$ , $T_P=1\text{ms}$ (NOTE 1)	$P_{PK}$	Minimum 600	Watts
Steady State Power Dissipation at $T_L=75^\circ\text{C}$ Lead Lengths .375", (9.5mm) (NOTE 2)	PD	5	Watts
Peak Forward Surge Current, 8.3ms Single Half Sine Wave Superimposed on Rated Load (JEDEC Method) (NOTE 3)	$I_{FSM}$	100	Amps
Operating and Storage Temperature Range	$T_J$ , $T_{STG}$	-65 to +175	°C

#### NOTES:

1. Non-repetitive current pulse, per Fig. 3 and derated above  $T_A=25^\circ\text{C}$  per Fig. 2
2. Mounted on Copper Leaf Area of 1.57 inches squared (40mm squared)
3. 8.3ms single half sine-wave, duty cycle 4 pulses per minutes maximum
4. Ratings at single phase, half wave, 60Hz, resistive or inductive load. For capacitive load, derate current by 20%.

SIZE <b>A</b>	DWG. NO. <b>TA-103</b>	ELECTRONIC FILE <b>TA-103.DWG</b>	REV <b>B</b>
SCALE: NTS		U.O.M.: INCHES [mm]	SHEET: 2 OF 3

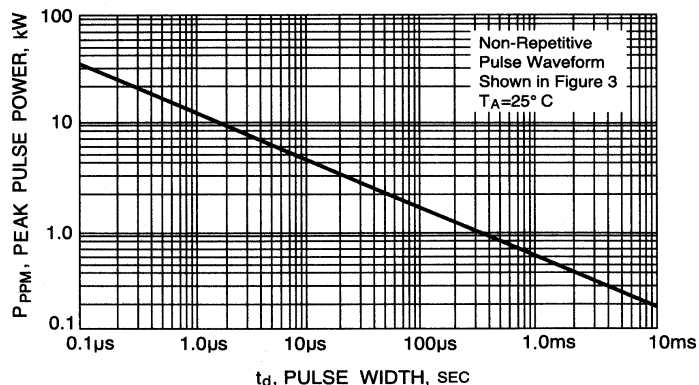

FIG.1-PEAK PULSE POWER RATING CURVE

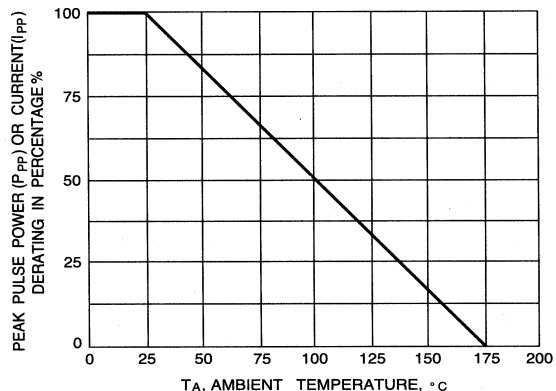

FIGURE 2-PULSE DERATING CURVE

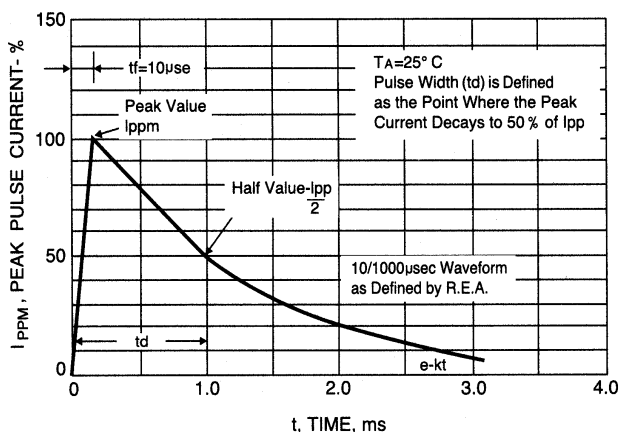

FIGURE 3-PULSE WAVEFORM

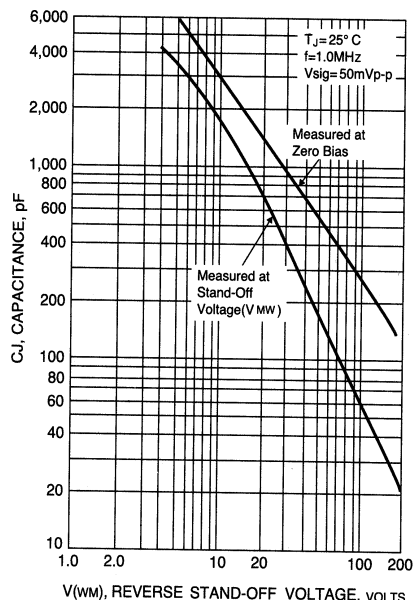

FIG.4-TYPICAL JUNCTION CAPACITANCE UNIDIRECTIONAL

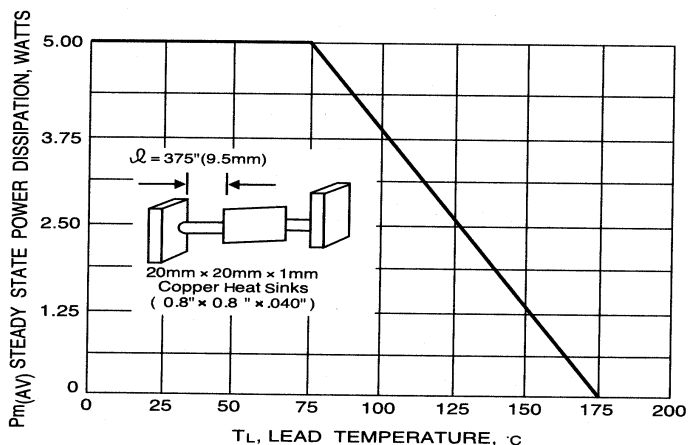

FIG. 5-STEADY STATE POWER DERATING CURVE

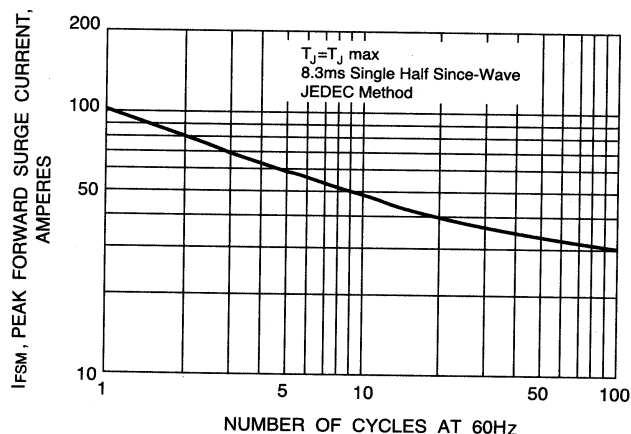

FIG.6-MAXIMUM NON-REPETITIVE PEAK FORWARD SURGE CURRENT UNIDIRECTIONAL

SIZE	DWG. NO.	ELECTRONIC FILE	REV
A	TA-103	TA-103.dwg	B
SCALE: NTS		U.O.M.: INCHES [mm]	SHEET: 3 OF 3