

© COPYRIGHT 1997 BY SPC TECHNOLOGY. ALL RIGHTS RESERVED. NO PORTION OF THIS PUBLICATION, WHETHER IN WHOLE OR IN PART CAN BE REPRODUCED WITHOUT THE EXPRESS WRITTEN CONSENT OF SPC TECHNOLOGY.

REVISONS		DDC. NO. SPC-FD05, Total Pages: 2						
DCP #	REV	DESCRIPTION	DRAWN	DATE	CHECKD	DATE	APPRVD	DATE
18	A	RELEASED	D.J.C.	4/3/97	J.C.	4/8/97	B.B.	4/16/97
428	B	CHANGE ELECTRONIC FILE NAME	DJC	2/12/98	JC	2/17/98	JC	2/17/98

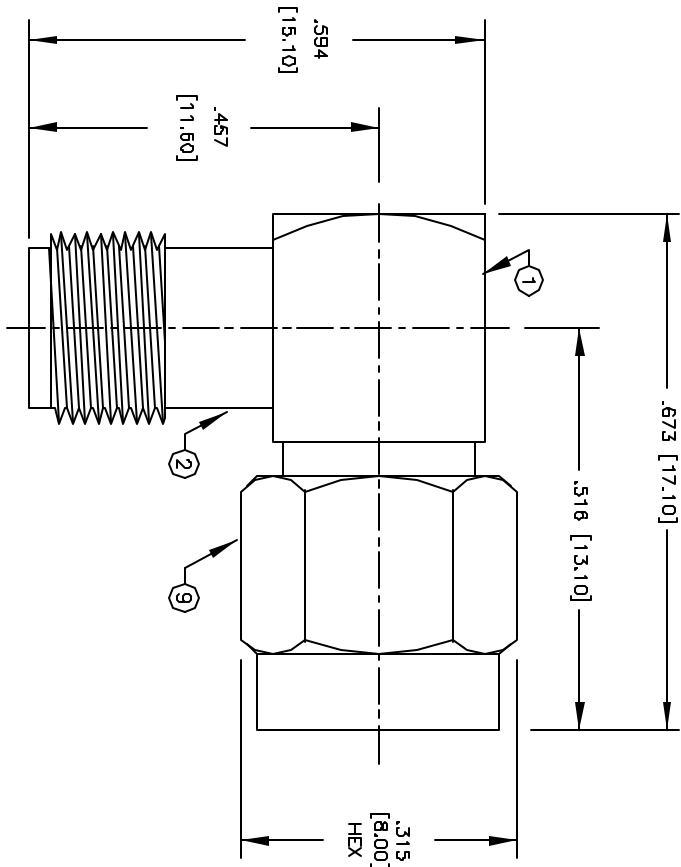

SPECIFICATIONS:

IMPEDANCE: 50 OHMS
 WORKING VOLTAGE: 335 VRMS @ SEA LEVEL
 FREQUENCY RANGE: 0-12.4 GHz

ITEM	DESCRIPTION	QTY	MATERIAL	FINISH
10	END CAP	1	BRASS	GOLD
9	SHELL	1	BRASS	GOLD
8	RETAINING RING	1	BERYLLIUM COPPER	NONE
7	GASKET	1	S.I. RUBBER	BRIGHT ORANGE
6	DIELECTRIC	1	TEFLON	NONE
5	DIELECTRIC	1	TEFLON	NONE
4	CONTACT	1	BERYLLIUM COPPER	GOLD
3	PIN	1	BRASS	GOLD
2	FEMALE BODY	1	BRASS	GOLD
1	MALE BODY	1	BRASS	GOLD

DISCLAIMER
 ALL STATEMENTS AND TECHNICAL INFORMATION CONTAINED HEREIN ARE BASED UPON INFORMATION AND/OR TESTS WE BELIEVE TO BE ACCURATE AND RELIABLE. SINCE CONDITIONS OF USE ARE BEYOND OUR CONTROL, THE USER SHALL DETERMINE THE SUITABILITY OF THE PRODUCT FOR THE INTENDED USE AND ASSUME ALL RISK AND LIABILITY WHATSOEVER IN CONNECTION THEREWITH.

SPC TECHNOLOGY
 2870190, LL 60740-4195

DRAWN BY: DANIEL CAREY
CHECKED BY: JOHN COLE
APPROVED BY: BRETT BRAATZ

DATE: 4/3/97
DATE: 4/8/97
DATE: 4/16/97

DRAWING TITLE: SMA FEMALE TO SMA MALE R/A ADAPTER

SIZE: A
DWG. NO.: 8589-0847
SCALE: NTS

CAD FILE: 16N2729.DWG
REV: B

SHEET: 1 OF 1