

Aluminum Capacitors Axial Standard, High Voltage

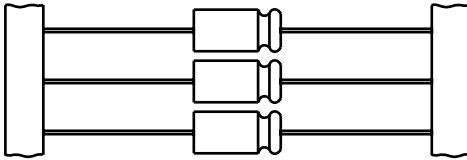
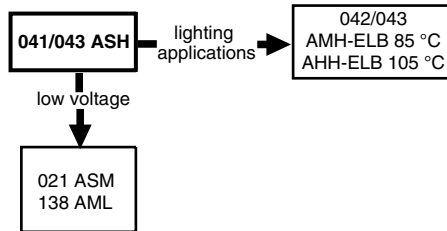

Fig.1 Component outlines

FEATURES

- Polarized aluminum electrolytic capacitors, non-solid electrolyte
- Axial leads, cylindrical aluminum case, insulated with a blue sleeve
- Mounting ring version not available in insulated form
- Taped versions up to case \varnothing 15 x 30 mm available for automatic insertion
- Useful life: 5000 to 15 000 hours at 85 °C
- High rated voltage: up to 450 V
- Lead (Pb)-free versions are RoHS compliant

**RoHS
COMPLIANT**
APPLICATIONS

- General purpose, industrial, power supply, audio-video
- Smoothing, filtering, buffering at high voltages
- Boards with restricted mounting height, vibration and shock resistant

MARKING

The capacitors are marked (where possible) with the following information:

- Rated capacitance (in μF)
- Tolerance on rated capacitance, code letter in accordance with IEC 60062 (T for - 10 to + 50 %)
- Rated voltage (in V)
- Upper category temperature (85 °C)
- Date code, in accordance with IEC 60062
- Code indicating factory of origin
- Name of manufacturer
- Band to indicate the negative terminal
- '+' sign to identify the positive terminal
- Series number (041, 042 or 043)

| QUICK REFERENCE DATA | | |
|---|--|---|
| DESCRIPTION | VALUE | |
| Nominal case sizes (\varnothing D x L in mm) | 6.5 x 18 to 10 x 25 | 10 x 30 to 21 x 38 |
| Rated capacitance range, C_R | 1 to 220 μF | |
| Tolerance on C_R | - 10 to + 50 % | |
| Rated voltage range, U_R | 160 to 450 V | |
| Category temperature range | - 40 to + 85 °C (450 V: - 25 to + 85 °C) | |
| Endurance test at 85 °C | 2000 hours | 8000 hours (450 V: 5000 hours) |
| Useful life at 85 °C | 5000 hours | 15 000 hours (450 V: 10 000 hours) |
| Useful life at 40 °C | 1.4 x I_R applied: 120 000 hours | 1.8 x I_R applied: 240 000 hours (450 V: 160 000 hours) |
| Shelf life at 0 V, 85 °C | 500 hours | 500 hours |
| Based on sectional specification | IEC 60384-4/EN130300 | |
| Climatic category IEC 60068 | 40/085/56 (450 V: 25/085/56) | |

| C_R (μF) | U_R (V) | | | | | |
|----------------------------|-----------|-----------|-----------|-----------|-----------|-----------|
| | 160 | 250 | 350 | 385 | 400 | 450 |
| 1.0 | - | - | - | 6.5 x 18 | - | - |
| 2.2 | - | 6.5 x 18 | - | 8 x 18 | - | - |
| 4.7 | 6.5 x 18 | 8 x 18 | 10 x 18 | 10 x 25 | - | - |
| 6.8 | - | - | 10 x 30 | 10 x 30 | 10 x 30 | 10 x 30 |
| 10 | 8 x 18 | 10 x 25 | 12.5 x 30 | 12.5 x 30 | 12.5 x 30 | 12.5 x 30 |
| | - | 10 x 30 | - | - | - | - |
| 15 | - | 12.5 x 30 | 12.5 x 30 | 15 x 30 | 15 x 30 | 12.5 x 30 |
| 22 | 10 x 25 | 12.5 x 30 | 15 x 30 | 18 x 30 | 18 x 30 | 15 x 30 |
| | 10 x 30 | - | - | - | - | - |
| 33 | 12.5 x 30 | 15 x 30 | 18 x 30 | 18 x 38 | 18 x 38 | 18 x 30 |
| 47 | 15 x 30 | 18 x 30 | 18 x 38 | 18 x 38 | 18 x 38 | 18 x 38 |
| 68 | 15 x 30 | 18 x 38 | 21 x 38 | 21 x 38 | 21 x 38 | 21 x 38 |
| 100 | 18 x 30 | 21 x 38 | - | - | - | - |
| 150 | 18 x 38 | - | - | - | - | - |
| 220 | 21 x 38 | - | - | - | - | - |

DIMENSIONS in millimeters **AND AVAILABLE FORMS**

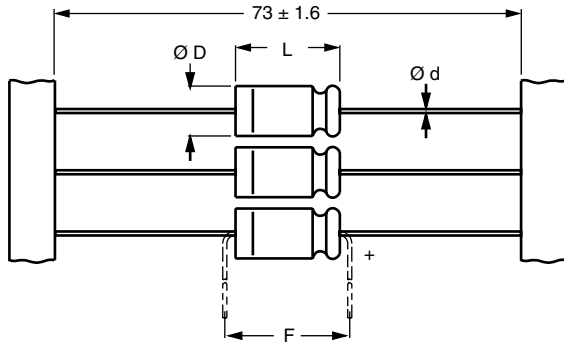

Form BR: Taped on reel
case $\varnothing D \times L = 6.5 \times 18$ to 15×30 mm
Form BA: Taped in box (ammopack)
case $\varnothing D \times L = 6.5 \times 18$ to 10×25 mm

Fig.2 Forms BA and BR

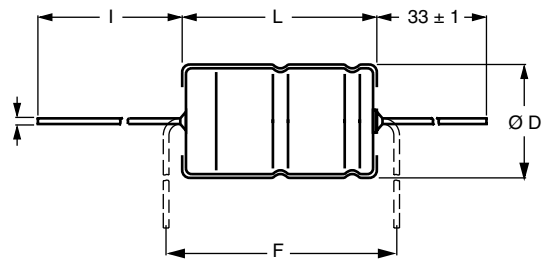

Form AA: Axial in box
case $\varnothing D \times L = 10 \times 30$ to 21×38 mm

Fig.3 Form AA

Table 1

| AXIAL; DIMENSIONS in millimeters, MASS AND PACKAGING QUANTITIES | | | | | | | | | | |
|---|-----------|----------------------------|--------|------------------------|------------|------------|----------|----------------------|---------|---------|
| NOMINAL CASE SIZE $\varnothing D \times L$ | CASE CODE | AXIAL: FORM AA, BA, AND BR | | | | | MASS (g) | PACKAGING QUANTITIES | | |
| | | $\varnothing d$ | l | $\varnothing D_{max.}$ | $L_{max.}$ | $F_{min.}$ | | FORM AA | FORM BA | FORM BR |
| 6.5 x 18 | 4 | 0.8 | - | 6.9 | 18.5 | 25 | ≈ 1.3 | - | 1000 | 1000 |
| 8 x 18 | 5 | 0.8 | - | 8.5 | 18.5 | 25 | ≈ 1.7 | - | 500 | 500 |
| 10 x 18 | 6 | 0.8 | - | 10.5 | 18.5 | 25 | ≈ 2.5 | - | 500 | 500 |
| 10 x 25 | 7 | 0.8 | - | 10.5 | 25.5 | 30 | ≈ 3.3 | - | 500 | 500 |
| 10 x 30 | 00 | 0.8 | 55 ± 1 | 10.5 | 30.5 | 35 | ≈ 4.8 | 340 | - | 500 |
| 12.5 x 30 | 01 | 0.8 | 55 ± 1 | 13.0 | 30.5 | 35 | ≈ 7.4 | 260 | - | 400 |
| 15 x 30 | 02 | 0.8 | 55 ± 1 | 15.5 | 30.5 | 35 | ≈ 11.7 | 200 | - | 250 |
| 18 x 30 | 03 | 0.8 | 55 ± 1 | 18.5 | 30.5 | 35 | ≈ 12.9 | 120 | - | - |
| 18 x 38 | 04 | 0.8 | 34 ± 1 | 18.5 | 39.5 | 44 | ≈ 19.0 | 125 | - | - |
| 21 x 38 | 05 | 0.8 | 34 ± 1 | 21.5 | 39.5 | 44 | ≈ 24.0 | 100 | - | - |

Note

Detailed tape dimensions see section 'PACKAGING'.

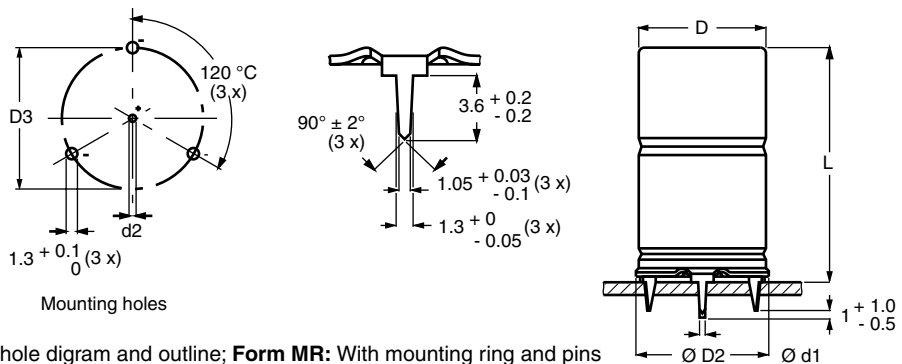

Case $\varnothing D \times L = 15 \times 30$ to 21×38 mm
Case not insulated (insulation on request)
Especially for applications with severe shocks and vibrations

Fig.4 Mounting hole diagram and outline; **Form MR:** With mounting ring and pins

Table 2

| MOUNTING RING; DIMENSIONS in millimeters, MASS AND PACKAGING QUANTITIES | | | | | | | | | |
|---|-----------|------------------------|------------------|------------------------|-------------------------|------------|------------|----------|----------------------|
| Nominal CASE SIZE $\varnothing D \times L$ | CASE code | MOUNTING RING: Form MR | | | | | | MASS (g) | PACKAGING QUANTITIES |
| | | $\varnothing d1$ | $\varnothing d2$ | $\varnothing D_{max.}$ | $\varnothing D2_{max.}$ | D3 | $L_{max.}$ | | |
| 15 x 30 | 02 | 0.8 | 1.0 + 0.4 | 15.5 | 17.5 | 16.5 ± 0.2 | 33 | ≈ 11.7 | 200 |
| 18 x 30 | 03 | 0.8 | 1.0 + 0.4 | 18.5 | 19.5 | 18.5 ± 0.2 | 33 | ≈ 12.9 | 240 |
| 18 x 38 | 04 | 0.8 | 1.0 + 0.4 | 18.5 | 19.5 | 18.5 ± 0.2 | 42 | ≈ 19.0 | 100 |
| 21 x 38 | 05 | 0.8 | 1.0 + 0.4 | 21.5 | 22.5 | 21.5 ± 0.2 | 42 | ≈ 24.0 | 100 |



| ELECTRICAL DATA | |
|-----------------|---|
| SYMBOL | DESCRIPTION |
| C_R | rated capacitance at 100 Hz, tolerance - 10 to + 50 |
| I_R | rated RMS ripple current at 100 Hz, 85 °C |
| I_{L1} | max. leakage current after 1 minute at U_R |
| I_{L5} | max. leakage current after 5 minutes at U_R |
| $\tan \delta$ | max. dissipation factor at 100 Hz |
| ESR | equivalent series resistance at 100 Hz (calculated from $\tan \delta_{max}$ and C_R) |
| Z | max. impedance at 10 kHz |

ORDERING EXAMPLE

Electrolytic capacitor 041 series
 10 μ F/250 V; - 10/+ 50 %
 Nominal case size: \varnothing 10 x 25 mm; Form BA
 Ordering code: MAL204133109E3
 Former 12NC: 2222 041 33109

Note
 Unless otherwise specified, all electrical values in Table 3 apply at
 $T_{amb} = 20$ °C, P = 86 to 106 kPa, RH = 45 to 75 %.

| ELECTRICAL DATA AND ORDERING INFORMATION | | | | | | | | | | | | | |
|--|-------------------------------|--|--------------|----------------------------------|---------------------------------|---------------------------------|-------------------------|-------------------------------|-----------------------------|-------------------------|-----------------------------|----------------------------|-----------------------------|
| U_R (V) | C_R 100 Hz (μ F) | NOMINAL CASE SIZE \varnothing D x L (mm) | CASE CODE | I_R 100 Hz 85 °C (mA) | I_{L1} 1 min (μ A) | I_{L5} 5 min (μ A) | $\tan \delta$ 100 Hz | ESR 100 Hz (Ω) | Z 10 kHz (Ω) | ORDERING CODE MAL2..... | | | |
| | | | | | | | | | | IN BOX FORM AA | TAPED ON REEL FORM BR | TAPED IN BOX FORM BA | MOUNTING RING FORM MR |
| 160 | 4.7 | 6.5 x 18 | 4 | 50 | 38 | 8 | 0.15 | 51 | 26 | - | 04121478E3 | 04131478E3 | - |
| | 10 | 8 x 18 | 5 | 70 | 68 | 14 | 0.15 | 24 | 12 | - | 04121109E3 | 04131109E3 | - |
| | 22 | 10 x 25 | 7 | 150 | 130 | 25 | 0.15 | 11 | 5.5 | - | 04121229E3 | 04131229E3 | - |
| | 22 | 10 x 30 | 00 | 190 | 42 | 25 | 0.10 | 6.8 | 5.5 | 04211229E3 | 04221229E3 | - | - |
| | 33 | 12.5 x 30 | 01 | 270 | 58 | 36 | 0.10 | 4.5 | 3.1 | 04211339E3 | 04221339E3 | - | - |
| | 47 | 15 x 30 | 02 | 350 | 78 | 49 | 0.10 | 3.2 | 2.1 | 04211479E3 | 04221479E3 | - | 04241479E3 |
| | 68 | 15 x 30 | 02 | 420 | 110 | 69 | 0.10 | 2.2 | 1.4 | 04211689E3 | 04221689E3 | - | 04241689E3 |
| | 100 | 18 x 30 | 03 | 580 | 150 | 100 | 0.10 | 1.5 | 1.0 | 04211101E3 | - | - | 04241101E3 |
| | 150 | 18 x 38 | 04 | 760 | 230 | 150 | 0.10 | 1.0 | 0.7 | 04311151E3 | - | - | 04341151E3 |
| 220 | 21 x 38 | 05 | 940 | 330 | 220 | 0.10 | 0.7 | 0.5 | 04311221E3 | - | - | 04341221E3 | |
| 250 | 2.2 | 6.5 x 18 | 4 | 35 | 28 | 6 | 0.10 | 72 | 50 | - | 04123228E3 | 04133228E3 | - |
| | 4.7 | 8 x 18 | 5 | 55 | 55 | 11 | 0.10 | 34 | 23 | - | 04123478E3 | 04133478E3 | - |
| | 10 | 10 x 25 | 7 | 90 | 95 | 19 | 0.10 | 16 | 11 | - | 04123109E3 | 04133109E3 | - |
| | 10 | 10 x 30 | 00 | 130 | 33 | 19 | 0.10 | 15 | 11 | 04213109E3 | 04223109E3 | - | - |
| | 15 | 12.5 x 30 | 01 | 180 | 44 | 27 | 0.10 | 10 | 7.4 | 04213159E3 | 04223159E3 | - | - |
| | 22 | 12.5 x 30 | 01 | 220 | 60 | 37 | 0.10 | 6.8 | 5.0 | 04213229E3 | 04223229E3 | - | - |
| | 33 | 15 x 30 | 02 | 290 | 84 | 54 | 0.10 | 4.5 | 3.4 | 04213339E3 | 04223339E3 | - | 04243339E3 |
| | 47 | 18 x 30 | 03 | 400 | 120 | 75 | 0.10 | 3.2 | 2.3 | 04213479E3 | - | - | 04243479E3 |
| | 68 | 18 x 38 | 04 | 520 | 160 | 110 | 0.10 | 2.2 | 1.7 | 04313689E3 | - | - | 04343689E3 |
| 100 | 21 x 38 | 05 | 650 | 240 | 150 | 0.10 | 1.5 | 1.1 | 04313101E3 | - | - | 04343101E3 | |
| 350 | 4.7 | 10 x 18 | 6 | 60 | 69 | 14 | 0.10 | 34 | 22 | - | 04125478E3 | 04135478E3 | - |
| | 6.8 | 10 x 30 | 00 | 110 | 32 | 18 | 0.10 | 22 | 14 | 04215688E3 | 04225688E3 | - | - |
| | 10 | 12.5 x 30 | 01 | 150 | 42 | 25 | 0.10 | 15 | 10 | 04215109E3 | 04225109E3 | - | - |
| | 15 | 12.5 x 30 | 01 | 180 | 57 | 36 | 0.10 | 10 | 6.7 | 04215159E3 | 04225159E3 | - | - |
| | 22 | 15 x 30 | 02 | 250 | 79 | 50 | 0.10 | 6.8 | 4.5 | 04215229E3 | 04225229E3 | - | 04245229E3 |
| | 33 | 18 x 30 | 03 | 350 | 110 | 73 | 0.10 | 4.5 | 3.1 | 04215339E3 | - | - | 04245339E3 |
| | 47 | 18 x 38 | 04 | 450 | 160 | 100 | 0.10 | 3.2 | 2.1 | 04315479E3 | - | - | 04345479E3 |
| 68 | 21 x 38 | 05 | 560 | 220 | 150 | 0.10 | 2.2 | 1.4 | 04315689E3 | - | - | 04345689E3 | |
| 385 | 1 | 6.5 x 18 | 4 | 20 | 19 | 4 | 0.10 | 160 | 100 | - | 04128108E3 | 04138108E3 | - |
| | 2.2 | 8 x 18 | 5 | 40 | 42 | 8 | 0.10 | 72 | 45 | - | 04128228E3 | 04138228E3 | - |
| | 4.7 | 10 x 25 | 7 | 70 | 71 | 15 | 0.10 | 34 | 22 | - | 04128478E3 | 04138478E3 | - |
| | 6.8 | 10 x 30 | 00 | 110 | 34 | 20 | 0.10 | 22 | 14 | 04218688E3 | 04228688E3 | - | - |
| | 10 | 12.5 x 30 | 01 | 150 | 45 | 27 | 0.10 | 15 | 10 | 04218109E3 | 04228109E3 | - | - |
| | 15 | 15 x 30 | 02 | 210 | 62 | 39 | 0.10 | 10 | 6.0 | 04218159E3 | 04228159E3 | - | 04248159E3 |
| | 22 | 18 x 30 | 03 | 290 | 86 | 55 | 0.10 | 6.8 | 4.1 | 04218229E3 | - | - | 04248229E3 |
| | 33 | 18 x 38 | 04 | 380 | 120 | 80 | 0.10 | 4.5 | 2.7 | 04318339E3 | - | - | 04348339E3 |
| | 47 | 18 x 38 | 04 | 450 | 170 | 110 | 0.10 | 3.2 | 2.1 | 04318479E3 | - | - | 04348479E3 |
| 68 | 21 x 38 | 05 | 570 | 250 | 160 | 0.10 | 2.2 | 1.4 | 04318689E3 | - | - | 04348689E3 | |

ELECTRICAL DATA AND ORDERING INFORMATION

| U _R (V) | C _R 100 Hz (μF) | NOMINAL CASE SIZE Ø D x L (mm) | CASE CODE | I _R 100 Hz 85 °C (mA) | I _{L1} 1 min (μA) | I _{L5} 5 min (μA) | tan δ 100 Hz | ESR 100 Hz (Ω) | Z 10 kHz (Ω) | ORDERING CODE MAL2..... | | | |
|-----------------------|----------------------------------|--|--------------|---|----------------------------------|----------------------------------|-----------------|----------------------|--------------------|-------------------------|-----------------------------|----------------------------|-----------------------------|
| | | | | | | | | | | IN BOX FORM AA | TAPED ON REEL FORM BR | TAPED IN BOX FORM BA | MOUNTING RING FORM MR |
| 400 | 6.8 | 10 x 30 | 00 | 110 | 220 | 110 | 0.055 | 11.5 | 7.3 | 04216688E3 | 04226688E3 | - | - |
| | 10 | 12.5 x 30 | 01 | 150 | 240 | 110 | 0.055 | 7.5 | 4.6 | 04216109E3 | 04226109E3 | - | - |
| | 15 | 15 x 30 | 02 | 210 | 250 | 110 | 0.055 | 5.0 | 3.1 | 04216159E3 | 04226159E3 | - | 04246159E3 |
| | 22 | 18 x 30 | 03 | 290 | 280 | 120 | 0.055 | 3.5 | 2.1 | 04216229E3 | - | - | 04246229E3 |
| | 33 | 18 x 38 | 04 | 380 | 320 | 130 | 0.055 | 2.3 | 1.4 | 04316339E3 | - | - | 04346339E3 |
| | 47 | 18 x 38 | 04 | 450 | 370 | 140 | 0.055 | 1.7 | 1.1 | 04316479E3 | - | - | 04346479E3 |
| | 68 | 21 x 38 | 05 | 560 | 440 | 150 | 0.055 | 1.2 | 0.7 | 04316689E3 | - | - | 04346689E3 |
| 450 | 6.8 | 10 x 30 | 00 | 110 | 230 | 110 | 0.10 | 22 | 14 | 04217688E3 | 04227688E3 | - | - |
| | 10 | 12.5 x 30 | 01 | 150 | 240 | 110 | 0.10 | 15 | 10 | 04217109E3 | 04227109E3 | - | - |
| | 15 | 12.5 x 30 | 01 | 180 | 260 | 110 | 0.10 | 10 | 6 | 04217159E3 | 04227159E3 | - | - |
| | 22 | 15 x 30 | 02 | 240 | 290 | 120 | 0.10 | 6.8 | 4.1 | 04217229E3 | 04227229E3 | - | 04247229E3 |
| | 33 | 18 x 30 | 03 | 350 | 330 | 130 | 0.10 | 4.5 | 2.7 | 04217339E3 | - | - | 04247339E3 |
| | 47 | 18 x 38 | 04 | 440 | 390 | 140 | 0.10 | 3.2 | 2.1 | 04317479E3 | - | - | 04347479E3 |
| | 68 | 21 x 38 | 05 | 550 | 460 | 160 | 0.10 | 2.2 | 1.4 | 04317689E3 | - | - | 04347689E3 |

ADDITIONAL ELECTRICAL DATA

| PARAMETER | Conditions | Value | |
|------------------------------------|---|--|---------------|
| | | Axial | mounting ring |
| Voltage | | | |
| Surge voltage | U _R = 160 to 250 V | U _s ≤ 1.15 x U _R | |
| | U _R = 350 to 450 V | U _s ≤ 1.1 x U _R | |
| Reverse voltage | | U _{rev} ≤ 1 V | |
| Current | | | |
| Leakage current | After 1 minute: case Ø D x L = 6.5 x 18 to 10 x 25 mm: CV ≤ 1000 μC CV > 1000 μC case Ø D x L = 10 x 30 to 21 x 38 mm: U _R = 160 to 385 V U _R = 400 and 450 V | I _{L1} ≤ 0.05 C _R x U _R or 5 μA, whichever is greater I _{L1} ≤ 0.03 C _R x U _R + 20 μA | |
| | After 5 minutes: U _R = 160 to 385 V: CV ≤ 1000 μC CV > 1000 μC U _R = 400 and 450 V | I _{L1} ≤ 0.009 C _R x U _R + 10 μA I _{L1} ≤ 0.009 C _R x U _R + 200 μA | |
| Inductance | | | |
| Equivalent series inductance (ESL) | case Ø D x L mm: | | |
| | 6.5 x 18 | typ. 15 nH | - |
| | 8 x 18 | typ. 35 nH | - |
| | 10 x 18 | typ. 69 nH | - |
| | 10 x 25 | typ. 38 nH | - |
| | 10 x 30 | typ. 38 nH | - |
| | 12.5 x 30 | typ. 46 nH | - |
| | 15 x 30 | typ. 48 nH | typ. 39 nH |
| | 18 x 30 | typ. 50 nH | typ. 39 nH |
| | 18 x 38 | typ. 54 nH | typ. 39 nH |
| 21 x 38 | typ. 59 nH | typ. 39 nH | |

CAPACITANCE (C)

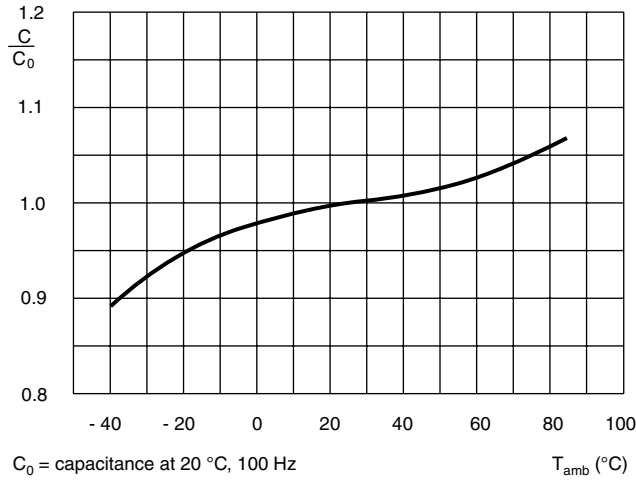

Fig.5 Typical multiplier of capacitance as a function of ambient temperature

EQUIVALENT SERIES RESISTANCE (ESR)

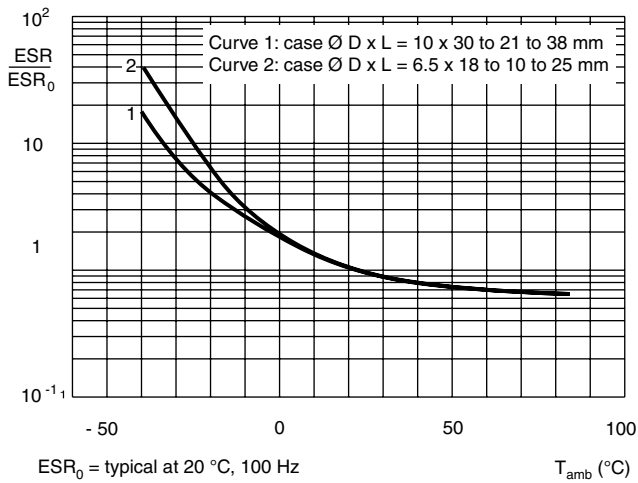

Fig.6 Typical multiplier of ESR as a function of ambient temperature

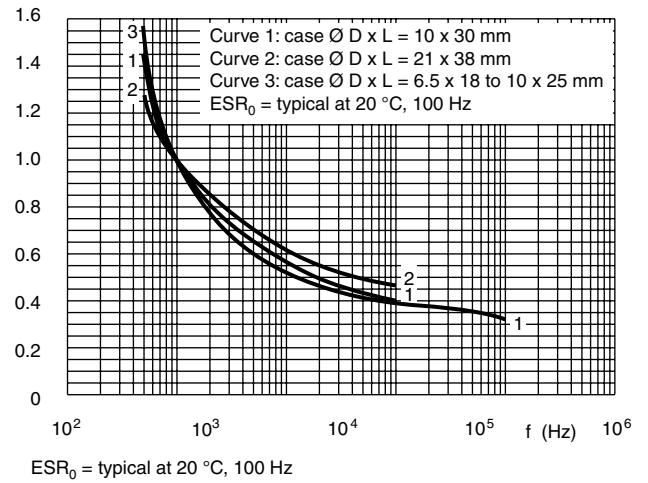

Fig.7 Typical multiplier of ESR as a function of frequency

IMPEDANCE (Z)

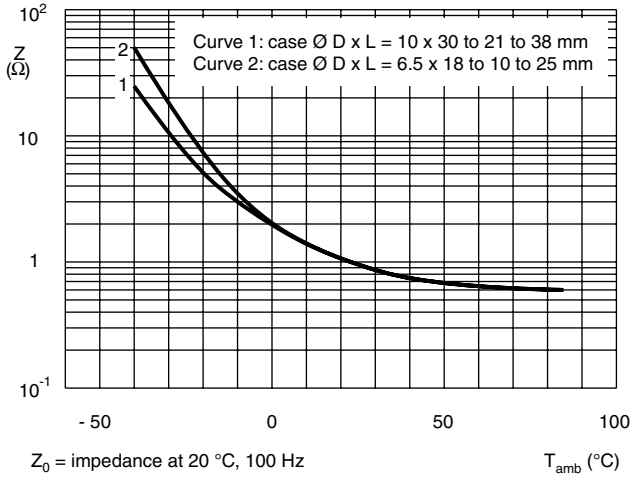

Fig.8 Typical impedance of capacitance as a function of ambient temperature

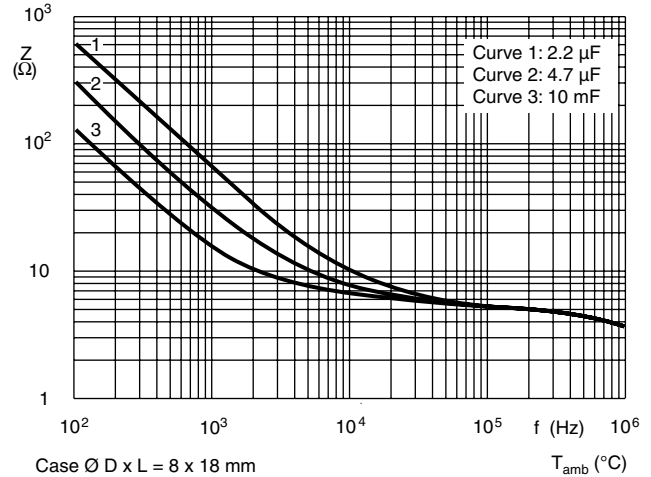

Fig.7 Typical impedance as a function of frequency

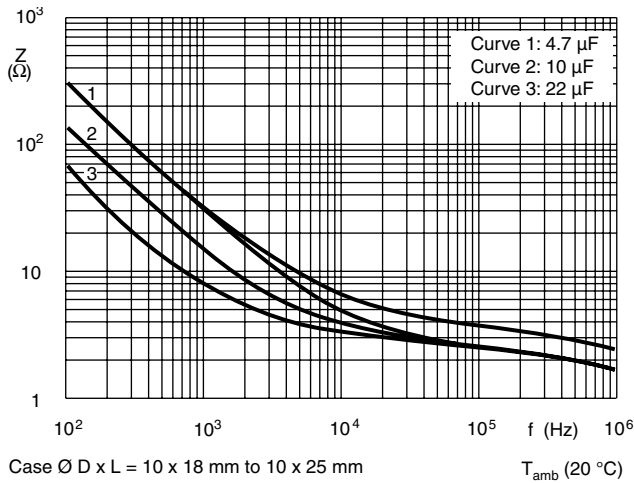

Fig.10 Typical impedance as a function of frequency

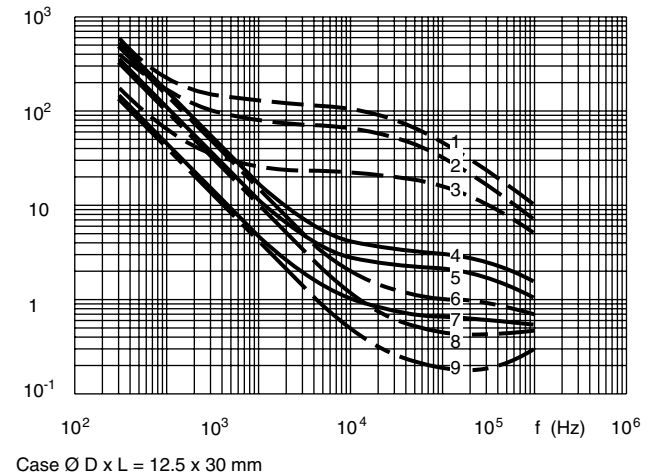

Fig.11 Typical impedance as a function of frequency at different ambient temperatures

- Curve 1: $10 \mu F$, 350 and 385 V; $-40^{\circ}C$
- Curve 2: $15 \mu F$, 250 V; $-40^{\circ}C$
- Curve 3: $33 \mu F$, 160 V; $-40^{\circ}C$
- Curve 4: $10 \mu F$, 350 and 385 V; $20^{\circ}C$
- Curve 5: $15 \mu F$, 250 V; $20^{\circ}C$
- Curve 6: $33 \mu F$, 160 V; $20^{\circ}C$
- Curve 7: $10 \mu F$, 350 and 385 V; $85^{\circ}C$
- Curve 8: $15 \mu F$, 250 V; $85^{\circ}C$
- Curve 9: $33 \mu F$, 160 V; $85^{\circ}C$

RIPPLE CURRENT AND USEFUL LIFE

CCC205

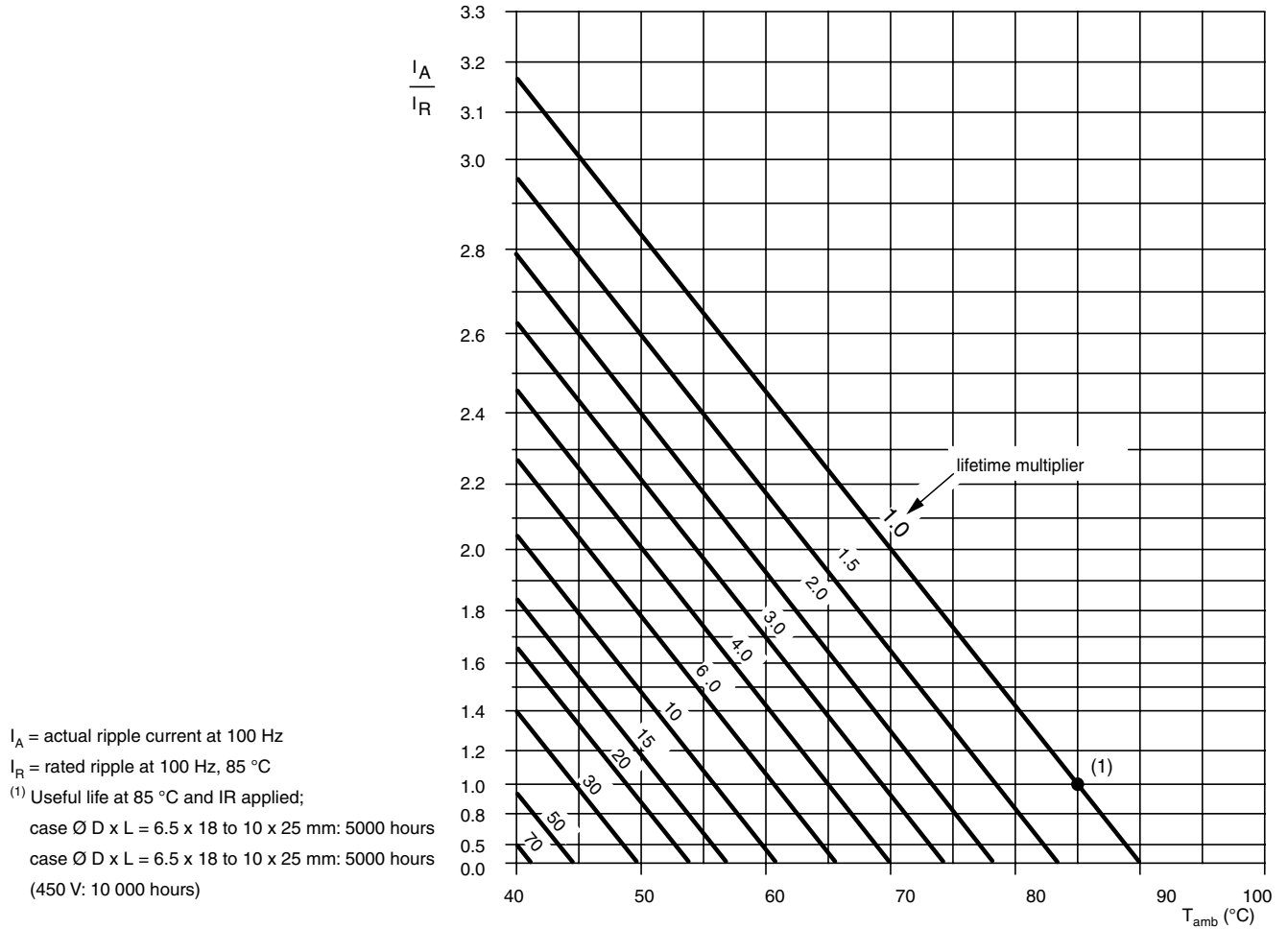

Fig.12 Multiplier of useful life as a function of ambient temperature and ripple current load

Table 3

| MULTIPLIER OF RIPPLE CURRENT (I_R) AS A FUNCTION OF FREQUENCY | |
|---|------------------|
| FREQUENCY (Hz) | I_R MULTIPLIER |
| 50 | 0.75 |
| 100 | 1.00 |
| 300 | 1.15 |
| 1000 | 1.30 |
| 3000 | 1.40 |
| $\geq 10\ 000$ | 1.50 |

Table 4

| TEST PROCEDURES AND REQUIREMENTS | | | |
|--|--|--|--|
| TEST | | PROCEDURE (quick reference) | REQUIREMENTS |
| NAME OF TEST | REFERENCE | | |
| Endurance | IEC 60384-4/ EN130300 subclause 4.13 | $T_{amb} = 85\text{ }^{\circ}\text{C}$; U_R applied; case $\varnothing D \times L$: 6.5 x 18 to 10 x 25 mm: 2000 hours; 10 x 30 to 21 x 38 mm 8000 hours (450 V: 5000 hours) | $U_R = 160\text{ V}$; $\Delta C/C: \pm 15\%$ $U_R = 250\text{ to }450\text{ V}$; $\Delta C/C: \pm 10\%$ $\tan \delta \leq 1.3 \times \text{spec. limit}$ $Z \leq 2 \times \text{spec. limit}$ $I_{L5} \leq \text{spec. limit}$ |
| Useful life | CECC 30301 subclause 1.8.1 | $T_{amb} = 85\text{ }^{\circ}\text{C}$; U_R and I_R applied; case $\varnothing D \times L$: 6.5 x 18 to 10 x 25 mm: 5000 hours; 10 x 30 to 21 x 38 mm: 15 000 hours (450 V: 10 000 hours) | $U_R = 160\text{ V}$; $\Delta C/C: \pm 45\%$ $U_R = 250\text{ to }450\text{ V}$; $\Delta C/C: \pm 30\%$ $\tan \delta \leq 3 \times \text{spec. limit}$ $Z \leq 3 \times \text{spec. limit}$ $I_{L5} \leq \text{spec. limit}$ no short or open circuit total failure percentage: $\leq 3\%$ |
| Shelf life (storage at high temperature) | IEC 60384-4/ EN130300 subclause 4.17 | $T_{amb} = 85\text{ }^{\circ}\text{C}$; no voltage applied; 500 hours after test: U_R to be applied for 30 minutes, 24 to 48 hours before measurement | $\Delta C/C$, $\tan \delta$, Z : for requirements see 'Endurance test' above $I_{L5} \leq 2 \times \text{spec. limit}$ |



Disclaimer

All product specifications and data are subject to change without notice.

Vishay Intertechnology, Inc., its affiliates, agents, and employees, and all persons acting on its or their behalf (collectively, "Vishay"), disclaim any and all liability for any errors, inaccuracies or incompleteness contained herein or in any other disclosure relating to any product.

Vishay disclaims any and all liability arising out of the use or application of any product described herein or of any information provided herein to the maximum extent permitted by law. The product specifications do not expand or otherwise modify Vishay's terms and conditions of purchase, including but not limited to the warranty expressed therein, which apply to these products.

No license, express or implied, by estoppel or otherwise, to any intellectual property rights is granted by this document or by any conduct of Vishay.

The products shown herein are not designed for use in medical, life-saving, or life-sustaining applications unless otherwise expressly indicated. Customers using or selling Vishay products not expressly indicated for use in such applications do so entirely at their own risk and agree to fully indemnify Vishay for any damages arising or resulting from such use or sale. Please contact authorized Vishay personnel to obtain written terms and conditions regarding products designed for such applications.

Product names and markings noted herein may be trademarks of their respective owners.