

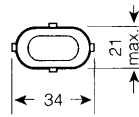

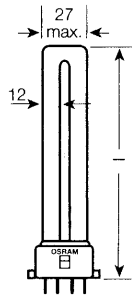

OSRAM DULUX® S/E FOR ELECTRONIC CONTROL GEAR (ECG) AND DIMMING SYSTEMS

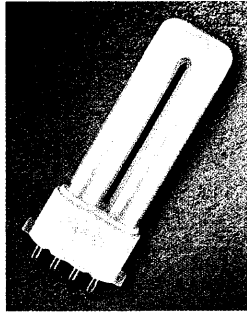
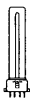

25W	→	5W	
40W	→	7W	
60W	→	9W	
75W	→	11W	

Lamp reference



OSRAM DULUX® S/E

Lamp reference	W		Ra	lm	I max. [mm]	IEC i max. [mm]	IEC	Packaging	Barcode
DULUX S/E 5W/21-840	5	LUMILUX Cool White	1 B	250	85	85	2G7	10	020150
DULUX S/E 5W/41-827	5	LUMILUX INTERNA	1 B	250	85	85	2G7	10	017624
DULUX S/E 7W/21-840	7	LUMILUX Cool White	1 B	400	114	115	2G7	10	020167
DULUX S/E 7W/31-830	7	LUMILUX Warm White	1 B	400	114	115	2G7	10	591988
DULUX S/E 7W/41-827	7	LUMILUX INTERNA	1 B	400	114	115	2G7	10	017648
DULUX S/E 9W/21-840	9	LUMILUX Cool White	1 B	600	144	145	2G7	10	020174
DULUX S/E 9W/31-830	9	LUMILUX Warm White	1 B	600	144	145	2G7	10	589398
DULUX S/E 9W/41-827	9	LUMILUX INTERNA	1 B	600	144	145	2G7	10	017655
DULUX S/E 11W/21-840	11	LUMILUX Cool White	1 B	900	214	215	2G7	10	020181
DULUX S/E 11W/31-830	11	LUMILUX Warm White	1 B	900	214	215	2G7	10	589374
DULUX S/E 11W/41-827	11	LUMILUX INTERNA	1 B	900	214	215	2G7	10	017662

For circuit diagrams see page 3.31.

For QUICKTRONIC® ECGs for high voltages and ACCUTRONIC® ECGs for low voltages see Section 7.

OSRAM DULUX® S/E compact fluorescent lamps have been designed for HF and dimming operation.

Dimming is one of the many applications of OSRAM DULUX® S/E compact fluorescent lamps.



OSRAM DULUX® S/E compact fluorescent lamps can be connected to almost any type of power supply, which makes them extremely versatile.

These innovative energy-saving lamps can be operated on batteries, solar cells and mains supply. They are suitable for high and low voltage (e.g. with ACCUTRONIC®) and can be fully dimmed. Their dimensions and wattages are identical to those of the standard OSRAM DULUX® S models.

The fact that they can be used with separate control gear means they can be connected to almost any type of power supply, including mains, batteries and solar cells. Major applications include dimming operation and battery powered emergency lighting in department stores, office buildings, etc.

- Ten times the life of GLS lamps of the same light output with ECG operation
- Comfortable light in ECG operation
- Slim and compact
- Smallest unit suitable for solar or battery-powered systems (emergency power)
- Low power consumption: 5W, 7W, 9W, 11W
- Luminous flux values from 250 to 900 lm
- Single ended four-pin plug-in 2G7 base.

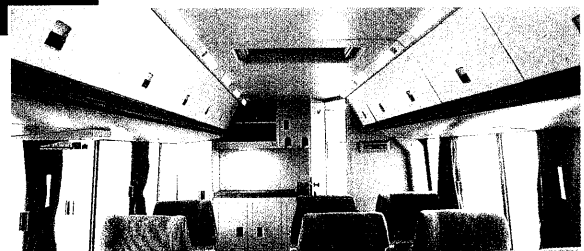

1) See page 3.30

* To ensure that your order reaches you quickly, please order standard pack quantities