

3.2 EPIC® DA - VINCI H - B

Tüllengehäuse / Hood / Capot

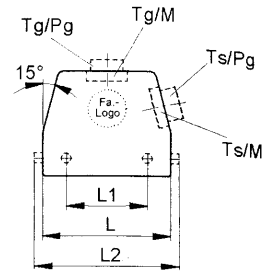
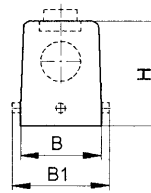
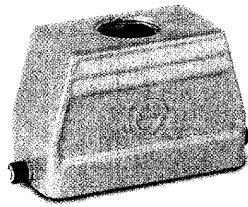
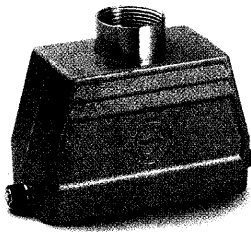

EPIC® H-B Gehäuse: Tüllengehäuse (Kabeleingang gerade, Bolzen für Längsbügel)

EPIC® H-B housings: hood (top entry, bolts for single locking lever)

Boîtiers EPIC® H-B: capot (sortie verticale, ergots pour simple levier)

H-B 24

Artikel part article	Art.Nr. part No. N° art.	Art.Nr.: EP part No.: EP N° art.: EP	PG	M	ZW	L	L1	L2	L3	L4	B	B1	B2	B3	B4	B5	H	H1	H2	S	d
H-B 24 TG-RO 21	10121900*	70149000	21		●	120	137				43						61				
H-B 24 TG-RO 29	10111900*	70149200	29		●																
H-B 24 TG-RO M25	19121900	79149000		25		120	137				43						61				
H-B 24 TG-RO M32	19111900	79149200		32																	

Einsätze / Inserts / Inserts: 1.3: H-BE 48 / 1.5: H-BVE 10 / 1.6: H-D 64 / 1.7: H-DD 108 / 1.8: MC 24
Kabelverschraubung / Cable gland / Presse-étoupe: 4.1 PG / 4.2 Metr.

H-B 48

Artikel part article	Art.Nr. part No. N° art.	Art.Nr.: EP part No.: EP N° art.: EP	PG	M	ZW	L	L1	L2	L3	L4	B	B1	B2	B3	B4	B5	H	H1	H2	S	d
H-B 48 TG 29	10155000*	-	29		●																
H-B 48 TG 36	10156000*	-	36		●	132	152				90						105				
H-B 48 TG 42	10157000*	-	42		●																
H-B 48 TG M32	19155000	-		32																	
H-B 48 TG M40	19156000	-		40		132	152				90						105				
H-B 48 TG M50	19157000	-		50																	

Einsätze / Inserts / Inserts: 1.3: H-BE 48 / 1.5: 2 x H-BVE 10 / 1.6: H-D 128 / 1.7: H-DD 216 / 1.8: 2 x MC 24
Kabelverschraubung / Cable gland / Presse-étoupe: 4.1 PG / 4.2 Metr.

4115211

4.2 EPIC® CERTOSA M

Kabelverschraubungen metrisch / Cable glands metric thread / Presse-étoupes pas métrique

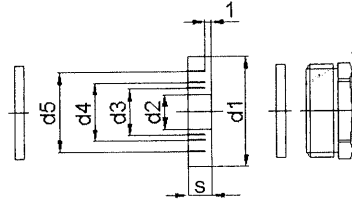
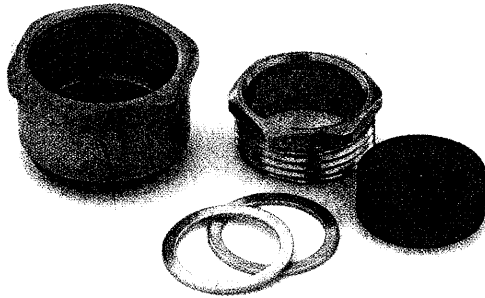

EPIC® CM-M

Artikel part article	Art.Nr. part No. N° art.	M	d1	d2	Kabel Ø cable Ø câble Ø	d3	Kabel Ø cable Ø câble Ø	d4	Kabel Ø cable Ø câble Ø	d5	Kabel Ø cable Ø câble Ø	S	SW mm opening of the spanner ouverture de clef	VPE packing unit condition- nement
CM-M12	71201000	12	10	5	4-6							5	15	5
CM-M16	71201100	16	13,8	3	2-4	6	5-7	9	8-10			5,5	19	5
CM-M20	71201200	20	17,6	4	3-5	7	6-8	10	9-11	13	12-14	6	23	5
CM-M25	71201300	25	22,6	8,5	7,5-9,5	11,5	10-12,5	14,5	13,5-15,5	17,5	16,5-18,5	7,5	28	5
CM-M32	71201400	32	29,6	16	15-17	19	18-20	22	21-23	25	24-26	9,5	36	5
CM-M40	71201500	40	37,6	23	22-24	26	25-27	29	28-30	32	31-33	12	46	5
CM-M50	71201600	50	47,6	30	29-31	33	32-34	36	35-37	39	38-40	14	55	5

Material / material / matière: Metall, Messing vernickelt / metal, brass, nickel plated / métallique, laiton nickelage
 Schutzart / protection class / degré de protection: IP 54 (DIN 46320)
 Temperaturbereich / temperature range / gamme de température: -40° C – +125° C

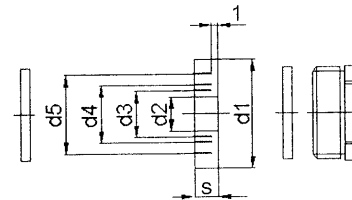

EPIC® SM-M

Artikel part article	Art.Nr. part No. N° art.	M	d1	d2	Kabel Ø cable Ø câble Ø	d3	Kabel Ø cable Ø câble Ø	d4	Kabel Ø cable Ø câble Ø	d5	Kabel Ø cable Ø câble Ø	S	SW mm opening of the spanner ouverture de clef	VPE packing unit condition- nement
SM-M12	71200000	12	10	5	4-6							5	12	5
SM-M16	71200100	16	13,8	3	2-4	6	5-7	9	8-10			5,5	16	5
SM-M20	71200200	20	17,6	4	3-5	7	6-8	10	9-11	13	12-14	6	20	5
SM-M25	71200300	25	22,6	8,5	7,5-9,5	11,5	10,5-12,5	14,5	13,5-15,5	17,5	16,5-18,5	7,5	25	5
SM-M32	71200400	32	29,6	16	15-17	19	18-20	22	21-23	25	24-26	9,5	32	5
SM-M40	71200500	40	37,6	23	22-24	26	25-27	29	23-28	32	31-33	12	40	5
SM-M50	71200600	50	47,6	30	29-31	33	32-34	36	35-37	39	38-40	14	50	5

Material / material / matière: Metall, Messing vernickelt / metal, brass, nickel plated / métallique, laiton nickelage
 Schutzart / protection class / degré de protection: IP 54 (DIN 46320)
 Temperaturbereich / temperature range / gamme de température: -40° C – +125° C

3.2 EPIC® D A - V I N C I H - B

Tüllengehäuse / Hood / Capot

Technische Daten:

Vorschriften: DIN 43652

Temperaturbereich: -40°C - +125°C

Schutzart: IP 65

Werkstoff: H-B 6 – 48: Aluminiumlegierung, pulverbeschichtet

Technical Data

Specifications: DIN 43652

Temperature range: : -40°C - +125°C

Protection class: IP 65

Material: H-B 6 – 48: aluminium alloy, powder coated

Caractéristiques techniques

Règlements: DIN 43652

Gamme de température: : -40°C - +125°C

Degré de protection: IP 65

Matière: H-B 6 – 48: Alliage aluminium, recouvert par pulvérisation

3