

R

INDL

Farnell
COMPONENTS

≡

JGS

150-439

Although this comprehensive catalogue lists most of the standard items which we can supply from existing moulds it does not cover our entire range. Enquiries are therefore welcomed for requirements not listed. The majority of listed items can be supplied ex-stock; some however are only made to order and quantities depend on economical manufacturing requirements which vary dependent on size of mould, type of material and colour.

Rubber items are mainly stocked in Natural Rubber, but can also be specially manufactured in Neoprene, Nitrile, E.P.D.M., Silicone and in different shore hardnesses. (See overleaf)

P.V.C. items are normally stocked in standard grade VX329, but as above can be specially manufactured in grades to suit customers requirements. (See overleaf)

In an effort to assist you in selecting the appropriate materials for your own particular application, we have compiled overleaf a tabulated guide to the properties of the above mentioned materials.

Data Sheet

Material	Normal Shore Hardness	Special Properties and Applications	Maximum Constant Working Temperature °C	Minimum Constant Working Temperature °C
COMMERCIAL NATURAL RUBBER	60°	<i>General Industrial Use</i>	70°	— 50°
NEOPRENE	60°	<i>Oil Resisting Good Ageing Properties</i>	100°	— 30°
NITRILE	60°	<i>Oil, Petrol and Fuel Resisting</i>	120°	— 40°
E.P.D.M.	65°	<i>Weather Resisting Ozone Resisting</i>	100°	— 50°
SILICONE	45°	<i>Ozone Resisting High Temperature Uses</i>	250°	— 60° — 80°
PVC GRADE				
VX 321	43°	<i>An Alternative to Very Soft Rubber</i>	70°	— 35°
VX 329	55°	<i>General Industrial Use</i>	70°	— 35°
VX 342	57°	<i>Non-Migratory Heat Resisting</i>	100° Intermittent	— 30°
SANTOPRENE THERMOPLASTIC RUBBER				
		<i>Characteristics Similar to Neoprene</i>	150°	— 40°

All items are normally stocked in Black. Other colours can be made available to order.

General tolerance 0.25mm ±

REEVITE

INDUSTRIAL MOULDINGS

OPEN GROMMETS

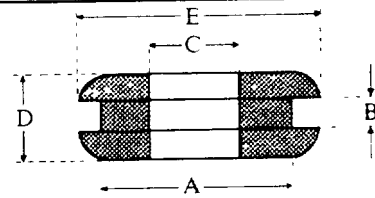

RUBBER PART NO	P.V.C. PART NO	METRIC					IMPERIAL				
		A	B	C	D	E	A	B	C	D	E
RB 60		11.1	2.8	6.4	7.6	14.3	7/16	7/64	1/4	19/64	9/16
	PV 180	11.1	2.8	8.0	9.1	14.3	7/16	7/64	5/16	23/64	9/16
	PV 843	11.1	2.8	9.5	9.1	15.9	7/16	7/64	3/8	23/64	5/8
RB 844		11.1	3.2	6.4	8.0	14.3	7/16	1/8	1/4	5/16	9/16
RB 229		11.1	3.2	6.4	9.5	15.9	7/16	1/8	1/4	3/8	5/8
RB 229A		11.1	3.2	7.6	9.5	15.9	7/16	1/8	19/64	3/8	5/8
	PV 846	11.1	3.2	7.2	8.0	15.9	7/16	1/8	9/32	5/16	5/8
	PV 51	11.1	3.2	8.0	8.0	15.9	7/16	1/8	5/16	5/16	5/8
RB 6835		11.1	3.2	8.0	9.5	15.9	7/16	1/8	5/16	3/8	5/8
RB 68		11.1	3.6	6.4	8.4	14.3	7/16	9/64	1/4	21/64	9/16
	PV 848A	11.1	3.6	8.0	9.9	14.3	7/16	9/64	5/16	23/64	9/16
	PV 849	11.1	3.6	9.5	9.9	15.9	7/16	9/64	3/8	25/64	5/8
RB 82		11.1	4.0	6.4	8.7	14.3	7/16	3/32	1/4	11 1/32	9/16
	PV 850	11.1	4.0	8.0	8.7	15.9	7/16	3/32	3/16	11 1/32	5/8
RB 6836		11.1	4.0	8.0	10.3	15.9	7/16	3/32	3/16	13 1/32	5/8
	PV 851	11.1	4.0	9.5	10.3	15.9	7/16	3/32	3/8	13 1/32	5/8
RB 86		11.1	4.4	6.4	9.1	14.3	7/16	11/64	1/4	23/64	9/16
	PV 852	11.1	4.4	8.0	9.1	15.9	7/16	11/64	3/16	23/64	5/8
	PV 853	11.1	4.4	9.5	10.7	15.9	7/16	11/64	3/8	27/64	5/8
RB 87		11.1	4.8	6.4	9.5	14.3	7/16	3/16	1/4	3/8	9/16
	PV 854	11.1	4.8	8.0	9.5	15.9	7/16	3/16	3/16	3/8	5/8
	PV 855	11.1	4.8	9.5	11.1	15.9	7/16	3/16	3/8	7/16	5/8
RB 6837		11.1	5.2	8.0	11.5	15.9	7/16	13/64	3/16	29/64	5/8
RB 92		11.1	6.4	6.4	11.1	14.3	7/16	1/4	1/4	7/16	9/16
	PV 856	11.1	6.4	7.2	11.1	15.9	7/16	1/4	9/32	7/16	5/8
	PV 52	11.1	6.4	8.0	11.1	15.9	7/16	1/4	3/16	7/16	5/8
RB 6838		11.1	6.4	8.0	12.7	15.9	7/16	1/4	3/16	1/2	5/8
	PV 231	11.9	1.6	6.4	8.0	15.9	15/32	1/16	1/4	5/16	5/8
	PV 232	11.9	2.0	4.8	9.1	15.9	15/32	5/64	3/16	23/64	5/8
	PV 233	11.9	2.0	9.5	6.8	17.5	15/32	5/64	3/8	17/64	11/16
	PV 234	11.9	2.4	8.7	4.8	15.9	15/32	3/32	11 1/32	3/16	5/8
	PV 860	11.9	2.4	9.5	5.6	15.9	15/32	3/32	3/8	7/32	5/8
RB 861		12.3	3.2	8.0	6.4	20.6	31/64	1/8	5/16	1/4	13 1/16
	PV 149A	12.7	0.8	4.8	8.0	15.9	1/2	1/32	3/16	5/16	5/8
	PV 54	12.7	0.8	8.0	5.6	15.9	1/2	1/32	3/16	7/32	5/8
RB 54		12.7	0.8	8.0	7.2	15.9	1/2	1/32	3/16	9/32	5/8
RB 54A	PV 54A	12.7	0.8	9.5	7.2	17.5	1/2	1/32	3/8	9/32	11 1/16
	PV 864	12.7	1.2	4.8	8.4	15.9	1/2	3/64	3/16	21/64	5/8
	PV 55	12.7	1.2	6.4	7.6	15.9	1/2	3/64	1/4	19/64	5/8
RB 56	PV 56	12.7	1.2	8.0	5.6	15.9	1/2	3/64	3/16	7/12	5/8
RB 93	PV 56A	12.7	1.2	9.5	7.6	17.5	1/2	3/64	3/8	19/64	11 1/16
RB 3428		12.7	1.2	9.5	7.6	17.5	1/2	3/64	3/8	19/64	11 1/16
	PV 866	12.7	1.6	4.8	8.7	15.9	1/2	1/16	3/16	11 1/32	5/8
	PV 57	12.7	1.6	6.4	8.0	15.9	1/2	1/16	1/4	3/16	5/8
RB 58	PV 58	12.7	1.6	8.0	6.4	15.9	1/2	1/16	5/16	1/4	5/8
	PV 58A	12.7	1.6	8.0	8.0	19.0	1/2	1/16	5/16	3/16	3/4

REEVITE

INDUSTRIAL MOULDINGS

OPEN GROMMETS

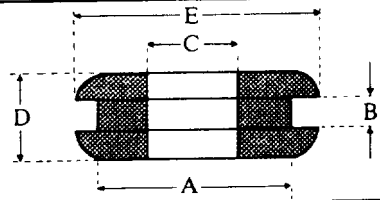

RUBBER PART NO	P.V.C. PART NO	METRIC					IMPERIAL				
		A	B	C	D	E	A	B	C	D	E
*	PV 59B	12.7	1.6	9.5	5.6	17.5	1/2	1/16	3/8	3/32	1 1/16
	PV 53	12.7	1.6	9.5	6.3	15.9					
RB 59	PV 59	12.7	1.6	9.5	7.5	17.5	1/2	1/16	3/8	5/16	19/64
	PV 236	12.7	1.6	11.1	6.4	19.0	1/2	1/16	7/16	1/4	3/4
RB 3430		12.7	1.8	9.5	8.0	17.5	1/2	.070	3/8	5/16	1 1/16
	PV 868	12.7	2.0	4.8	9.1	15.9	1/2	3/64	3/16	23/64	5/8
	PV 869	12.7	2.0	8.0	6.8	15.9	1/2	3/64	3/16	17/64	5/8
	PV 870	12.7	2.0	9.5	7.6	17.5	1/2	3/64	3/8	19/64	1 1/16
RB 94		12.7	2.0	9.5	8.4	17.5	1/2	3/64	3/8	2 1/64	1 1/16
	PV 871	12.7	2.4	4.8	9.5	15.9	1/2	3/32	3/16	3/8	5/8
	PV 872	12.7	2.4	5.6	11.9	17.5	1/2	3/32	3/32	15/32	1 1/16
RB 237	PV 237	12.7	2.4	8.0	8.7	15.9	1/2	3/32	3/16	1 1/32	5/8
RB 153		12.7	2.4	8.7	11.9	19.0	1/2	3/32	1 1/32	15/32	3/4
	PV 873	12.7	2.4	9.5	8.0	17.5	1/2	3/32	3/8	3/16	1 1/16
RB 3431		12.7	2.4	9.5	8.7	17.5	1/2	3/32	3/8	1 1/32	1 1/16
RB 59A	PV 59A	12.7	2.4	9.5	8.7	17.5	1/2	3/32	3/8	1 1/32	1 1/16
	PV 874	12.7	2.8	4.8	9.9	15.9	1/2	3/64	3/16	25/64	5/8
	PV 875	12.7	2.8	8.0	7.6	15.9	1/2	3/64	5/16	19/64	5/8
	PV 876	12.7	2.8	9.5	8.4	17.5	1/2	3/64	3/8	2 1/64	1 1/16
RB 95		12.7	2.8	9.5	9.1	17.5	1/2	3/64	3/8	23/64	1 1/16
	PV 877	12.7	3.2	4.8	10.3	15.9	1/2	1/8	3/16	13/32	5/8
	PV 60	12.7	3.2	8.0	8.0	15.9	1/2	1/8	5/16	5/16	5/8
	PV 60A	12.7	3.2	8.0	9.5	19.0	1/2	1/8	5/16	3/8	3/4
RB 3432		12.7	3.2	9.5	9.5	17.5	1/2	1/8	3/8	3/8	1 1/16
RB 61	PV 61	12.7	3.2	9.5	9.5	17.5	1/2	1/8	3/8	3/8	1 1/16
	PV 878	12.7	3.6	4.8	10.7	15.9	1/2	9/64	3/16	2 1/64	5/8
	PV 879	12.7	3.6	8.0	8.4	15.9	1/2	9/64	5/16	2 1/64	5/8
	PV 880	12.7	3.6	9.5	9.1	17.5	1/2	9/64	3/8	23/64	1 1/16
RB 96		12.7	3.6	9.5	9.9	17.5	1/2	9/64	3/8	25/64	1 1/16
	PV 238	12.7	4.0	4.8	11.1	15.9	1/2	5/32	3/16	7/16	5/8
	PV 881	12.7	4.0	8.0	8.7	15.9	1/2	5/32	5/16	1 1/32	5/8
	PV 882	12.7	4.0	9.5	9.5	17.5	1/2	5/32	3/8	3/8	1 1/16
RB 3433		12.7	4.0	9.5	10.3	17.5	1/2	5/32	3/8	13/32	1 1/16
RB 97		12.7	4.0	9.5	10.3	17.5	1/2	5/32	3/8	13/32	1 1/16
	PV 883	12.7	4.4	4.8	11.5	15.9	1/2	1 1/64	3/16	29/64	5/8
	PV 884	12.7	4.4	8.0	9.1	15.9	1/2	1 1/64	5/16	23/64	5/8
	PV 885	12.7	4.4	9.5	9.9	17.5	1/2	1 1/64	3/8	25/64	1 1/16
RB 98		12.7	4.4	9.5	10.7	17.5	1/2	1 1/64	3/8	27/64	1 1/16
	PV 886	12.7	4.8	4.8	11.9	15.9	1/2	3/16	3/16	15/32	5/8
	PV 887	12.7	4.8	8.0	9.5	15.9	1/2	3/16	3/16	3/8	5/8
RB 62	PV 62	12.7	4.8	9.5	11.1	17.5	1/2	3/16	3/8	7/16	1 1/16
RB 3434		12.7	5.2	9.5	11.5	17.5	1/2	13/64	3/8	29/64	1 1/16
	PV 239	12.7	5.6	8.0	11.9	15.9	1/2	7/32	5/16	15/32	5/8
RB 99		12.7	5.6	9.5	11.9	17.5	1/2	7/32	3/8	15/32	1 1/16
	PV 888	12.7	6.4	8.0	12.7	19.0	1/2	1/4	5/16	1/2	3/4
RB 3435		12.7	6.4	9.5	12.7	17.5	1/2	1/4	3/8	1/2	1 1/16
RB 100		12.7	6.4	9.5	12.7	17.5	1/2	1/4	3/8	1/2	1 1/16
	PV 889	12.7	8.0	8.0	14.3	19.0	1/2	5/16	5/16	9/16	3/4
RB 102		12.7	8.0	9.5	14.3	17.5	1/2	5/16	3/8	9/16	1 1/16
	PV 240A	12.7	9.5	8.0	15.9	19.0	1/2	3/8	5/16	5/8	3/4
RB 240		12.7	9.5	9.5	15.9	17.5	1/2	3/8	3/8	5/8	1 1/16
RB 3438	PV 890	12.7	11.1	9.5	17.5	19.0	1/2	7/16	3/8	1 1/16	3/4
	PV 891	12.7	12.7	8.0	19.0	19.0	1/2	1/2	5/16	3/4	3/4