

Front horizontal rail (A)

To accommodate guide rails and for the attachment of front panels.

- Front projection 2.5 mm in accordance with IEC 60 297-3.
- HP pitch patterns of holes for the precise installation of guide rails
- M4 thread on end face
- Straight-through core hole
- Horizontal rail 192 HP without machining on the end faces. Suitable for cutting to length

Material:

Extruded aluminium section

Surface finish:

Clear-chromated or anodised

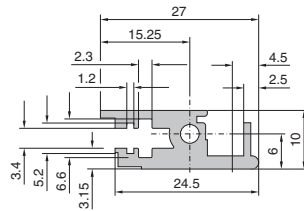

Usable width (HP)	Packs of	Model No. RP
4 (left)	1	3684.592
4 (right)	1	3684.955
8 (left)	1	3684.593
8 (right)	1	3684.956
12	1	3684.594
16	1	3684.595
20	1	3684.596
21	1	3685.985
40	1	3684.960
42	1	3684.560
63	1	3684.561
84	1	3684.562
84	2	3685.267 ¹⁾
192	1	3688.000 ²⁾

¹⁾ Including 4 assembly screws

²⁾ Anodised



Also required:

Assembly screws M4 x 12, packs of 100, Model No. RP 3654.300, see page 576.



Accessories:

Threaded inserts, see page 504.

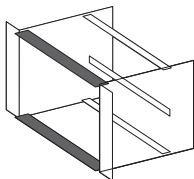

Front horizontal rail, with 10 mm extension (B)

for type IV, IVs and VII injector/extractor handle
To accommodate guide rails and for the attachment of front panels.

- Front projection and pitch pattern of holes based on IEEE 1101.10 and IEC 60 297-5-101, for use of type IV and VII injector/extractor handles
- HP pitch patterns of holes for the precise installation of guide rails
- M4 thread on end face
- Straight-through core hole
- Horizontal rail 192 HP without machining on the end faces. Suitable for cutting to length

Material:

Extruded aluminium section

Surface finish:

Clear-chromated or anodised

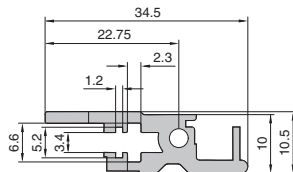

Usable width (HP)	Packs of	Model No. RP
40	1	3684.961
42	1	3684.565
63	1	3684.566
84	1	3684.567
84	2	3685.269 ¹⁾
192	1	3688.001 ²⁾

¹⁾ Including 4 assembly screws

²⁾ Anodised



Also required:

Assembly screws M4 x 12, packs of 100, Model No. RP 3654.300, see page 576.



Accessories:

Threaded inserts, see page 504.