

All bodies, unless otherwise noted, are machined brass, gold-plated 3μ".

All insulators are Teflon.

All center contacts are 30μ" gold plated.

All dimensions in millimeters and [inches].

Plug Crimp Attachment for Flexible Cable and Direct Solder for Semi-Rigid Cable

Straight Crimp Plug - Flexible Cable

P.N.	Cable Group	Plt.	Ins.	Imp.	Crimp Tool
SMB6121A2-NT30G-1-50	01	Nickel	Teflon	50	3 or 4
SMB6121A2-3GT30G-1-50	01	Gold	Teflon	50	3 or 4
SMB6121A2-NT30G-1A-50	01A	Nickel	Teflon	50	3 or 4
SMB6121A2-3GT30G-1A-50	01A	Gold	Teflon	50	3 or 4
SMB6121A1-003-NT30G-5-50	05	Nickel	Teflon	50	1 or 2
SMZ6121A6-002-N/3GT30G-6-75	06	Gold	Teflon	75	1 or 2
SMB6121A1-003-3GT30G-5-5A-50	05A	Gold	Teflon	50	1 or 2
SMZ6121A6-3GT30G-6-75	06	Gold	Teflon	75	1 or 2
SMB6121A1-NT30G-5A-50	05A	Nickel	Teflon	50	2
SMB6121A1-3GT30G-5A-50	05A	Gold	Teflon	50	2
SMB6121A1-NT30G-14-50	14	Nickel	Teflon	50	1 or 2
SMB6121A1-3GT30G-14-50	14	Gold	Teflon	50	1 or 2
SMZ6121A6-3GT30G-16-75	16	Gold	Teflon	75	9
SMZ6121A6-3GT30G-19-75	19	Gold	Teflon	75	3
SMZ6121AA-3GT30G-19-75 Mini 75 Ohm	19	Gold	Teflon	75	3
SMC Connectors					
SMC6121A2-3GT30G-1-50	01	Gold	Teflon	50	3 or 4
SMC6121A1-NT30G-5-50	05	Nickel	Teflon	50	1 or 2
SMC6121A1-3GT30G-5-50	05	Gold	Teflon	50	1 or 2
SMC6121A1-3GT30G-5A-50	05A	Gold	Teflon	50	2

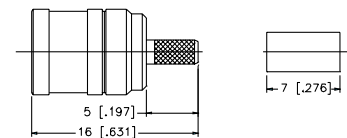
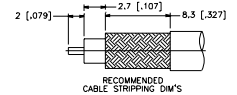
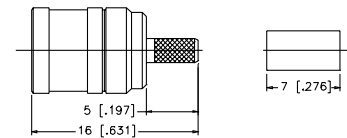
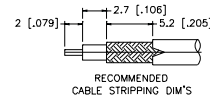

SMB6121A2-NT30G-1-50, SMB6121A2-3GT30G-1-50, SMB6121A6-3GT30G-16-75, SMB6121A6-3GT30G-19-75

Note: Female center contact

Assembly Instruction J - page 218

Straight Solder Plug - Semi-Rigid Cable

P.N.	Cable Group	Plt.	Ins.	Imp.	Crimp Tool
SMB6181A1-NT30G-11-50	11	Nickel	Teflon	50	N/A
SMB6181A1-3GT30G-11-50	11	Gold	Teflon	50	N/A
SMB6181A1-3GT30G-13-50	13	Gold	Teflon	50	N/A

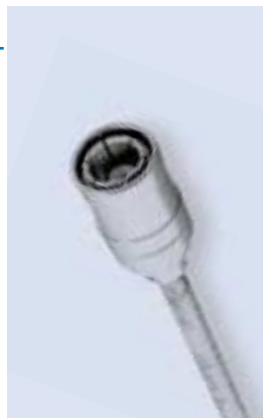

SMB6181A1-NT30G-11-50, SMB6181A1-3GT30G-11-50

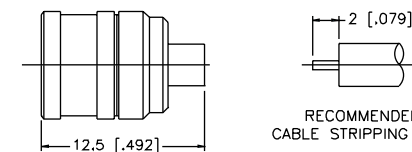

SMB6181A1-3GT30G-13-50

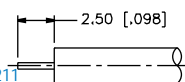

Assembly Instruction C - page 211
Assembly Instruction E - page 213

Note: Female center contact