



16, 32 Amp
Watertight (IP67)
Drawing D



16, 32 Amp
Splashproof (IP44)
Drawing D

Amps	Poles and Wires	Voltage AC	Clock Position of Ground Contact	NEMA 4X Watertight (IP67)	Splashproof (IP44)
16	2P3W	110	4	AT119304	AT110304
		230	9	AT119309	AT110309
		400	6	AT119306	AT110306
	3P4W	110	4	AT119404	AT110404
		230	9	AT119409	AT110409
		400	6	AT119406	AT110406
		500	7	AT119407	AT110407
	4P5W	110	4	AT119504	AT110504
		230	9	AT119509	AT110509
400		6	AT119	AT110	
32	2P3W	110	4	AT139304	AT130304
		230	9	AT139309	AT130309
		400	6	AT139306	AT130306
	3P4W	110	4	AT139404	AT130404
		230	9	AT139409	AT130409
		400	6	AT139406	AT130406
		500	7	AT139407	AT130407
	4P5W	110	4	AT139504	AT130504
		230	9	AT139509	AT130509
400		6	AT139	AT130	
32*	3P4W	380 50Hz 440 60Hz	3	AT139403	

* 32 Amp. Only for Refrigerated Containers.

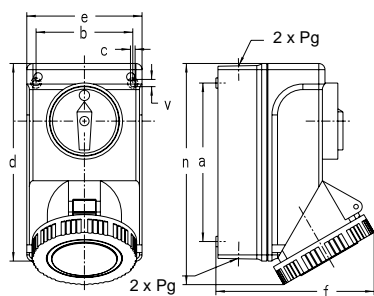

Drawing D

Dimensions

Amps		Poles and Wires	Unit of Measure	Dimensions										
N.A.	Int'l			a	b	c	d	e	f	NEMA 4X IP67	NEMA 4X IP44	NEMA 4X IP67	NEMA 4X IP67	
20	16	2P3W	inch	5.00	3.07	0.18	6.54	3.82	4.57	4.72	7.28	7.28	0.28	
			mm	127	78	4.5	166	97	116	120	185	185	7	
20	16	3P4W	inch	5.00	3.07	0.18	6.54	3.82	4.72	4.92	7.28	7.28	0.28	
			mm	127	78	4.5	166	97	120	125	185	185	7	
20	16	4P5W	inch	5.00	3.07	0.18	6.54	3.82	4.92	5.20	7.28	7.28	0.28	
			mm	127	78	4.5	166	97	125	132	185	185	7	
30	32	2P3W	inch	6.06	3.70	0.18	7.60	4.45	5.71	6.06	8.46	8.46	0.28	
			mm	154	94	4.5	193	113	145	154	215	215	7	
30	32	3P4W	inch	6.06	3.70	0.18	7.60	4.45	5.71	6.06	8.46	8.46	0.28	
			mm	154	94	4.5	193	113	145	154	215	215	7	
30	32	4P5W	inch	6.06	3.70	0.18	7.60	4.45	5.83	6.06	8.46	8.46	0.28	
			mm	154	94	4.5	193	113	148	154	215	215	7	