

DESIGN VARIATION 'U' NUTS

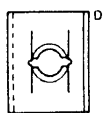

Impression turned 90°

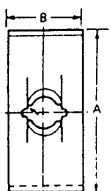
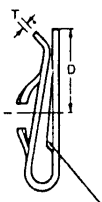

2 corners cropped

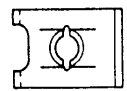

Relief notch



No retaining feature on lower leg

Standard 'U' nut design Prefix SNU
Extrusion or sheared tab

7224758
To
7224801



No lead angle on upper leg



Keyhole impression



Barbs to engage mounting panel



Barbs to engage backing panel

SCREW SIZE	PART NUMBER	PANEL RANGE	PANEL SYMBOL	DESIGN VARIATION	A	B	C	D	H	T	X	Y
		mm.			mm.	mm.	mm.	mm.	mm.	mm.	mm.	mm.
No. 4 AB	SNU 2449	0.61/0.71	-	Std	11.2	7.9	4.77	5.1	4.77	0.51	8.33	5.54
No. 4 AB	SNU 1812	0.71/1.22	-	F	11.2	7.9	4.77	5.1	4.77	0.51	8.33	5.54
No. 4 AB	SNU 3886	-	-	FJ	11.0	7.9	5.1	4.8	3.9	0.56	8.3	6.6
No. 4 AB	SNU 3970	-	-	J	9.3	7.9	3.0	4.7	3.9	0.56	8.3	5.6
No. 6 AB	SNJ 1198/--/4	0.61/1.02	4	Std	16.8	11.2	7.14	7.9	5.94	0.56	11.38	4.06
No. 6 AB	SNJ1895	0.91/1.22	-	Std	9.6	7.9	3.96	4.6	4.77	0.56	8.33	3.81
No. 6 AB	SNJ 1198/--/6	1.22/1.63	6	Std	16.5	11.2	7.14	7.9	5.94	0.56	11.38	4.06
No. 6 AB	SNJ 1915	1.83/2.03	-	Std	16.5	11.2	6.73	7.9	5.94	0.56	11.38	4.06
No. 6 AB	SNU 3823	0.46/0.81	-	J	9.6	7.9	3.56	4.8	5.21	0.56	8.33	6.73
No. 6 AB	SNU 1219	0.71/1.63	-	F	16.5	11.2	6.73	7.9	5.94	0.56	11.38	6.10
No. 6 AB	SNU 3716	0.79/1.30	-	DE	9.6	12.7	4.06	4.3	5.28	0.61	12.95	4.76
No. 6 AB	SNU 2592	0.91/1.22	-	J	9.6	7.9	3.56	4.8	5.21	0.56	8.33	6.73
No. 6 AB	SNU 2811	0.91/1.22	-	FJ	11.7	7.9	5.54	4.8	5.21	0.56	8.33	5.71
No. 6 AB	SNU 3374	0.91/1.22	-	FJK	11.7	7.9	5.54	4.8	5.21	0.56	8.33	5.71
No. 6 AB	SNU 2945	1.98/2.06	-	GJ	9.4	7.9	3.00	4.8	3.96	0.56	8.33	6.60
No. 6 AB	SNU 3129	2.16/2.41	-	H	12.4	11.2	6.15	5.6	5.54	0.56	11.38	7.11
No. 6 AB	SNU 3720	2.44/2.92	-	H	12.4	11.2	5.92	5.6	5.54	0.56	11.38	7.11
No. 6 AB	SNU 2954	2.54/2.79	-	F	16.5	11.2	6.73	8.4	5.94	0.56	11.38	7.62
No. 6 AB	SNU 3773	3.43/3.68	-	FJ	10.9	7.9	5.08	4.8	5.21	0.56	8.33	7.14
No. 6 AB	SNU 3774	3.43/3.68	-	FGJ	10.9	7.9	5.08	4.8	3.96	0.56	8.33	7.14
No. 6 AB	SNU 2031	12.19/13.21	-	DFG	12.4	12.7	6.35	5.1	5.54	0.56	-	-
No. 6 AB	SNU 3932	1.6/1.9	-	F*3	16.5	11.1	7.5	7.9	6.0	0.56	11.5	9.9
No. 6 AB	SNU 3936	0.8/1.0	-	HJ	10.0	9.5	4.0	4.9	5.2	0.56	9.9	6.0
No. 6 AB	SNU 3980	-	-	GF	15.9	11.1	8.0	7.9	5.2	0.56	11.5	9.5
No. 6 AB	SNU 3981	-	-	GF	16.0	11.1	6.4	8.4	5.2	0.56	11.5	9.6
No. 6 AB	SNU 4032	-	-	FJ	19.0	11.2	10.7	7.1	5.2	0.51	11.6	11.4
No. 6 AB	SNU 4040	-	-	Std	17.1	11.0	6.7	7.9	5.2	0.61	11.4	10.3
No. 6 AB	SNU 4060	-	-	FJK	11.6	7.9	5.5	4.8	5.2	0.56	8.3	7.0
No. 6 AB	SNU 4102	0.9/1.2	-	FJ	11.6	7.9	5.5	4.8	5.2	0.56	8.3	7.0
No. 6 AB	SNU 4108	-	-	OH	12.5	11.1	6.2	5.5	5.5	0.56	11.6	7.5
No. 8 AB	SNJ 0116/--/5	0.71/1.22	5	Std	16.8	11.2	7.14	7.9	7.14	0.61	11.38	5.59
No. 8 AB	SNJ 1601/--/5	0.71/1.22	5	Std	23.9	11.2	14.27	7.9	7.14	0.61	11.38	5.71
No. 8 AB	SNJ 0116/--/6	1.42/1.83	6	Std	16.5	11.2	7.14	7.9	7.14	0.61	11.38	5.59
No. 8 AB	SNJ 1601/--/6	1.42/1.83	6	Std	23.6	11.2	14.27	7.9	7.14	0.61	11.38	5.71
No. 8 AB	SNJ 2005	2.39/2.64	-	AC	16.5	9.7	6.35	7.9	7.14	0.71	9.91	5.71
No. 8 AB	SNU 1864	0.56/1.02	-	DF	14.0	12.7	5.54	6.3	7.14	0.61	12.95	6.35
No. 8 AB	SNU 3381	0.71/1.02	-	G	16.5	8.6	8.74	6.3	5.08	0.71	8.99	7.52
No. 8 AB	SNU 3248	0.71/1.02	-	FK	16.8	11.2	7.14	7.9	7.14	0.61	11.38	8.74
No. 8 AB	SNU 0536	0.71/1.63	-	F	16.5	11.2	6.73	7.9	7.14	0.61	11.38	7.62
No. 8 AB	SNU 1561	0.71/1.63	-	F	24.4	11.2	4.30	7.9	7.14	0.61	11.38	10.67
No. 8 AB	SNU 2032	0.81/0.96	-	H	11.7	10.4	4.77	5.6	6.35	0.51	10.72	6.35
No. 8 AB	SNU 3178	0.81/1.14	-	E	16.5	11.2	7.62	7.9	6.73	0.71	11.38	6.35
No. 8 AB	SNU 3106	0.81/1.78	-	DF	15.2	14.2	7.92	5.8	6.35	0.61	14.73	8.74
No. 8 AB	SNU 3247	0.91/1.63	-	FKL	16.5	11.2	6.73	7.9	7.14	0.61	11.38	8.64
No. 8 AB	SNU 2285	1.12/1.17	-	H	11.7	10.4	4.77	5.8	6.35	0.51	10.72	6.35
No. 8 AB	SNU 1675	1.22/1.63	-	H	10.4	8.6	4.37	4.6	6.60	0.51	8.99	6.35
No. 8 AB	SNU 1686	1.22/1.63	-	DF	14.0	12.7	5.54	6.3	7.14	0.61	12.95	7.14
No. 8 AB	SNU 2013	2.03/2.64	-	E	27.7	12.7	18.24	7.9	6.73	0.61	12.95	8.74
No. 8 AB	SNU 2569	2.03/2.79	-	F	16.3	11.2	6.73	7.9	7.14	0.61	11.38	7.62
No. 8 AB	SNU 3194	2.92/3.10	-	G	15.5	8.6	8.74	6.3	5.21	0.71	8.99	7.92
No. 8 AB	SNU 1907	3.17/3.56	-	FG	17.3	11.2	6.73	7.9	6.35	0.61	11.38	7.92
No. 8 AB	SNU 2598	3.56/4.17	-	G	22.9	11.2	13.49	7.9	5.54	0.71	11.38	9.91
No. 8 AB	SNU 2448	4.32/4.83	-	FG	16.0	11.2	6.73	7.9	6.35	0.61	11.38	7.92
No. 8 AB	SNU 2251	5.95/6.98	-	DFG	13.5	12.7	6.73	5.1	5.54	0.61	-	-
No. 8 AB	SNU 2250	8.00/8.99	-	DFG	12.4	12.7	5.94	5.1	5.54	0.61	-	-
No. 8 AB	SNU 1898	15.49/16.26	-	DFG	15.2	14.2	7.92	6.3	6.35	0.61	-	-
No. 8 AB	SNU 3915	-	-	FKL	16.5	11.1	6.3	8.4	7.1	0.61	11.5	9.9
No. 8 AB	SNU 3925	-	-	H	11.8	10.3	5.0	5.7	4.9	0.51	10.7	7.1
No. 8 AB	SNU 3968	-	-	FJG	14.4	12.7	6.1	6.4	7.1	0.61	13.1	13.0
No. 8 AB	SNU 3988	-	-	GK	16.2	11.1	5.8	7.9	7.1	0.61	11.5	9.7
No. 8 AB	SNU 3990	-	-	HM	10.5	8.7	4.8	4.6	7.1	0.51	9.1	6.3
No. 8 AB	SNU 3991	-	-	FG	14.4	12.7	6.1	6.4	7.1	0.61	13.1	13.0