

SECTION A-A

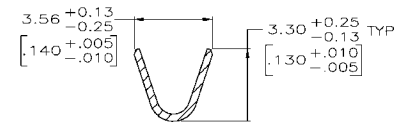
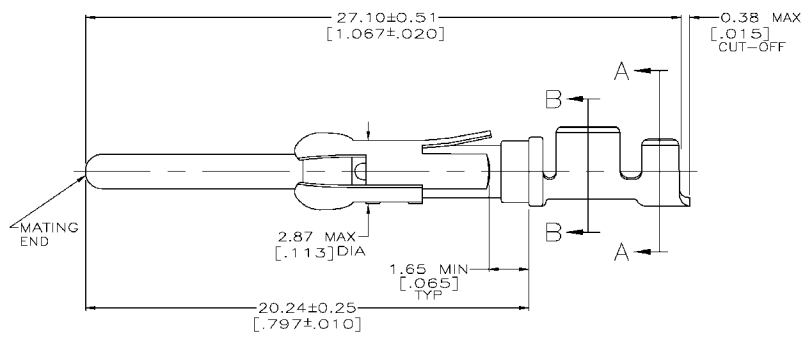

SECTION B-B

- 1. 0.76μm [.000030] MIN GOLD PER MIL-G-45204 ON MATING END FOR A LENGTH OF 5.08 [.200] MIN WITH GOLD FLASH ON THE REMAINDER, OVER 1.27μm [.000050] MIN NICKEL PER QQ-N-290.
- 2. 0.76μm [.000030] MIN GOLD PER MIL-G-45204 IN MATING END FOR A LENGTH OF 5.08 [.200] MIN WITH A UNIFORM GRADIENT TO 0.25μm [.000010] MIN GOLD PER MIL-G-45204 ON THE REMAINDER, OVER 1.27μm [.000050] MIN NICKEL PER QQ-N-290.
- 3. 0.38μm [.000015] MIN GOLD PER MIL-G-45204 ON MATING END FOR A LENGTH OF 5.08 [.200] MIN WITH GOLD FLASH ON THE REMAINDER OVER 1.27μm [.000050] MIN NICKEL PER QQ-N-290.
- 4. 1.27μm [.000050] MIN TIN-LEAD PER MIL-T-10727 OVER 1.27μm [.000050] MIN NICKEL PER QQ-N-290.
- 5. GOLD PLATING NOT REQUIRED IN THIS AREA.
- 6. WIRE RANGE 18-14 AWG.
- 7. INSULATION RANGE 2.03 [.080]-2.54 [.100] DIA.
- 8. 0.38μm [.000015] MIN GOLD PER MIL-G-45204 ON MATING END FOR A LENGTH OF 5.08 [.200] MIN, 1.27μm [.000050] MIN TIN-LEAD PER MIL-T-10727 FOR A LENGTH OF 5.69 [.224] MIN ON OPPOSITE END, BOTH OVER 1.27μm [.000050] MIN NICKEL PER QQ-N-290 ON ENTIRE CONTACT.
- 9. 1.27μm [.000050] MIN TIN PER MIL-T-10727 OVER 1.27μm [.000050] MIN NICKEL PER QQ-N-290.

	STANDARD	△	BRASS	1-66359-7	1-66361-5
	STANDARD	△	BRASS	1-66359-6	1-66361-4
	SMALL PACK	△	BRASS	1-66361-2	1-66361-3
	STANDARD	△	BRASS	1-66359-4	1-66361-2
	SMALL PACK	△	BRASS	66359-4	1-66361-1
	SMALL PACK	△	BRASS	66359-2	1-66361-0
OBSOLETE	STANDARD	△	BRASS	1-66359-3	66361-9
OBSOLETE	STANDARD	△	PHOSPHOR BRONZE	1-66359-2	66361-8
OBSOLETE	STANDARD	△	PHOSPHOR BRONZE	1-66359-1	66361-7
	STANDARD	△	BRASS	66359-4	66361-4
	STANDARD	△	BRASS	66359-3	66361-3
	STANDARD	△	BRASS	66359-2	66361-2
	STANDARD	△	BRASS	66359-1	66361-1

THIS DRAWING IS A CONTROLLED DOCUMENT

DATE: 06/03/92	BY: L. SIFF	TYCO Electronics	Tyco Electronics Corporation
DATE: 6-11-92	BY: W. LENKER	TYCO Electronics	City, State, Zip
DATE: 7-8-92	BY: G. STEINHAUER	TYCO Electronics	

PIN ASSEMBLY, LOOSE PIECE, TYPE III+

DATE: 06/03/92 DRAWING NO: A2 00779 C-66361

CUSTOMER DRAWING SCALE: 8:1 SHEET: 1 OF 1 REV: E