

1

2

3

4

5

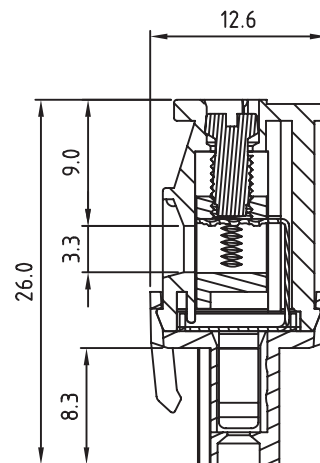
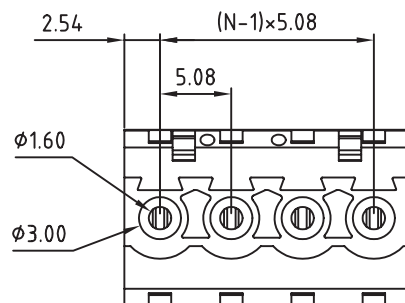
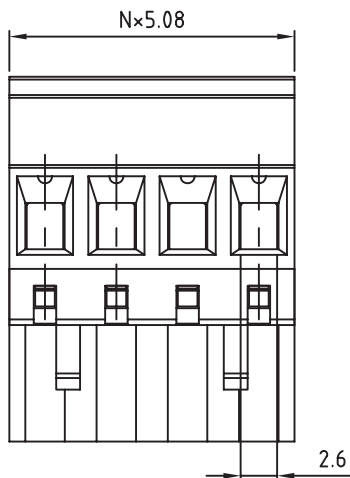
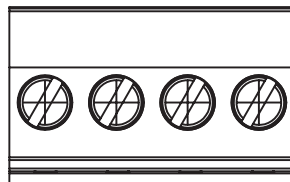

TECHNICAL CHARACTERISTICS

MATERIAL

INSULATOR: NYLON 66
 COLOR: GREEN
 METAL HOUSING: BRASS (CuZn)
 TERMINAL SCREW: STEEL ZINC PLATING "-" SLOT TYPE
 WIRE GUARD: PhBz TIN PLATED

ENVIRONMENTAL

OPERATING TEMPERATURE: -30 UP TO 105°C
 FLAMABILITY RATING: UL94-V0
 COMPLIANCE: LEAD FREE AND ROHS

ELECTRICAL

	cULus	VDE
CURRENT RATING:	15A	17A
WORKING VOLTAGE:	300VAC	300VAC
WITHSTANDING VOLTAGE:	1.6KV	2.5KV

MECHANICAL

	12-24 AWG	0.34-2.5MM ²
SOLID WIRE:	12-24 AWG	0.34-2.5MM ²
STRANDED WIRE:	12-24 AWG	0.34-2.5MM ²
TORQUE :	3.5Lb.In	0.5Nm

WIRE STRIPE LENGTH: 6-7MM

SCREW: M3
 PITCH: 5.08MM

SOLDERING: WAVE PROCESS ONLY

PACKAGING
 BOX

SERIE 352

CERTIFICATION



RoHS Compliant

PROJECTION:

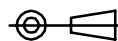

GENERAL TOLERANCE

.X = +/- 0.2

.XX = +/- 0.15



APPROVAL: RJ

UNIT: MM

SCALE:

SHEET: 1/1

DRAW: MARVIN

DESCRIPTION: 5.08MM GREEN PLUG HORIZONTAL FRANT WIRE ENTRY WITH SCREW

WERI PART NO: 691 352 510 0xx

SIZE

A4

REV	DATE	FILE	BY
A	31-OCT-07	PDF	EC