



Dimensions

DIN 7985

BS 4183

ISO 7045

Materials / Finishes:

Steel 4.8 / Zinc & clear

Other materials and finishes available on request

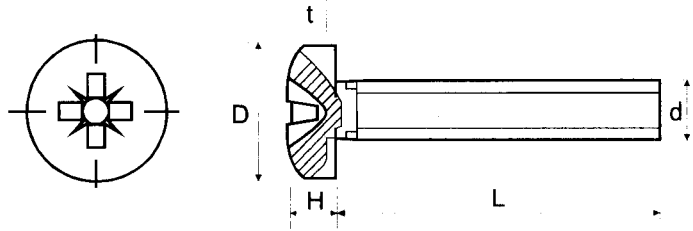

d	M2	M2.5	M3	M3.5	M4	M5	M6	M8
D nom	4	5	6	7	8	10	12	16
recess No.	0	1	1	2	2	2	3	4
Head HT max (DIN)	1.7	2.1	2.5	2.8	3.25	3.95	4.75	6.1
Head HT max (BS)	-	1.75	2.1	2.45	2.8	3.5	4.2	5.6
Head HT max (ISO)	1.6	2.1	2.4	2.6	3.1	3.7	4.6	6

NB: Generally our preferred stock is to DIN - if dimensions are critical to your application you should check with us prior to ordering.

Preferred sizes - Steel

d	M2	M2.5	M3	M3.5	M4	M5	M6	M8
L	4	TR	TR					
	5	TR	TR					
	6	TR	TR			TR	TR	
	8	TR	TR			TR	TR	TR
	10	TR	TR			TR	TR	TR
	12	TR	TR			TR	TR	TR
	16	TR	TR			TR	TR	TR
	20	TR	TR			TR	TR	TR
	25	TR	TR			TR	TR	TR
	30			TR		TR	TR	TR
	35					TR	TR	TR
	40					TR	TR	TR
	45						TR	
	50						TR	
	60							
65								