

© COPYRIGHT 1997 BY SPC TECHNOLOGY. ALL RIGHTS RESERVED. NO PORTION OF THIS PUBLICATION, WHETHER IN WHOLE OR IN PART CAN BE REPRODUCED WITHOUT THE EXPRESS WRITTEN CONSENT OF SPC TECHNOLOGY.

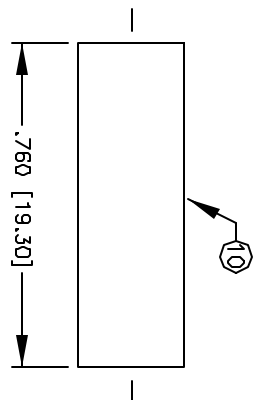

**SPECIFICATIONS:**

IMPEDANCE: 50 OHMS  
 WORKING VOLTAGE: 375V PEAK @ SEA LEVEL  
 FREQUENCY RANGE: 0-12.4 GHz  
 INSERTION LOSS: ≤ -.2 dB @ 6 GHz  
 VSWR MAXIMUM: 1.3:1 @ 6 GHz  
 FOR RG-174, 188, 188A, 316/U, ALPHA 9174, 9316,  
 BELDEN 8216, 83269, 83284, 84316 & TIMES LMR-100 CABLE

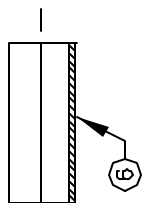
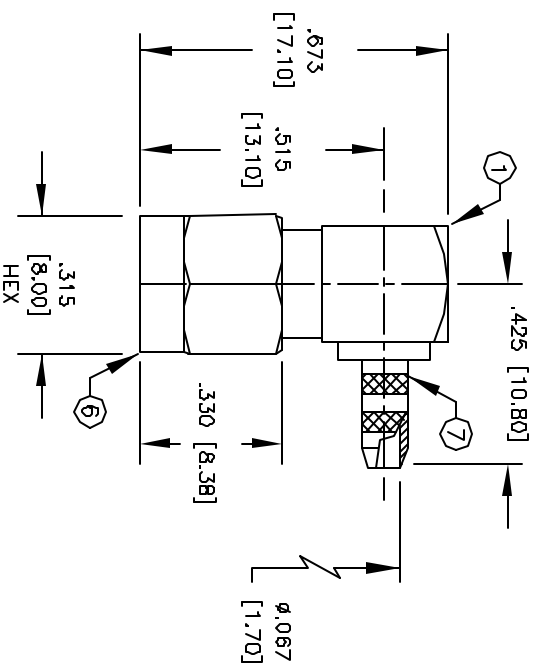
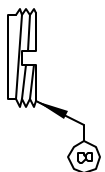
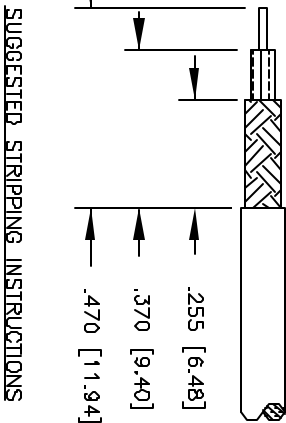

SUGGESTED STRIPPING INSTRUCTIONS

SUGGESTED CRIMP: .130

REVISIONS				DOC. NO.	SPC TECHNOLOGY		DATE	REV		
DCP #	REV	DESCRIPTION	RELEASED	Effective	3/3/97	DCP Nos	103	Supersedes	DCP No	97
18	A	RELEASED	D.J.C.	4/2/97	J.C.	4/8/97	B.B.	4/16/97		
428	B	CHANGE ELECTRONIC FILE NAME	DJC	2/12/98	JC	2/17/98	JC	2/17/98		

ITEM	DESCRIPTION	QTY	MATERIAL	FINISH
10	HEAT SHRINK	1		BLACK
9	FERRULE	1	BRASS	NICKEL
8	END CAP	1	BRASS	NICKEL
7	FERRULE STUD	1	BRASS	NICKEL
6	SHELL	1	BRASS	NICKEL
5	RETAINING RING	1	BERILLIUM COPPER	NONE
4	GASKET	1	S.I. RUBBER	BRIGHT ORANGE
3	DIELECTRIC	1	TEFLON	NONE
2	PIN	1	BRASS	GOLD
1	BODY	1	BRASS	NICKEL

DISCLAIMER  
 ALL DIMENSIONS AND TECHNICAL INFORMATION CONTAINED HEREIN ARE BASED UPON INFORMATION AND/OR TESTS WE BELIEVE TO BE ACCURATE AND RELIABLE. SINCE CONDITIONS OF USE ARE NOT KNOWN AT THE TIME OF DESIGN, THE USER SHALL DETERMINE THE SUITABILITY OF THE PRODUCT FOR THE INTENDED USE AND ASSUME ALL RISK AND LIABILITY WHATSOEVER IN CONNECTION THEREWITH.



SPC TECHNOLOGY  
 2070160, IL 60140-4166

DRAWN BY: DANIEL CAREY		DATE: 4/2/97		DRAWING TITLE: SMA MALE RIGHT ANGLE CRIMP	
CHECKED BY: JOHN COLE		DATE: 4/8/97		SIZE DWG. NO. 8589-0837	
APPROVED BY: BRETT BRAATZ		DATE: 4/16/97		SCALE: NTS	
				U.O.M.: INCHES [mm]	
				SHEET: 1 OF 1	
DIMENSIONS ARE FOR REFERENCE PURPOSES ONLY.		CAD FILE		REV B	