

SUBMINIATURE COAXIAL CONNECTORS

SMB LOCK series

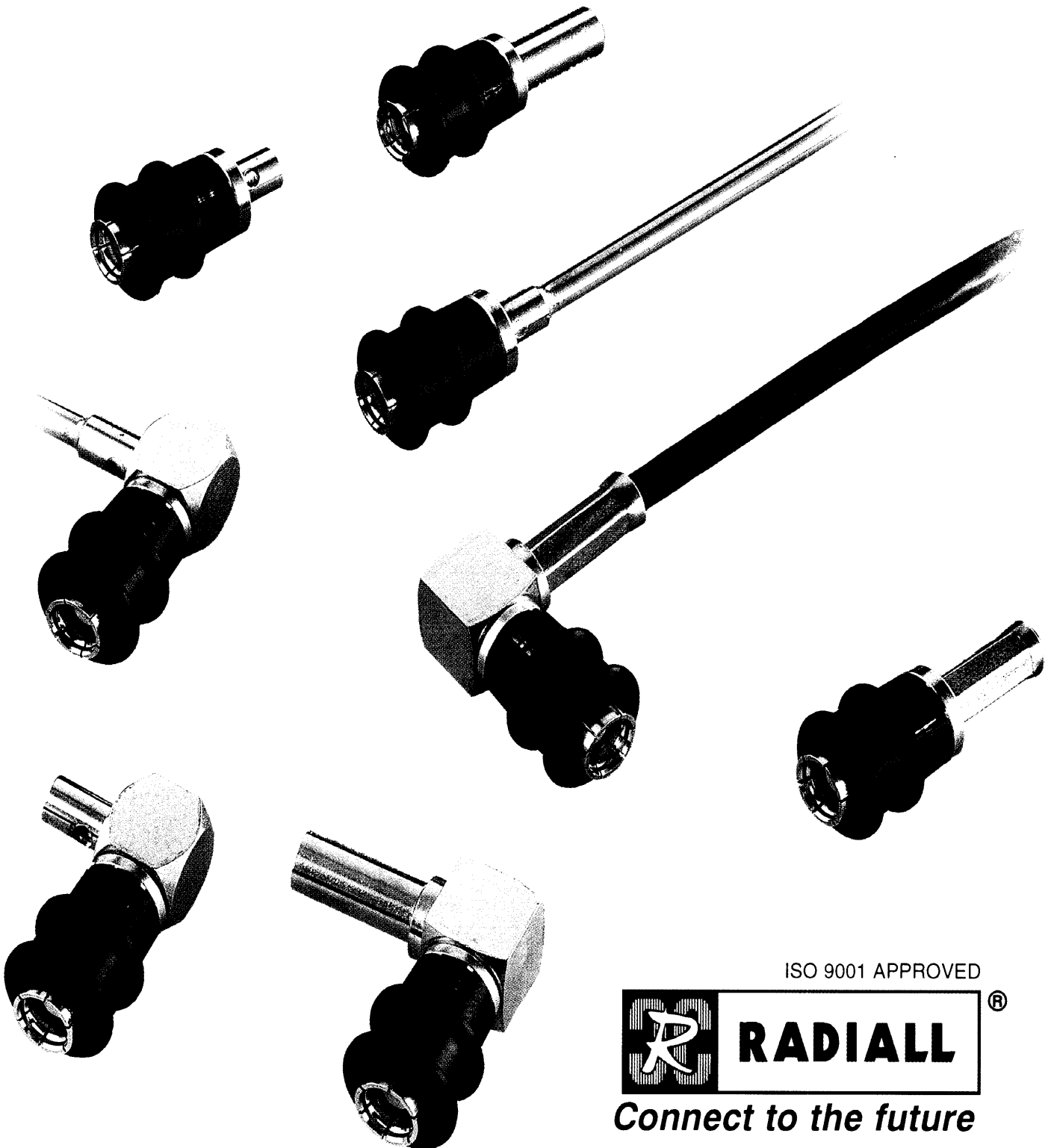

ISO 9001 APPROVED



Connect to the future

SMB LOCK

RADIALl proposes new **SMB LOCK** plugs with a 2 step connection system :

- 1 - **Snap** the plug on the male connector (fig. 1),
- 2 - **Lock** the couple by pushing down the coupling nut (fig. 2).

This new range

- ◆ is **totally intermateable** with the standard **SMB** male connectors.
- ◆ benefits from a low intermodulation.
- ◆ is intended to replace the standard SMB and screw-on connectors in all applications requiring :

- a fast connection
- a reliable lock-on connection
- long durability.

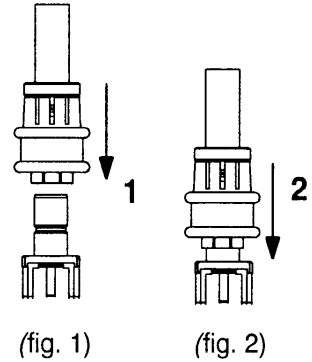
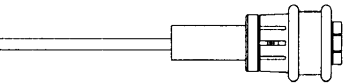

ELECTRICAL CHARACTERISTICS

Impedance		50 Ω		
Operating frequency		DC to 4 GHz		
Typical V.S.W.R.	Straight models	.085"	2 GHz	4 GHz
		∅ 2.6/50	1.15	1.20
Right angle models	.085"	1.20	1.25	
	∅ 2.6/50	1.05	1.15	
RF insertion loss.	Straight models	.085"	0,20 √F (GHz)	
		∅ 2.6/50	0,25 √F (GHz)	
Right angle models	.085"	0,25 √F (GHz)		
	∅ 2.6/50	0,50 √F (GHz)		
Testing voltage (V RMS)	.085"	750		
	∅ 2.6/50	1000		
Working voltage (V RMS)	.085"	335		
	∅ 2.6/50	335		
Insulation resistance (MΩ)		1000		

ENVIRONMENTAL CHARACTERISTICS

Temperature range	-35 °C / +125 °C
-------------------	------------------

MECHANICAL CHARACTERISTICS

Life		500 matings min
Cable retention force	.085"	220 N
	∅ 2.6/50	110 N
Coupling nut retention force		50 N min

MATERIALS

Bodies	Brass
Center contact	Beryllium copper
Outer contact	Bronze
Insulator	PTFE
Coupling nut	POM

PLATING

Bodies	BBR (non magnetic plating)
Center contact	Gold

Standard packaging : 100 pieces (same part number). For unit packaging, add "W" after the P/N.

SMB LOCK

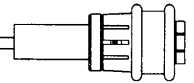

STRAIGHT PLUG FULL CRIMP TYPE FOR FLEXIBLE CABLES

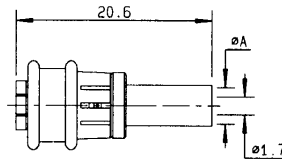

Cable type	cable	part number	A	captive c.contact
2.6/50/S	RG174-188-316 / SHF 2.7 TU*	R117 082 807	3.25	yes
2.6/50/D	RD316 / SHF 2.7 TD*	R117 083 807	3.5	yes

RIGHT ANGLE PLUG CRIMP TYPE FOR FLEXIBLE CABLES

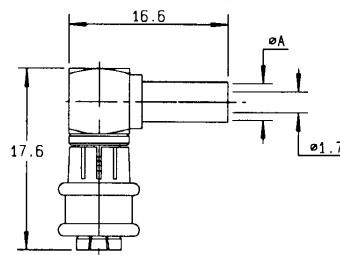
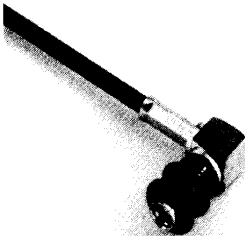

Cable type	cable	part number	A	captive c.contact
2.6/50/S	RG174-188-316 / SHF 2.7 TU*	R117 186 807	3.25	yes
2.6/50/D	RD316 / SHF 2.7 TD*	R117 187 807	3.5	yes

STRAIGHT PLUG SOLDER TYPE FOR SEMI-RIGID CABLE

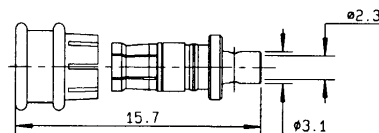

Cable type	cable	part number	captive center contact
.085"	RG 405/U	R117 053 807	no

RIGHT ANGLE PLUG SOLDER TYPE FOR SEMI-RIGID CABLE

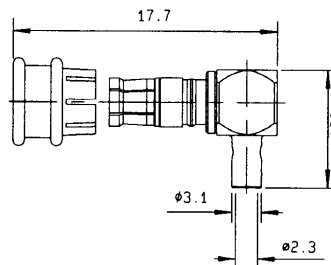
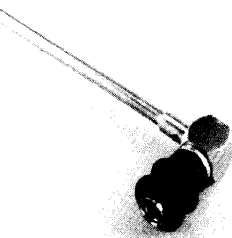

Cable type	cable	part number	captive center contact
.085"	RG 405/U	R117 152 807	yes

* These RADIALL cables are "low loss-low cost" option to RG cables. Their main advantages are : **low loss level, low intermod level, high shielding effectiveness, halogen free.** Part number : SHF 2.7 TU : **C291 999 904** - SHF 2.7 TD : **C 291 214 090.**