

1

2

3

4

5

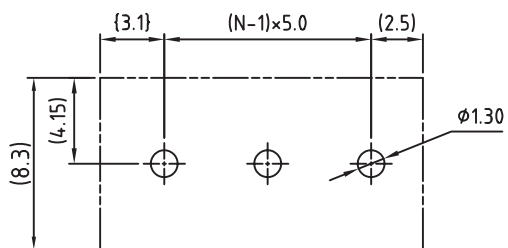
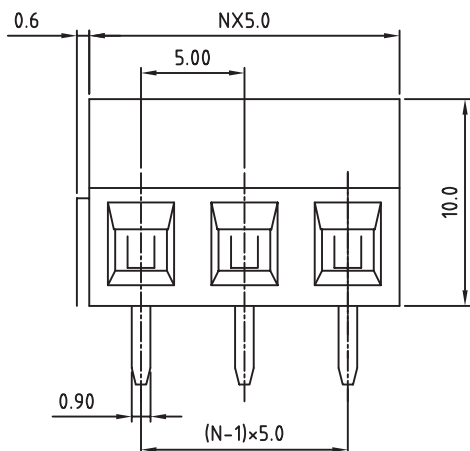
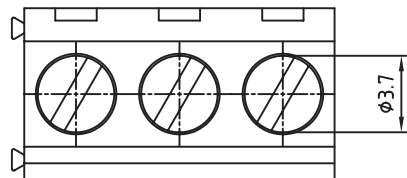

PCB LAYOUT - COMPONENT VIEW

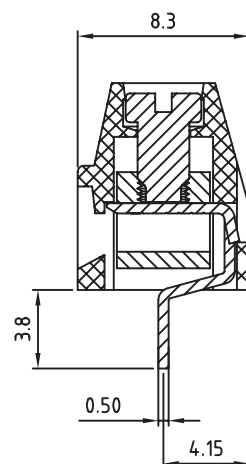

TECHNICAL CHARACTERISTICS

MATERIAL

INSULATOR: NYLON 66
 MAX TEMPERATURE: WAVE SOLDERING COMPATIBLE
 COLOR: GREEN
 METAL HOUSING: BRASS (CuZn)
 TERMINAL SCREW: STEEL ZINC PLATING "-" SLOT TYPE
 CONTACTS: BRASS
 SOLDER TAIL PLATING: TIN

ENVIRONMENTAL

OPERATING TEMPERATURE: -30 UP TO 105°C
 FLAMABILITY RATING: UL94-V0
 COMPLIANCE: LEAD FREE AND ROHS

ELECTRICAL

	UL	VDE
CURRENT RATING:	10A	10A
WORKING VOLTAGE:	300VAC	250VAC
WITHSTANDING VOLTAGE:	1.6KV	2.0KV

MECHANICAL

SOLID WIRE:	16-26 AWG	0.5-1.5MM ²
STRANDED WIRE:	16-26 AWG	0.5-1.5MM ²
TORQUE :	3.5Lb.In	0.4Nm

WIRE STRIPE LENGTH: 5-6MM

SCREW: M2.5

PITCH: 5.0MM

SOLDERING: WAVE PROCESS ONLY

PACKAGING

BOX

SERIE 213

CERTIFICATION



RoHS Compliant

PROJECTION:

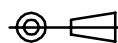

GENERAL TOLERANCE

.X = +/- 0.2

.XX = +/- 0.15



APPROVAL: RJ

UNIT: MM

SCALE:

SHEET: 1/1

DRAW: MARVIN

DESCRIPTION: 5.0MM MODULAR GREEN HORIZONTAL ENTRY
 WITH RISING CAGE CLAMP - 10.0MM HEIGHT

WERI PART NO: 691 213 710 0xx

SIZE

A4

G			
F			
E			
D			
C			
B			
A	30-OCT-07	PDF	EC
REV	DATE	FILE	BY