



<a href="#">Home</a>	<a href="#">Products</a>	<a href="#">Enquiry Form</a>	<a href="#">Contact Us</a>	<a href="#">The Company</a>	<a href="#">Quality</a>
----------------------	--------------------------	------------------------------	----------------------------	-----------------------------	-------------------------

## 90 Degree DIN Panel Meters

### Technical Specification

<b>Standards:</b>	IEC 51, BS 89
<b>Enclosure:</b>	DIN43700 Flame retardant base material UL94V1, case & terminal cover material UL94VO. Scale marking DIN 43802 Protection IP52: IP54 can be supplied.
<b>Overload:</b>	CURRENT-1.2 x rating for 2hrs -10 x rating for 5 secs. VOLTAGE-1.2 x rating for 2 hrs - 2 x rating for 5 secs. *
<b>Insulation Test:</b>	2kV 50Hz for 1 min
<b>Temperature:</b>	Calibrated at 23°C Suitable for use at -25°C to +40°C
<b>Available Extras:</b>	Adjustable red secondary pointer. Terminal cover. Special scale. Polycarbonate window. 6.4mm "Faston" terminal tag (voltmeters & ammeters to 5A).

\* Not for 1A MDI

### Panel Cut-Outs

(All Dimensions in mm)

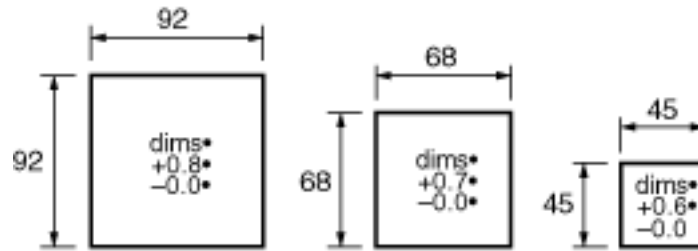

Dimensions (All in mm)

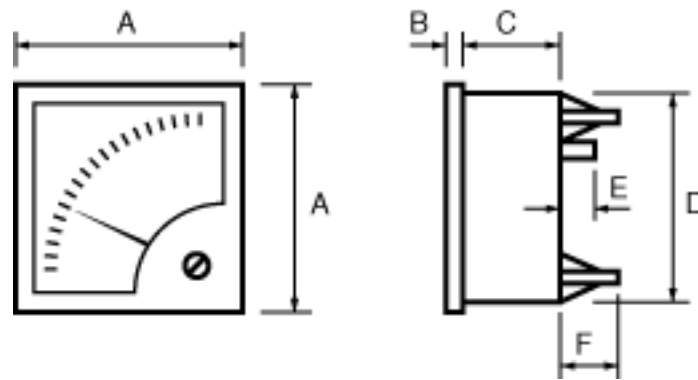

	A	B	C	D	E	F
DIN 48 (M4 screw clamps) Ammeters up to 5A & Voltmeters	48	5	43	44.8	10	-
DIN 48 (M6 stud terminals) Ammeters 6A to 40A	48	5	43	44.8	21	-
DIN 72 (M4 screw clamps) Ammeters up to 5A & Voltmeters	72	5.5	38.5	66	10	-
DIN 72 (M6 stud terminals) Ammeters 6A to 50A	72	5.5	38.5	66	19	-
DIN 72 (M8 stud terminals) Ammeters 60A to 100A	72	5.5	38.5	66	22	-
DIN 96 (M4 screw clamps) Ammeters upto 5A & voltmeters	96	5.5	38.5	90	10	20
DIN 96 (M6 stud terminals) Ammeters 6A to 50A	96	5.5	38.5	90	19	20

DIN 96 (M8 stud terminals) Ammeters 60A to 100A	96	5.5	28.5	90	22	20
DIN96 Watt-meter	96	5.5	123	90	13	-
DIN96 Power Factor Indicator	96	5.5	123	90	13	-
DIN96 Max Demand Indicator (M4 screw clamps)	96	5.5	58	90	10	20
DIN96 Combined MDI (M4 screw clamps)	96	5.5	58	90	10	20

**Note:** If terminal covers are fitted as an optional extra, add 23mm to dimension "C" for DIN72 & DIN96 meters, add 25mm to dimension "C" for DIN48 meters.



**[Main Meter Page](#)**

**Contact sales: [sales@hobut.co.uk](mailto:sales@hobut.co.uk)**