

Tous droits strictement réservés. Reproduction ou communication à des tiers interdite sous quelque forme que ce soit sans autorisation écrite du propriétaire. Propriété de c FCI. Droits de reproduction FCI.

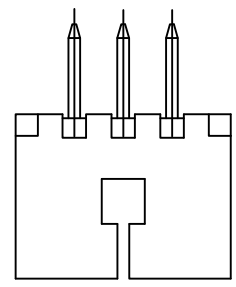

All rights strictly reserved. Reproduction or issue to third parties in any form whatever is not permitted without written authority from the proprietor. Property of FCI. Copyright FCI.

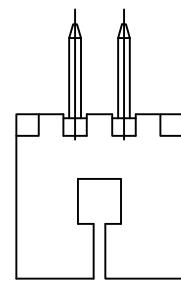
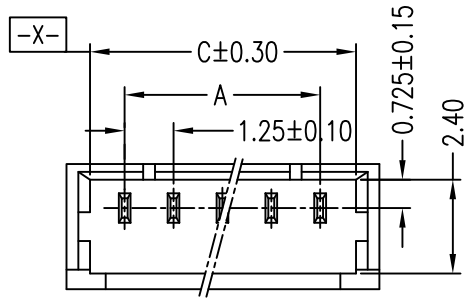

2 POS

3 POS

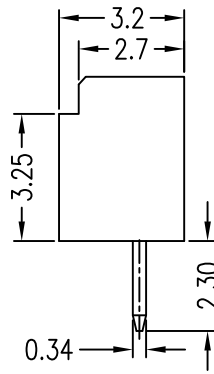
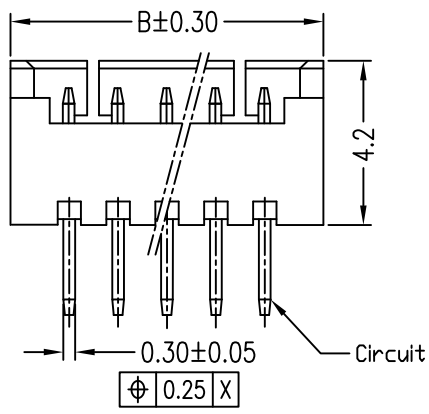

NOTES

- SPECIFICATIONS**  
 Current Rating: 1A AC,DC  
 Voltage Rating: 125V AC,DC  
 Temperature Range: -40°C ~ +105°C  
 Contact Resistance: 20mΩ Max.  
 Insulation Resistance: 100MΩ Min.  
 Withstanding Voltage: 500V AC/minute
- Material & finish:**  
 Housing: Natural Thermoplastic, UL94V-0  
 Contact and metal hold-down: Phosphor Bronze  
 Plating of contact: Matte Tin or gold plating over Nickel
- Ordering Information & Dimensions:**  
 10114829- X X X XX LF  
 Material: LCP  
 Plating: 0: Matte Tin, 1: Gold Flash  
 Packaging: 1: Tape & Reel  
 LF: See note A  
 pin counts from 02~15

Part No.	Dimensions			
	POS	A	B	C
10114829-xxx02LF	2	1.25±0.10	4.25	3.05
10114829-xxx03LF	3	2.50±0.10	5.50	4.30
10114829-xxx04LF	4	3.75±0.10	6.75	5.55
10114829-xxx05LF	5	5.00±0.10	8.00	6.80
10114829-xxx06LF	6	6.25±0.15	9.25	8.05
10114829-xxx07LF	7	7.50±0.15	10.50	9.30
10114829-xxx08LF	8	8.75±0.15	11.75	10.55
10114829-xxx09LF	9	10.00±0.15	13.00	11.80
10114829-xxx10LF	10	11.25±0.20	14.25	13.05
10114829-xxx11LF	11	12.50±0.20	15.50	14.30
10114829-xxx12LF	12	13.75±0.20	16.75	15.55
10114829-xxx13LF	13	15.00±0.20	18.00	16.80
10114829-xxx14LF	14	16.25±0.20	19.25	18.05
10114829-xxx15LF	15	17.50±0.20	20.50	19.30

Note A: The LF means RoHS compliance, the housing will withstand exposure to peak temperature 260 degree C for 5 sec in the IR re-flow process.

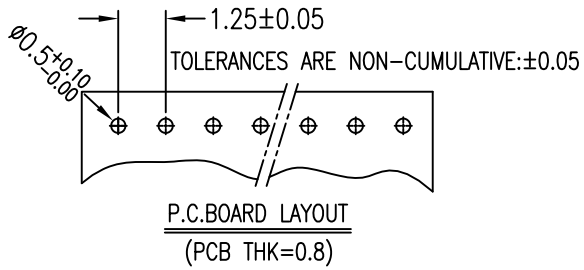

mat'l. code				tolerances unless otherwise specified				CUSTOMER COPY		FCI	
ltr	ecn no	dr	date	.X ± 0.25		projection		www.fciconnect.com			
A	T10-0145	J H	12/1/10	.XX ± 0.15		MM		title			
				.XXX ±		1:1		WTB 1.25MM WAFER 180° DIP			
				0° ±2°				product family		code	
				dr	JASON HSU	12/1/10	size		WTB		TWN
				enr	JASON HSU	12/1/10	dwg no		10114829		sheet
				chr	GARY HSIEH	12/1/10	scale		A4		1 of 1
				appd	JOSEPH HSIA	12/1/10					
sheet index	revision sheet	A	1								