

REV.	DATE	DESCRIPTION
NC	10/09/96	INITIAL RELEASE
A	05/29/07	UPDATE DRAWING FORMAT

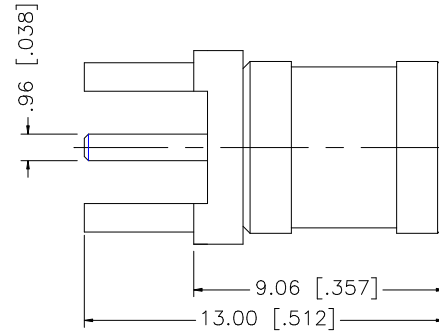
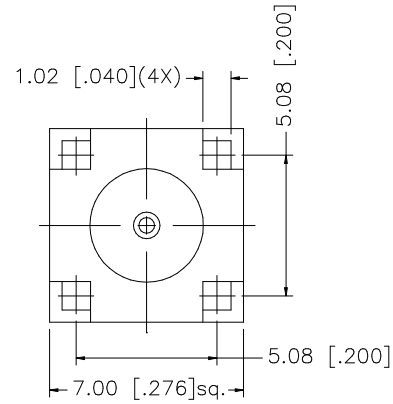

8					<small>UNLESS OTHERWISE SPECIFIED DIMENSIONS ARE IN MILLIMETERS. DIMENSIONS IN [ ] ARE IN INCHES AND FOR CUSTOMER REFERENCE ONLY.</small> <small>UNLESS OTHERWISE SPECIFIED TOLERANCES FOR MILLIMETERS ARE:</small> 0.5 - 8mm ± 0.20mm 8 - 30mm ± 0.40mm 30 - 120mm ± 0.50mm <small>UNLESS OTHERWISE SPECIFIED TOLERANCES FOR INCHES ARE:</small> .020 - .315 = ± 0.007" .315 - 1.180 = ± 0.015" 1.180 - 4.724 = ± 0.020"	APPROVALS	DATE	<h1 style="color: blue;">Amphenol Connex</h1>			
7				DRAWN		G.R.S.	05/29/07				
6				CHECKED				<b>PART DESCRIPTION</b>  <b>STRAIGHT SMB PLUG FOR P.C. BOARD</b>			
5				ISSUED							
4							<b>PART NO.</b>  <b>142134</b>				
3	CONTACT PIN	BRASS	GOLD	1	SHEET	1 OF 1					
2	INSULATOR	TEFLON	NATURAL	1	<b>DWG. NO.</b> 142134.DWG						
1	HOUSING/BODY	BRASS	GOLD	1					<b>REV.</b> A <b>SIZE</b> A <b>SCALE</b> NA		
	DESCRIPTION	MATERIAL	FINISH	QTY	<small>DO NOT SCALE DRAWING</small>						
					<small>CAD FILE</small> C:/142/142134.DWG						