



PART NO.

41612 - Series

REVISIONS

ECN #	REV	DESCRIPTION	DRAWN	DATE	CHECKD	DATE	APPRVD	DATE
-	A	RELEASED	Ramya	15/11/08	Suresh	15/11/08	Farnell	29/11/08

41612-32AB-MS

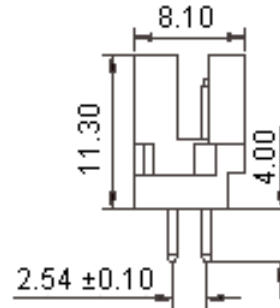
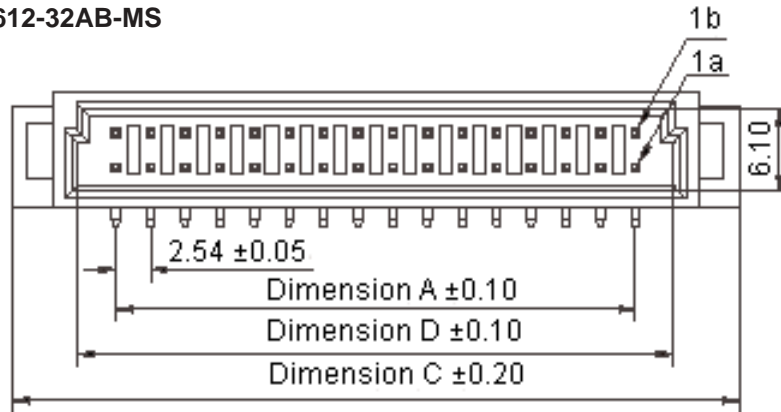

Feature:

- Design for home appliances, aviation electronics, automobile electronics and computer (PC) peripherals.

Specifications:

- Current rating : 2.0A ac/dc.
- Voltage rating : 250V ac/dc.
- Maximum contact resistance : 30mΩ.
- Minimum insulation resistance : 1000MΩ.
- Withstanding voltage : 1000V ac for one minute.
- Operating temperature range : -25°C to +125°C.

Material and Finish:

- Insulator : PBT.
- Plug contact : Copper alloy.
- Socket contact : Phosphor bronze.
- Plating : Selective gold plated.

41612-32AB-MR

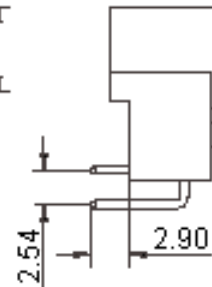
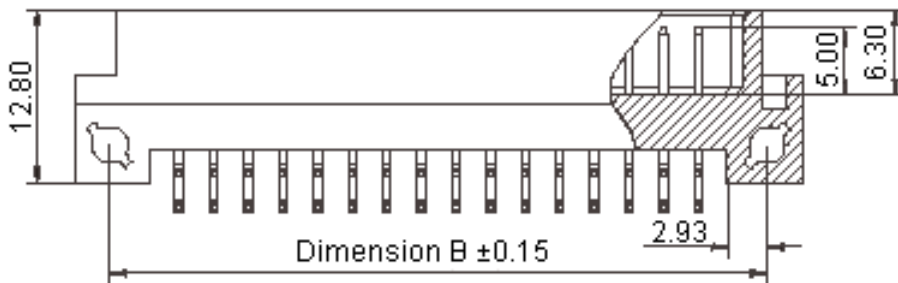

Dimensions : Millimetres

This data sheet and its contents (the "Information") belong to the Premier Farnell Group (the "Group") or are licensed to it. No licence is granted for the use of it other than for information purposes in connection with the products to which it relates. No licence of any intellectual property rights is granted. The Information is subject to change without notice and replaces all data sheets previously supplied. The Information supplied is believed to be accurate but the Group assumes no responsibility for its accuracy or completeness, any error in or omission from it or for any use made of it. Users of this data sheet should check for themselves the Information and the suitability of the products for their purpose and not make any assumptions based on information included or omitted. Liability for loss or damage resulting from any reliance on the Information or use of it (including liability resulting from negligence or where the Group was aware of the possibility of such loss or damage arising) is excluded. This will not operate to limit or restrict the Group's liability for death or personal injury resulting from its negligence. SPC MULTICOMP is the registered trademark of the Group. © Premier Farnell plc 2008.

TOLERANCES:
UNLESS OTHERWISE SPECIFIED, DIMENSIONS ARE FOR REFERENCE PURPOSES ONLY.

DRAWN BY:	DATE:
Ramya	15/11/08
CHECKED BY:	DATE:
Suresh	15/11/08
APPROVED BY:	DATE:
Farnell	29/11/08

DRAWING TITLE: 2.54mm Plug - DIN41612, Double Row			
SIZE A	DWG NO. M10001803	ELECTRONIC FILE 1661145-TDS_DWG	REV A
SCALE: NTS		U.O.M.: mm	SHEET: 1 OF 3



PART NO.

41612-32AB - Series

REVISIONS

ECN #	REV	DESCRIPTION	DRAWN	DATE	CHECKD	DATE	APPRVD	DATE
-	A	RELEASED	Ramya	15/11/08	Suresh	15/11/08	Farnell	29/11/08

Recommended PCB Layout

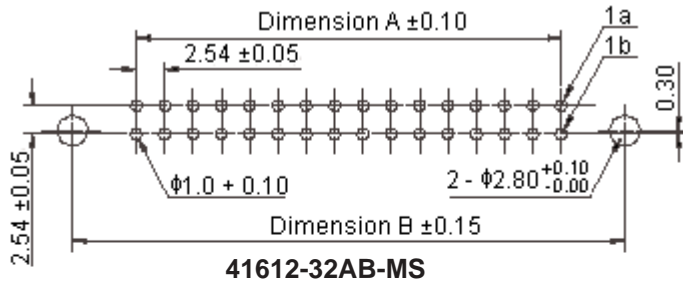

41612-32AB-MS

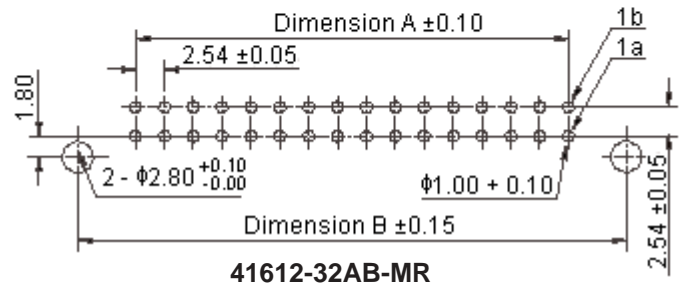

41612-32AB-MR

Dimensions : Millimetres

Engineering Dimensions

Number of Positions	A	B	C	D	Part Number
32	38.10	49.51	54.40	44.50	41612-32AB-MS
		48.20	53.20		41612-32AB-MR
64	78.74	90.15	95.00	85.50	41612-64AB-MS
		88.90	94.20		41612-64AB-MR

Dimensions : Millimetres

This data sheet and its contents (the "Information") belong to the Premier Farnell Group (the "Group") or are licensed to it. No licence is granted for the use of it other than for information purposes in connection with the products to which it relates. No licence of any intellectual property rights is granted. The Information is subject to change without notice and replaces all data sheets previously supplied. The Information supplied is believed to be accurate but the Group assumes no responsibility for its accuracy or completeness, any error in or omission from it or for any use made of it. Users of this data sheet should check for themselves the Information and the suitability of the products for their purpose and not make any assumptions based on information included or omitted. Liability for loss or damage resulting from any reliance on the Information or use of it (including liability resulting from negligence or where the Group was aware of the possibility of such loss or damage arising) is excluded. This will not operate to limit or restrict the Group's liability for death or personal injury resulting from its negligence. SPC MULTICOMP is the registered trademark of the Group. © Premier Farnell plc 2008.

TOLERANCES:
UNLESS OTHERWISE SPECIFIED, DIMENSIONS ARE FOR REFERENCE PURPOSES ONLY.

DRAWN BY:	DATE:
Ramya	15/11/08
CHECKED BY:	DATE:
Suresh	15/11/08
APPROVED BY:	DATE:
Farnell	29/11/08

DRAWING TITLE:			
2.54mm Plug - DIN41612, Double Row			
SIZE	DWG NO.	ELECTRONIC FILE	REV
A	M10001803	1661145-TDS_DWG	A
SCALE: NTS		U.O.M.: mm	SHEET: 2 OF 3



PART NO.

41612-32AB - Series

REVISIONS

ECN #	REV	DESCRIPTION	DRAWN	DATE	CHECKD	DATE	APPRVD	DATE
-	A	RELEASED	Ramya	15/11/08	Suresh	15/11/08	Farnell	29/11/08

Part Number Explanation:

41612

32

AB

-

MS

Number of Positions

Double Rows

Male

Double Rows : AB = A, B Row.

Male : MS = Male Straight and MR = Male Right Angle.

<http://www.farnell.com>

<http://www.newark.com>

<http://www.cpc.co.uk>

This data sheet and its contents (the "Information") belong to the Premier Farnell Group (the "Group") or are licensed to it. No licence is granted for the use of it other than for information purposes in connection with the products to which it relates. No licence of any intellectual property rights is granted. The Information is subject to change without notice and replaces all data sheets previously supplied. The Information supplied is believed to be accurate but the Group assumes no responsibility for its accuracy or completeness, any error in or omission from it or for any use made of it. Users of this data sheet should check for themselves the information and the suitability of the products for their purpose and not make any assumptions based on information included or omitted. Liability for loss or damage resulting from any reliance on the Information or use of it (including liability resulting from negligence or where the Group was aware of the possibility of such loss or damage arising) is excluded. This will not operate to limit or restrict the Group's liability for death or personal injury resulting from its negligence. SPC MULTICOMP is the registered trademark of the Group. © Premier Farnell plc 2008.

TOLERANCES:
UNLESS OTHERWISE SPECIFIED, DIMENSIONS ARE FOR REFERENCE PURPOSES ONLY.

DRAWN BY:	DATE:
Ramya	15/11/08
CHECKED BY:	DATE:
Suresh	15/11/08
APPROVED BY:	DATE:
Farnell	29/11/08

DRAWING TITLE:			
2.54mm Plug - DIN41612, Double Row			
SIZE	DWG NO.	ELECTRONIC FILE	REV
A	M10001803	1661145-TDS_DWG	A
SCALE: NTS		U.O.M.: mm	SHEET: 3 OF 3