

FS6BNCU

www.icmcorp.net

The FS6BNCU is our Universal "BNC" type connector that fits most RG6 standard, tri-shield, and quad-shield coaxial cable.



CPLCCT-SLM
Utilize This Tool

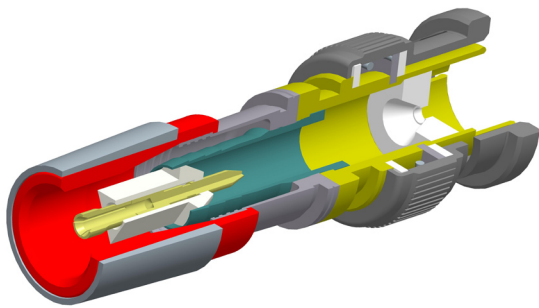

Specifications:

- 75 Ohm Construction
- DC-1 GHz > 26 dB Return Loss < 1.10 VSWR
- DC-2 GHz > 23 dB Return Loss < 1.16 VSWR
- DC-3 GHz > 23 dB Return Loss < 1.16 VSWR
- Cable Pullout Force Exceeding 65 in/lbs.
- Body Material Brass
- Body Material (Plating) Nickel

| Coax Sizing (inches) | Min ~ Max |
|----------------------|---------------|
| Center | .0399 ~ .0418 |
| Dielectric | .180 ~ .193 |
| Outer Jacket | .265 ~ .305 |

| Coax Sizing (mm) | Min ~ Max |
|------------------|-------------|
| Center | 1.01 ~ 1.06 |
| Dielectric | 4.57 ~ 4.90 |
| Outer Jacket | 6.73 ~ 7.75 |

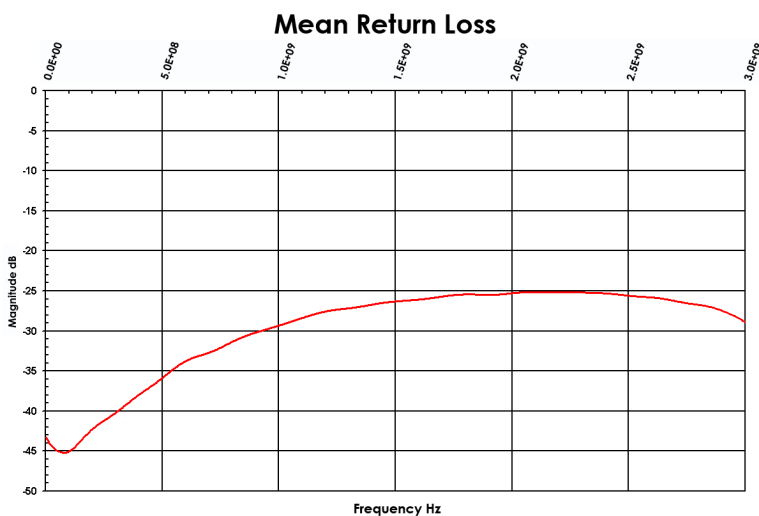

| Frequency (Hz) | dB |
|----------------|----------|
| 5 MHz | -43.4 dB |
| 15 MHz | -43.9 dB |
| 550 MHz | -34.7 dB |
| 750 MHz | -32.1 dB |
| 1000 MHz | -29.3 dB |
| 2000 MHz | -25.3 dB |
| 3000 MHz | -28.9 dB |

Lower return loss (dB) equates to less reflection through the connector while maintaining signal strength