

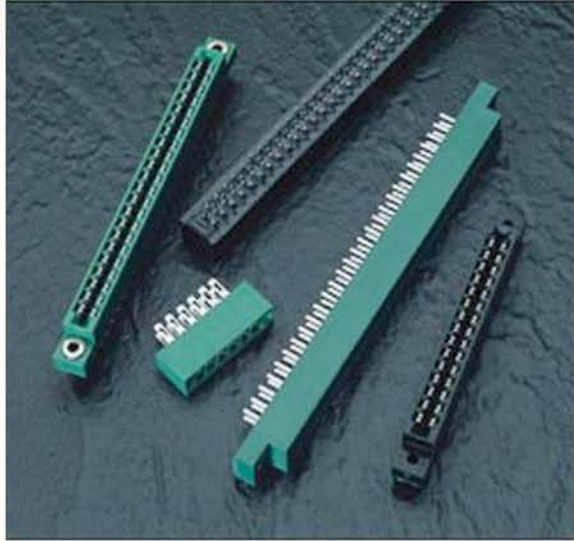

SERIES 306/316/356



Example Part Number 306 - 022 - 521 - 178

Series _____
 Total Number of Contacts _____
 Contact Code _____
 Mounting Options _____

Series	Insulator Colour	Card Slot Length
306	Green	Standard Length per MIL-C-21097
316	Green	.020 (0.51) Shorter than Standard
356	Black	Standard Length per MIL-C-21097

Total Number of Contacts	Contact Row
006, 007, ... 043	Centre Row

Contact Code	Description & Tail Size	Tail Length "G"
500	Wire Hole .087 x .015 (2.21 x 0.38)	.282 (7.16)
520	P.C. Tail .046 x .015 (1.17 x 0.38)	.213 (5.41)
521	P.C. Tail .037 x .015 (0.94 X 0.38)	.125 (3.18)

Mounting Option	Description
101	No Mounting Lugs
102	.128 (3.25) Dia. Mounting Holes
103	.116 (2.95) I.D. Floating Eyelets
104	.156 (3.96) Dia. Mounting Holes
107	M3-0.5 Metric Threaded Inserts
108	#4-40 Unified Threaded Inserts
158	.468 (11.89) Offset Card Guides
168	.344 (8.74) Offset Card Guides
178	In-Line Card Guides

Ordering Code Notes

- 1) All connector sizes up to 43 contacts centre row are available upon request
- 2) For contacts with overall tin plating, change the first digit of the contact code from 5 to 4

FEATURES

- UL Recognized
- .156 (3.96) Contact Spacing with Single Row
- Accepts .062 (1.57) Nominal Thickness P.C. Board
- Low Profile Insulator Body, .460 (11.68)
- Contact Termination Options include P.C. Tail & Wire Hole
- Large Variety of Mounting Options
- Pre-assembled Card Guides Available
- Accepts Between Contact and In-Contact Polarizing Keys

SPECIFICATIONS

- Insulator Material: Thermoplastic Polyester, UL 94V-0
- Contact Material: Copper, Nickel, Tin Alloy CA-725
- Contact Plating: Gold on the Mating Area, Tin on the Contact Tails, Nickel Underplate
- Current Rating: 5 Amperes Continuous
- Contact Resistance: 10 Milliohms Maximum
- Dielectric Withstanding Voltage: 1800 V AC rms at Sea Level Between Adjacent Contacts
- Insulation Resistance: 5000 Megohms Minimum
- Operating Temperature: -65 to +105 Degrees C
- Insertion Force: 16 oz (4.45 N) Maximum per Contact when Tested with a .070 (1.78) Thick Gauge
- Withdrawl Force: 1 oz (0.28 N) Minimum per Contact when Tested with a .054 (1.37) Thick Gauge

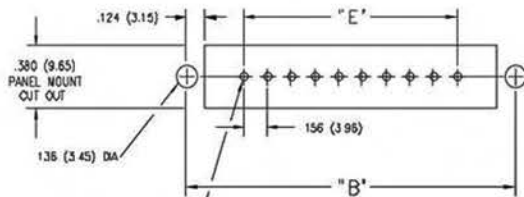
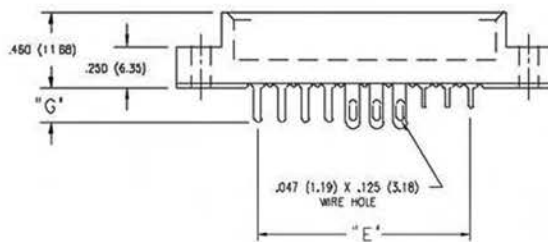
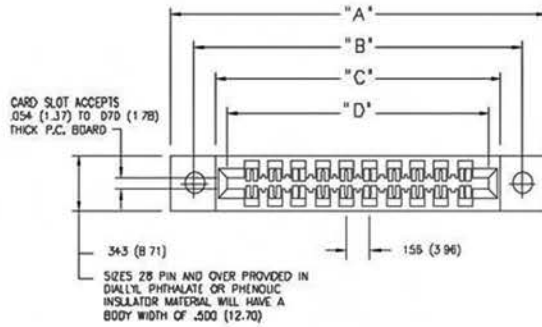

.050 (1.27) DIA +.004 (0.10) /-.000
FOR CODE S20 P.C. TAIL
.041 (1.04) DIA +.004 (0.10) /-.000
FOR CODE S21 P.C. TAIL
Φ .008 (0.20) DIA

CONNECTOR MOUNTING PATTERN

IN-CONTACT
POLARIZING KEY
P/N 338-240-328



BETWEEN CONTACT
POLARIZING KEY
P/N 306-240-318

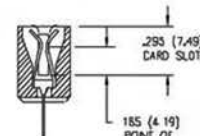

SECTION THROUGH CONTACT POSITION

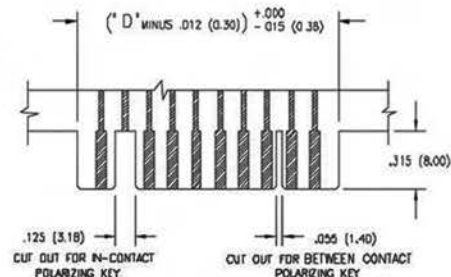

CUT OUT FOR IN-CONTACT POLARIZING KEY

CUT OUT FOR BETWEEN CONTACT POLARIZING KEY

RECOMMENDED DAUGHTER BOARD

NUMBER OF CONTACTS	"A"		"B"		"C"		"D"		"E"
	Inch	(mm)	Inch	(mm)	Inch	(mm)	306,356	316	
Single							Inch (mm)	Inch (mm)	Inch (mm)
6	1.842	(46.79)	1.532	(38.91)	1.246	(31.65)	1.100 (27.94)	1.080 (27.43)	.780 (19.81)
8	2.154	(54.71)	1.844	(46.84)	1.558	(39.57)	1.412 (35.86)	1.382 (35.36)	1.092 (27.74)
10	2.466	(62.64)	2.156	(54.76)	1.870	(47.50)	1.724 (43.79)	1.704 (43.28)	1.404 (35.66)
12	2.778	(70.56)	2.468	(62.69)	2.182	(55.42)	2.036 (51.71)	2.016 (51.21)	1.716 (43.59)
15	3.246	(82.45)	2.936	(74.57)	2.650	(67.31)	2.504 (63.60)	2.484 (63.09)	2.184 (55.47)
18	3.714	(94.34)	3.404	(86.46)	3.118	(79.20)	2.972 (75.49)	2.952 (74.98)	2.652 (67.36)
22	4.338	(110.19)	4.028	(102.31)	3.742	(95.05)	3.596 (91.34)	3.576 (90.83)	3.276 (83.21)
25	4.806	(122.07)	4.496	(114.20)	4.210	(106.93)	4.064 (103.23)	4.044 (102.72)	3.744 (95.10)
28	5.274	(133.96)	4.964	(126.09)	4.678	(118.82)	4.532 (115.11)	4.512 (114.60)	4.212 (106.98)
30	5.596	(141.88)	5.276	(134.01)	4.990	(126.75)	4.844 (123.04)	4.824 (122.53)	4.524 (114.91)
36	6.522	(165.66)	6.212	(157.78)	5.926	(150.52)	5.780 (146.81)	5.760 (146.30)	5.460 (138.68)
40	7.146	(181.51)	6.836	(173.63)	6.550	(166.37)	6.404 (162.66)	6.384 (162.15)	6.084 (154.53)
43	7.614	(193.40)	7.304	(185.52)	7.018	(178.26)	6.872 (174.55)	6.852 (174.04)	6.552 (166.42)

Dimensions of Other Connector Sizes are Listed