

Anna-40-7 series



Ordering number	C11716		
Description	C11716_Anna-40-7-S-OSL		
Family	Anna-40-7	FWHM	degrees
Type	Lens	Efficiency	-
LED	Oslon SSL 80	cd/lm	-
Color	Transparent	Gerber File	Available
Diameter	40 mm		
Height	10.7 mm		
Style	Round		
Optic Material	PMMA		
Holder Material	-		
Fastening	-		
Status	Ready		



Ordering number	C11717		
Description	C11717_Anna-40-7-M-OSL		
Family	Anna-40-7	FWHM	degrees
Type	Lens	Efficiency	-
LED	Oslon SSL 80	cd/lm	-
Color	Transparent	Gerber File	Available
Diameter	40 mm		
Height	10.7 mm		
Style	Round		
Optic Material	PMMA		
Holder Material	-		
Fastening	-		
Status	Ready		



Ordering number	C11718		
Description	C11718_Anna-40-7-W-OSL		
Family	Anna-40-7	FWHM	degrees
Type	Lens	Efficiency	-
LED	Oslon SSL 80	cd/lm	-
Color	Transparent	Gerber File	Available
Diameter	40 mm		
Height	10.7 mm		
Style	Round		
Optic Material	PMMA		
Holder Material	-		
Fastening	-		
Status	Ready		

D

C

B

A

4

4

3

3

2

2

1

1

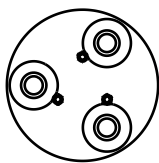

Anna-3

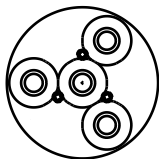

Anna-4

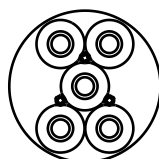

Anna-5

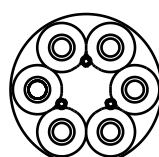

Anna-6

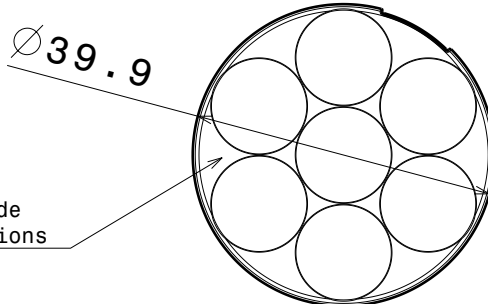
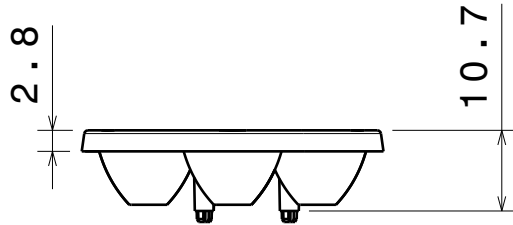

Anna-7

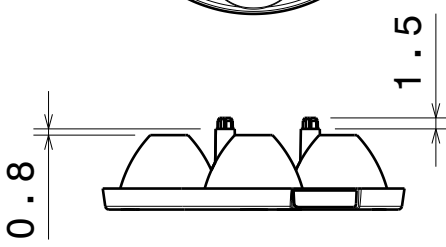

Same top side in all versions

Same location pin-circle in all versions

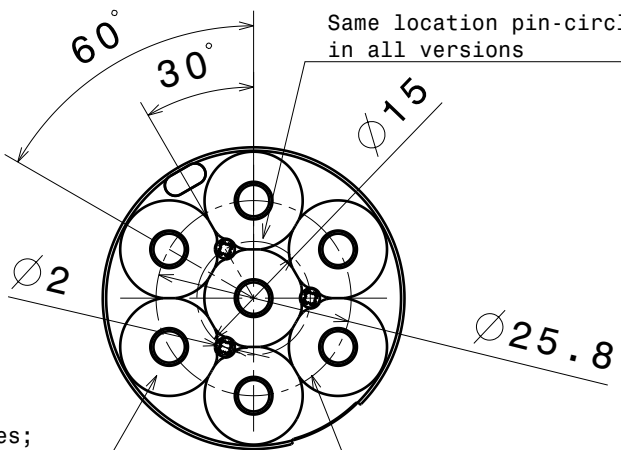

Number of cones varies; 3, 4, 5, 6 and 7pcs on bottom side depending the version.

Same led-circle in all versions

Material: PMMA

Versions:

- Anna-3-S
- Anna-3-M
- Anna-3-W
- Anna-4-S
- Anna-4-M
- Anna-4-W
- Anna-5-S
- Anna-5-M
- Anna-5-W
- Anna-6-S
- Anna-6-M
- Anna-6-W
- Anna-7-S
- Anna-7-M
- Anna-7-W

This drawing is our property. It can't be reproduced or communicated without our written agreement.



L T F e e i n

DRAWING TITLE

Datasheet Anna40-series Lens

DRAWN BY p DATE 12.10.2010

CHECKED BY s n DATE 12.10.2010

DESIGNED BY hh DATE 30.07.2010

SIZE	DRAWING NUMBER	REV
A4	-	1
SCALE	1:1	WEIGHT (g)
		SHEET 1/1

D

A