

REGAL WEALTH ENGINEERING LIMITED

ADD: SUZHOU REPRESENTATIVE OFFICE, 0203A1 1A SINGA PLAZA JINJIHU ROAD SUZHOU INDUSTRIAL PARK, P.R.CHINA
 TEL: 86-512-62532393 FAX:86-512-62532690

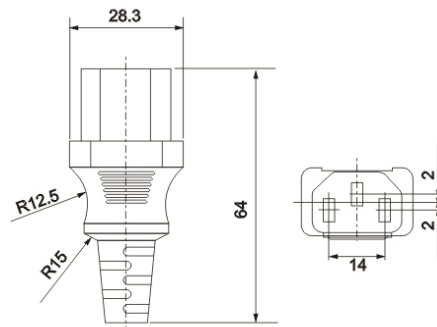
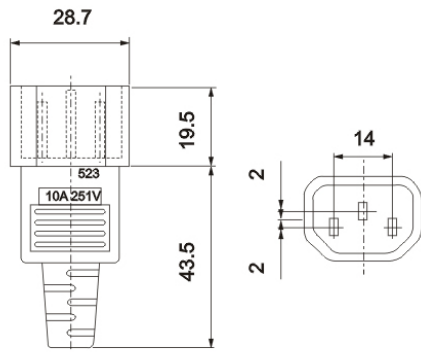

CERTIFICATE OF RoHS COMPLIANCE

UKM2.5SPLITTER has been manufactured from materials that are compliant with the UK (EU) RoHS requirements.

The materials in our power cords range have been independently tested by an appropriate third party and we retain these records and intend to repeat such tests on an ongoing basis as part of our quality control procedures. Testing methods include:

- EPA method 3050B:1996 other acid digestion
- BSEN1122: 2001 method B other acid digestion
- EPA method 3052B:1996 other acid digestion
- EPA method 3060 & EPA 7196A:1992
- Atomic Absorption Spectrometer/ Inductively coupled Plasma Atomic Emission Spectrometer (ICP+AES) UV-VIS Spectrophotometer

End 1: IEC Cold Connector Plug (C14) black

Fuse: N/A

Cable: HO5VV-F 3x1,00 black 1,50mts to splitter to 2 x 0.50mts HO5VV-F 3x1,00 black

End 2: IEC Cold Connector (C13) black

Approvals:



Picture relevant dimensions for illustrative purposes only

裕诚工程有限公司 REGAL WEALTH ENGINEERING LIMITED	Production Number	RWPL10202R	Rev
	Interim NO.		A

Dimensions of plugs and connectors may differ from those illustrated. Other approved bodies' approvals may be substituted.