

PV7 Series

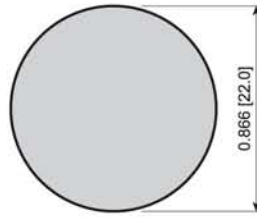

Suggested Panel Cutout



Maximum Panel Thickness:
Momentary Version: 0.315 [8.0mm]
Maintained Version: 0.472 [12.0mm]

FEATURES:

- Vandal and Water Resistant
- Long Life Expectancy

SPECIFICATIONS:

RATING: 2A 48VDC
ILLUMINATION BASE RATING:
 Red, Yellow, and Orange: 20mA 1.8V
 Blue, Green, and White: 20mA 2.8V
TEMPERATURE: -20°C to 55°C
CONTACT RESISTANCE: 50mΩ Max.
INSULATION RESISTANCE: 1,000MΩ Min.
DIELECTRIC STRENGTH: 2,000VAC
MECHANICAL LIFE: 1,000,000 Cycles
ELECTRICAL LIFE: 50,000 Cycles

MATERIALS:

BUTTON: Stainless Steel
 Nickel Plated Brass
BODY: Stainless Steel
 Nickel Plated Brass
BASE: PBT

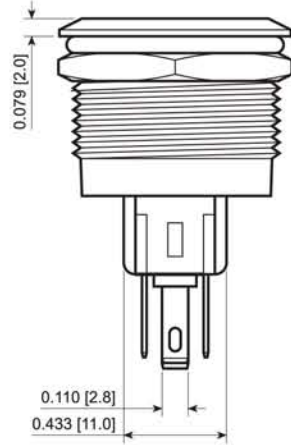
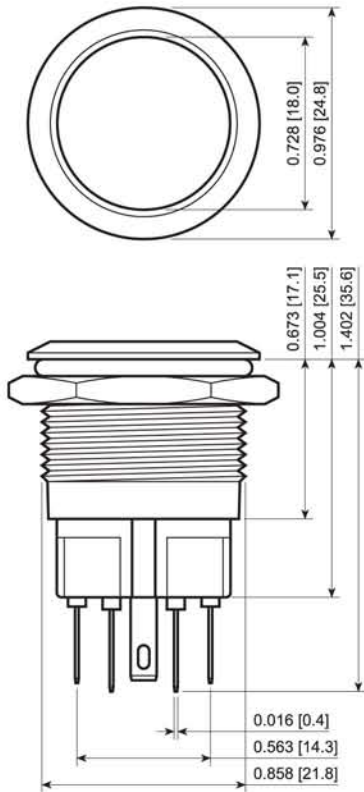

Illumination Options

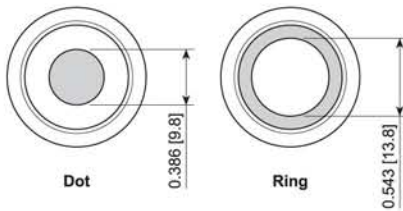

Maintained Version Dimensions

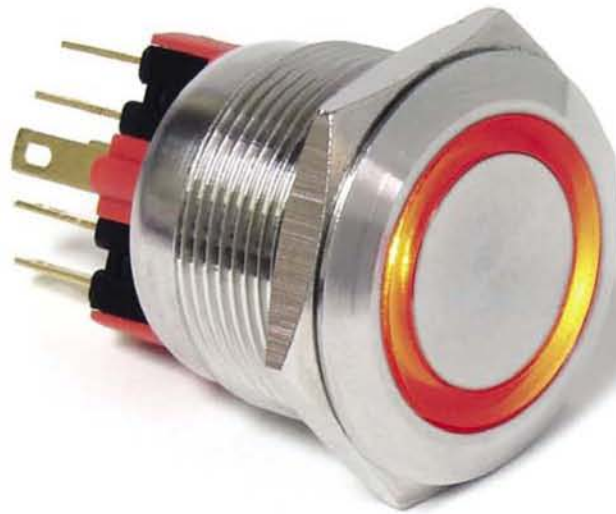
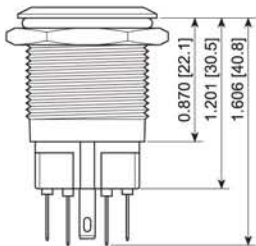

PV7F2Y0SS-311

SPECIFICATIONS SUBJECT TO CHANGE WITHOUT NOTICE

| Series | Actuator Options | Terminal Function | Rating | Body Finish | Actuator Finish | Contact Material | Lens Style | Lens Color | Illumination Voltage |
|--------|------------------|---|--------------|-----------------------------------|-----------------------------------|---------------------------|---------------------|---|--|
| PV7 | F - Flat | 2 Pole: Y - 1P Off-(On) / 1P On-(Off) T - 1P Off-On / 1P On-Off | 0 - 2A 48VDC | N - Nickel S - Stainless Steel | N - Nickel S - Stainless Steel | None - Silver G - Gold | 2 - Dot 3 - Ring | 0 - White 1 - Red 2 - Orange 3 - Green 4 - Blue 5 - Yellow | 1 - Base Voltage 3 - 6V 4 - 12V 5 - 24V 6 - 125V 7 - 250V |

Notes:
 Additional material, illumination and marking options are available. Please ask your sales person.

For Illuminated Switches Only

EXAMPLE PART NUMBERS:

PV7F2T0SS-344 1P Off-On/1P On-Off
 Flat Actuator, Blue Ring Illumination, 12V

PV7F2Y0SS 1P Off-(On)/1P On-(Off)
 Flat Actuator

PV7F2Y0SS-241 1P Off-(On)/1P On-(Off)
 Flat Actuator, Blue Dot Illumination, 2.8V

PV7F2Y0SS-313 1P Off-(On)/1P On-(Off)
 Flat Actuator, Red Ring Illumination, 6V

PV7F2Y0SS-351 1P Off-(On)/1P On-(Off)
 Flat Actuator, Yellow Ring Illumination, 1.8V