



## Features

### •Secure locking, easy insertion

The combination of terminal and housing provides easy mating onto the male tab. Unmating is also easy, by holding the housing while pulling, the contact lock spring is disengaged by the taper inside the housing. Should you accidentally pull the wire, the locking mechanism ensure that disengagement does not take place.

### •Stable contact performance

The contact is designed with a large contact area to give stable performance, even when high current is applied.

### •Mis-insertion prevention mechanism and housing lance

Inside the housing is a stopper that prevents mis-insertion, which ensures that someone will not mistakenly insert a contact in the housing. What's more, use of a housing lance means that only slight force is needed to insert a contact, even though the contact is held firmly in place.

## Specifications

- Current rating: 25A AC, DC(#250 + AWG #10)
- Voltage rating: 250V AC, DC
- Temperature range: -40°C to +105°C
- Contact resistance: Initial value/ 3m Ω max.  
After environmental testing/ 6m Ω max.
- Insulation resistance: 1,000M Ω min.
- Withstanding voltage: 2,000V AC/ minute
- Applicable wire: #110...AWG #24 to #16  
#187...AWG #26 to #14  
#205...AWG #22 to #14  
#250...AWG #22 to #10
- Applicable Tab: #110 Tab 0.5mm(.020") thick  
#187 Tab 0.5mm(.020")/0.8mm(.031") thick  
#205 Tab 0.5mm(.020")/0.8mm(.031") thick  
#250 Tab 0.8mm(.031") thick

\*Contact JST for details.

## Standards

- Recognized E60389
- 1 Certified LR20812
- 2 R9850196

## Contact

### #110 Series

**SPS-01T-110**

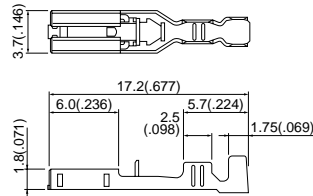

**SPS-41T-110**

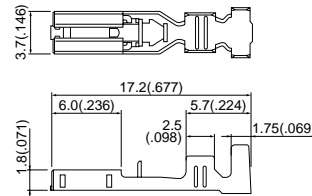

### #187 Series

**SPS-01T-187**...for 0.5mm(.020")  
thick tabs

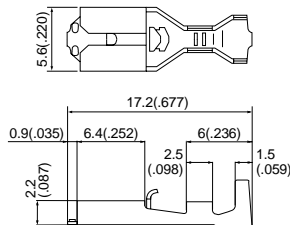

**SPS-51T-187**...for 0.5mm(.020")

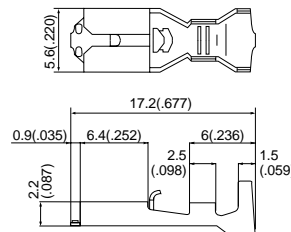

**SPS-82T-187**...for 0.5mm(.020")

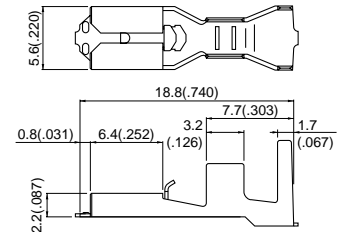

**SPS-01T-187-8**...for 0.8mm(.031")

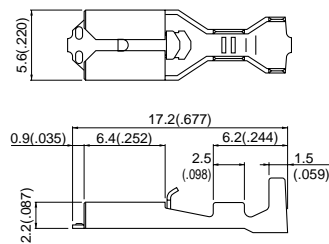

**SPS-51T-187-8**...for 0.8mm(.031") thick

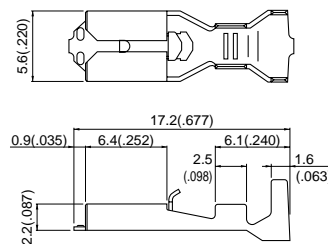

### <Flag type>

**SFPS-41T-187**...for 0.5mm(.020")

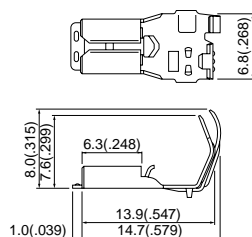

**SFPS-41T-187-8**...for 0.8mm(.031") thick

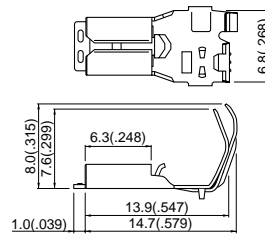

# PS CONNECTOR

## Contact

### #205 Series

**SPS-21T-205**...for 0.8mm(.031") thick

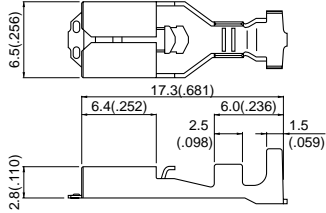

**SPS-21T-205-5**...for 0.5mm(.020")

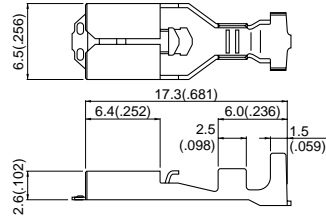

**SPS-51T-205**...for 0.8mm(.031")

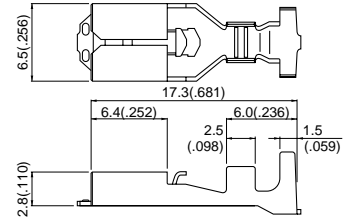

### #250 Series

**SPS-21T-250**

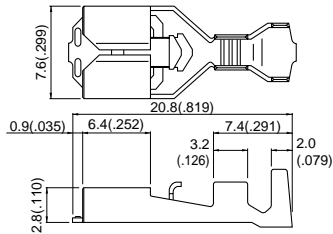

**SPS-61T-250**

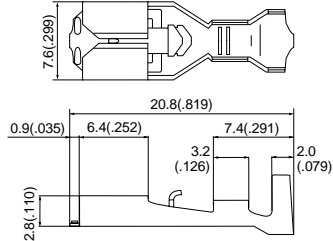

**SPS-91T-250**

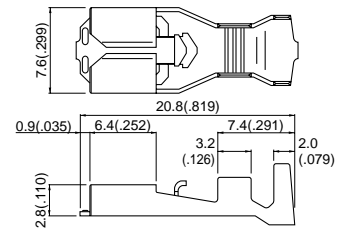

### <Flag type>

**SFPS-61T-250**

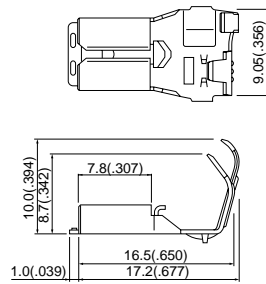

**SFPS-91T-250**

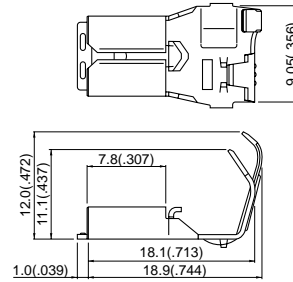

## Contact

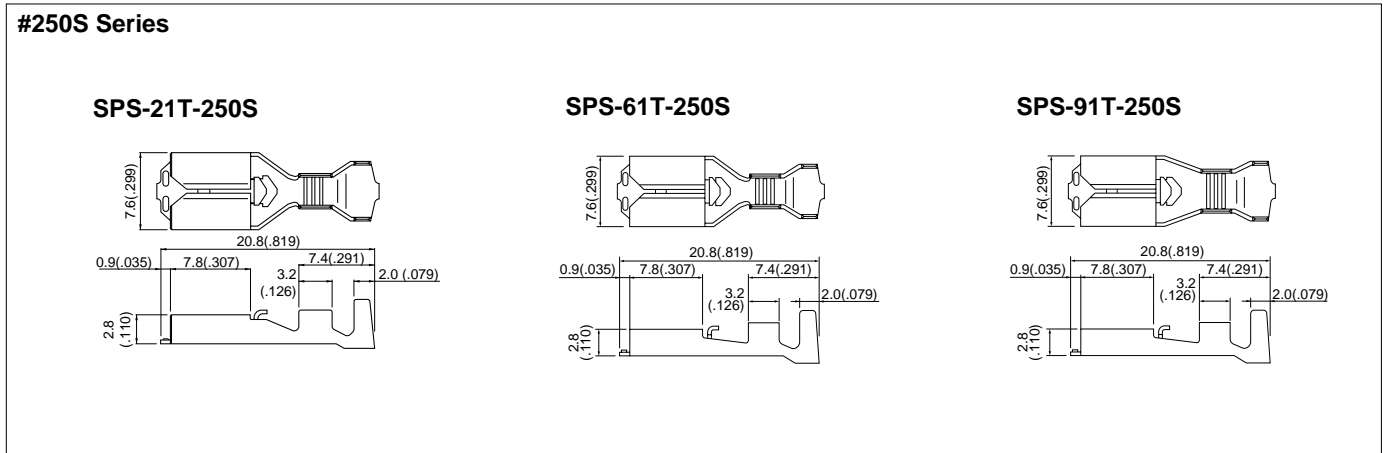

Series	Model No.	Applicable wire			Qty / reel
		mm <sup>2</sup>	AWG #	Insulation O.D.mm(in.)	
#110	SPS-01T-110	0.21 to 0.5	24 to 20	1.0 to 2.5(.039 to .098)	10,000
	SPS-41T-110	0.5 to 1.25	20 to 16	1.9 to 3.4(.075 to .134)	10,000
#187	for 0.5mm(.020") thick tabs SPS-01T-187	0.13 to 0.5	26 to 20	1.3 to 3.4(.051 to .134)	10,000
	SPS-51T-187	0.5 to 2.0	20 to 14	1.9 to 3.6(.075 to .142)	7,500
	SPS-82T-187	0.75+0.75 to 1.25+1.25	18+18 to 16+16	2.1+2.1 to 2.9+2.9(.083+.083 to .114+.114)	3,500
	for 0.8mm(.031") thick tabs SPS-01T-187-8	0.13 to 0.5	26 to 20	1.3 to 3.4(.051 to .134)	10,000
#187 flag	for 0.5mm(.020") thick tabs SFPS-41T-187	0.3 to 1.25	22 to 16	1.7 to 3.4(.067 to .134)	5,000
	for 0.8mm(.031") thick tabs SFPS-41T-187-8	0.3 to 1.25	22 to 16	1.7 to 3.4(.067 to .134)	5,000
#205	for 0.8mm(.031") thick tabs SPS-21T-205	0.3 to 0.75	22 to 18	1.5 to 3.1(.059 to .122)	5,000
	for 0.5mm(.020") thick tabs SPS-21T-205-5	0.3 to 0.75	22 to 18	1.5 to 3.1(.059 to .122)	5,000
	for 0.8mm(.031") thick tabs SPS-51T-205	0.5 to 2.0	20 to 14	1.9 to 3.6(.075 to .142)	5,000
#250	SPS-21T-250	0.3 to 0.75	22 to 18	1.5 to 3.1(.059 to .122)	5,000
	SPS-61T-250	0.75 to 2.0	18 to 14	2.1 to 3.9(.083 to .154)	5,000
	SPS-91T-250	2.0 to 5.5	14 to 10	3.0 to 4.7(.118 to .185)	4,000
#250 flag	SFPS-61T-250	0.75 to 2.0	18 to 14	2.1 to 3.9(.083 to .154)	3,000
	SFPS-91T-250	3.5 to 5.5	12 to 10	4.0 to 5.2(.157 to .205)	2,000
#250S	SPS-21T-250S	0.3 to 0.75	22 to 18	1.5 to 3.1(.059 to .122)	5,000
	SPS-61T-250S	0.75 to 2.0	18 to 14	2.1 to 3.9(.083 to .154)	5,000
	SPS-91T-250S	2.0 to 5.5	14 to 10	3.0 to 4.7(.118 to .185)	4,000

**Material and Finish**

Brass, tin-plated

# PS CONNECTOR

## Housing

### #110 Series

#### PS-110

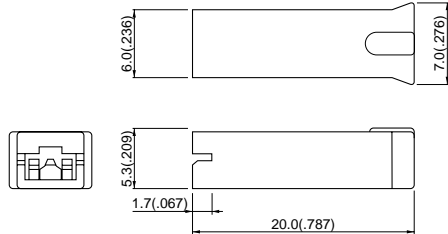

### #187 Series

#### PS-187

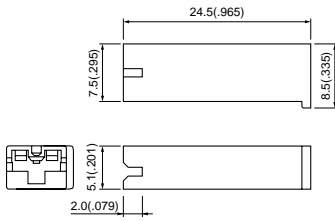

#### PS-187-2A-10

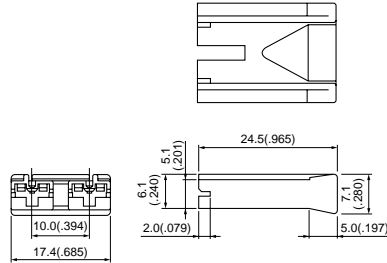

#### PS-187-2A-15

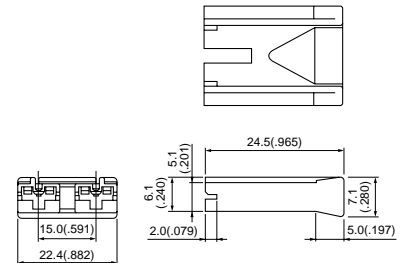

#### PS-187-2A-17.8

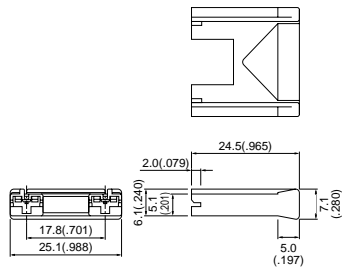

#### PS-187-2B

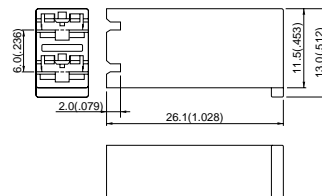

#### PS-187-2B-6.75

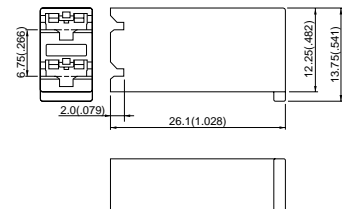

#### PS-187-2B1

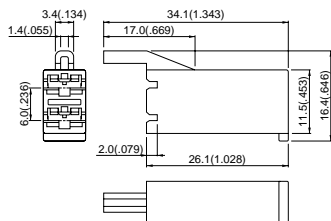

#### PS-187-4B

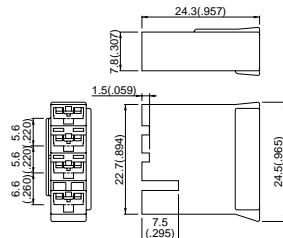

## #187 Series

**PS-187-2V**



**PS-187-3V**

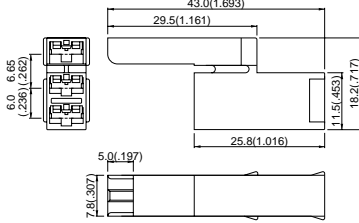

**PS-187-8-T-H**

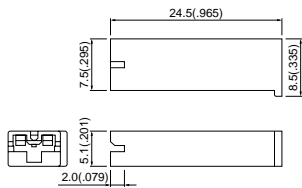

**PS-187-2A-16-8-T-H**

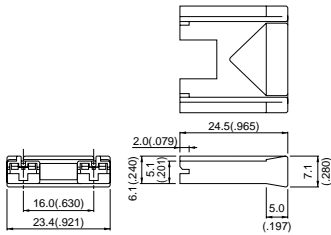

**PS-187-2B-8-T-H**

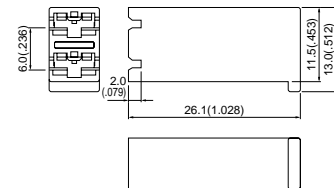

**PS-187-2B1-8-T-H**

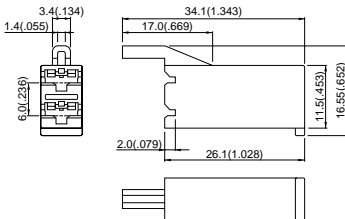

**PS-187-2V-8-T-H**

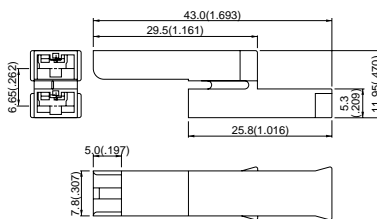

**PS-187-3V-8-T-H**

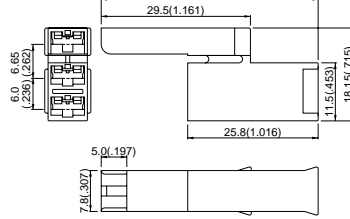

## #250S Series

**NPS-250-A**

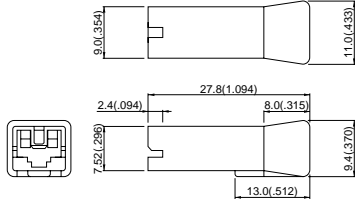

## #250 Series

**PS-250**

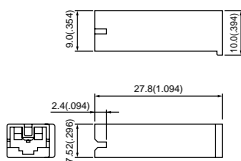

**PS-250-A**

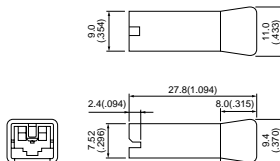

**PS-250-2B**

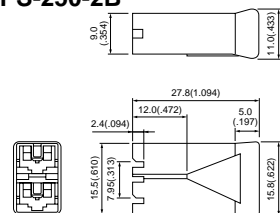

# PS CONNECTOR

## #250 Series

### PS-250-2A-15

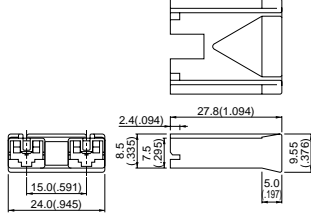

## One-touch sleeve

### FPS-187

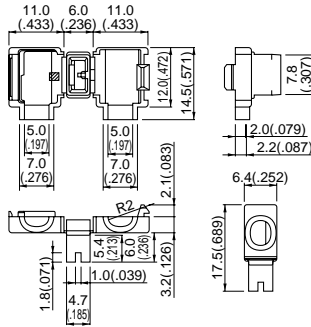

### FPS-250

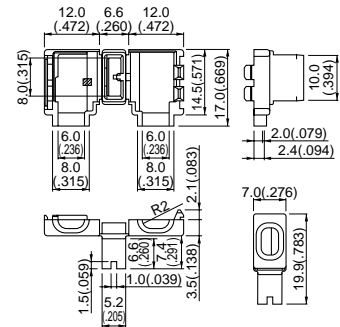

Series	Model No.	Q'ty / bag	Applicable terminal	
#110	PS-110	1,000	SPS-01T-110, SPS-41T-110	
	PS-187	1,000		
	PS-187-2A-10	1,000		
	PS-187-2A-15	500		
	PS-187-2A-17.8	500		
	PS-187-2B	500		
	PS-187-2B-6.75	500		
	PS-187-2B1	500		
	PS-187-4B	500		
	PS-187-2V	500		
	PS-187-3V	500		
	*PS-187-8-T-H	1,000		
	*PS-187-2A-16-8-T-H	500		
	*PS-187-2B-8-T-H	500		
*PS-187-2B1-8-T-H	500			
*PS-187-2V-8-T-H	500			
*PS-187-3V-8-T-H	500			
#250S	NPS-250-A	1,000	SPS-21T-250S SPS-61T-250S SPS-91T-250S	
	#250	PS-250	1,000	SPS-21T-250 SPS-61T-250 SPS-91T-250
		PS-250-A	500	
PS-250-2B		500		
One-touch sleeve	PS-250-2A-15	500	SFPS-41T-187 SFPS-61T-250	
	FPS-187	500		
	FPS-250	500		

### Material and Finish

Nylon 66, UL94V-0, natural (white)  
UL94V-2, gray <\*-marked housing...for 0.8mm(.031") thick tabs>

Note: FPS-187 and FPS-250 are UL recognized with File No. E55167, but not CSA certified.

## Applicable tab

#110...for 0.5mm (.020")

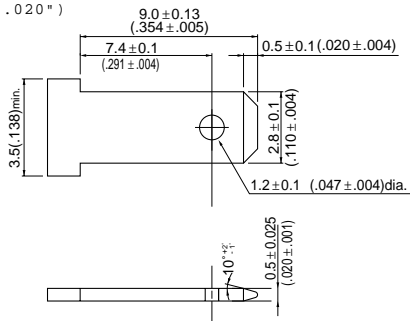

#187...for 0.5mm (.020")

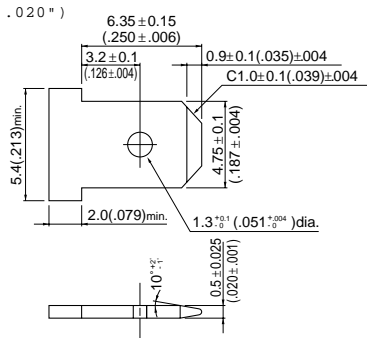

#187...for 0.8mm (.031") thick tabs

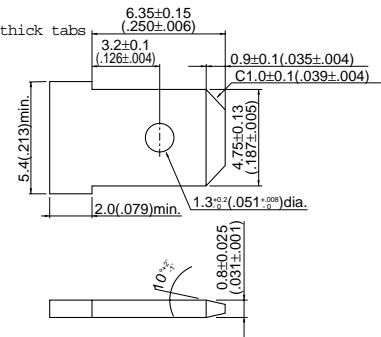

#205...for 0.8mm (.031") thick

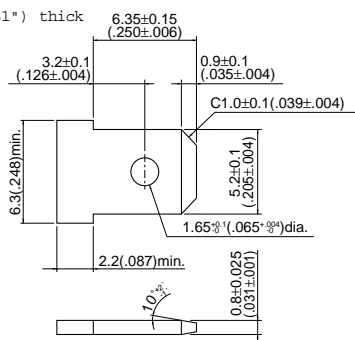

#250...for 0.8mm (.031") thick

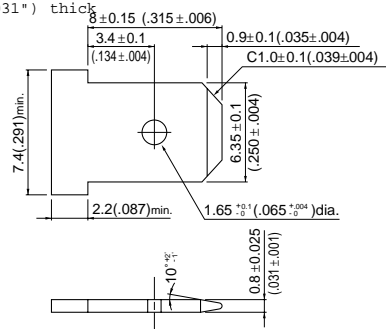

Note: Make sure there are no unneeded ribs or other protuberances on tab surfaces.