

Solderless splices

BUTT

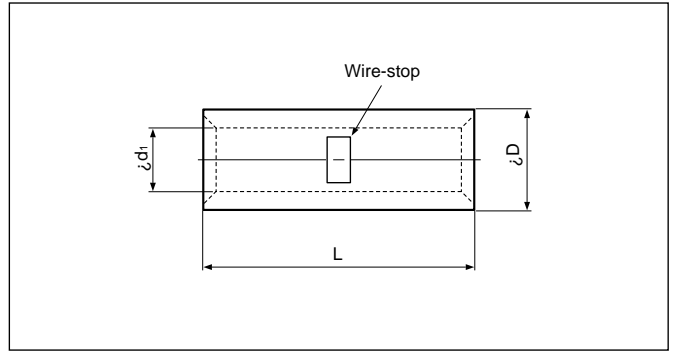

Non-insulated

File No.: E42024 LR20812

Actual

Refer to page 151 for actual size of the splice.

Applicable Wire AWG#(mm ²)	Part No.	Standard	Dimensions mm (in.)			Tool No.												Qty/box						
			L	ø D	ø d ₁	YHT-2210	YHT-8S	YA-1	YA-2	YA-4	YA-5	YPT-60-21	YPT-150-1	BCT-0514	BCT-860	BCT-8150	YET-60-1		YET-150-1	YET-300-1	F-4			
22 to 16 (0.25 to 1.65)	C-1.25		15.0 (.591)	3.3 (.130)	1.7 (.067)	0	0	0	0	0	0	0	0	0	0	0	0	0	0	0	0	0	0	1,000
16 to 14 (1.04 to 2.63)	C-2		15.0 (.591)	4.1 (.161)	2.3 (.091)	0	0	0	0	0	0	0	0	0	0	0	0	0	0	0	0	0	0	1,000
12 to 10 (2.63 to 6.64)	C-5.5		15.0 (.591)	5.4 (.213)	3.4 (.134)	0	0	0	0	0	0	0	0	0	0	0	0	0	0	0	0	0	0	500
8 (6.64 to 10.52)	C-8		21.0 (.827)	7.0 (.276)	4.5 (.177)	0	0	0	0	0	0	0	0	0	0	0	0	0	0	0	0	0	0	200
6 (10.52 to 16.78)	C-14		26.0 (1.024)	8.9 (.350)	5.8 (.228)	0	0	0	0	0	0	0	0	0	0	0	0	0	0	0	0	0	0	100
4 (16.78 to 26.66)	C-22		29.0 (1.142)	11.3 (.445)	7.7 (.303)	0	0	0	0	0	0	0	0	0	0	0	0	0	0	0	0	0	0	50
2 (26.66 to 42.42)	C-38		32.0 (1.260)	13.2 (.520)	9.4 (.370)	0	0	0	0	0	0	0	0	0	0	0	0	0	0	0	0	0	0	25
1/0 (42.42 to 60.57)	C-60		36.0 (1.417)	15.3 (.602)	11.4 (.449)	0	0	0	0	0	0	0	0	0	0	0	0	0	0	0	0	0	0	10
2/0 (60.57 to 76.28)	C-70		37.0 (1.457)	17.5 (.689)	13.3 (.524)	0	0	0	0	0	0	0	0	0	0	0	0	0	0	0	0	0	0	20
3/0 (76.28 to 96.3)	C-80		38.0 (1.496)	19.5 (.768)	14.5 (.571)	0	0	0	0	0	0	0	0	0	0	0	0	0	0	0	0	0	0	10
4/0 (96.3 to 117.2)	C-100		38.0 (1.496)	22.1 (.870)	16.4 (.646)	0	0	0	0	0	0	0	0	0	0	0	0	0	0	0	0	0	0	10
250 to 300MCM (117.2 to 152.05)	C-150		54.0 (2.126)	26.4 (1.039)	19.5 (.768)	0	0	0	0	0	0	0	0	0	0	0	0	0	0	0	0	0	0	10
350MCM (152.05 to 192.6)	C-180		57.0 (2.244)	28.5 (1.122)	21.0 (.827)	0	0	0	0	0	0	0	0	0	0	0	0	0	0	0	0	0	0	10
400MCM (192.6 to 242.27)	C-200		63.0 (2.480)	32.4 (1.276)	24.0 (.945)	0	0	0	0	0	0	0	0	0	0	0	0	0	0	0	0	0	0	10
600 to 650MCM (242.27 to 325)	C-325		72.0 (2.835)	37.0 (1.457)	28.0 (1.102)	0	0	0	0	0	0	0	0	0	0	0	0	0	0	0	0	0	0	10

Note:1) Delivery lead times may vary depending on the product. Contact JST for details.

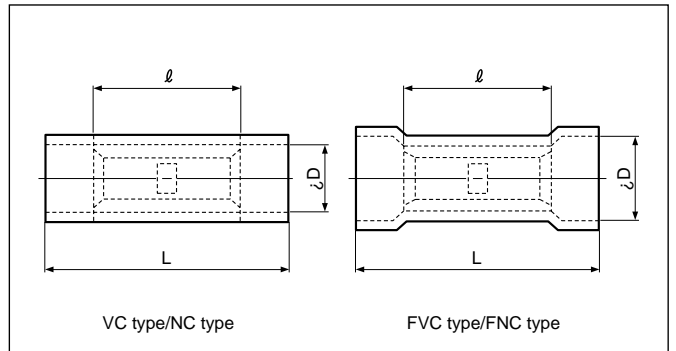
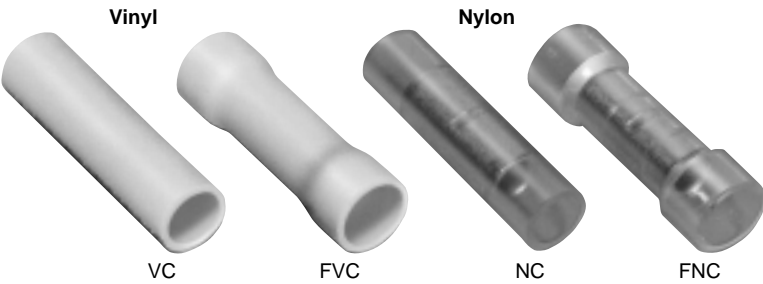

Vinyl or nylon insulated

File No.: E42024 LR20812

Actual

Refer to page 152 for actual size of the splice.

Applicable Wire AWG#(mm ²)	Part No.		Standard	Dimensions mm (in.)			Color	Tool No.						Qty/box		
	Vinyl	Nylon		L	ℓ	ø D		YNT-2216	YNT-1614	YNT-1210S	YA-1	YA-2	YA-4	BCT-0514	Vinyl	Nylon
22 to 16 *(0.25 to 1.65)	VC-1.25	NC-1.25		22.7 (.894)	15.0 (.591)	3.2 (.126)	0	0	0	0	0	0	0	0	1,000	500
	FVC-1.25	FNC-1.25				4.0 (.157)										
16 to 14 (1.04 to 2.63)	VC-2	NC-2		22.7 (.894)	15.0 (.591)	3.9 (.154)	0	0	0	0	0	0	0	1,000	500	
	FVC-2	FNC-2				4.5 (.177)										
12 to 10 (2.63 to 6.64)	VC-5.5	NC-5.5		26.7 (1.051)	15.0 (.591)	5.4 (.213)	0	0	0	0	0	0	0	500	500	
	FVC-5.5	FNC-5.5				6.8 (.268)										

Note:1) *The crimping will be more secure if the total cross-sectional area of the wire is at least 0.5 mm².
 Examples : If the cross-sectional area of the wire is 0.3mm², fold the wire in two when crimping the terminal.
 If the cross-sectional area of the wire is 0.5mm², crimp the terminal onto the wire as it is.
 2) Delivery lead times may vary depending on the product. Contact JST for details.