

Please note that the data given here has been taken from the online catalog. For comprehensive information and data, please refer to the user documentation at <http://www.download.phoenixcontact.com>. The General Terms and Conditions of Use apply to Internet downloads.

▶ Extract from the online catalog



Electronic housing consisting of: Housing shells left and right, front plate, transparent cover, metal foot catch and spring, open housing, 18-pos. (6 x 3 pos.), width: 17.5 mm, color: Light gray

The illustration shows the version ME MAX 17,5 2-2 KMGY with mounting rail bus connector plugged in

Order No.	2713612
Ord designation	ME MAX 17,5 3-3 KMGY
EAN	4017918917395
Pack	10 Pcs.
Customs tariff	85369010
Weight/Piece	0,06025 KG
Catalog page information	Page 138 (NTK-2005)

▶ Product notes

WEEE/RoHS-compliant since: 05/12/2005



IMPORTANT : This date is valid for Customers in Germany only. Date Format is MM/DD/YYYY. Please contact your local in-country Phoenix Contact location or designated business partner for a Logistics Compliant date in your area. In order to guarantee delivery of RoHS-Compliant product, please purchase Phoenix Contact parts from authorized Phoenix Contact representatives and distributors.

ME MAX 17,5 3-3 KMGY



▶ **Technical data**

General

Housing material	PA 6.6
Color	light gray

Dimensions / positions

Length	99 mm
Constructional height	114.5 mm
Width	17.5 mm
Number of positions	18

Technical data

Inflammability class acc. to UL 94	V0
------------------------------------	----

► Drawings

Explosion drawing

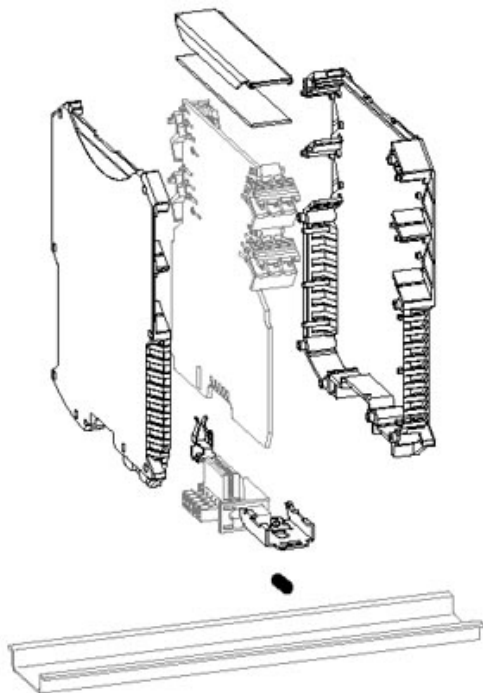

The illustration shows a version of the product
(open housing) with accessories

Dimensioned drawing

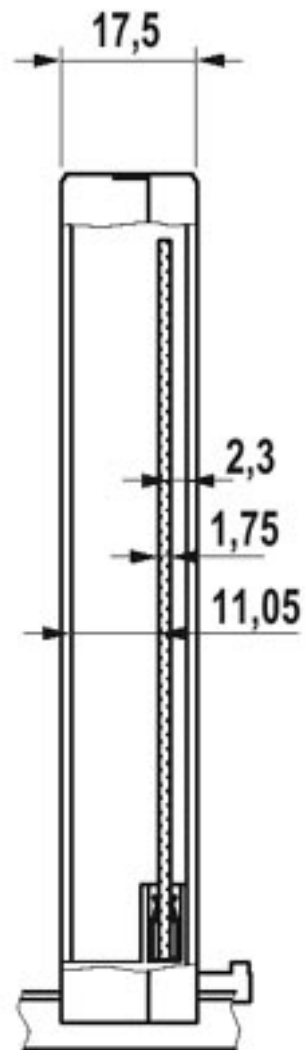
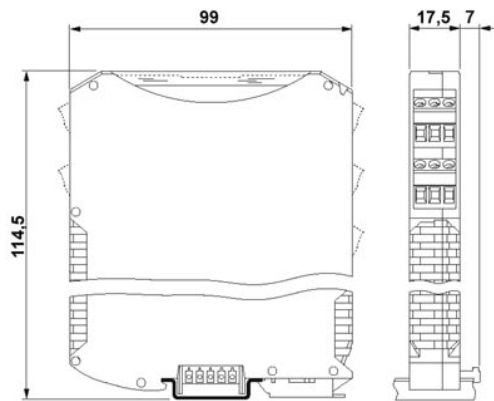

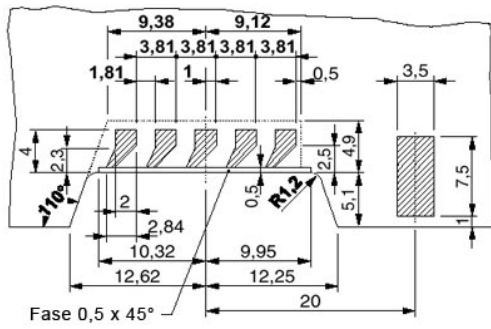

Detailed dimensional drawing of the mounting rail bus connector contact pads

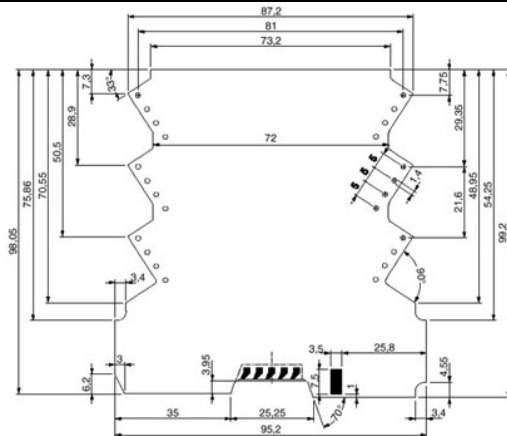

Dimensional drawing of the ME MAX 3-3 printed circuit board, for printed circuit terminal block connection (MKDSO), view: component side

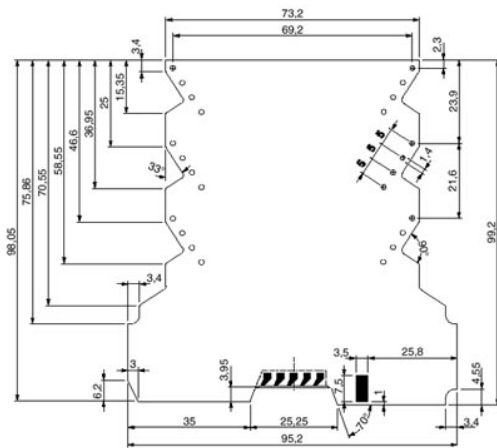

Dimensional drawing of the ME MAX 3-3 printed circuit board for plug connection (MSTBO), view: component side

► Accessories

Item	Designation	Description
General		
0813789	BMKLT 14X12 WH	Label sheet for laser printer, rounded label corners, sheet format: DIN A4, 1 sheet , labeling field: 14 x 12 mm, color: White
2713645	ME 17,5 TBUS 1,5/ 5-ST-3,81 KMGY	Bus connector, gold-plated contacts, for mounting on DIN rail, 5-pos.
2706959	ME MAX B-17,5 KMGY	Cover cap for unoccupied terminal points, color: Light gray
2713777	ME MAX LP SAMPLE MSTBO 2-2	PCB, for custom fitting for COMBICON connection system
2713735	MKDSO 2,5/ 3-6 SET KMGY	Kit consisting of COMBICON header and PCB terminal blocks for 6x3 positions (18-pos.), color: Light gray
2713748	MSTBO 2,5/ 3-6 ST SET KMGY	Kit consisting of COMBICON header and screw connectors for 6x3 positions (18-pos.), color: Light gray
Plug/Adapter		
2908294	ME FE-CONTACT	Functional earth ground contact, for intermediate elements.

► Address

PHOENIX CONTACT GmbH & Co. KG
Flachsmarktstr. 8
32825 Blomberg
Germany
Phone +49 5235 3 00
Fax +49 5235 3 41200
<http://www.phoenixcontact.com>
Phoenix Contact
Technical modifications reserved;