

## Series -5GM

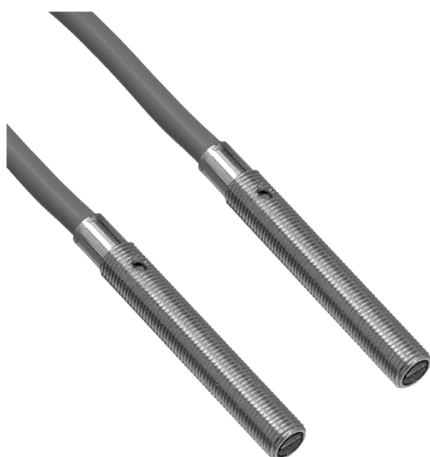

### Through beam sensor

- OBE250-5GM35-SE0
- OBE250-5GM35-SE1
- OBE250-5GM35-SE2
- OBE250-5GM35-SE3
- OBE250-5GM45-SE0-V3
- OBE250-5GM45-SE1-V3
- OBE250-5GM45-SE2-V3
- OBE250-5GM45-SE3-V3

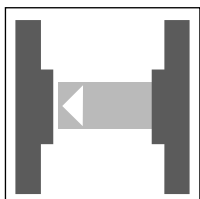

250 mm



### Features

- Very small housing
- Complete device, no amplifier needed
- High operating range
- Voltage range 10 ... 30 V DC, output current 100 mA short circuit protected
- Optical parts made of glass, easy cleaning
- Protection degree IP67

## Dimensions

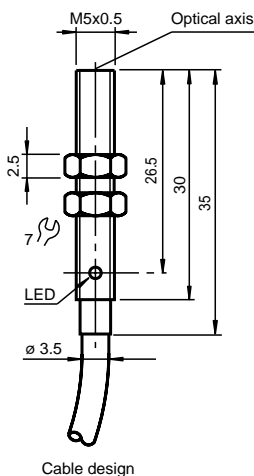

Cable design

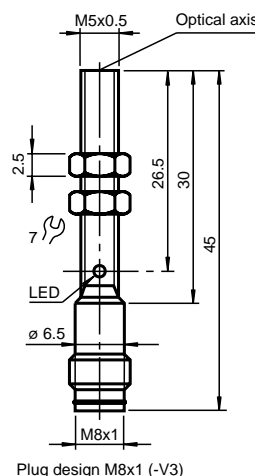

Plug design M8x1 (-V3)

Connectors, mounting accessories etc... see "accessories" section

e.g. connectors: V3-GM-5M-PUR (straight)  
V3-WM-E2-5M-PUR (angled)

## Electrical connection

E0:

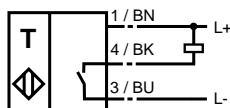

E1:

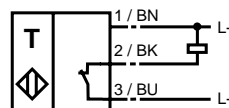

E2:

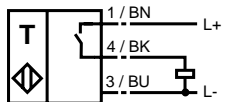

E3:

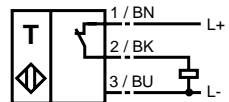

Emitter:

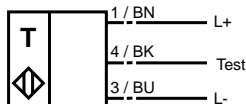

## Technical data

### Valid for the whole family

#### General specifications

Sensing range	0 ... 250 mm
Reference target	Receiver
Light type	IR-light 880 nm
Ambient light limit	≤ 10000 Lux sun light ≤ 3000 Lux halogen light
Standard conformity	EN 60947-5-2

#### Electrical specifications

Rated operational voltage	$U_e$ 10 ... 30 V DC , residual ripple 20 % $U_B$
No-load supply current	$I_0$ 15 mA (device)
Time delay before availability	$t_v$ 20 ms

#### Indicating/operating means

LED yellow Switching state, flushing: pre-fault indication

#### Output

Rated operational current	$I_e$ 100 mA , short circuit/overload protected
Switching frequency	$f$ ≤ 250 Hz
Switch-on delay	$t_{on}$ 3 ms

#### Input

Input type Emitter: 1 test input,  
not activated: < 4 V, activated: > 8 V or open

#### Ambient conditions

Ambient temperature 0 ... 55 °C (273 ... 328 K)

#### Mechanical specifications

Protection degree IP67 according to EN 60529

#### Material

Housing	V2A
Light exit	Scratch resistant mineral glass plate

### Version data

Model number	OBE250-5GM35-SE0	OBE250-5GM35-SE1
Output type	1 switch output E0, npn NO	1 switch output E1, npn NC
Connection type	2 m cable, 3 x 0,14 mm <sup>2</sup> , PVC	2 m cable, 3 x 0,14 mm <sup>2</sup> , PVC
Mass	76 g	76 g
Model number	OBE250-5GM35-SE2	OBE250-5GM35-SE3
Output type	1 switch output E2, pnp NO	1 switch output E3, pnp NC
Connection type	2 m cable, 3 x 0,14 mm <sup>2</sup> , PVC	2 m cable, 3 x 0,14 mm <sup>2</sup> , PVC
Mass	76 g	76 g
Model number	OBE250-5GM45-SE0-V3	OBE250-5GM45-SE1-V3
Output type	1 switch output E0, npn NO	1 switch output E1, npn NC
Connection type	V3 connector (M8 x 1), 3 pin	V3 connector (M8 x 1), 3 pin
Mass	18 g	18 g
Model number	OBE250-5GM45-SE2-V3	OBE250-5GM45-SE3-V3
Output type	1 switch output E2, pnp NO	1 switch output E3, pnp NC
Connection type	V3 connector (M8 x 1), 3 pin	V3 connector (M8 x 1), 3 pin
Mass	18 g	18 g

## Model number

OBE250-5GM35-SE0  
OBE250-5GM35-SE1  
OBE250-5GM35-SE2  
OBE250-5GM35-SE3  
OBE250-5GM45-SE0-V3  
OBE250-5GM45-SE1-V3  
OBE250-5GM45-SE2-V3  
OBE250-5GM45-SE3-V3

## Characteristic curves

### Characteristic response curve

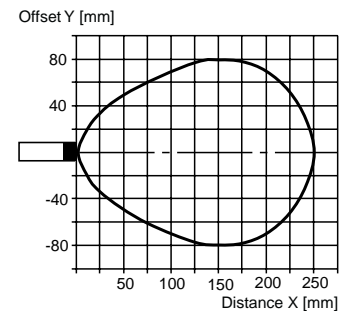

Permissible separation (offset) between the optical axis of the emitter and receiver.