

Cable Joints

Data Sheet



Shell Dimensions

Straight-through Joints				
Type	A	B	C	
			min	max
CM0 Range	200	35	5	20
CM1 Range	250	45	8	30
CM2 Range	320	60	10	34
CM3 Range	450	75	30	48
CM4 Range	550	100	40	66

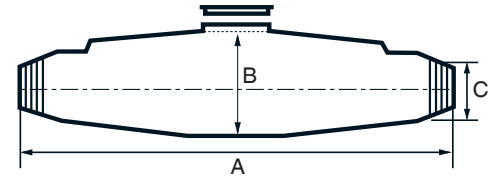

All shells are injection-moulded from high-impact polycarbonate to form clear, rigid and strong pairs which clip together easily and provide a robust seal to prevent resin leakage.

Mechanical Connectors

Joint Type	Mechanical Connectors included
CM0 Range	4 x MC1/0 & Allen Key
CM1 Range	4 x MC1/1 & Allen Key
CM2 Range	4 x MC1/2 & Allen Key
CM3 Range	4 x MC1/3 & Allen Key
CM4 Range	4 x MC1/3 & Allen Key



Mechanical Connectors - MC1 Range

Brass Connectors (set of 4) with Allen Key				
Core sizes mm ²	To max 10mm ²	To max 25mm ²	To max 50mm ²	To max 120mm ²
1.5 - 10	MC1/0	MC1/1	MC1/2	MC1/3
16 - 25	MC1/1	MC1/2	MC1/2	MC1/3
35 - 50	MC1/2	MC1/2	MC1/2	MC1/3
70 - 120	MC1/3	MC1/3	MC1/3	MC1/3

Please note that a Material Safety Data Sheet for Poluurethane Resin & Hardener is available for download as a separate file.

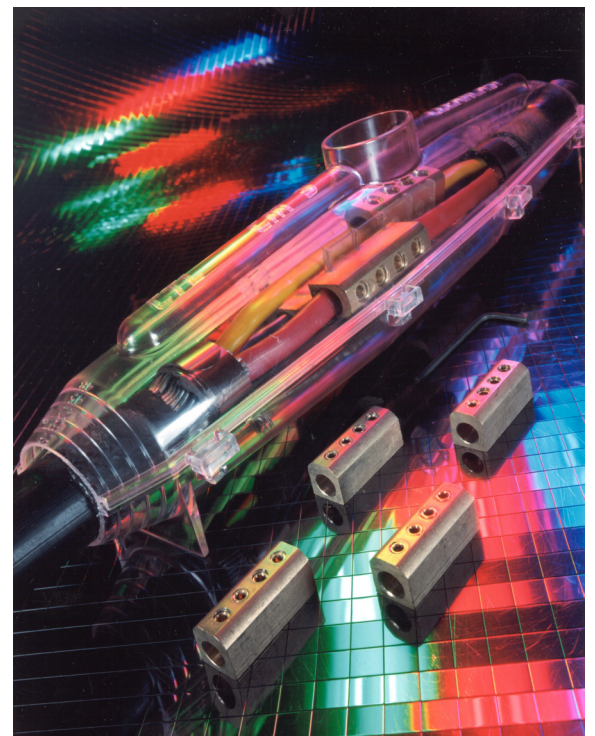



Features

- Two-part Polyurethane resin in protective aluminium foil.
- Mixing is performed in sealed conditions - no need for skin contact but safety gloves are provided.
- Controlled curing temperature designed to be compatible with PVC, XLPE, EPR, Polythene and PILC cables.
- Clear mixing instructions on every pack.
- Full Health & Safety labelling.
- Batch number & use-by-date on every pack.
- Designed to meet the requirements of BS 6910, BS7888, CENELEC HD623 S1 and EN50393:2006.
- The same well-proven high quality resin formula is used as standard throughout both the LV & MV ranges.



Specification	
<i>Mixed properties</i>	Pack designed to contain factory dispensed quantities of resin & hardener
<i>Specific gravity</i>	1.40 Resin, 1.22 Hardener
<i>Density (g/ml)</i>	1.36 mixed system
<i>Colour</i>	Cream (standard)
<i>Gel Time</i>	20-30 minutes at 21° C for 200g mass
<i>Peak Exotherm</i>	54-75° C depending upon volume and ambient temperature.
<i>Complete cure time</i>	at 23° C - 24 hours at 80° C - 1 hour
<i>Shelf life</i>	24 months when stored at 5° C - 15° C.
<i>Operating temperature</i>	-40° C to +100° C continuous, for cured product
<i>Thermal Conductivity</i>	>0.4w/mK
<i>Tensile strength</i>	45 MPa
<i>Electrical strength</i>	20kV/mm
<i>Health & safety</i>	Each pack contains mixing instructions and carries health and safety warnings. H&S (COSHH) Information Sheet available upon request
<i>Transportation</i>	No special labelling required for shipments by air, sea or road (UN No 2489, packaging group III)

Joint Type	Useable volume of pack
CM0 Range	180 ml
CM1 Range	350 ml
CM2 Range	825 ml
CM3 Range	1850 ml
CM4 Range	3825 ml

Resin Packs

Low Voltage Resin Cable Joints

Suitable for PVC or XLPE cable, 1kV

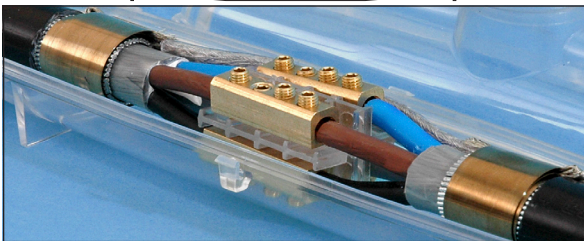
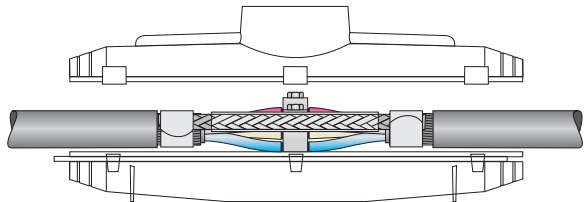

Supplied complete with 4 mechanical connectors & Allen Key.
Everything needed to complete a cable joint - all in one box!

The range of ProPower LV Resin cable joints represents the very best available in terms of design, quality, ease of use and relevant certification.

Injection Moulded Shells

Rigid and very strong, their snap-lock design forms an excellent seal and prevents egress of resin.

Mechanical Connectors

These have been especially designed to match the same range of cable sizes as the joints they are supplied with. Machined from solid brass, they are suitable for either copper or aluminium conductors. Two Allen screws for each core ensure a sound electrical performance and an Allen key is also provided with each kit to ensure that everything needed to join a cable is included in the one box.

Earth Braid (Not EX variants)

Offers significant advantages over "single wire type" earth continuity systems, which can fail if poorly positioned within wire armour cores that have "spread". The flat, soft braid ensures good electrical contact and is insulated for extra protection.

Constant Force Springs (Not EX variants)

Cable joints move and expand due to earth shift and heat from electrical current. Constant force springs react to this movement and maintain a sound electrical connection between the steel wire armouring and the earth continuity braid.

Core separators

Provide safe separation of cores and connectors.

Two-part resin

This long-proven resin formula is of such quality that it is equally suitable for both LV and MV applications and provides excellent adhesion to PVC, XLPE, polythene and paper cables. It is supplied in two-part easy-mix packaging, ensuring both convenience and safety.

Packaging

Pro Power joints are supplied in especially robust and rigid boxes to withstand stacking both in warehouses and in pallets. These boxes are also popular with jointers since they can be used as "mini workbenches".

Instructions

Detailed, clear and concise instruction sheets, mostly printed in full colour, ensure there is no ambiguity about safe jointing procedures.

Certification

To CENELEC HD 623.S1/DIN VDE 0278, now renamed EN50393:2006. (BS6910 and BS7888 standards are now obsolete.)

LV Joints for Armoured Cables c/w mechanical connectors and earth continuity kits

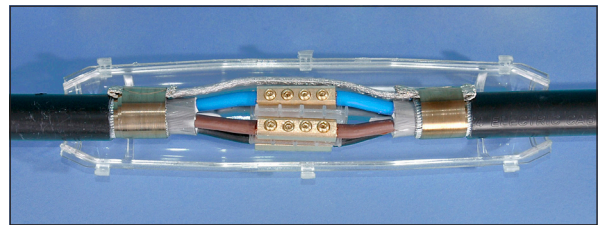

Quick Selection

No of cores	Armoured Cable size (mm ²)														
	1.5	2.5	4	6	10	16	25	35	50	70	95	120	150	185	240
2			A			B		C		D					E
3		A			B	C			D			E			Special
4		A			B	C			D			E			Special

LV Joints for Unarmoured Cables c/w mechanical connectors

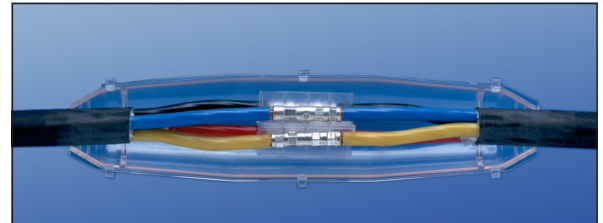

Quick Selection

No of cores	Unarmoured Cable size (mm ²)														
	1.5	2.5	4	6	10	16	25	35	50	70	95	120	150	185	240
2			AEX			BEX		CEX		DEX					EEX
3		AEX			BEX	CEX			DEX			EEX			Special
4		AEX			BEX	CEX			DEX			EEX			Special

Type	Order Code	1+	5+	10+
For armoured cable				
A				
B				
C				
D				
E				
For unarmoured cable				
AEX				
BEX				
CEX				
DEX				
EEX				