

LPX 40/60/110 ENCLOSURES

LPX 40 and LPX 60 • Cover Enclosure Kit

MATERIALS

- 1 Base plate
- 1 Cover plate
- 2 Cover screws M3 x 6mm long with star washer
- 4 Board screws M3 x 6mm long with spring washer
- 1 Nut M4
- 1 Washer M4 spring washer
- 1 Washer M4 star washer
- 1 Insulation sheet

NOTES

1. All dimensions are in mm and (inches).
2. Overall dimension:
LPX 40: 150 (5.9) x 98 (3.86) x 38 (1.5)
LPX 60: 150 (5.9) x 986 (3.86) x 50 (1.97)
3. Base plate has 3 sets of customer mountings-
 4x M3 inserts - maximum allowable screw penetration 3mm and
 2x 4mm clear holes plus 2 keyways, (see detail A).
 Side mountings - 2x M3 inserts - maximum allowable screw penetration 6mm
4. Ensure insulator is correctly fitted in base under PCB to maintain safety creepage and clearance distances.
5. Ensure base is firmly connected to supply earth via the earth stud marked: 

DIMENSIONS

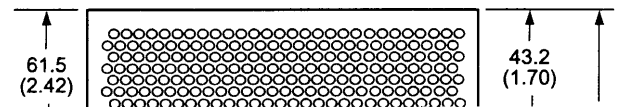
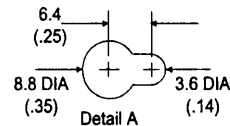
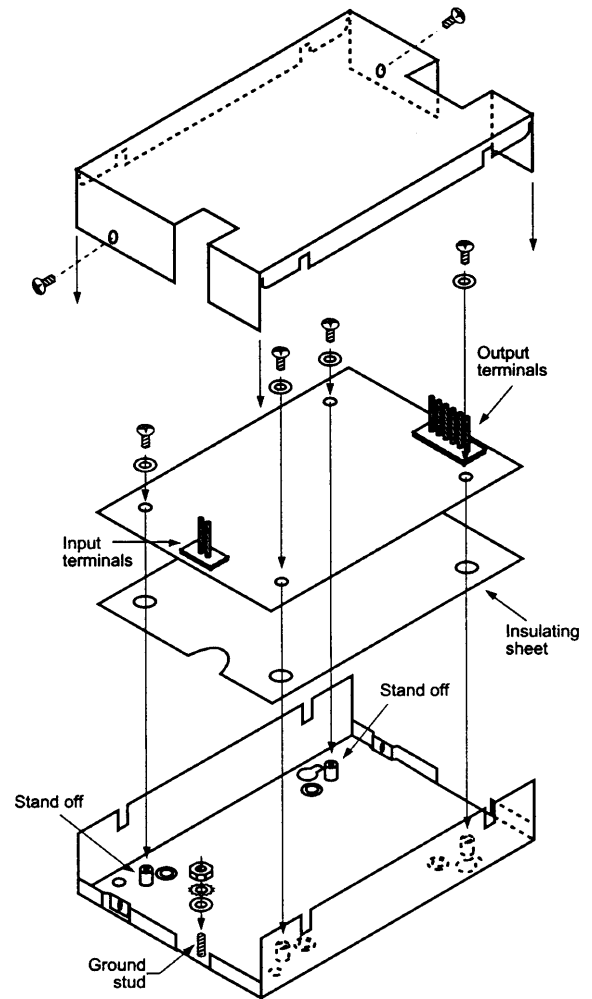
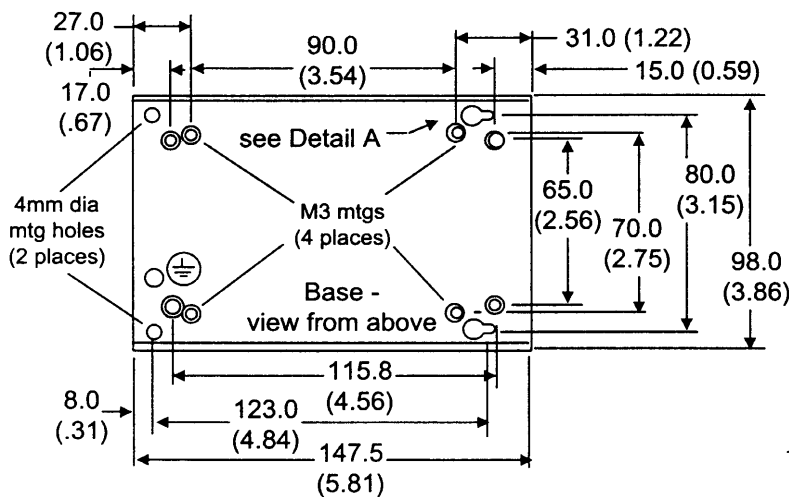

LPX40 LPX60