

Contents

| | |
|------------------------------------|-----------|
| Introduction | 3 |
| Tools | 5 |
| DREMEL® 300 Series | 6 |
| DREMEL® 400 Series DIGITAL | 9 |
| DREMEL® 10.8 V Lithium-Ion | 12 |
| DREMEL® Stylus™ Lithium-Ion | 14 |
| DREMEL® Glue Gun | 16 |
| DREMEL® Scroll Station™ | 18 |
| Accessories | 21 |
| Carving / Engraving / Routing | 22 |
| Grinding / Sharpening | 25 |
| Cleaning / Polishing | 28 |
| Cutting | 32 |
| Sanding | 36 |
| Collets / Mandrels / Miscellaneous | 38 |
| Accessory Kits | 41 |
| Attachments | 47 |
| Attachments to Reach | 48 |
| Attachments to Rout | 49 |
| Attachments to Sharpen | 50 |
| Attachments to Cut | 51 |
| Attachments to Control | 53 |
| Attachments to Saw | 55 |
| Miscellaneous | 57 |
| Battery Packs | 58 |
| Goggles | 58 |

Contents

| | |
|--------------------------|-----------|
| Miscellaneous | 57 |
| Scroll saw blades | 59 |
| Glue sticks | 59 |
| Index by category | 60 |
| Index by numbers | 63 |
| EAN-Codes | 64 |

Introduction

Dremel is the inventor of the famous high speed rotary tool system which you can use for a great number of projects where precision is required, both indoor and out.

DIY-projects: like fixing a hinge of a door or sanding parts of a wooden swing.

Hobby projects: like making model planes, or fixing parts of your classic car.

Creative projects: like engraving glass, wood or other materials.

The possibilities with the Dremel system are almost infinite. With your Dremel you become the expert in handling projects with great detail and precision even in hard to reach places. Whether you're an experienced craftsman working with great care on details of a car or model plane, or a beginner, taking on hobby projects, the Dremel system is perfect for anyone looking for precision and a wide variety of possibilities.

The innovative Dremel System has developed into a great range of tools and over 150 accessories and attachments.

The Dremel system consists of three components:

A. Tools

B. Accessories

C. Attachments

In this brochure the Dremel system will be explained, so you will find the right tools, attachments and accessories for every project.





Tools

Dremel has created a number of high speed rotary tools, corded as well as cordless. Every tool has specific features that makes it unique in its class. Dremel has developed each tool to meet the highest quality standards and optimise your enjoyment and comfort while working.

| | | |
|--------------------------------|--|---|
| DREMEL® 300 Series | DREMEL® 300 Series (300-25) DREMEL® 300 Series (300-1/55) |  |
| DREMEL® 400 Series DIGITAL | DREMEL® 400 Series DIGITAL (400-1/55) DREMEL® 400 Series DIGITAL (400-4/80) |  |
| DREMEL® 10.8 V Lithium-Ion | DREMEL® 10.8V Lithium-Ion (8000-60) |  |
| DREMEL® Stylus™ Lithium-Ion | DREMEL® Stylus™ Lithium-Ion (1100-15) |  |
| DREMEL® Glue Gun | DREMEL® Glue Gun (1200-3/6) |  |
| DREMEL® Scroll Station™ | DREMEL® Scroll Station™ (1800-1/5) |  |

DREMEL® 300 Series



Technical specifications

| | |
|-------------------|-----------------------|
| Rated power input | 125 W |
| Voltage | 230 V |
| Weight | 0,55 kg |
| No load speed | 10.000 - 33.000 1/min |

The Dremel 300 series is the new Dremel multitool, which is unique for its ergonomic design. It offers the user a comfortable grip with a convenient lightweight housing. The Dremel 300 Series is the ideal tool for users that like to perform detailed tasks, whether it's occasionally or regularly. Use the high quality Dremel accessories and attachments, to discover numerous possibilities: detailed sanding, precise routing, polishing for a great finish or even cutting through all kinds of materials, the only limit is your imagination. With the Dremel 300 Series, Dremel offers great quality at a very affordable price.

Features and Benefits

- 1 New and unique design**
improved ergonomics and increased comfort
- 2 Comfort switches**
to match the speed to the project at hand
- 3 Variable speed - 10.000 – 33.000 RPM**
more comfortable when handling and better control
- 4 Attachment interfaces**
to attach DREMELite and other (future) attachments
- 5 On-board wrench storage**
to have the wrench always at hand and nicely stored
- 6 Integrated hang hook**
for hanging the tool on the WorkStation or near the project
- 7 Soft grip**
for reduced vibration and a better grip
- 8 125W motor**
for optimal performance



DREMEL® 300 Series (300-25)

This kit includes the Dremel 300 series multitool in a convenient storage case for containment of accessories and attachments. The case features a unique system for attaching Mini Accessory Cases (mini cases not included) to expand storage possibility. This execution is the entry level kit, offering the Dremel 300 Series with a selected amount of accessories.



Contents

- Dremel 300 Series
- 25 high quality Dremel accessories
- Convenient and elegant storage case
- Inspiring Welcome Poster

Included accessories

Carving /
Engraving /
Routing



191

Grinding /
Sharpening



952

Cleaning /
Polishing



414

429

421

Cutting



409(5)

Sanding



407

408(2)

432

413(9)

Collets /
Mandrels /
Miscellaneous



401



402

Order information

Ordernumber: FO130300JB

EAN: 8710364030491

DREMEL® 300 Series (300-1/55)







This kit includes the Dremel 300 series multitool, a rich accessory content and the versatile, high quality Dremel Flexible Shaft. All this fits in a convenient case, that has the possibility of expanding storage space by sliding the Mini Accessory Case to the side of the tool case (1 accessory set included). This is a high value kit, offering great value for money for the more demanding user.



Contents

- Dremel 300 Series
- 55 high quality Dremel accessories in Mini Accessory Case
- Dremel high quality Flexible Shaft
- Convenient and elegant storage case
- Inspiring Welcome Poster

Included accessories

| | |
|------------------------------------|---|
| Carving / Engraving / Routing |  191 |
| Grinding / Sharpening |   8193 84922 |
| Cleaning / Polishing |     403 414(2) 429(2) 421 |
| Cutting |   409(36) 540 |
| Sanding |     407 408(2) 432 413(3) |
| Collets / Mandrels / Miscellaneous |   401 402 |

Order information

Ordernumber: FO130300JE

EAN: 8710364030521

DREMEL® 400 Series DIGITAL



Technical specifications

| | |
|-------------------|----------------------|
| Rated power input | 140 W |
| Voltage | 230 V |
| Weight | 0,59 kg |
| No load speed | 5.000 - 33.000 1/min |

The Dremel 400 Series Digital is the perfect multitool for projects that require the utmost precision. Thanks to the unique digital display, you can work more precisely on several materials that require different speed settings, either low or high. Combined with the convenient tool design, this multitool is the perfect partner for every job demanding precision and control. Restoring delicate parts in antique furniture, on detailed woodworking, polishing chrome on low speed, or drilling miniature holes in several materials; this tool is an absolute must for the most demanding craftsman. The Dremel 400 Series Digital: maximum precision and control.

Features and Benefits

- 1 Slim housing design**
allows maximum control and excellent grip
- 2 Variable speed control 5.000 - 33.000 RPM**
for exact speed adjustment in 1.000 RPM increments
- 3 LCD display**
shows exact speed settings
- 4 Separate on/off switch**
provides increased control and keeps speed setting after tool is switched off
- 5 140W motor**
for maximum performance
- 6 Electronic feedback control**
enhances the torque and performance at low and mid range speeds
- 7 Soft start function**
improves the lifetime of the motor
- 8 Hang hook**
for hanging the tool on the WorkStation or near the project



DREMEL® 400 Series DIGITAL (400-1/55)

This kit includes the top-of-the-range Digital Multitool from Dremel, with innovative features such as digital speed control, LCD display, electronic feedback circuitry and soft start. Additionally, the kit includes the unique Planer Attachment, which allows for very precise material removal on a variety of home craft and home maintenance projects. Next to the Planer Attachment, the kit includes 55 original Dremel accessories and a sturdy carrying case.



Contents

- Dremel 400 Series Digital
- 55 high quality Dremel accessories
- Planer attachment
- Planer bit
- Sturdy and spacious storage case
- Inspiring Welcome Poster

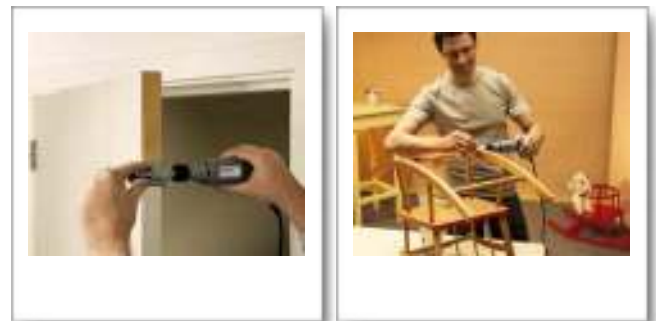

Included accessories

Carving / Engraving / Routing



191

Grinding / Sharpening



8193



84922

Cleaning / Polishing



414(2)



403



429(2)



421

Cutting



409



540

Sanding



407



408



432



413(3)

Collets / Mandrels / Miscellaneous



401



402

Order information

Ordernumber: FO130400JH

EAN: 8710364032983

DREMEL® 400 Series DIGITAL (400-4/80)

This Dremel Kit is the premium offer in the range. The Dremel 400 Series Digital comes with 2 mini accessory cases, 80 accessories and 4 unique Dremel attachments in a spacious and highly convenient storage case. All together this kit offers the user maximum precision and control for many applications. This execution is the supreme kit in the Dremel range, satisfying even the most demanding craftsman.



Contents

- Dremel 400 Series Digital
- 80 high quality Dremel accessories in 2 Mini Accessory Cases
- High quality Flexible Shaft
- Line and Circle Cutter
- Cutting Guide Attachment
- Lawn Mower Sharpening Attachment
- Sturdy and spacious storage case
- Inspiring Welcome Poster

Included accessories

| | | | | | | | | | | | | |
|--|---|-----|---|---------|---|--------|---|---------|---|--------|---|-----|
| Carving / Engraving / Routing |  | 191 | | | | | | | | | | |
| Grinding / Sharpening |  | 932 |  | 8193 |  | 84922 |  | 541(2) | | | | |
| Cleaning / Polishing |  | 403 |  | 425(2) |  | 422 |  | 414(2) |  | 429(2) |  | 421 |
| Cutting |  | 426 |  | 409(36) |  | 540(2) |  | 561 | | | | |
| Sanding |  | 407 |  | 408(3) |  | 432(3) |  | 413(15) | | | | |
| Collets / Mandrels / Miscellaneous |  | 150 |  | 401 |  | 402 | | | | | | |

Order information

Ordernumber: FO130400JE

EAN: 8710364031412

DREMEL® 10.8 V Lithium-Ion



Technical specifications

| | |
|--------------------|----------------------|
| Battery voltage | 10.8 V |
| Charging time | 3 h |
| Weight | 0,424 kg |
| No load speed | 5.000 - 35.000 1/min |
| Battery technology | Lithium-Ion |

The Dremel 10.8 V Lithium-Ion is the fastest (5,000-35,000 RPM) and most powerful cordless rotary tool available. Thanks to its lithium-ion technology: The tool is lightweight and easy to handle. The battery retains its power even after not using it for a long period of time. The tool can be charged at any time without damaging the battery capacity. The Dremel 10.8V Lithium-Ion: ready when you are, wherever you are!

Features and Benefits

- 1 Lightweight design**
which makes the tool easy to handle
- 2 Soft grip**
for reduced vibration and a better grip
- 3 Battery fuel gauge**
which indicates the current battery capacity
- 4 Lithium- ion battery**
no memory effect and no self discharge
- 5 Ergonomic housing**
increases comfort when working the tool
- 6 Attachment interfaces**
to attach DREMELite and other (future) attachments



DREMEL® 10.8V Lithium-Ion (8000-60)

The Dremel 10.8V Li-ion Cordless tool is the first power tool in the world to feature Li-ion battery technology. Li-ion batteries can be charged at any time, have no self-discharge and weigh up to 30% less than conventional NiCd cells. Most importantly, Li-ion technology allows this cordless tool to perform like a corded tool. In addition to the tool, the kit features a 3 hour charger, a soft bag and 60 original Dremel accessories.



Contents

- 60 high Quality Dremel accessories
- 3 hours quick charger
- Soft bag
- the Dremel 10.8V Lithium-Ion™
- 3,2 mm collet
- Collet nut
- Collet wrench
- Inspiring Welcome Poster

Included accessories

| | | |
|--|--|---|
| Carving / Engraving / Routing | | 191 |
| Grinding / Sharpening | | 541 8193 84922 932 |
| Cleaning / Polishing | | 414(5) 425(2) 429(3) |
| Cutting | | 409(15) 420(2) |
| Sanding | | 407 408(4) 411(10) 430 431(3) 432(3) 438(3) |
| Collets / Mandrels / Miscellaneous | | 150 401 402 |

Order information

Ordernumber: FO138000JG

EAN: 8710364032952

DREMEL® Stylus™ Lithium-Ion

New



Technical specifications

| | |
|--------------------|----------------------|
| Battery voltage | 7,2 V |
| Battery capacity | 1,0 Ah |
| Charging time | 5 h |
| Weight | 0,295 kg |
| No load speed | 5.000 - 25.000 1/min |
| Battery technology | Lithium-Ion |

The unique size and design of the Dremel® Stylus™ Lithium-Ion makes this tool very convenient to use, resulting in maximum precision and control. The ergonomics of the Dremel Stylus™ offer maximum maneuverability, allowing the user to reach high levels of precision. This new Dremel tool is designed for people, engaged in creative hands-on projects where precision is of the utmost importance. You can think of projects in the field of (glass) engraving, model building, creative in-house decorating, etc.
Dremel Stylus, Precision Redefined.

Features and Benefits

- 1 Unique ergonomic design**
the Dremel Stylus feels like an extension of your hand
- 2 Separate on-off switch**
allows you to keep your speed setting
- 3 Integrated wrench storage**
always have your wrench at hand
- 4 Charger holds accessories (shanked and non-shanked)**
- 5 Lithium-Ion battery (7.2V)**
always chargeable, no memory effect, no self discharge
- 6 Softgrip**
for a comfortable hold and reduced vibration
- 7 Variable speed 5.000 – 25.000 RPM**
select the right speed for your project



DREMEL® Stylus™ Lithium-Ion (1 100-15)

This kit offers the brandnew Dremel Stylus with a selection of Dremel accessories. Especially when working on intricate and detailed work this kit is the right choice.

Contents

Dremel Stylus Lithium Ion
Charger
15 High quality Dremel accessories
Welcome poster



Included accessories

Carving /
Engraving /
Routing



191

Grinding /
Sharpening



84922

Cleaning /
Polishing



423



403



520

Cutting



420(5)

Sanding



430



431



438



511

Collets /
Mandrels /
Miscellaneous



402

Order information

Ordernumber: FO131100JB

EAN: 8710364034338

DREMEL® Glue Gun



The Dremel Glue Gun is the most richly featured gluegun in the market. Its innovative design and numerous features make it very user friendly and easy to use. The features are specially designed for making the job of glueing easier. The gluegun will meet any demand in a wide variety of projects: model building, woodworking, scrapbooking or casemodding

Features and Benefits

- 1 Dual temp**
for working on a wide range of materials
- 2 Anti drip tip**
prevents hot glue from dripping onto your workpiece
- 3 LED light**
lights the area you're working on
- 4 Kick-stand**
one hand operated kick-stand provides stable placement on the work surface
- 5 Large 3 finger trigger**
allows precise applying of glue
- 6 Big foot**
Offers stability when placed on the work surface
- 7 Soft grip**
for comfortable hold
- 8 Standard glue stick size**
to make it compatible with wide array of glues
- 9 Indicator lights**
tell you when the gun is ready to operate
- 10 3-way switch**
select the right temp setting for the project at hand

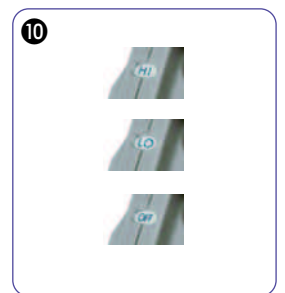

DREMEL® Glue Gun (1200-3/6)



Contents

- Dremel Glue Gun
- 3 different nozzles
- 6 Glue sticks (dual temperature)

Technical specifications

| | |
|-------------------|--------------|
| Rated power input | 30 W |
| Voltage | 230 V |
| Weight | 0,36 kg |
| Dual temperature | 120 / 195 °C |



Order information

Ordernumber: FO131200JB

EAN: 8710364033904

DREMEL® Scroll Station™



The Dremel ScrollStation is the most richly featured, most user-friendly and easy to control scrollsaw in the market. Its size and sturdiness, up front mounted controls, integrated disc sander and power take-off port allow you to work effortlessly and with high precision on a variety of detailed woodworking or other projects.

Features and Benefits

- 1 470 mm throat depth**
cuts larger work pieces than most other scrollsaws in the market.
- 2 Tool-less blade holder with quick tension adjustment**
no tools needed for fast and easy saw blade change and adjustment of saw blade tension.
- 3 InfiniteCut™ Blade holder**
the blade can be rotated 90 degrees for infinite cutting length.
- 4 Disc Sander**
the included 12cm disc sander allows users to sand, shape, smooth and finish projects.
- 5 Smooth cast-iron table**
the extra-large (520 mm x 385 mm) table, the extra-smooth finish and the sturdy support offer effortless work piece manipulation.
- 6 45-degree tilt left / 5-degree tilt right**
detents lock into place every 15 degree up to 45 degree to the left and at 5 degree to the right with a positive stop at 0 degree to quickly and easily square the table.
- 7 Power take-off port**
allows usage of the Dremel FlexShaft 225 (not included) by using the power supply of the sanding disc.
- 8 Flexible dust blower**
adjustable, multidirectional blower keeps cutting line clear for greater visibility.
- 9 Integrated Top handle**
to move the tool easily.
- 10 Accepts pin-end and plain-end saw blades**
the blade-holder accepts all standard 127 mm scrollsaw blades, pin-end as well as plain-end blades without additional adapters.
- 11 Blade storage**
convenient blade storage drawer keeps blades at your fingertips.
- 12 Top-mounted controls**
up-front control panel for easy access to on-off switch and variable speed adjustment (500-1500 SPM).
- 13 Hold down foot**
metal guide to reduce work piece vibration and to improve working results.
- 14 Vacuum cleaner interface**
keep working surface and tool clean and free of wood chips.
- 15 Adjustable disc sander table and angle guide**
table adjustable from 0 to 45 degrees. Removable angle guide adjustable 0±45 degrees.
- 16 Dovetail interface**
allows click-on of the DREMELite attachment DL4 (available separately).



DREMEL® Scroll Station™ (1 800-1/5)



Contents

Scroll saw
Disc Sander
5 scroll saw blades
Instruction manual

Technical specifications

| | |
|-------------------|-------------------|
| Rated power input | 110 W |
| Voltage | 230 V |
| Weight | 24,00 kg |
| No load speed | 500 - 1.500 1/min |
| Cutting depth | 470 mm |



Order information

Ordernumber: FO131800JB

EAN: 8710364035014

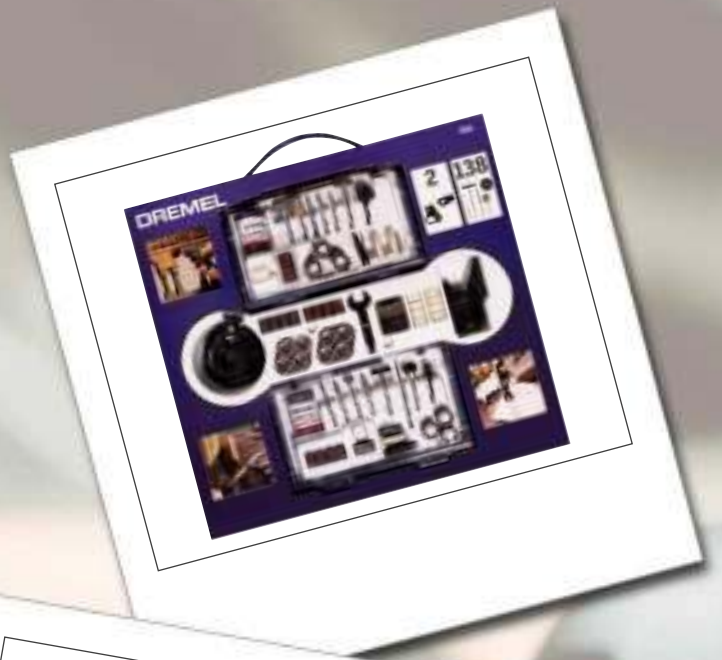

Accessories

To optimize your project result, you need the right accessories with a high quality standard. Dremel has created a range of accessories to suit all your needs. To help you select the right accessories, Dremel has created a colour coding system: every colour represents a category of applications. This will help you to select the right accessories you need for your jobs. No matter which materials you want to work with, Dremel has a solution for you.

| | | |
|--|---|--|
| <p>Carving / Engraving / Routing</p> | <p>Dremel offers high quality carving, engraving and routing accessories for many different applications. Their sharpness and durability allow them to last a long time.</p> |  |
| <p>Grinding / Sharpening</p> | <p>The accessories in this category can deburr, smooth, grind and clean a variety of materials in any kind of job.</p> |  |
| <p>Cleaning / Polishing</p> | <p>Dremel cleaning and polishing accessories include brushes, felt accessories and rubber points to work on steel, aluminium, brass, silver, gold and plastics.</p> |  |
| <p>Cutting</p> | <p>Dremel provides two types of cutting accessories for any cutting job; Cut-off wheels and cutting bits. Cut-off wheels cut metal, wood and plastic along their edge. Cutting bits are used with the Dremel cutting guide and cut in any direction.</p> |  |
| <p>Sanding</p> | <p>Dremel sanding accessories include sanding drums, bands, discs, flapwheels and abrasive buffs to remove and smoothen material.</p> |  |
| <p>Collets / Mandrels / Miscellaneous</p> | <p>This category features the miscellaneous extras, like drill bits, collets, mandrels and a multi-chuck.</p> |  |
| <p>Accessory Kits</p> | <ul style="list-style-type: none"> 100-pcs Accessory Set (701) 110-pcs Accessory Set (697) 140-pcs Accessory Set (700) 175-pcs Accessory Set (698) Cleaning / Polishing Set (684) Multipurpose Set (687) Cutting Set (688) |  |

Carving / Engraving / Routing

1. High Speed Cutters

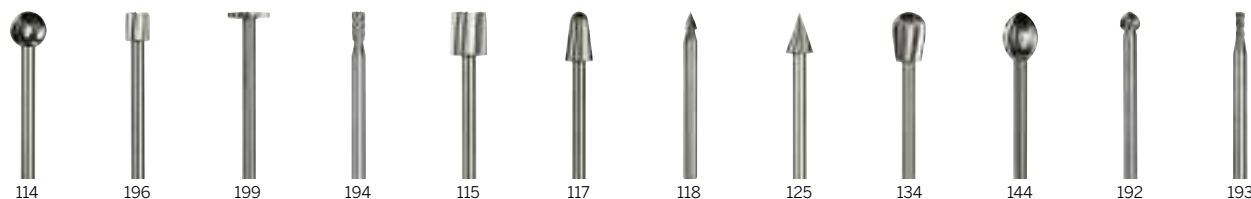

High speed cutters can be used for shaping, hollowing, grooving, slotting, making tapered holes in soft metals, plastics and woods.

| Model | Quantity | Working \varnothing mm | Shank \varnothing mm | Ordernumber | EAN |
|-------|----------|--------------------------|------------------------|-------------|---------------|
| 114 | 1 | 7,8 | 3,2 | 2615011432 | 8710364007868 |
| 196 | 1 | 5,6 | 3,2 | 2615019632 | 8710364007394 |
| 199 | 1 | 9,5 | 3,2 | 2615019932 | 8710364007400 |
| 194 | 1 | 3,2 | 3,2 | 2615019432 | 8710364007387 |
| 115 | 1 | 7,8 | 3,2 | 2615011532 | 8710364007332 |
| 117 | 1 | 6,4 | 3,2 | 2615011732 | 8710364007875 |
| 118 | 1 | 3,2 | 3,2 | 2615011832 | 8710364007349 |
| 125 | 1 | 6,4 | 3,2 | 2615012532 | 8710364007356 |
| 134 | 1 | 7,2 | 3,2 | 2615013432 | 8710364007912 |
| 144 | 1 | 7,8 | 3,2 | 2615014432 | 8710364007936 |
| 192 | 1 | 4,8 | 3,2 | 2615019232 | 8710364007363 |
| 193 | 1 | 2,0 | 3,2 | 2615019332 | 8710364007370 |

2. Engraving Cutters



Quality cutters for detail engraving, carving, routing in wood, fiberglass, plastic and soft metals.

| Model | Quantity | Working \varnothing mm | Shank \varnothing mm | Ordernumber | EAN |
|-------|----------|--------------------------|------------------------|-------------|---------------|
| 105 | 1 | 0,8 | 2,4 | 2615010532 | 8710364007288 |
| 106 | 1 | 1,6 | 2,4 | 2615010632 | 8710364007295 |
| 107 | 1 | 2,4 | 2,4 | 2615010732 | 8710364007301 |
| 108 | 1 | 0,8 | 2,4 | 2615010832 | 8710364007318 |
| 110 | 1 | 1,9 | 2,4 | 2615011032 | 8710364007820 |
| 111 | 1 | 0,8 | 2,4 | 2615011132 | 8710364007837 |
| 113 | 1 | 1,6 | 2,4 | 2615011332 | 8710364007325 |

Carving / Engraving / Routing

3. Diamond Wheel Points



For fine detail work, cutting, engraving, carving, touch-up and finishing. Use on wood, jade, ceramic, glass, hardened steel, semi-precious stones and other hard materials. Bits are covered with diamond particles.

| Model | Quantity | Working \varnothing mm | Shank \varnothing mm | Ordernumber | EAN |
|-------|----------|--------------------------|------------------------|-------------|---------------|
| 7103 | 1 | 2,0 | 2,4 | 2615710332 | 8710364008469 |
| 7105 | 1 | 4,4 | 2,4 | 2615710532 | 8710364008476 |
| 7120 | 1 | 6,7 | 2,4 | 2615712032 | 8710364008490 |
| 7122 | 1 | 2,4 | 2,4 | 2615712232 | 8710364008506 |
| 7123 | 1 | 4,8 | 2,4 | 2615712332 | 8710364008513 |
| 7134 | 1 | 2,0 | 2,4 | 2615713432 | 8710364008520 |
| 7144 | 1 | 2,4 | 2,4 | 2615714432 | 8710364008537 |

4. Tungsten Carbide Cutters



Use for shaping, smoothing and material removal. Use on hardened steel, stainless steel, cast iron, nonferrous metals, fired ceramics, plastics, hardwoods and other hard materials.

| Model | Quantity | Working \varnothing mm | Shank \varnothing mm | Ordernumber | EAN |
|-------|----------|--------------------------|------------------------|-------------|---------------|
| 9901 | 1 | 3,2 | 3,2 | 2615990132 | 8710364008605 |
| 9902 | 1 | 2,4 | 3,2 | 2615990232 | 8710364008612 |
| 9903 | 1 | 3,2 | 3,2 | 2615990332 | 8710364008629 |
| 9904 | 1 | 2,4 | 3,2 | 2615990432 | 8710364008636 |
| 9905 | 1 | 3,2 | 3,2 | 2615990532 | 8710364008643 |
| 9909 | 1 | 3,2 | 3,2 | 2615990932 | 8710364008667 |
| 9910 | 1 | 3,2 | 3,2 | 2615991032 | 8710364008674 |
| 9911 | 1 | 3,2 | 3,2 | 2615991132 | 8710364008681 |

Carving / Engraving / Routing

5. Structured Tooth Tungsten Carbide Cutters



Fast cutting sharp teeth for greater material removal. Use on fiberglass, wood, plastic, epoxy, rubber, laminates, particle board, soft metals, ceramic tile.

| Model | Quantity | Working \varnothing mm | Shank \varnothing mm | Ordernumber | EAN |
|-------|----------|--------------------------|------------------------|-------------|---------------|
| 9931 | 1 | 6,4 | 3,2 | 2615993132 | 8710364008544 |
| 9934 | 1 | 7,8 | 3,2 | 2615993432 | 8710364008575 |
| 9936 | 1 | 19,0 | 3,2 | 2615993632 | 8710364008599 |

6. Router Bits (HSS)



For routing, inlaying and mortising in wood and other soft materials. Use with Dremel Router Attachment 335 or Shaper/Router Table 231.

| Model | Quantity | Working \varnothing mm | Shank \varnothing mm | Ordernumber | EAN |
|-------|----------|--------------------------|------------------------|-------------|---------------|
| 612 | 1 | 9,5 | 3,2 | 2615061232 | 8710364008254 |
| 615 | 1 | 9,5 | 3,2 | 2615061532 | 8710364008285 |
| 640 | 1 | 6,4 | 3,2 | 2615064032 | 8710364008308 |
| 650 | 1 | 3,2 | 3,2 | 2615065032 | 8710364007417 |
| 652 | 1 | 4,8 | 3,2 | 2615065232 | 8710364008315 |
| 654 | 1 | 6,4 | 3,2 | 2615065432 | 8710364008322 |
| 655 | 1 | 8,0 | 3,2 | 26150655JA | 8710364023042 |

Grinding / Sharpening

1. Aluminum Oxide Grinding Wheel



541

Use for deburring, rust removal and general purpose grinding. Use with mandrel 402.

| Model | Quantity | Working \varnothing mm | Shank \varnothing mm | Ordernumber | EAN |
|-------|----------|--------------------------|------------------------|-------------|---------------|
| 541 | 2 | 22,4 | 3,2 | 2615054132 | 8710364010523 |

2. Aluminum Oxide Grinding Stones



911

932

952

953

997

8153

8175

8193

8215

Use on metals, castings, welded joints, rivets and rust. Ideal for sharpening, deburring and general purpose grinding of most materials.

| Model | Quantity | Working \varnothing mm | Shank \varnothing mm | Ordernumber | EAN |
|-------|----------|--------------------------|------------------------|-------------|---------------|
| 911 | 1 | 11,1 | 3,2 | 2615091132 | 8710364008056 |
| 932 | 1 | 9,5 | 3,2 | 2615093232 | 8710364007455 |
| 952 | 1 | 9,5 | 3,2 | 2615095232 | 8710364007462 |
| 953 | 1 | 6,4 | 3,2 | 2615095332 | 8710364007479 |
| 997 | 1 | 3,4 | 3,2 | 2615099732 | 8710364007486 |
| 8153 | 1 | 4,8 | 3,2 | 2615815332 | 8710364008124 |
| 8175 | 1 | 9,5 | 3,2 | 2615817532 | 8710364008131 |
| 8193 | 1 | 15,9 | 3,2 | 2615819332 | 8710364007493 |
| 8215 | 1 | 25,4 | 3,2 | 2615821532 | 8710364008148 |

Grinding / Sharpening

3. Silicon Carbide Grinding Stones



Designed to work well on stone, glass, ceramics, porcelain and non-ferrous metals.

| Model | Quantity | Working \varnothing mm | Shank \varnothing mm | Ordernumber | EAN |
|-------|----------|--------------------------|------------------------|-------------|---------------|
| 83142 | 1 | 7,0 | 3,2 | 2615314232 | 8710364016815 |
| 83322 | 1 | 3,2 | 3,2 | 2615332232 | 8710364016808 |
| 83702 | 1 | 3,2 | 3,2 | 2615370232 | 8710364016792 |
| 84922 | 1 | 4,8 | 3,2 | 2615492232 | 8710364016860 |
| 85422 | 1 | 19,8 | 3,2 | 2615542232 | 8710364016853 |
| 85602 | 1 | 10,3 | 3,2 | 2615560232 | 8710364016846 |

4. Abrasive Points



Use for finishing work and light deburring. For paint and rust removal without removing any of the base material.

| Model | Quantity | Working \varnothing mm | Shank \varnothing mm | Ordernumber | EAN |
|-------|----------|--------------------------|------------------------|-------------|---------------|
| 516 | 1 | 13,0 | 3,2 | 2615051632 | 8710364015238 |
| 518 | 1 | 13,0 | 3,2 | 2615051832 | 8710364015245 |

Grinding / Sharpening

5. Chainsaw Sharpening Grinding Stones



Precision ground for quick, easy sharpening of chain saw blades. Use with Dremel Chainsaw sharpening attachment No. 1453

| Model | Quantity | Working \varnothing mm | Shank \varnothing mm | Ordernumber | EAN |
|-------|----------|--------------------------|------------------------|-------------|---------------|
| 453 | 2 | 4,0 | 3,2 | 2615045332 | 8710364009336 |
| 454 | 2 | 4,8 | 3,2 | 2615045432 | 8710364009329 |
| 455 | 2 | 5,6 | 3,2 | 2615045532 | 8710364009558 |
| 457 | 2 | 4,5 | 3,2 | 2615045732 | 8710364021697 |

Cleaning / Polishing

1. Rubber Polishing Points



Blue points for finishing and polishing all ferrous metals. Removes small burrs and scratch marks left by grinding and sanding, and cleans and defines grooves. Also effective on many stones and ceramics.

| Model | Quantity | Working \varnothing mm | Shank \varnothing mm | Ordernumber | EAN |
|-------|----------|--------------------------|------------------------|-------------|---------------|
| 461 | 1 | 6,4 | 2,4 | 2615046132 | 8710364008339 |
| 462 | 1 | 6,4 | 2,4 | 2615046232 | 8710364008346 |
| 463 | 1 | 6,4 | 2,4 | 2615046332 | 8710364008353 |

2. Impregnated Polishing Wheel



Impregnated polishing wheel for light stock removal and high luster polishing. Works on various surfaces like steel, aluminium, brass, silver, gold, hard plastic etc. The polishing wheel is impregnated with a silicon carbide abrasive and cooling lubricant, so polishing compound is not needed.

| Model | Quantity | Working \varnothing mm | Shank \varnothing mm | Ordernumber | EAN |
|-------|----------|--------------------------|------------------------|-------------|---------------|
| 520 | 1 | 13,2 | 3,2 | 2615052065 | 8710364023035 |

Cleaning / Polishing

3. Polishing Wheels



Ideal for polishing metals and plastics. Using polishing compound no. 421 with wheels produces a high luster. Use 414, 422 and 429 with mandrel 401. Use 423 and 425 with mandrel 402.

| Model | Quantity | Working ø mm | Shank ø mm | Ordernumber | EAN |
|-------|----------|--------------|------------|-------------|---------------|
| 414 | 6 | 13,0 | 3,2 | 2615041432 | 8710364007141 |
| 422 | 1 | 10,0 | 3,2 | 2615042232 | 8710364007158 |
| 423 | 1 | 26,0 | 3,2 | 2615042332 | 8710364007165 |
| 429 | 1 | 26,0 | 3,2 | 2615042932 | 8710364007189 |
| 425 | 1 | 22,5 | 3,2 | 2615042532 | 8710364007172 |
| 421 | 1 | | | 2615042132 | 8710364008452 |

4. Bristle Brushes



Use for light deburring, cleaning, polishing of silverware, jewelry and other precious metals. Can be used with polishing compound (421).

| Model | Quantity | Working ø mm | Shank ø mm | Ordernumber | EAN |
|-------|----------|--------------|------------|-------------|---------------|
| 403 | 1 | 19,0 | 3,2 | 2615040332 | 8710364007127 |
| 404 | 1 | 13,0 | 3,2 | 2615040432 | 8710364007134 |
| 405 | 1 | 3,2 | 3,2 | 2615040532 | 8710364008230 |

Cleaning / Polishing

5. Carbon Steel Brushes



Versatile brush for removing rust and corrosion, polish metal surfaces, deburr and blend surface junctures or clean electrical components.

| Model | Quantity | Working \varnothing mm | Shank \varnothing mm | Ordernumber | EAN |
|-------|----------|--------------------------|------------------------|-------------|---------------|
| 428 | 1 | 19,0 | 3,2 | 2615042832 | 8710364007196 |
| 442 | 1 | 13,0 | 3,2 | 2615044232 | 8710364007202 |
| 443 | 1 | 3,2 | 3,2 | 2615044332 | 8710364007219 |

6. High-Performance Abrasive Brush



High performance for deburring, cleaning, rust and corrosion removal. Can be used at higher speed than other brushes (max. 20.000 rpm)

| Model | Quantity | Working \varnothing mm | Shank \varnothing mm | Ordernumber | EAN |
|-------|----------|--------------------------|------------------------|-------------|---------------|
| 538 | 1 | 26,0 | 3,2 | 26150538JA | 8710364023066 |

Cleaning / Polishing

7. Stainless Steel Brushes



Stainless steel brushes do not cause “after rust” when used on corrosive-resistant materials like pewter, aluminum and stainless steel.

| Model | Quantity | Working \varnothing mm | Shank \varnothing mm | Ordernumber | EAN |
|-------|----------|--------------------------|------------------------|-------------|---------------|
| 530 | 1 | 19,0 | 3,2 | 2615053032 | 8710364010561 |
| 531 | 1 | 13,0 | 3,2 | 2615053132 | 8710364010578 |
| 532 | 1 | 3,2 | 3,2 | 2615053232 | 8710364010585 |

8. Brass Brushes



Brass brushes are non-sparking and softer than steel. They will not scratch soft metals like gold, copper, brass.

| Model | Quantity | Working \varnothing mm | Shank \varnothing mm | Ordernumber | EAN |
|-------|----------|--------------------------|------------------------|-------------|---------------|
| 535 | 1 | 19,0 | 3,2 | 2615053532 | 8710364010530 |
| 536 | 1 | 13,0 | 3,2 | 2615053632 | 8710364010547 |
| 537 | 1 | 3,2 | 3,2 | 2615053732 | 8710364010554 |

Cutting

1. DREMEL® SpeedClic®

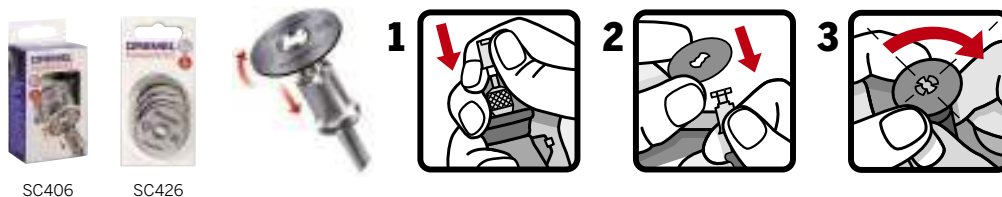

Dremel, the inventor of the Multitool, now brings you SpeedClic - an innovation that makes changing cut-off wheels quick and easy. Through a patented mandrel and wheel design, Dremel has found a way that enables you to change your accessory in 3 simple steps - Pull, Click, Twist - without using any tools. The Starter Set SC406 includes the new SpeedClic mandrel and two SpeedClic cut-off wheels. The fiberglass reinforced cut-off wheels SC426 are replacement cut-off wheels specifically for the SpeedClic system.

| Model | Quantity | Working \varnothing mm | Shank \varnothing mm | Ordernumber | EAN |
|-------|----------|--------------------------|------------------------|-------------|---------------|
| SC406 | 1+2 | 32,0 | 3,2 | 2615S406JA | 8710364033461 |
| SC426 | 5 | 32,0 | 3,2 | 2615S426JA | 8710364033478 |

2. Cut-Off Wheels

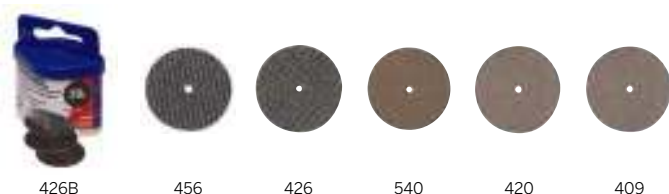

For slicing and cutting in metal, wood and plastic. Cut-off wheels make it easy to cut or slot bolts, screws, sheet metal, thin wood and plastic. Fiberglass reinforced cut-off wheels (456, 426, 426B) are for tough applications. The cut-off wheel cuts only along its edge. Do not attempt to sand or cut curved holes with cut-off wheels. Use Dremel cut-off wheels with mandrel 402.

| Model | Quantity | Working \varnothing mm | Shank \varnothing mm | Ordernumber | EAN |
|-------|----------|--------------------------|------------------------|-------------|---------------|
| 426B | 20 | 32,0 | 3,2 | 2615426BJA | 8710364026296 |
| 456 | 10 | 38,0 | 3,2 | 26150456JA | 8710364023011 |
| 426 | 5 | 32,0 | 3,2 | 2615042632 | 8710364007448 |
| 540 | 5 | 32,0 | 3,2 | 2615054032 | 8710364010516 |
| 420 | 20 | 24,0 | 3,2 | 2615042032 | 8710364007431 |
| 409 | 36 | 24,0 | 3,2 | 2615040932 | 8710364007424 |

Cutting

3. Diamond Wheel



545

A unique accessory especially suited to cutting, grinding and filing materials that are harder than metal. For example concrete, marble, stone, porcelain, ceramic and hard epoxide. The diamond wheel produces a fine cut, is extremely durable, does not break and retains its shape.

| Model | Quantity | Working ø mm | Shank ø mm | Ordernumber | EAN |
|-------|----------|--------------|------------|-------------|---------------|
| 545 | 1 | 22,2 | 3,2 | 2615054565 | 8710364017010 |

4. Cutting/Shaping Wheel



542

The ultimate solution for wood. The special design of the cutting/shaping wheel 542 ensures that you can cut both hard and soft types of wood, cut grooves and shape wood. The carbide coating makes the wheel especially durable.

| Model | Quantity | Working ø mm | Shank ø mm | Ordernumber | EAN |
|-------|----------|--------------|------------|-------------|---------------|
| 542 | 1 | 25,4 | 3,2 | 2615054265 | 8710364017119 |

Cutting

5. Rip/Cross-Cut Blade



546

Precision saw blade for fine, clean and straight cuts in all sorts of wood. Perfect for laminate and wood flooring or thin wood plates. Use only with Dremel Mini Saw attachment 670. Made of carbon steel, 48 offset teeth guarantee precise, fast cuts up to 6.35 mm.

| Model | Quantity | Working \varnothing mm | Shank \varnothing mm | Ordernumber | EAN |
|-------|----------|--------------------------|------------------------|-------------|---------------|
| 546 | 1 | 31,8 | 3,2 | 26150546JA | 8710364023073 |

6. Spiral Cutting Bits



560



561



562

The drywall cutting bit 560 gives you fast clean cuts in drywall. The multipurpose cutting bit 561 cuts wood, plastic, fiberglass, drywall, laminate & vinyl siding. The tile cutting bit 562 cuts ceramic wall tile, cement board and blaster. (Not for use on floor tile)

| Model | Quantity | Working \varnothing mm | Shank \varnothing mm | Ordernumber | EAN |
|-------|----------|--------------------------|------------------------|-------------|---------------|
| 560 | 1 | 3,2 | 3,2 | 2615056032 | 8710364010592 |
| 561 | 1 | 3,2 | 3,2 | 2615056132 | 8710364010615 |
| 562 | 1 | 3,2 | 3,2 | 2615056232 | 8710364010608 |

Cutting

7. Grout Removal Bits



569



570

Ideal for cleaning wall and floor grout or removing grout to replace broken tiles. Use with the Dremel Grout Removal attachment 568.

| Model | Quantity | Working ø mm | Shank ø mm | Ordernumber | EAN |
|-------|----------|--------------|------------|-------------|---------------|
| 569 | 1 | 1,6 | 3,2 | 2615056932 | 8710364014125 |
| 570 | 1 | 3,2 | 3,2 | 2615057032 | 8710364016624 |

Sanding

1. Sanding Bands

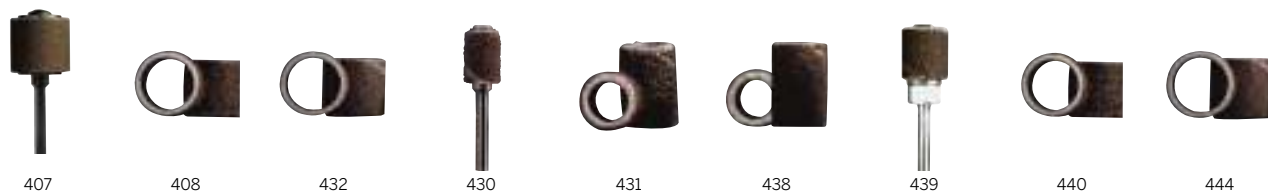

For rough shaping and smoothing wood and fiberglass, removing rust from metal surfaces and shaping rubber surfaces. Sanding bands are easily replaceable.

| Model | Quantity | Working \varnothing mm | Shank \varnothing mm | Grit | Ordernumber | EAN |
|-------|----------|--------------------------|------------------------|------|-------------|---------------|
| 407 | 1 | 13,0 | 3,2 | 60 | 2615040732 | 8710364007226 |
| 408 | 6 | 13,0 | 3,2 | 60 | 2615040832 | 8710364007233 |
| 432 | 6 | 13,0 | 3,2 | 120 | 2615043232 | 8710364007264 |
| 430 | 1 | 6,4 | 3,2 | 60 | 2615043032 | 8710364007240 |
| 431 | 6 | 6,4 | 3,2 | 60 | 2615043132 | 8710364007257 |
| 438 | 6 | 6,4 | 3,2 | 120 | 2615043832 | 8710364007271 |
| 439 | 1 | 9,5 | 3,2 | 60 | 2615043932 | 8710364008391 |
| 440 | 6 | 9,5 | 3,2 | 60 | 2615044032 | 8710364008407 |
| 444 | 6 | 9,5 | 3,2 | 120 | 2615044432 | 8710364008414 |

2. Flapwheels



Perfect for sanding flat or contoured surfaces on metal, wood, rubber or plastic.

| Model | Quantity | Working \varnothing mm | Shank \varnothing mm | Grit | Ordernumber | EAN |
|-------|----------|--------------------------|------------------------|------|-------------|---------------|
| 502 | 1 | 28,6 | 3,2 | 80 | 2615050232 | 8710364015252 |
| 504 | 1 | 28,6 | 3,2 | 80 | 2615050432 | 8710364015269 |

Sanding

3. Finishing Abrasive Buffs



511

Finishing abrasive buffs for precise and delicate material removal on metal, glass, wood, aluminum and plastics. The flexible material enables to work on tight and irregularly shaped areas. Use with mandrel 402.

| Model | Quantity | Working ø mm | Shank ø mm | Grit | Ordernumber | EAN |
|-------|----------|--------------|------------|------|-------------|---------------|
| 511 | 2 | 25,5 | 3,2 | | 2615051165 | 8710364023028 |

4. Sanding Discs



411

412

413

Sanding discs are designed for precise sanding on wood. Use with mandrel 402.

| Model | Quantity | Working ø mm | Shank ø mm | Grit | Ordernumber | EAN |
|-------|----------|--------------|------------|------|-------------|---------------|
| 411 | 36 | 19,0 | 3,2 | 180 | 2615041132 | 8710364008421 |
| 412 | 36 | 19,0 | 3,2 | 220 | 2615041232 | 8710364008438 |
| 413 | 36 | 19,0 | 3,2 | 240 | 2615041332 | 8710364008445 |

Collets / Mandrels / Miscellaneous

1. Collets



480

481

482

483

4485

Collets offer the most precise way to hold an accessory in a multitool. The collet kit 4485 is an assortment of the different available collets (0,8 / 1,6 / 2,4 / 3,2 mm) including a collet nut.

| Model | Quantity | Working \varnothing mm | Shank \varnothing mm | Ordernumber | EAN |
|-------|----------|--------------------------|------------------------|-------------|---------------|
| 480 | 1 | | 3,2 | 2615048032 | 8710364007554 |
| 481 | 1 | | 2,4 | 2615048132 | 8710364007561 |
| 482 | 1 | | 1,6 | 2615048232 | 8710364007578 |
| 483 | 1 | | 0,8 | 2615048332 | 8710364007585 |
| 4485 | 1+4 | | | 2615448532 | 8710364007592 |

2. Multi Chuck



4486

The DREMEL multi chuck (4486) allows you to quickly and easily change accessories on your DREMEL multitool without using collets. It accepts accessories from 0,4 mm to 3,4 mm shank.

| Model | Quantity | Working \varnothing mm | Shank \varnothing mm | Ordernumber | EAN |
|-------|----------|--------------------------|------------------------|-------------|---------------|
| 4486 | 1 | | | 2615448632 | 8710364012978 |

Collets / Mandrels / Miscellaneous

3. Mandrels



Mandrels are used to mount different accessories, like felt polishing wheels or cut-off wheels.

| Model | Quantity | Working \varnothing mm | Shank \varnothing mm | Ordernumber | EAN |
|-------|----------|--------------------------|------------------------|-------------|---------------|
| 401 | 1 | | 3,2 | 2615040132 | 8710364007530 |
| 402 | 1 | | 3,2 | 2615040232 | 8710364007547 |

4. Precision Drill Bit Set

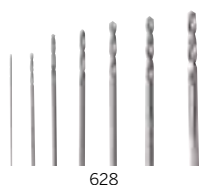

The DREMEL precision drill bit set (628) contains 7 drill bits for drilling into wood or soft metal. The different diameters included are 0,8 / 1,2 / 1,6 / 2,0 / 2,4 / 2,8 and 3,2 mm.

| Model | Quantity | Working \varnothing mm | Shank \varnothing mm | Ordernumber | EAN |
|-------|----------|--------------------------|------------------------|-------------|---------------|
| 628 | 7 | | | 2615062832 | 8710364009381 |

5. Wood Drill Bit Set



The DREMEL wood drill bit set contains 4 drill bits with centering point for drilling into wood. The different drilling diameters included are 3, 4, 5 and 6 mm. The titanium coating offers high performance and longer lifetime.

| Model | Quantity | Working \varnothing mm | Shank \varnothing mm | Ordernumber | EAN |
|-------|----------|--------------------------|------------------------|-------------|---------------|
| 636 | 4 | | 3,2 | 26150636JA | 8710364026289 |

Accessory Kits

100-pcs Accessory Set (701)

This accessory set includes the 100 best sold accessories in a high value tin can box. The accessories can be easily stored in the insert or the included small plastic case. The DREMEL Quick Start leaflet shows the included accessories and explains on which materials they can be used.



Included accessories

| | |
|------------------------------------|--|
| Carving / Engraving / Routing | 191 |
| Grinding / Sharpening | 541(6), 932, 952, 8193, 84922, 85422 |
| Cleaning / Polishing | 414(12), 429(6), 403(2) |
| Cutting | 409(36), 426 |
| Sanding | 407(2), 408, 432(6), 430(6), 431, 438(6) |
| Collets / Mandrels / Miscellaneous | 402(6), 150 |

Order information

Ordernumber: 26150701JA

EAN: 8710364035601

110-pcs Accessory Set (697)

This accessory set includes the 110 best sold accessories in a high value accessory box. The DREMEL Quick Start leaflet shows the included accessories and explains on which materials they can be used. Additionally, it contains the unique DREMEL Lawn Mower Sharpening Attachment.



Included accessories

| | |
|------------------------------------|---|
| Carving / Engraving / Routing | 191 |
| Grinding / Sharpening | 932, 952, 8193, 84922, 85422 |
| Cleaning / Polishing | 405, 428, 414(4), 429, 421 |
| Cutting | 409(10), 420(8), 426(2) |
| Sanding | 411(18), 412(19), 413(19), 407, 408(4), 432(4), 430, 431(3), 438(3) |
| Collets / Mandrels / Miscellaneous | 401, 402, 150 |

Order information

Ordernumber: 26150697JC

EAN: 8710364029129

Accessory Kits

140-pcs Accessory Set (700)

This accessory set includes an assortment of the most popular DREMEL accessories. The included 138 accessories are stored in two convenient accessory boxes that can be attached on the DREMEL tool cases (300 Series and 400 Series). The DREMEL Quick Start leaflet shows the included accessories and explains on which materials they can be used. Additionally it provides the DREMEL Cutting Guide and the DREMEL Lawn Mower Sharpening Attachment which leads to a total content of 140 pieces.



Included accessories

| | |
|------------------------------------|---|
| Carving / Engraving / Routing | 194 |
| Grinding / Sharpening | 932, 953, 84922, 85422, 85602 |
| Cleaning / Polishing | 403, 404, 414(11), 421, 425, 428, 429(3) |
| Cutting | 409(36), 420(20), 426, 540, 561 |
| Sanding | 407, 408(7), 413(20), 430, 431(6), 432(7), 438(6), 511(2) |
| Collets / Mandrels / Miscellaneous | 150, 401, 402 |

Order information

Ordernumber: 26150700JA

EAN: 8710364033829

175-pcs Accessory Set (698)

175 high quality DREMEL accessories in a unique storage box. The extensive selection of this set offers numerous possibilities. Neatly arranged and therefore very user-friendly. But that is not all. You will find exclusive additions to this set such as a line & circle cutter and an impregnated polishing wheel. Furthermore, we have included the Quick Start leaflet for immediate application and correct use of all parts.



Included accessories

| | |
|------------------------------------|---|
| Carving / Engraving / Routing | 191, 194 |
| Grinding / Sharpening | 932(2), 952(2), 8193(2), 84922(2), 85422, 85602(2), 541(3) |
| Cleaning / Polishing | 520, 414(8), 429(4), 425(3), 428, 403, 404, 405, 421 |
| Cutting | 409(20), 420(20), 426(4), 561 |
| Sanding | 411(21), 412(20), 413(20), 408(6), 432(6), 431(6), 438(6), 407, 430 |
| Collets / Mandrels / Miscellaneous | 415, 150, 401, 402, 90962 |

Order information

Ordernumber: 26150698JA

EAN: 8710364026685

Accessory Kits

Cleaning / Polishing Set (684)

All you need for cleaning and polishing in a convenient box. Removable accessory tray and 3 dividers provide perfect storage solution. DREMEL Quick Start leaflet explains the included accessories.



Included accessories

Cleaning / Polishing

403, 404, 405, 428, 520, 414(6), 422, 425(2), 429(3), 421

Collets / Mandrels / Miscellaneous

401, 402

Order information

Ordernumber: 26150684JA

EAN: 8710364029099

Multipurpose Set (687)

Assortment of best selling accessories in a convenient box. Removable accessory tray and 3 dividers provide perfect storage solution. DREMEL Quick Start leaflet explains the included accessories.



Included accessories

Carving / Engraving / Routing

194

Grinding / Sharpening

952, 85422

Cleaning / Polishing

403, 414(2), 429(2), 421

Cutting

409(36), 426

Sanding

407, 408, 432(2)

Collets / Mandrels / Miscellaneous

401, 402

Order information

Ordernumber: 26150687JA

EAN: 8710364029105

Accessory Kits

Cutting Set (688)

Assortment of 68 cut-off wheels in a convenient box.; Removable accessory tray and 3 dividers provide perfect storage solution. DREMEL Quick Start leaflet explains the included accessories.



Included accessories

Cutting

409(36), 420(24), 426(3), 540(5)

Collets / Mandrels / Miscellaneous

402

Order information

Ordernumber: 26150688JA

EAN: 8710364029112





DREMEL



Attachments

With Dremel attachments you can do your job with even more precision and ease. Dremel offers attachments to rout, control, cut, saw, sharpen and to reach.

| | | |
|--------------------------------------|--|---|
| <p>Attachments to Reach</p> | <p>Flexible Shaft (225) Right Angle Attachment (575)</p> |  |
| <p>Attachments to Rout</p> | <p>Plunge Router Attachment (335) Shaper / Router Table (231)</p> |  |
| <p>Attachments to Sharpen</p> | <p>Chainsaw Sharpening Attachment (1453) Lawn Mower Sharpening Attachment (675)</p> |  |
| <p>Attachments to Cut</p> | <p>Multipurpose Cutting Kit (565) Wall Tile Cutting Kit (566) Wall & Floor Grout Removal Kit (568)</p> |  |
| <p>Attachments to Control</p> | <p>Workstation™ (220) DREMELite™ (DL4) D-Vise (2214) Flex-Shaft Tool Holder (2222)</p> |  |
| <p>Attachments to Saw</p> | <p>Mini Saw Attachment (670)</p> |  |

Attachments to Reach

Flexible Shaft (225)

- Ideal attachment for precise, detailed work or hard to reach places.
- Comfort grip handpiece allows fingertip control to cut, grind, sand, polish and more.
- Integrated shaft lock button for quick and easy accessory changes. 127 mm bend radius provides more comfort and flexibility during use.
- Quick connect attaches your DREMEL tool in seconds.



Contents

Flexible Shaft - length 1070 mm
Driver Cap

Order information

Ordernumber: 26150225PD

EAN: 8710364020935

Right Angle Attachment (575)

- Designed to use accessories in right angle for hard to reach places.
- Ball bearings and spiral bevel gears provide smooth and cool operation and guarantee longer lifetime.
- Coupling system allows to place the attachment in 12 different directions on your DREMEL tool.
- Quick connect attaches your DREMEL tool in seconds.



Contents

Right Angle Attachment
Driver Cap

Order information

Ordernumber: 2615057532

EAN: 8710364016983

Attachments to Rout

Plunge Router Attachment (335)

- Converts your DREMEL tool into a plunge router to rout circles, signs and inlay work, decorative edges and to rout parallel to an edge.
- Plunge-lock in handle - simply turn handle to lock/unlock.
- Two depth stops for quick, consistent adjustment of depth.
- Edge guide and circle guide to rout straight lines and perfect circles.
- Guide bushing set for letter and pattern template routing.



Contents

Plunge Router Attachment

Edge Guide

Circle Guide

Guide Bushing Set

Wrench

Order information

Ordernumber: 26150335JA

EAN: 8710364023080

Shaper / Router Table (231)

- Converts your DREMEL tool into a bench mounted tool for precise routing, shaping and sanding.
- Plastic knobs for easy tool assembly and depth adjustment.
- Smooth table surface to slide your workpiece easily over the table.
- Slot, groove, sand and trim edges.
- 3-way adjustable fence for accurate working result.
- Worktable 203 x 152 mm.
- Adjustable, transparent router bit guard enables safe working.

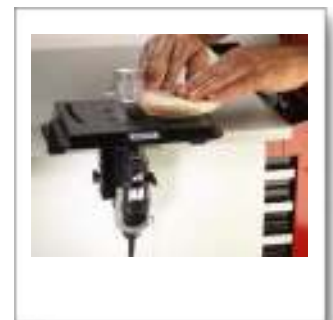

Contents

Shaper/Router Table

Order information

Ordernumber: 2615023132

EAN: 8710364016891

Attachments to Sharpen

Chainsaw Sharpening Attachment (1453)

- The fastest, easiest way to sharpen dull, slow-cutting chain saws.
- Easily attaches to your DREMEL tool.
- Works with a variety of different chain sizes.



Contents

Sharpening Angle Guide

Adjustment Gauge

Chainsaw Sharpening Grinding Stones

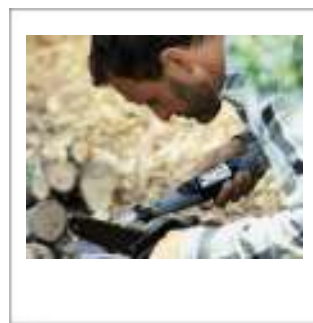

Order information

Ordernumber: 26151453PA

EAN: 8710364021499

Lawn Mower Sharpening Attachment (675)

- The fastest, easiest way to sharpen lawnmower blades.
- Easily attaches to your DREMEL tool.
- Guide provides optimum sharpening angle.
- Sharpens many lawn and garden tools.



Contents

Sharpening Angle Guide

Aluminum Oxide Grinding Stone (932)



Order information

Ordernumber: 26150675AB

EAN: 8710364020232

Attachments to Cut

Multipurpose Cutting Kit (565)

- Provides controlled cutting in a variety of materials.
- Easily attaches to your DREMEL tool.
- Easy depth adjustment up to 19 mm material thickness.



Contents

Cutting Guide

2 Drywall Cutting Bits 560

1 Multipurpose Cutting Bit 561

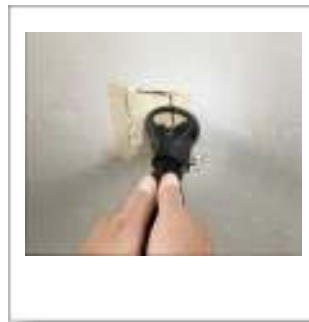

Order information

Ordernumber: 2615056532

EAN: 8710364010622

Wall Tile Cutting Kit (566)

- Provides controlled cutting in ceramic wall tiles.
- Easily attaches to your DREMEL tool.
- Easy depth adjustment up to 19 mm material thickness.



Contents

Cutting Guide

1 Tile Cutting Bit 562 (not for use on ceramic floor tiles)

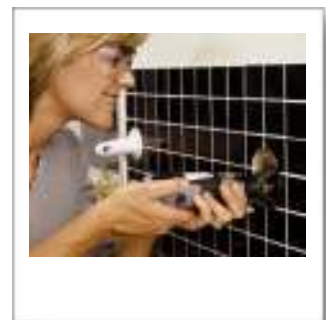

Order information

Ordernumber: 2615056632

EAN: 8710364010639

Attachments to Cut

Wall & Floor Grout Removal Kit (568)

- Specially developed for removing grout from between wall and floor tiles.
- The risk of chipping your tiles edges is greatly reduced compared with manual chiselling.
- Easy depth adjustment.
- Guide keeps bit centered between tiles.



Contents

Angled Cutting Guide
1.6 mm Grout Removal Bit 569



Order information

Ordernumber: 2615056832

EAN: 8710364013982

Attachments to Control

Workstation™ (220)

- This is the perfect solution for stationary working with your Dremel.
- Drill vertically or in an angle, adjustable in increments of 15 degrees.
- Holds tool horizontally for polishing and sanding.
- Integrated, telescoping tool stand holds tool with Flex Shaft (225).
- On-board accessory storage.
- Cord management keeps cord safely stowed.
- Depth markings for consistent depth adjustment.
- Base markings (metric and inches).



Contents

Combined Drill Press and Tool Holder

Order information

Ordernumber: 26150220JB

EAN: 8710364032426

DREMELite™ (DL4)

- DREMELite with unique, highly flexible shaft.
- Quick and easy way to light up your work surface.
- Ideal for hard-to-reach, dim places and/or precise detailed work.
- High-intensity LED light with lifetime warranty.
- Easy-to-use twist On/Off switch.
- Works with standard Lithium batteries.
- For use on Dremel Plunge Router Attachment (335), Dremel Workstation (220) and the exclusive Dremel Bench-Clip.



Contents

DREMELite
2 Lithium batteries (CR2025)
Bench-Clip

Order information

Ordernumber: 26150DL4JA

EAN: 8710364029136

Attachments to Control

D-Vise (2214)

- Conveniently holds workpiece while you use your rotary tool.
- Vise swivels 360° and tilts 180° in all directions.
- Jaws open to 64 mm.



Contents

D-Vise

Order information

Ordernumber: 2615221432

EAN: 8710364000944

Flex-Shaft Tool Holder (2222)

- Conveniently suspends your Dremel rotary tool above your workbench.
- Perfect for use with the Flexible Shaft attachment.
- Clamps to workbenches up to 50 mm thick, and adjusts in height from 300 to 1070 mm.
- Store extra bits on base.



Contents

Flex-Shaft Tool Holder

Order information

Ordernumber: 2615222232

EAN: 8710364016822

Attachments to Saw

Mini Saw Attachment (670)

- Transforms your DREMEL tool into a precision circular saw for fine, clear and straight cuts in all sorts of wood.
- Perfect for laminate and wood flooring or thin wood plates.
- The safety guard and lower guard make it safe to use the circular saw blade.
- The guide allows to make straight cuts.
- Quick connect attaches your DREMEL tool in seconds.
- This Mini Saw Attachment is easier to use than a hard saw, more precise than a jig saw and fits in tighter spaces than a circular saw.



Contents

Mini Saw Attachment
Rip/Cross-Cut Blade (546)
Driver Cap

Order information

Ordernumber: 26150670JA

EAN: 8710364023196



Miscellaneous

| | | |
|---------------|---------------------------------------|--|
| Battery Packs | 9.6V NiCd (785) 10.8V Li-Ion (855) |  |
|---------------|---------------------------------------|--|

| | | |
|---------|---------------|---|
| Goggles | Goggles (SG4) |  |
|---------|---------------|---|

| | | |
|-------------------|---|--|
| Scroll saw blades | 16411 (16411) 16453 (16453) 16412 (16412) 16461 (16461) 16413 (16413) 16463 (16463) 16440 (16440) 16483 (16483) 16443 (16443) 16446 (16446) 16448 (16448) |  |
|-------------------|---|--|

| | | |
|-------------|-------------------|---|
| Glue sticks | Glue Sticks (GS1) |  |
|-------------|-------------------|---|

Miscellaneous

Battery Packs



785



855

For DREMEL MultiPro 9.6V cordless tool use battery pack 785. For DREMEL 10.8V Lithium-Ion cordless tool use battery pack 855.

| Model | Quantity | Ordernumber | EAN |
|-------|----------|-------------|---------------|
| 785 | 1 | 26150785PB | 8710364018994 |
| 855 | 1 | 26150855JB | 8710364026357 |

Goggles



SG4

Use the goggles to provide protection for your eyes when working on your projects.

| Model | Quantity | Ordernumber | EAN |
|-------|----------|-------------|---------------|
| SG4 | 1 | 26150SG4JA | 8710364033812 |

Miscellaneous

Scroll saw blades



16411 16412 16413 16440 16443 16446 16448 16453 16461 16463 16483

Pin-end blades (16411, 16412, 16413) can be used for cutting in wood. Plain end blades (16440, 16443, 16446, 16448, 16453) can be used for detailde cutting in wood, plastics and fibrous materials. Plain-end blades 16483 can be used for cutting in metal. Spiral plain-end blades 16461, 16463 can be used for cutting in all directions. Scroll blades can be used with Dremel Scroll Station model 1800 and the old Scroll Saw model 1371.

| Model | Quantity | Width | Thick | Teeth per 2,5 cm | Ordernumber | EAN |
|-------|----------|-------|-------|------------------|-------------|---------------|
| 16411 | 5 | 2,80 | 0,45 | 15,0 | 2615641132 | 8710364010721 |
| 16412 | 5 | 2,80 | 0,45 | 10,0 | 2615641232 | 8710364010738 |
| 16413 | 5 | 1,77 | 0,25 | 18,5 | 2615641332 | 8710364010745 |
| 16440 | 5 | 0,56 | 0,25 | 28,0 | 2615644032 | 8710364010646 |
| 16443 | 5 | 0,74 | 0,30 | 20,0 | 2615644332 | 8710364010653 |
| 16446 | 5 | 0,96 | 0,40 | 12,5 | 2615644632 | 8710364010660 |
| 16448 | 5 | 1,14 | 0,43 | 11,5 | 2615644832 | 8710364010677 |
| 16453 | 5 | 1,57 | 0,50 | 9,5 | 2615645332 | 8710364010684 |
| 16461 | 5 | 0,71 | 0,76 | 46,0 | 2615646132 | 8710364010752 |
| 16463 | 5 | 0,86 | 0,91 | 41,0 | 2615646332 | 8710364010769 |
| 16483 | 5 | 0,84 | 0,41 | 36,0 | 2615648332 | 8710364010707 |

Glue sticks



GS1

These glue sticks can be used with any Glue Gun even for dual temperatures. Each package consists of 15 pieces with a length of 150 mm and 11 mm diameter.

| Model | Quantity | Length | Diameter | Ordernumber | EAN |
|-------|----------|--------|----------|-------------|---------------|
| GS1 | 15 | 150 | 11 | 26150GS1JA | 8710364036134 |

Index by category

| | |
|--|-----------|
| Introduction | 3 |
| Tools | 5 |
| DREMEL® 300 Series | 6 |
| DREMEL® 300 Series (300-25) | 7 |
| DREMEL® 300 Series (300-1/55) | 8 |
| DREMEL® 400 Series DIGITAL | 9 |
| DREMEL® 400 Series DIGITAL (400-1/55) | 10 |
| DREMEL® 400 Series DIGITAL (400-4/80) | 11 |
| DREMEL® 10.8 V Lithium-Ion | 12 |
| DREMEL® 10.8V Lithium-Ion (8000-60) | 13 |
| DREMEL® Stylus™ Lithium-Ion | 14 |
| DREMEL® Stylus™ Lithium-Ion (1100-15) | 15 |
| DREMEL® Glue Gun | 16 |
| DREMEL® Glue Gun (1200-3/6) | 17 |
| DREMEL® Scroll Station™ | 18 |
| DREMEL® Scroll Station™ (1800-1/5) | 19 |
| Accessories | 21 |
| Carving / Engraving / Routing | 22 |
| 1. High Speed Cutters | 22 |
| 2. Engraving Cutters | 22 |
| 3. Diamond Wheel Points | 23 |
| 4. Tungsten Carbide Cutters | 23 |
| 5. Structured Tooth Tungsten Carbide Cutters | 24 |
| 6. Router Bits (HSS) | 24 |
| Grinding / Sharpening | 25 |
| 1. Aluminum Oxide Grinding Wheel | 25 |
| 2. Aluminum Oxide Grinding Stones | 25 |
| 3. Silicon Carbide Grinding Stones | 26 |
| 4. Abrasive Points | 26 |
| 5. Chainsaw Sharpening Grinding Stones | 27 |
| Cleaning / Polishing | 28 |
| 1. Rubber Polishing Points | 28 |
| 2. Impregnated Polishing Wheel | 28 |
| 3. Polishing Wheels | 29 |
| 4. Bristle Brushes | 29 |
| 5. Carbon Steel Brushes | 30 |
| 6. High-Performance Abrasive Brush | 30 |
| 7. Stainless Steel Brushes | 31 |
| 8. Brass Brushes | 31 |

Index by category

| | |
|---|-----------|
| Accessories | 21 |
| Cutting | 32 |
| 1. DREMEL® SpeedClic® | 32 |
| 2. Cut-Off Wheels | 32 |
| 3. Diamond Wheel | 33 |
| 4. Cutting/Shaping Wheel | 33 |
| 5. Rip/Cross-Cut Blade | 34 |
| 6. Spiral Cutting Bits | 34 |
| 7. Grout Removal Bits | 35 |
| Sanding | 36 |
| 1. Sanding Bands | 36 |
| 2. Flapwheels | 36 |
| 3. Finishing Abrasive Buffs | 37 |
| 4. Sanding Discs | 37 |
| Collets / Mandrels / Miscellaneous | 38 |
| 1. Collets | 38 |
| 2. Multi Chuck | 38 |
| 3. Mandrels | 39 |
| 4. Precision Drill Bit Set | 39 |
| 5. Wood Drill Bit Set | 40 |
| Accessory Kits | 41 |
| 100-pcs Accessory Set (701) | 41 |
| 110-pcs Accessory Set (697) | 41 |
| 140-pcs Accessory Set (700) | 42 |
| 175-pcs Accessory Set (698) | 42 |
| Cleaning / Polishing Set (684) | 43 |
| Multipurpose Set (687) | 43 |
| Cutting Set (688) | 44 |
| Attachments | 47 |
| Attachments to Reach | 48 |
| Flexible Shaft (225) | 48 |
| Right Angle Attachment (575) | 48 |
| Attachments to Rout | 49 |
| Plunge Router Attachment (335) | 49 |
| Shaper / Router Table (231) | 49 |
| Attachments to Sharpen | 50 |
| Chainsaw Sharpening Attachment (1453) | 50 |
| Lawn Mower Sharpening Attachment (675) | 50 |
| Attachments to Cut | 51 |
| Multipurpose Cutting Kit (565) | 51 |
| Wall Tile Cutting Kit (566) | 51 |
| Wall & Floor Grout Removal Kit (568) | 52 |

Index by category

| | |
|-------------------------------|-----------|
| Attachments | 47 |
| Attachments to Control | 53 |
| Workstation™ (220) | 53 |
| DREMELite™ (DL4) | 53 |
| D-Vise (2214) | 54 |
| Flex-Shaft Tool Holder (2222) | 54 |
| Attachments to Saw | 55 |
| Mini Saw Attachment (670) | 55 |
| Miscellaneous | 57 |
| Battery Packs | 58 |
| 9.6V NiCd (785) | 58 |
| 10.8V Li-Ion (855) | 58 |
| Goggles | 58 |
| Goggles (SG4) | 58 |
| Scroll saw blades | 59 |
| 16411 (16411) | 59 |
| 16412 (16412) | 59 |
| 16413 (16413) | 59 |
| 16440 (16440) | 59 |
| 16443 (16443) | 59 |
| 16446 (16446) | 59 |
| 16448 (16448) | 59 |
| 16453 (16453) | 59 |
| 16461 (16461) | 59 |
| 16463 (16463) | 59 |
| 16483 (16483) | 59 |
| Glue sticks | 59 |
| Glue Sticks (GS1) | 59 |
| Index by category | 60 |
| Index by numbers | 63 |
| EAN-Codes | 64 |

Index by numbers

| Product | Ordernumber | page | Product | Ordernumber | page | Product | Ordernumber | page |
|----------|-------------|------|---------|-------------|------|----------|-------------|------|
| 105 | 2615010532 | 22 | 454 | 2615045432 | 27 | 911 | 2615091132 | 25 |
| 106 | 2615010632 | 22 | 455 | 2615045532 | 27 | 932 | 2615093232 | 25 |
| 107 | 2615010732 | 22 | 456 | 26150456JA | 32 | 952 | 2615095232 | 25 |
| 108 | 2615010832 | 22 | 457 | 2615045732 | 27 | 953 | 2615095332 | 25 |
| 110 | 2615011032 | 22 | 461 | 2615046132 | 28 | 997 | 2615099732 | 25 |
| 111 | 2615011132 | 22 | 462 | 2615046232 | 28 | 1100-15 | F0131100JB | 15 |
| 113 | 2615011332 | 22 | 463 | 2615046332 | 28 | 1200-3/6 | F0131200JB | 17 |
| 114 | 2615011432 | 22 | 480 | 2615048032 | 38 | 1453 | 26151453PA | 50 |
| 115 | 2615011532 | 22 | 481 | 2615048132 | 38 | 1800-1/5 | F0131800JB | 19 |
| 117 | 2615011732 | 22 | 482 | 2615048232 | 38 | 2214 | 2615221432 | 54 |
| 118 | 2615011832 | 22 | 483 | 2615048332 | 38 | 2222 | 2615222232 | 54 |
| 125 | 2615012532 | 22 | 502 | 2615050232 | 36 | 4485 | 2615448532 | 38 |
| 134 | 2615013432 | 22 | 504 | 2615050432 | 36 | 4486 | 2615448632 | 38 |
| 144 | 2615014432 | 22 | 511 | 2615051165 | 37 | 7103 | 2615710332 | 23 |
| 192 | 2615019232 | 22 | 516 | 2615051632 | 26 | 7105 | 2615710532 | 23 |
| 193 | 2615019332 | 22 | 518 | 2615051832 | 26 | 7120 | 2615712032 | 23 |
| 194 | 2615019432 | 22 | 520 | 2615052065 | 28 | 7122 | 2615712232 | 23 |
| 196 | 2615019632 | 22 | 530 | 2615053032 | 31 | 7123 | 2615712332 | 23 |
| 199 | 2615019932 | 22 | 531 | 2615053132 | 31 | 7134 | 2615713432 | 23 |
| 220 | 26150220JB | 53 | 532 | 2615053232 | 31 | 7144 | 2615714432 | 23 |
| 225 | 26150225PD | 48 | 535 | 2615053532 | 31 | 8000-60 | F0138000JG | 13 |
| 231 | 2615023132 | 49 | 536 | 2615053632 | 31 | 8153 | 2615815332 | 25 |
| 300-1/55 | F0130300JE | 8 | 537 | 2615053732 | 31 | 8175 | 2615817532 | 25 |
| 300-25 | F0130300JB | 7 | 538 | 26150538JA | 30 | 8193 | 2615819332 | 25 |
| 335 | 26150335JA | 49 | 540 | 2615054032 | 32 | 8215 | 2615821532 | 25 |
| 400-1/55 | F0130400JH | 10 | 541 | 2615054132 | 25 | 9901 | 2615990132 | 23 |
| 400-4/80 | F0130400JE | 11 | 542 | 2615054265 | 33 | 9902 | 2615990232 | 23 |
| 401 | 2615040132 | 39 | 545 | 2615054565 | 33 | 9903 | 2615990332 | 23 |
| 402 | 2615040232 | 39 | 546 | 26150546JA | 34 | 9904 | 2615990432 | 23 |
| 403 | 2615040332 | 29 | 560 | 2615056032 | 34 | 9905 | 2615990532 | 23 |
| 404 | 2615040432 | 29 | 561 | 2615056132 | 34 | 9909 | 2615990932 | 23 |
| 405 | 2615040532 | 29 | 562 | 2615056232 | 34 | 9910 | 2615991032 | 23 |
| 407 | 2615040732 | 36 | 565 | 2615056532 | 51 | 9911 | 2615991132 | 23 |
| 408 | 2615040832 | 36 | 566 | 2615056632 | 51 | 9931 | 2615993132 | 24 |
| 409 | 2615040932 | 32 | 568 | 2615056832 | 52 | 9934 | 2615993432 | 24 |
| 411 | 2615041132 | 37 | 569 | 2615056932 | 35 | 9936 | 2615993632 | 24 |
| 412 | 2615041232 | 37 | 570 | 2615057032 | 35 | 16411 | 2615641132 | 59 |
| 413 | 2615041332 | 37 | 575 | 2615057532 | 48 | 16412 | 2615641232 | 59 |
| 414 | 2615041432 | 29 | 612 | 2615061232 | 24 | 16413 | 2615641332 | 59 |
| 420 | 2615042032 | 32 | 615 | 2615061532 | 24 | 16440 | 2615644032 | 59 |
| 421 | 2615042132 | 29 | 628 | 2615062832 | 39 | 16443 | 2615644332 | 59 |
| 422 | 2615042232 | 29 | 636 | 26150636JA | 40 | 16446 | 2615644632 | 59 |
| 423 | 2615042332 | 29 | 640 | 2615064032 | 24 | 16448 | 2615644832 | 59 |
| 425 | 2615042532 | 29 | 650 | 2615065032 | 24 | 16453 | 2615645332 | 59 |
| 426 | 2615042632 | 32 | 652 | 2615065232 | 24 | 16461 | 2615646132 | 59 |
| 426B | 2615426BJA | 32 | 654 | 2615065432 | 24 | 16463 | 2615646332 | 59 |
| 428 | 2615042832 | 30 | 655 | 26150655JA | 24 | 16483 | 2615648332 | 59 |
| 429 | 2615042932 | 29 | 670 | 26150670JA | 55 | 83142 | 2615314232 | 26 |
| 430 | 2615043032 | 36 | 675 | 26150675AB | 50 | 83322 | 2615332232 | 26 |
| 431 | 2615043132 | 36 | 684 | 26150684JA | 43 | 83702 | 2615370232 | 26 |
| 432 | 2615043232 | 36 | 687 | 26150687JA | 43 | 84922 | 2615492232 | 26 |
| 438 | 2615043832 | 36 | 688 | 26150688JA | 44 | 85422 | 2615542232 | 26 |
| 439 | 2615043932 | 36 | 697 | 26150697JC | 41 | 85602 | 2615560232 | 26 |
| 440 | 2615044032 | 36 | 698 | 26150698JA | 42 | DL4 | 26150DL4JA | 53 |
| 442 | 2615044232 | 30 | 700 | 26150700JA | 42 | GS1 | 26150GS1JA | 59 |
| 443 | 2615044332 | 30 | 701 | 26150701JA | 41 | SC406 | 2615S406JA | 32 |
| 444 | 2615044432 | 36 | 785 | 26150785PB | 58 | SC426 | 2615S426JA | 32 |
| 453 | 2615045332 | 27 | 855 | 26150855JB | 58 | SG4 | 26150SG4JA | 58 |