

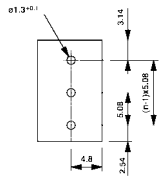

LM 5.08/90

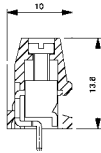

Technical data	VDE	UL	CSA
Rated voltage (V)	250*	300	300
Rated current (A)	17.5	10	10
Wire size (mm ² /AWG)	1.5	24...12	14

*Pollution severity 3 / Overvoltage category III

Additional technical data see page 53

Solder pin length **3.5 mm** **3.5 mm**

Color				
Poles	Type	Part No.	Part No.	Qty.
2	LM 5.08/2/90	1716080000	1716020000	500
3	LM 5.08/3/90	1716090000	1716030000	500
4	LM 5.08/4/90	999413	999392	
5	LM 5.08/5/90	999414	999393	
6	LM 5.08/6/90	999415	999394	
7	LM 5.08/7/90	999416	999395	
8	LM 5.08/8/90	999417	999396	
9	LM 5.08/9/90	999418	999397	
10	LM 5.08/10/90	999419	999398	
11	LM 5.08/11/90	999420	999399	
12	LM 5.08/12/90	999421	999400	
13	LM 5.08/13/90	999422	999401	
14	LM 5.08/14/90	999423	999402	
15	LM 5.08/15/90	999424	999403	
16	LM 5.08/16/90	999425	999404	
17	LM 5.08/17/90	999426	999405	
18	LM 5.08/18/90	999427	999406	
19	LM 5.08/19/90	999428	999407	
20	LM 5.08/20/90	999429	999408	
21	LM 5.08/21/90	999430	999409	
22	LM 5.08/22/90	999431	999410	
23	LM 5.08/23/90	999432	999411	
24	LM 5.08/24/90	999433	999412	

Accessories	Page
Marking	42
Mounting	-
Miscellaneous	45

LM 5.08/135

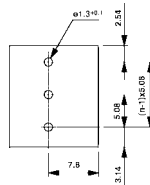
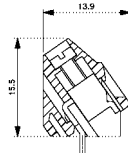

Technical data	VDE	UL	CSA
Rated voltage (V)	250*	300	300
Rated current (A)	17.5	10	10
Wire size (mm ² /AWG)	1.5	24...12	14

*Pollution severity 3 / Overvoltage category III

Additional technical data see page 53

Solder pin length **3.5 mm** **3.5 mm**

Color				
Poles	Type	Part No.	Part No.	Qty.
2	LM 5.08/2/135	1716120000	1716060000	500
3	LM 5.08/3/135	1716130000	1716070000	500
4	LM 5.08/4/135	999455	999434	
5	LM 5.08/5/135	999456	999435	
6	LM 5.08/6/135	999457	999436	
7	LM 5.08/7/135	999458	999437	
8	LM 5.08/8/135	999459	999438	
9	LM 5.08/9/135	999460	999439	
10	LM 5.08/10/135	999461	999440	
11	LM 5.08/11/135	999462	999441	
12	LM 5.08/12/135	999463	999442	
13	LM 5.08/13/135	999464	999443	
14	LM 5.08/14/135	999465	999444	
15	LM 5.08/15/135	999466	999445	
16	LM 5.08/16/135	999467	999446	
17	LM 5.08/17/135	999468	999447	
18	LM 5.08/18/135	999469	999448	
19	LM 5.08/19/135	999470	999449	
20	LM 5.08/20/135	999471	999450	
21	LM 5.08/21/135	999472	999451	
22	LM 5.08/22/135	999473	999452	
23	LM 5.08/23/135	999474	999453	
24	LM 5.08/24/135	999475	999454	

Accessories	Page
Marking	42
Mounting	-
Miscellaneous	45

LM 5.08/180

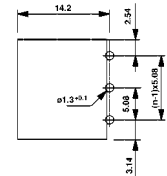
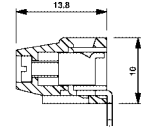

Technical data	VDE	UL	CSA
Rated voltage (V)	250*	300	300
Rated current (A)	17.5	10	10
Wire size (mm ² /AWG)	1.5	24...12	14

*Pollution severity 3 / Overvoltage category III

Additional technical data see page 53

Solder pin length **3.5 mm** **3.5 mm**

Color				
Poles	Type	Part No.	Part No.	Qty.
2	LM 5.08/2/180	1716100000	1716040000	500
3	LM 5.08/3/180	1716110000	1716050000	500
4	LM 5.08/4/180	999497	999476	
5	LM 5.08/5/180	999498	999477	
6	LM 5.08/6/180	999499	999478	
7	LM 5.08/7/180	999500	999479	
8	LM 5.08/8/180	999501	999480	
9	LM 5.08/9/180	999502	999481	
10	LM 5.08/10/180	999503	999482	
11	LM 5.08/11/180	999504	999483	
12	LM 5.08/12/180	999505	999484	
13	LM 5.08/13/180	999506	999485	
14	LM 5.08/14/180	999507	999486	
15	LM 5.08/15/180	999508	999487	
16	LM 5.08/16/180	999509	999488	
17	LM 5.08/17/180	999510	999489	
18	LM 5.08/18/180	999511	999490	
19	LM 5.08/19/180	999512	999491	
20	LM 5.08/20/180	999513	999492	
21	LM 5.08/21/180	999514	999493	
22	LM 5.08/22/180	999515	999494	
23	LM 5.08/23/180	999521	999495	
24	LM 5.08/24/180	999522	999496	

Accessories	Page
Marking	42
Mounting	-
Miscellaneous	45