

**NOTES :**

**I- MATERIAL:**

-HOUSING: POLYESTER FIBER GLASS FILLED UL 94-V0  
COLOR BLACK.

-TERMINAL: PHOSPHOR BRONZE.

**PLATING :**

POST PLATE 0.00127-0.00152/.000050-.000060 GOLD IN CONTACT AREA , 0.00190/.000075 MIN. PURE TIN IN TAIL AREA BOTH OVER 0.00127/.000050 MIN NICKEL OVERALL.

- 2- JACK FOR MATING WITH F.C.C. 68 PLUGS (90075 MOLEX SERIES).
- 3- PRODUCT SPECIFICATION PS-95003 AND PS-85505 (SECTION 5.2).
- 4- APPLICATION SPECIFICATION AS-95001.
- 5- PACKAGING SPECIFICATION PK-95022 (TRAY PACKAGING).
- 6- EXCEEDS CATEGORY 5E PERFORMANCE.
- 7- PC BOARD THICKNESS: 1.57/.062

OPTIONAL RIBS

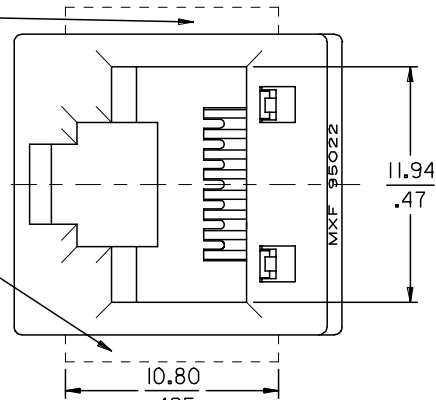

JACK WITH RIBS  
MATERIAL NR.: 85506-0001

JACK WITHOUT RIBS  
MATERIAL NR.: 85506-0002

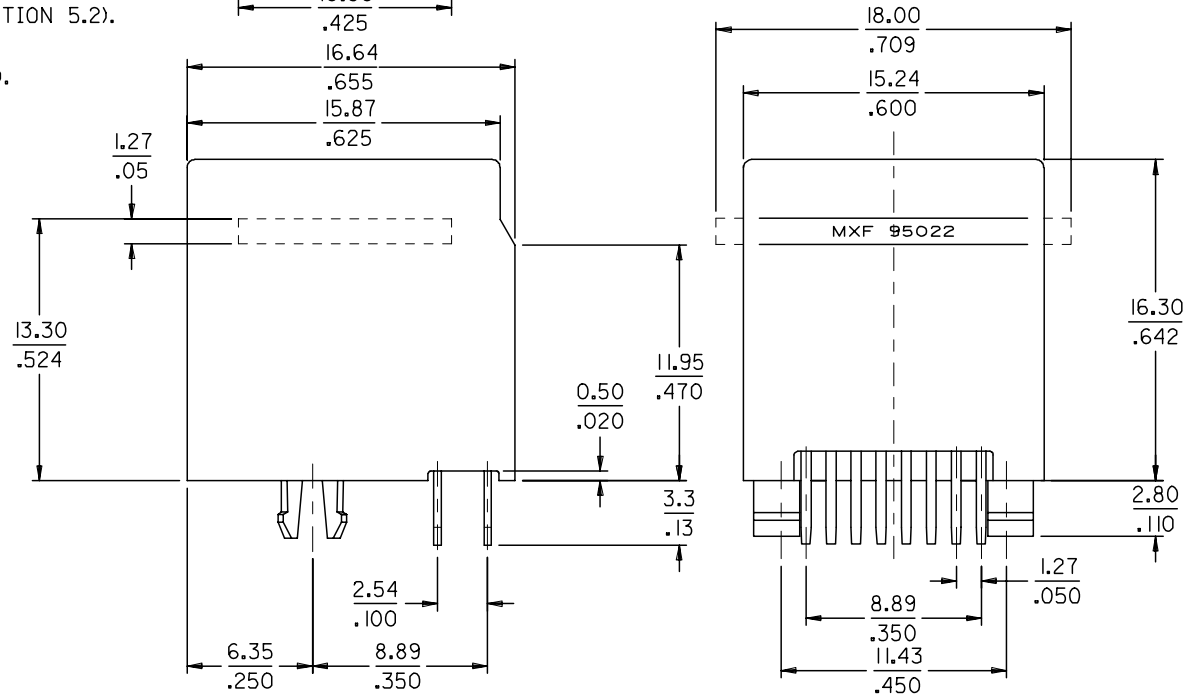

**P.C.B. MOUNTING PATTERN**  
(see from component side)

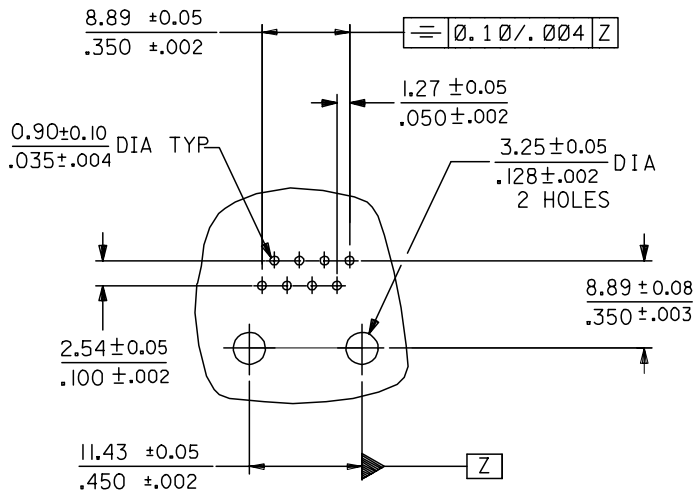

SCALE 2:1

<b>ENTER DESCRIPTION</b> EC NO: MG2005-0147 DRAWN: CEBASTI 2004/10/21 CHKD: FCARABET 2004/10/22 APPR: KNOLLER 2004/11/04	<b>QUALITY SYMBOLS</b> ▽=0 ▽=0	<b>GENERAL TOLERANCES (UNLESS SPECIFIED)</b>		<b>DIMENSION STYLE</b> MM/IN	<b>SCALE</b> 4:1	<b>DESIGN UNITS</b> METRIC	THIRD ANGLE PROJECTION
		4 PLACES ± --- ± --- 3 PLACES ± --- ± .006 2 PLACES ± 0.15 ± .010 1 PLACE ± 0.25 ± --- ANGULAR ± 2 °	DRAWN BY FB	DATE 98/02/25	<b>TITLE</b> HIGH SPEED MODULAR JACK HIGH PROFILE TOP ENTRY THROUGH HOLE 8 CIRCUIT		
		DRAFT WHERE APPLICABLE MUST REMAIN WITHIN DIMENSIONS	APPROVED BY	DATE	MOLEX INCORPORATED		
		SEE CHART	MATERIAL NO.	DOCUMENT NO. SD-85506-001	SHEET NO. 1 OF 1		

**NOTES :**

**1- MATERIAL:**

-HOUSING: LCP FIBER GLASS FILLED UL 94-V0  
COLOR BLACK.

-TERMINAL: PHOSPHOR BRONZE.

**PLATING :**

POST PLATE 0.00127-0.00152/.000050-.000060 GOLD IN CONTACT AREA , 0.00190/.000075 MIN. PURE TIN IN TAIL AREA BOTH OVER 0.00127/.000050 MIN NICKEL OVERALL.

2- JACK FOR MATING WITH F.C.C. 68 PLUGS (90075 MOLEX SERIES).

3- PRODUCT SPECIFICATION PS-85506-001

4- PACKAGING SPECIFICATION PK-95022 (TRAY PACKAGING).

5- EXCEEDS CATEGORY 5E PERFORMANCE.

6- PC BOARD THICKNESS: 1.57/.062

7- MANUFACTURING I.D. CAN BE MG, MXF OR MXI.

8- APPLICATION SPECIFICATION: AS-85513-001

OPTIONAL RIBS

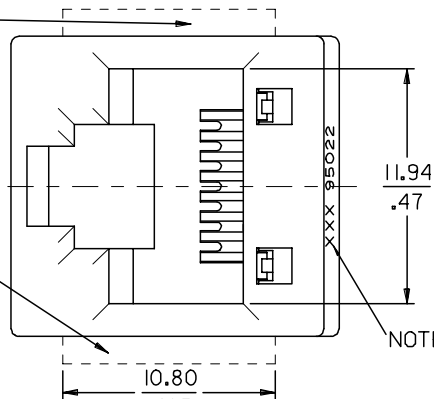

JACK WITH RIBS  
MATERIAL NR.: 85506-5001

---

JACK WITHOUT RIBS  
MATERIAL NR.: 85506-5002

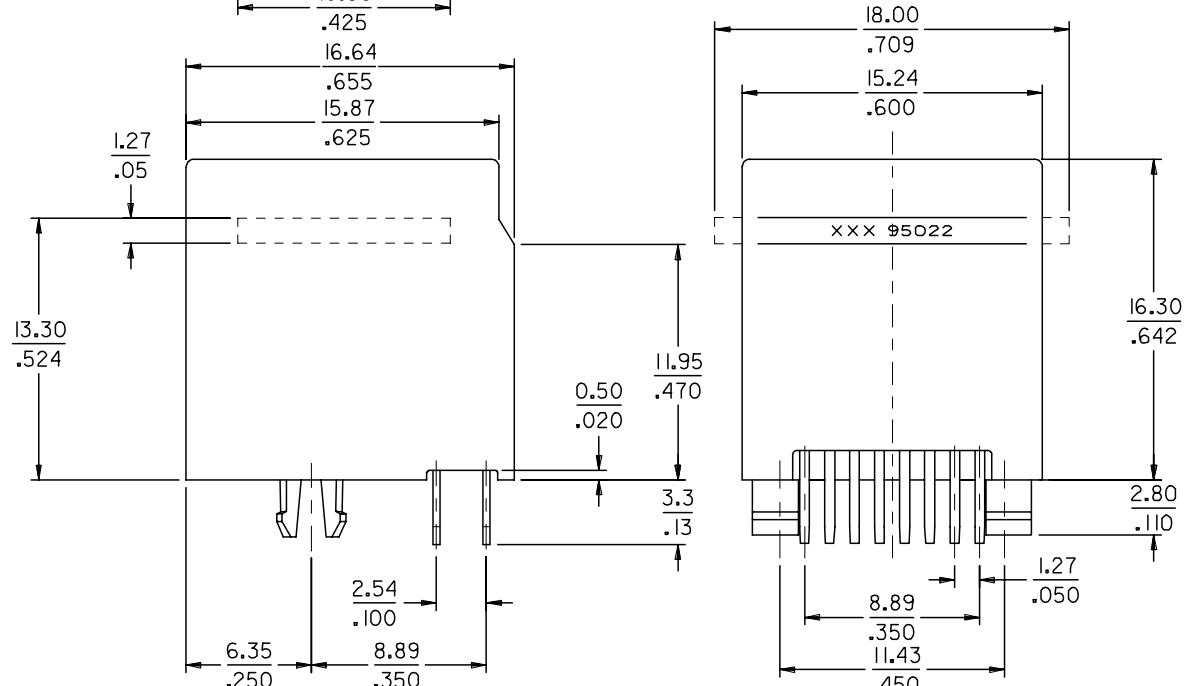

**P.C.B. MOUNTING PATTERN**  
(see from component side)

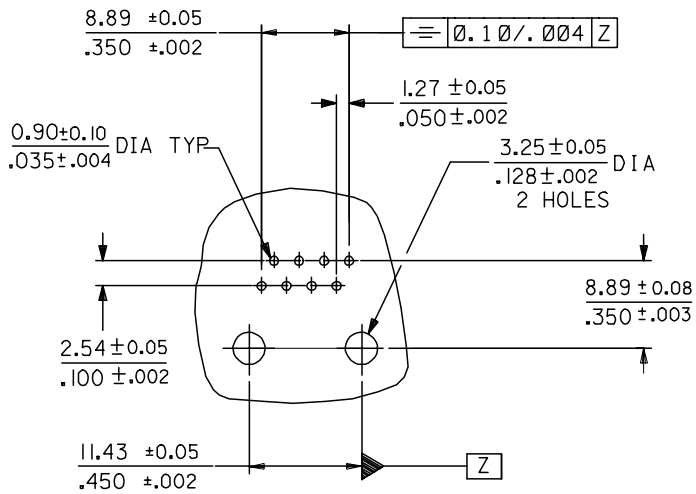

SCALE 2:1

MODIFIED NOTES EC NO: E2008-0057 DRWN:DBYRNES CHKD: APPR:EOMAHONY	2007/08/03	2007/08/03
	2007/08/03	2007/08/07
	2007/08/03	2007/08/07
	2007/08/03	2007/08/07

QUALITY SYMBOLS	▽=0
	∇=0

GENERAL TOLERANCES (UNLESS SPECIFIED)	
mm	INCH
4 PLACES ± ---	± ---
3 PLACES ± ---	± .006
2 PLACES ± 0.15	± .010
1 PLACE ± 0.25	± ---
ANGULAR ± 2 °	
DRAFT WHERE APPLICABLE MUST REMAIN WITHIN DIMENSIONS	

DIMENSION STYLE	
MM/IN	
DRAWN BY	DATE
FB	98/02/25
CHECKED BY	DATE
MF	1998/02/26
APPROVED BY	DATE
FB	1998/02/28
MATERIAL NO.	
SEE CHART	
SIZE	
A3	

SCALE	DESIGN UNITS	THIRD ANGLE PROJECTION
4:1	METRIC	
TITLE		
HIGH SPEED MODULAR JACK HIGH PROFILE TOP ENTRY THROUGH HOLE 8 CIRCUIT		
MOLEX INCORPORATED		
DOCUMENT NO.	SHEET NO.	
SD-85506-501	1 OF 1	
THIS DRAWING CONTAINS INFORMATION THAT IS PROPRIETARY TO MOLEX INCORPORATED AND SHOULD NOT BE USED WITHOUT WRITTEN PERMISSION		