

PRESSED ALUMINIUM - LOUVRE SINKS

LS160 TO220, TO126, TO3P **14°C/W**
AND MOST PLASTIC PACKAGED DEVICES
HEAT SINK WILL ACCEPT ONE OR TWO DEVICES

595-846

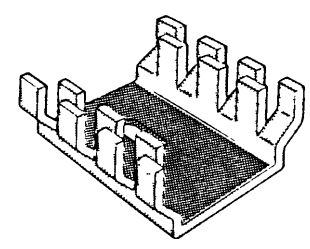
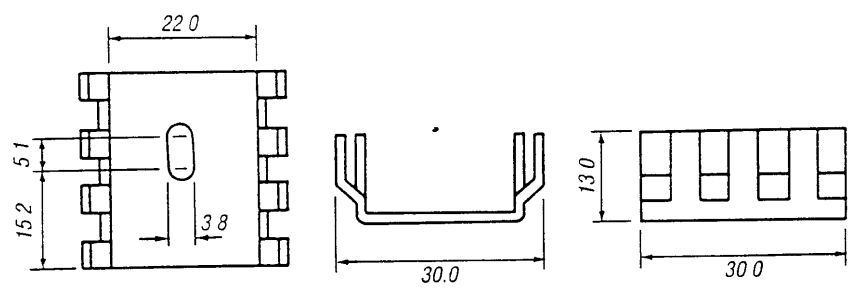

LS165 TO220, TO3P **17°C/W**

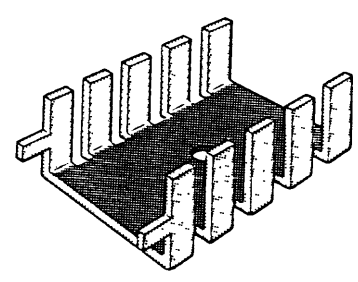
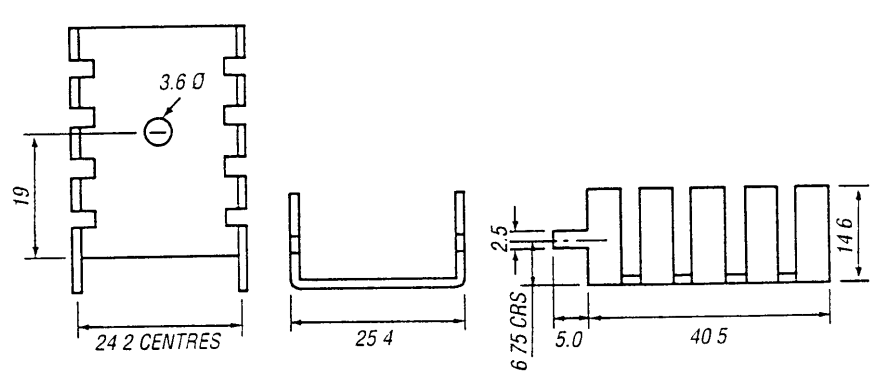

LS170 TO126 **21°C/W**

