

**Sensor Rundsteckverbinder    Sensor Round Connectors**  
**konfektionierbar                    assembly possible**  
**Serie 713    M12x1                    Series 713    M12x1**

Bezeichnung Designation	Polzahl No. of cont.	Bestell - Nummer/Ordering number			
		schwarz/black	PG	transparent/transparent	PG
Kupplungsstecker mit Gewindevorriegelungsring Kunststoff	4	99 - 0429 - 43 - 04	7	—	—
		99 - 0429 - 57 - 04	9	—	—
Male cable connector with plastic thread locking ring	5	99 - 0437 - 43 - 05	7	—	—
		99 - 0437 - 57 - 05	9	—	—
Kupplungsstecker mit Gewindevorriegelungsring Metall	3	99 - 0429 - 07 - 04	7	—	—
		99 - 0429 - 158 - 04	9	—	—
Male cable connector with metal thread locking ring	4	99 - 0429 - 14 - 04	7	99 - 0429 - 34 - 04	7
		99 - 0429 - 12 - 04	9	99 - 0429 - 31 - 04	9
Male cable connector with metal thread locking ring	5	99 - 0437 - 14 - 05	7	—	—
		99 - 0437 - 12 - 05	9	—	—
Kupplungsstecker Metallgehäuse, vernickelt	4	99 - 0429 - 55 - 04	7	—	—
Male cable connector metal housing, nickel	5	99 - 0437 - 55 - 05	7	—	—
Kupplungsstecker VA-Gewindering, vergoldete Kontakte	4	99 - 0429 - 82 - 04	7	—	—
Male cable connector ring nut (stainless steel) contacts with gold finish	5	99 - 0437 - 82 - 05	7	—	—

**Sensor Rundsteckverbinder**  
**konfektionierbar**  
**Serie 713 M12x1**

**Sensor Round Connectors**  
**assembly possible**  
**Series 713 M12x1**

Abbildung  
Figure

Maßzeichnung  
Drawing mm (inch)

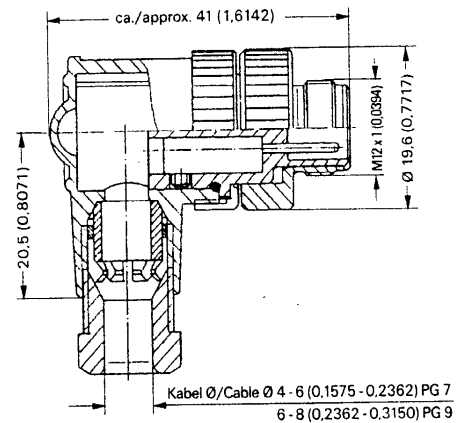
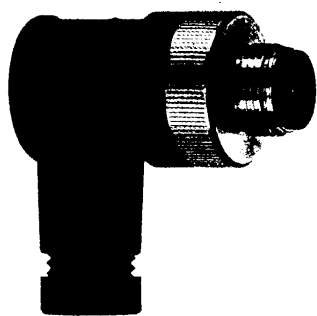
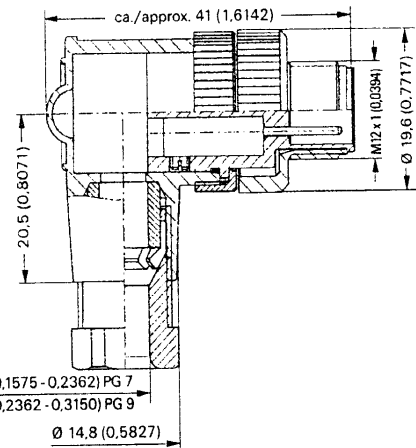
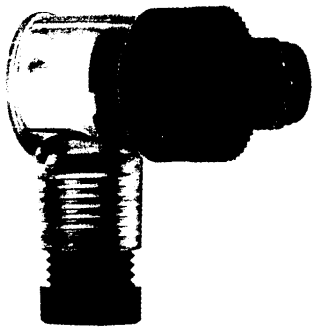

PG 11. 2 Kabel/cables Ø 4 - 5 (0,1575 - 0,1969)  
 2 Kabel/cables Ø 3 - 4 (0,1181 - 0,1575)

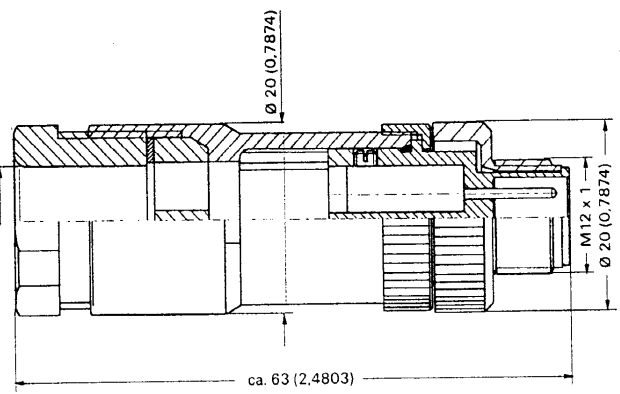



**Sensor Rundsteckverbinder    Sensor Round Connectors**  
**konfektionierbar                    assembly possible**  
**Serie 713    M12x1                    Series 713    M12x1**

Bezeichnung Designation	Polzahl No. of cont.	Bestell - Nummer/Ordering number			
		schwarz/black	PG	transparent/transparent	PG
Winkelstecker mit Gewindeverriegelungsring Kunststoff	4	99 - 0429 - 44 - 04	7	99 - 0429 - 20 - 04	7
	5	99 - 0437 - 44 - 05	7	—	—
Male angled connector with plastic thread locking ring	3	99 - 0429 - 27 - 04	7	—	—
	3	99 - 0429 - 161 - 04	9	—	—
Winkelstecker mit Gewindeverriegelungsring Metall	4	99 - 0429 - 24 - 04	7	99 - 0429 - 54 - 04	7
		99 - 0429 - 52 - 04	9	99 - 0429 - 53 - 04	9
Male angled connector with metal thread locking ring	5	99 - 0437 - 24 - 05	7	—	—
		99 - 0437 - 52 - 05	9	—	—
Duostecker mit Gewindeverriegelungsring Kunststoff, Kabelabgang PG 11 für zwei Kabel Ø 3 - 5 mm und Kabelbinder für Zugentlastung	4	99 - 0429 - 142 - 04	11	—	—
	5	99 - 0437 - 142 - 05	11	—	—
Twin Connector with thread locking ring synthetic material, PG 11 cable outlet for two cables Ø 3 - 5 mm and binder for cable clamp	5	99 - 0437 - 142 - 05	11	—	—

Sensor Rundsteckverbinder  
 konfektionierbar  
 Serie 713 M12x1

Sensor Round Connectors  
 assembly possible  
 Series 713 M12x1

Abbildung  
 Figure

Maßzeichnung  
 Drawing mm (inch)

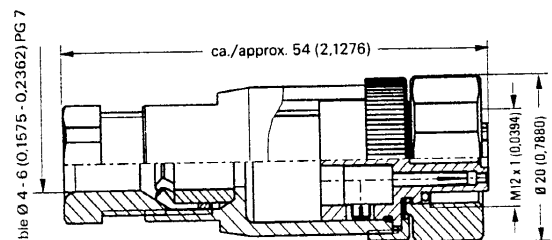
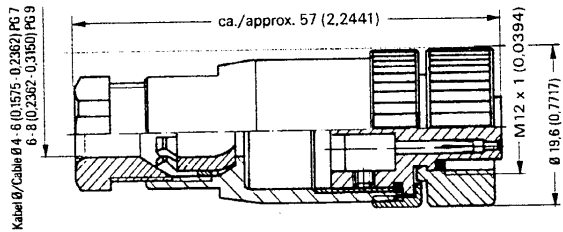
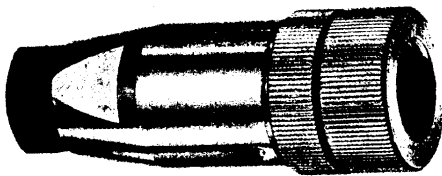
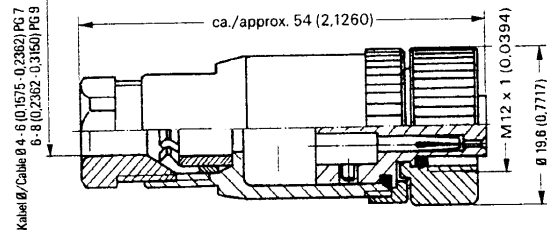
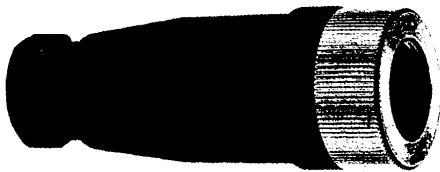
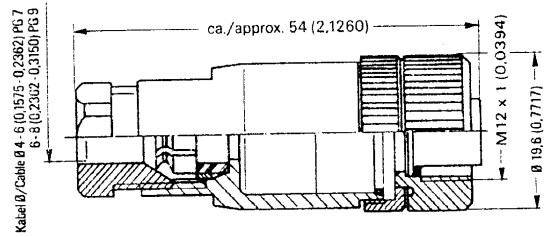
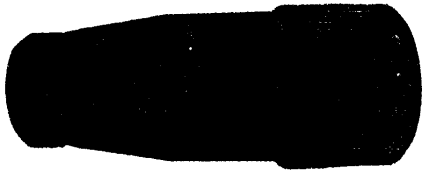





**Sensor Rundsteckverbinder konfektionierbar Serie 713 M12x1**      **Sensor Round Connectors assembly possible Series 713 M12x1**

Abbildung  
Figure

Maßzeichnung  
Drawing mm (inch)

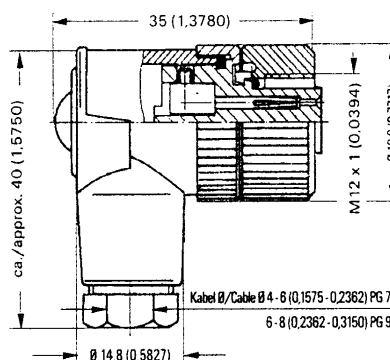
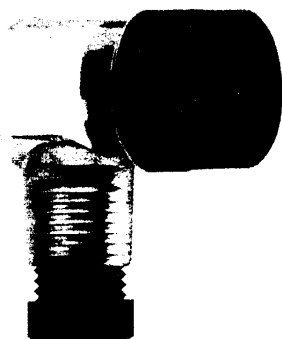

Verdrehen des Kontakteinsatzes zum Winkelabgang im 90° Raster möglich/  
Twisting of contact insert to angle outlet possible in 90° screen

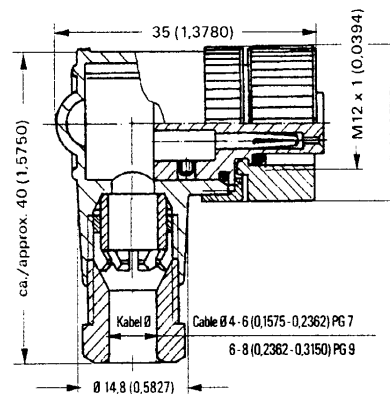
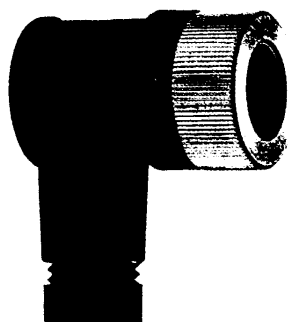

Verdrehen des Kontakteinsatzes zum Winkelabgang im 90° Raster möglich/  
Twisting of contact insert to angle outlet possible in 90° screen

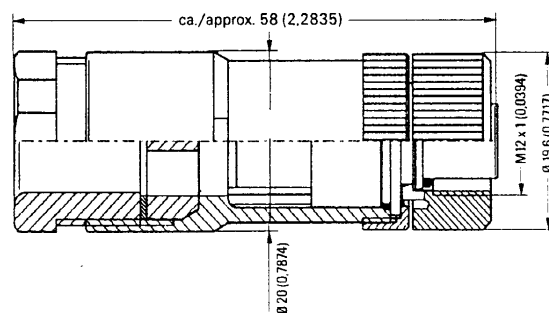



**Sensor Rundsteckverbinder konfektionierbar Serie 713 M12x1**      **Sensor Round Connectors assembly possible Series 713 M12x1**

Bezeichnung Designation	Polzahl No. of cont.	Bestell - Nummer/Ordering number			
		schwarz/black	PG	transparent/transparent	PG
Winkeldose mit Gewindevorriegelungsring Kunststoff	4	99 - 0430 - 00 - 04	7	99 - 0430 - 20 - 04	7
		99 - 0430 - 69 - 04	9	99 - 0430 - 68 - 04	9
Female angled connector with plastic thread locking ring	5	99 - 0436 - 00 - 05	7	—	—
		99 - 0436 - 69 - 05	9	—	—
Winkeldose mit Gewindevorriegelungsring Metall	3	99 - 0430 - 27 - 04	7	—	—
		99 - 0430 - 161 - 04	9	—	—
Female angled connector with metal thread locking ring	4	99 - 0430 - 24 - 04	7	99 - 0430 - 54 - 04	7
		99 - 0430 - 52 - 04 <b>RL</b>	9	99 - 0430 - 53 - 04	9
Female angled connector with metal thread locking ring	5	99 - 0436 - 24 - 05	7	—	—
		99 - 0436 - 52 - 05 <b>RL</b>	9	—	—
Duodose mit Gewindevorriegelungsring Kunststoff Kabelabgang PG 11 für 2 Kabel Ø 3-5 mm und Kabelbinder für Zugentlastung	4	99 - 0430 - 142 - 04	11	—	—
Twin female connector with plastic thread locking ring cable outlet PG 11 for two cables Ø 3-5 mm and cable binder for cable clamp	5	99 - 0436 - 142 - 05	11	—	—



**Sensor Rundsteckverbinder**  
**konfektionierbar, schirmbar**  
**Serie 713 M12x1**

**Sensor Round Connectors**  
**assembly possible, shieldable**  
**Series 713 M12x1**

Abbildung  
Figure

Maßzeichnung  
Drawing mm (inch)

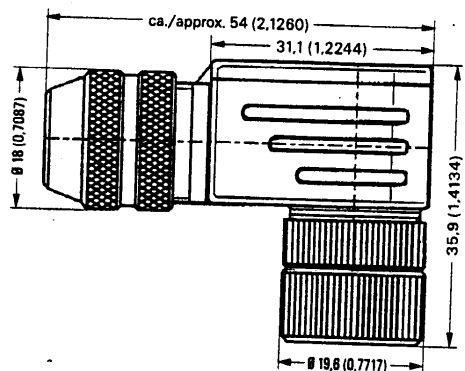
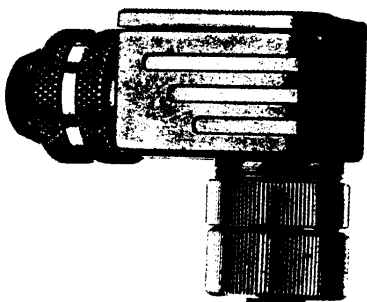
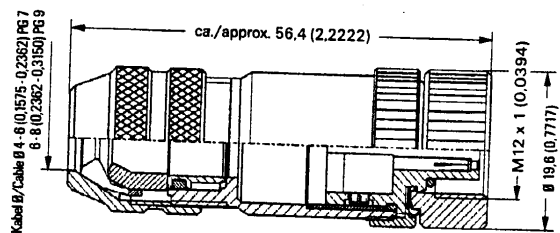
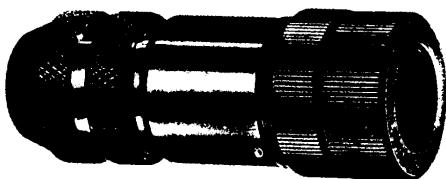
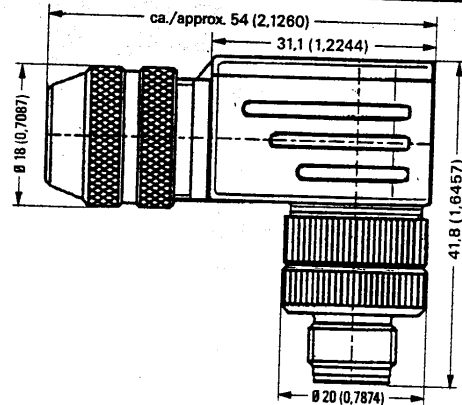
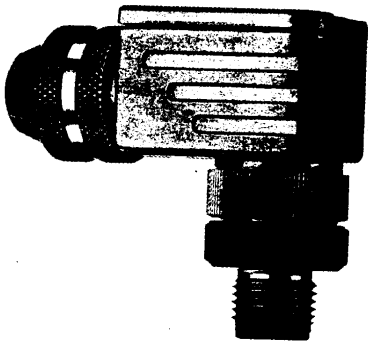
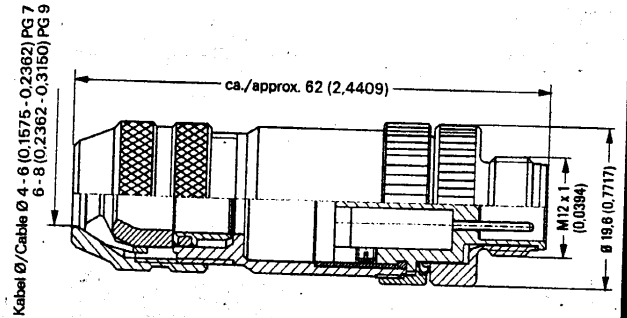
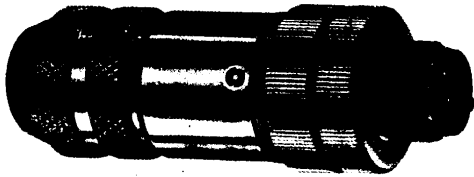

**Sensor Rundsteckverbinder** **Sensor Round Connectors**  
**konfektionierbar, schirmbar** **assembly possible, shieldable**  
**Serie 713 M12x1** **Series 713 M12x1**

Bezeichnung Designation	Polzahl No. of cont.	Bestell - Nummer Ordering number	Kabelauslaß cable outlet mm (inch)
Kupplungsstecker Metallgehäuse, schirmbar mit Gewindevverriegelungsring Metall	4	99 - 1429 - 814 - 04	6 (0,2362)
		99 - 1429 - 812 - 04	8 (0,3150)
Male cable connector metal housing, shieldable with metal thread locking ring	5	99 - 1437 - 814 - 05	6 (0,2362)
		99 - 1437 - 812 - 05	8 (0,3150)
Winkelstecker Metallgehäuse, schirmbar Gewindevverriegelungsring Metall	4	99 - 1429 - 824 - 04	6 (0,2362)
		99 - 1429 - 822 - 04	8 (0,3150)
Male angled connector metal housing, shieldable with metal thread locking ring	5	99 - 1437 - 824 - 05	6 (0,2362)
		99 - 1437 - 822 - 05	8 (0,3150)
Kupplungsdose Metallgehäuse, schirmbar Gewindevverriegelungsring Metall	4	99 - 1430 - 814 - 04	6 (0,2362)
		99 - 1430 - 812 - 04	8 (0,3150)
Female cable connector metal housing, shieldable with metal thread locking ring	5	99 - 1436 - 814 - 05	6 (0,2362)
		99 - 1436 - 812 - 05	8 (0,3150)
Winkeldose Metallgehäuse, schirmbar Gewindevverriegelungsring Metall	4	99 - 1430 - 824 - 04	6 (0,2362)
		99 - 1430 - 822 - 04	8 (0,3150)
Female angled connector metal housing, shieldable with metal thread locking ring	5	99 - 1436 - 824 - 05	6 (0,2362)
		99 - 1436 - 822 - 05	8 (0,3150)



**Sensor Rundsteckverbinder**    **Sensor Round Connectors**  
**konfektionierbar**                      **assembly possible**  
**Serie 713 M12x1**                      **Series 713 M12x1**

Abbildung  
Figure

Maßzeichnung  
Drawing mm (inch)

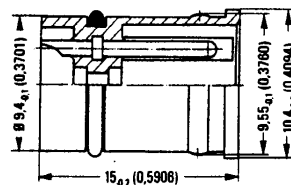
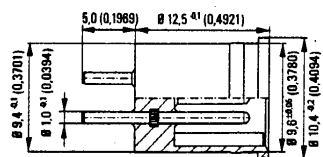
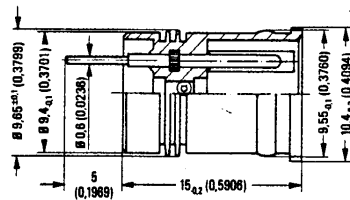
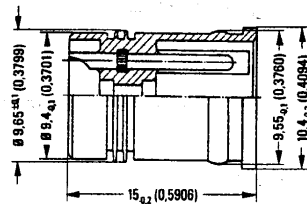
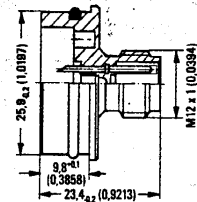
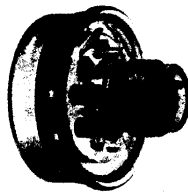
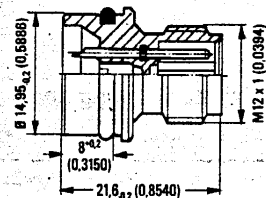
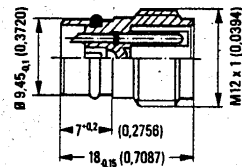





**Sensor Rundsteckverbinder positionierbar Serie 713 M12x1**      **Sensor Round Connectors positioning possible Series 713 M12x1**

Abbildung  
Figure

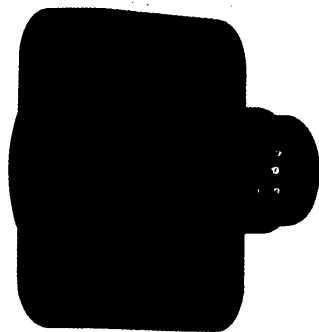

Maßzeichnung  
Drawing mm (inch)

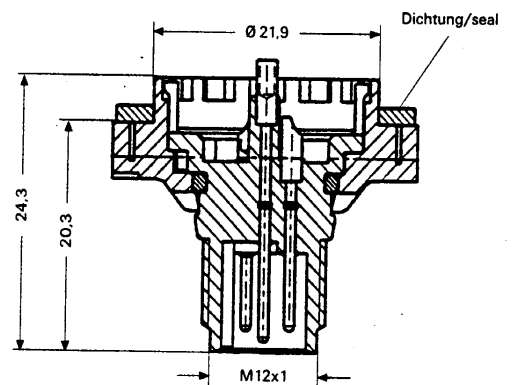
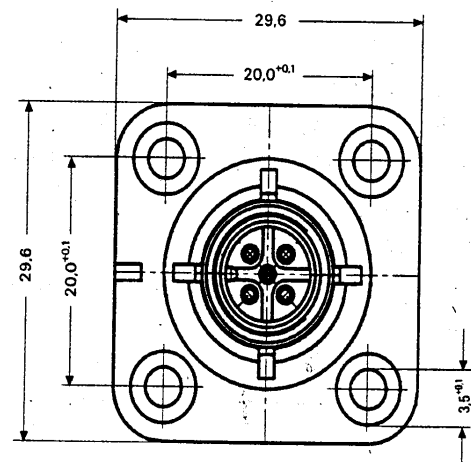

Dichtung/seal	Bestell-Nr.
	044 1125 A 1



a	b/mm (inch)
M12 x 0.5	15 (0.5906)
PG9	18 (0.7087)
PG11	22 (0.8661)
PG13,5	23 (0.9055)

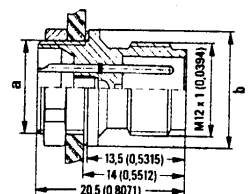



**Sensor Rundsteckverbinder positionierbar Serie 713 M12x1**      **Sensor Round Connectors positioning possible Series 713 M12x1**

Bezeichnung Designation	Polzahl No. of cont.	Bestell - Nummer Ordering number
Vierkantflanschstecker M12x1, positionierbar	4	09 - 0431 - 16 - 04
Square male socket M12x1, positioning possible	5	09 - 0433 - 16 - 05

Einbaustecker mit Befestigungsgewinde löten	Befestigungsgewinde fixing thread				
		M12 x 0,5	PG9	PG11	PG13,5
Male socket with fixing thread soldering	4	09-0431-81-04	09-0431-87-04	09-0435-87-04	09-0439-87-04
	5	09-0433-81-05	09-0433-87-05	09-0437-87-05	09-0449-87-05



# Sensor Rundsteckverbinder **Sensor Round Connectors** konfektionierbar, Zubehör **assembly possible, accessories** Serie 713 M12x1 **Series 713 M12x1**

Abbildung  
Figure

Maßzeichnung  
Drawing mm (inch)

Leiterplatten/PCB's

Beschaltung/Wiring

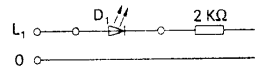

$U_{max} = 28 V$

	Wire	Wire	LED
Part Nr.	L <sub>1</sub>	0	D <sub>1</sub>
713-0-08-0461-00-00	rot/red	blau/blue	rot/red
713-0-08-0472-00-00	rot/red	blau/blue	gelb/yellow
713-0-08-0466-00-00	rot/red	blau/blue	grün/green

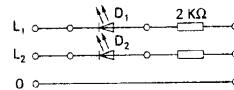
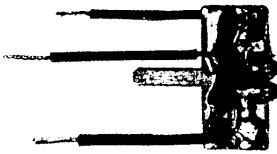

$U_{max} = 28 V$

	Wire	Wire	Wire	LED	LED
Part Nr.	L <sub>1</sub>	L <sub>2</sub>	0	D <sub>1</sub>	D <sub>2</sub>
713-0-08-0463-00-00	blau/blue	schwarz/black	braun/brown	grün/green	gelb/yellow
713-0-08-0467-00-00	blau/blue	schwarz/black	braun/brown	rot/red	grün/green

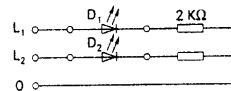
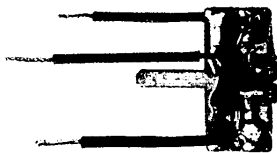

$U_{max} = 28 V$

	Wire	Wire	Wire	LED	LED
Part Nr.	L <sub>1</sub>	L <sub>2</sub>	0	D <sub>1</sub>	D <sub>2</sub>
713-0-08-0462-00-00	braun/brown	schwarz/black	blau/blue	grün/green	gelb/yellow
713-0-08-0460-00-00	braun/brown	schwarz/black	blau/blue	rot/red	grün/green

Schlauchverschraubung/Screwing for tube

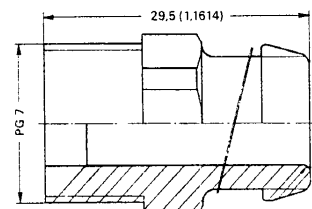

**Sensor Rundsteckverbinder**  
**konfektionierbar, Zubehör**  
**Serie 713 M12x1**

**Sensor Round Connectors**  
**assembly possible, accessories**  
**Series 713 M12x1**

Bezeichnung Designation	Polzahl No. of cont.		Bestell - Nummer Ordering number
LP mit LED	LED	PNP	NPN
PCB with LED	rot red	08 - 0461 - 000 - 000	—
PCB with LED	gelb yellow	08 - 0472 - 000 - 000	—
PCB with LED	grün green	08 - 0466 - 000 - 000	—
LP mit zwei LED's	grün/ gelb green/ yellow	—	08 - 0463 - 000 - 000
PCB with two LED's	rot/ grün red/ green	—	08 - 0467 - 000 - 000
LP mit zwei LED's	grün/ gelb green/ yellow	08 - 0462 - 000 - 000	—
PCB with two LED's	rot/ grün red/ green	08 - 0460 - 000 - 000	—

Schlauchverschraubung

02 - 0273 - 000

Screwing for tube



# Sensor Rundsteckverbinder **Sensor Round Connectors** konfektionierbar **assembly possible** Serie 713 M12x1 **Series 713 M12x1**

Montageanleitung  
 Assembly

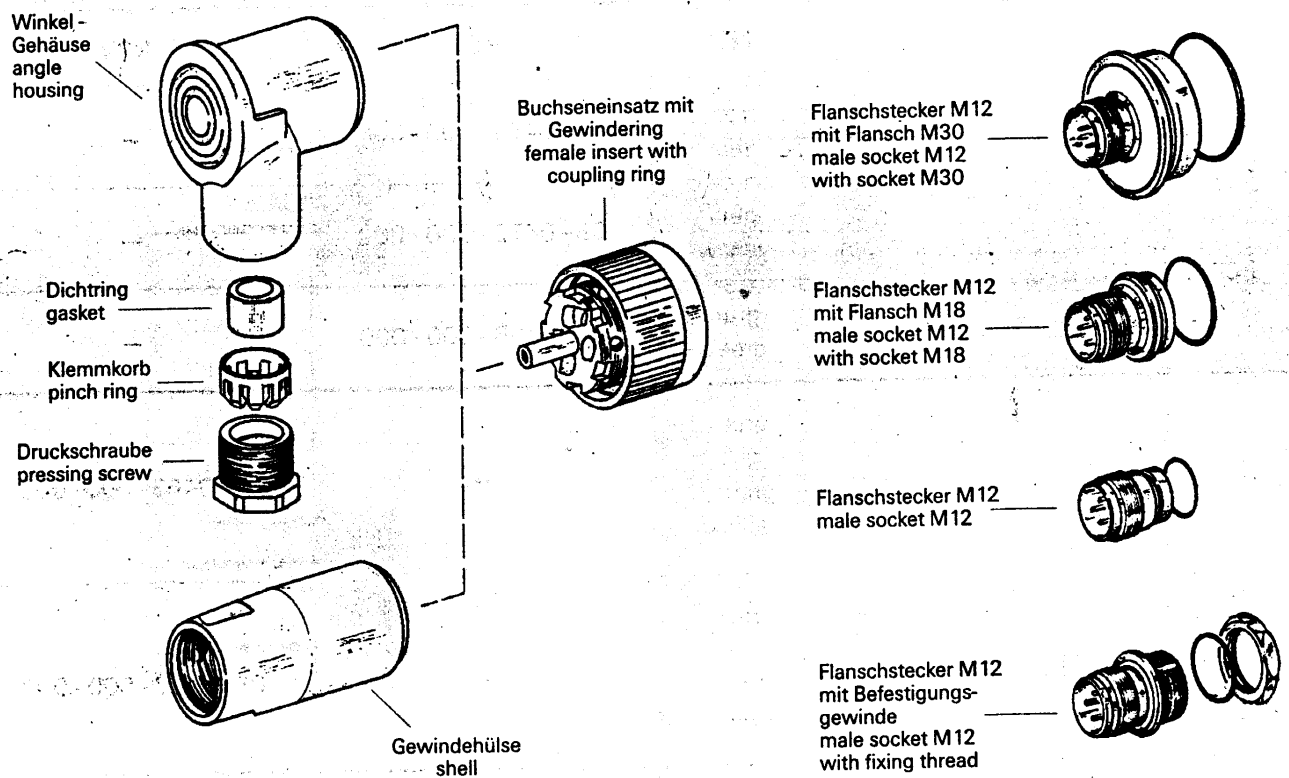

Strombelastbarkeitskurve (nach IEC 512 Teil 3) /  
 Load line (in accordance with IEC 512 part 3)

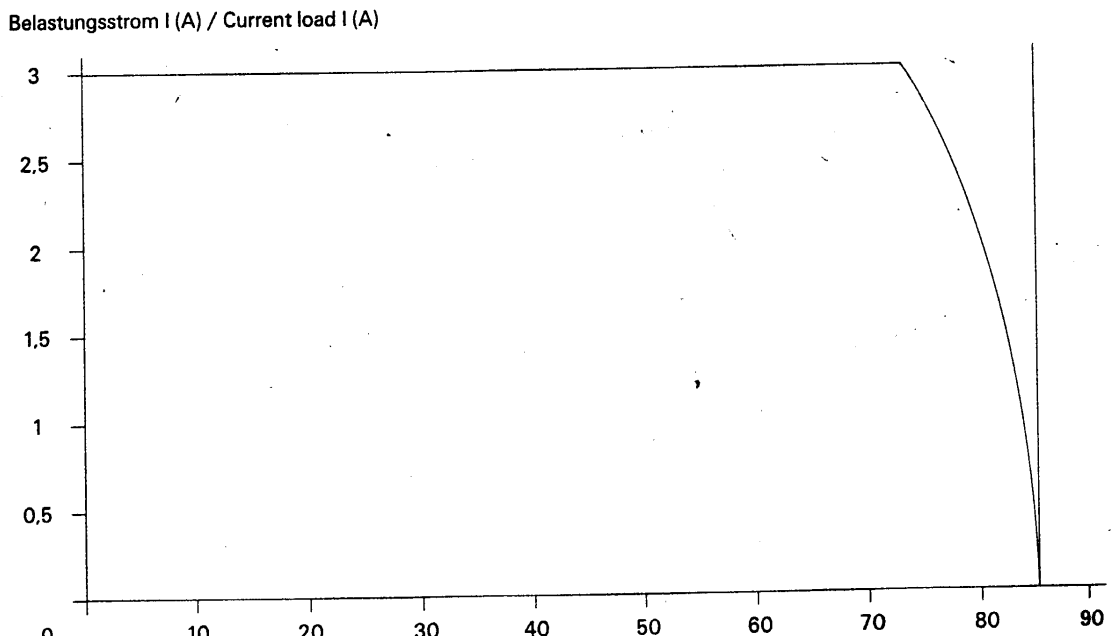

# Sensor Rundsteckverbinder **Sensor Round Connectors** konfektionierbar, schirmbar **assembly possible, shieldable** Serie 713 M12x1 **Series 713 M12x1**

## Aufbau/Design

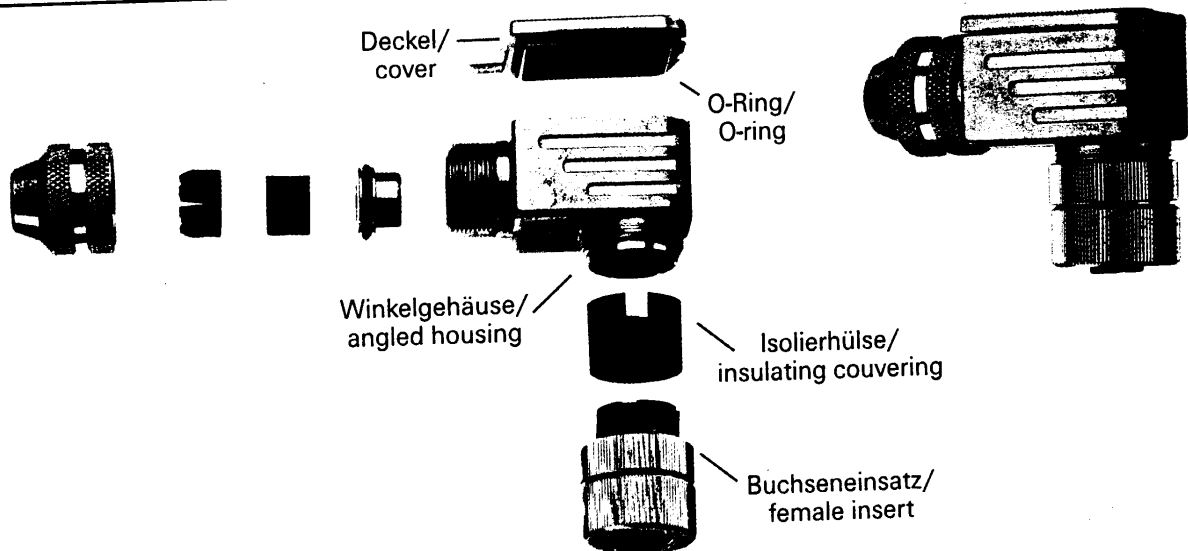
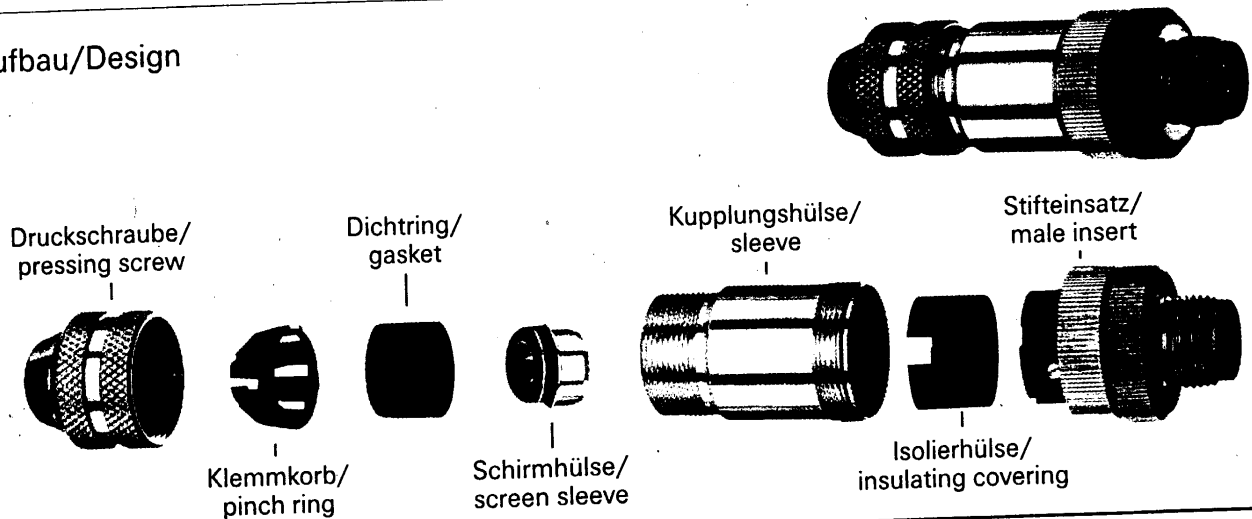

Dämpfungskurve/Attenuation curve

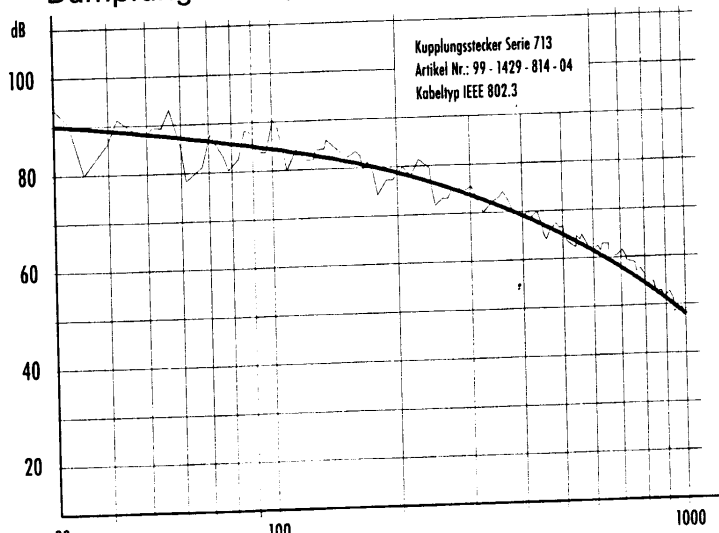

# Sensor Rundsteckverbinder

konfektionierbar, schirmbar

Serie 713 M12x1

# Sensor Round Connectors

assembly possible, shieldable

Series 713 M12x1

Montageanleitung  
Assembly instruction

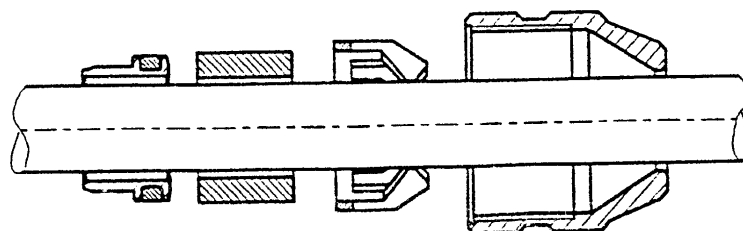

1. Teile auffädeln  
1. Stringing parts

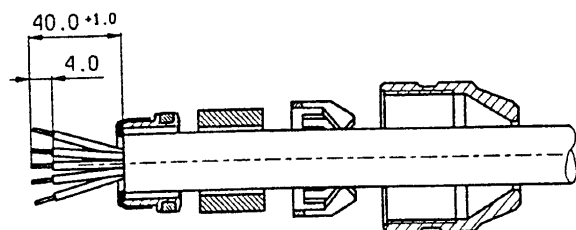

2. Abisolieren, Schirm aufweiten, um Schirmring legen, überstehendes Geflecht abschneiden.  
2. Stripping, widening of shield, put around shielding ring, cut off projecting braiding.

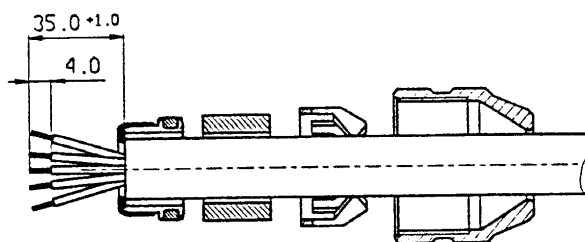

2. Abisolieren, Schirm aufweiten, um Schirmring legen, überstehendes Geflecht abschneiden.  
2. Stripping, widening of shield, put around shielding ring, cut off projecting braiding.

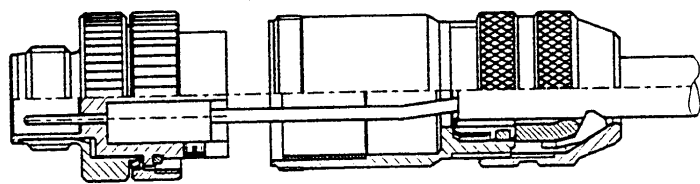

3. Litzen durch Gehäuse fädeln, Schirmring, Dichtring, Klemmkorb montieren. Druckschraube andrehen um das Kabel zu fixieren. Litzen anschrauben.  
3. Stringing wires through housing, assembling of shielding ring, gasket and pinch ring, turn on pressing screw to fix the cable, screw wires.

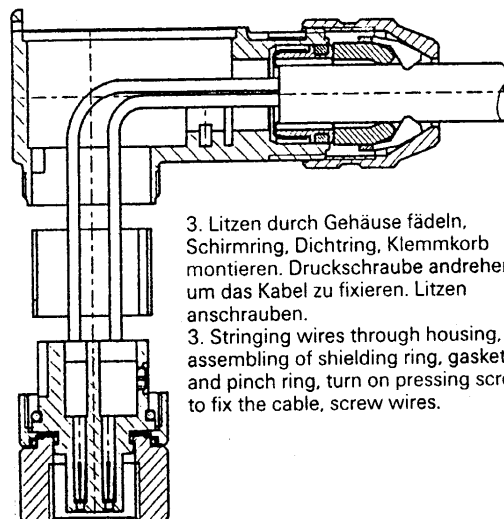

3. Litzen durch Gehäuse fädeln, Schirmring, Dichtring, Klemmkorb montieren. Druckschraube andrehen um das Kabel zu fixieren. Litzen anschrauben.  
3. Stringing wires through housing, assembling of shielding ring, gasket and pinch ring, turn on pressing screw to fix the cable, screw wires.

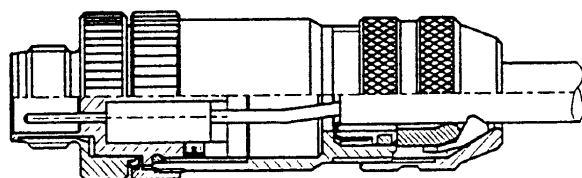

4. Übrige Teile gemäß Darstellung montieren und Druckschraube festdrehen.  
4. Assembling remaining parts according to plan, fasten pressing screw.

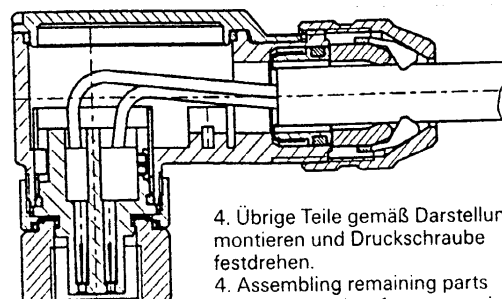

4. Übrige Teile gemäß Darstellung montieren und Druckschraube festdrehen.  
4. Assembling remaining parts

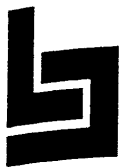

rs

# Sensor Rundsteckverbinder **Sensor Round Connectors** **konfektionierbar assembly possible** **Serie 713 M12x1 Series 713 M12x1**

Technische Daten	Specifications				
Polzahl	Number of contacts	3/4/5/7	Kabelteile, Anschlußseite / cable parts	4/5/7	Einbaustecker, Lötseite incorporation plug
Ansicht auf die Anschlußseite der Kontakteinsätze	View on termination side of inserts				
Anschlußart	Termination	schrauben/screw connection 7pol. löten/soldering		löten/soldering	
Verriegelung	Connection	schrauben/screwing			
Anschlußquerschnitt in mm <sup>2</sup>	Max. wire gauge in mm <sup>2</sup>	0,25 / 0,75		0,25	
Kabelauslaß in mm	Cable outlet in mm (inch)	PG 7, max. 6 mm (0,2362) PG 9, max. 8 mm (0,3150)			
Kontaktoberfläche	Finish of contacts	Cu Sn Zn			
Gehäuse Schutzart n. DIN VDE 0470 Teil 1 in gest. Zustand	Shell protection standard DIN VDE 0470 part 1 only when mated	PG 7 IP 67 mit Kabel Ø 4 - 6 mm IP 67 with cable Ø 4 - 6 mm PG 9 IP 67 mit Kabel Ø 6 - 8 mm IP 67 with cable Ø 6 - 8 mm	IP67		
Werkstoff Gehäuse	Material of shell	PBTP gr. transparent/PA		PA	
Metallausführung	Metal version	Cu Zn Oberfläche Nickel/finish nickel			
Brennbarkeit nach UL - 94	Flammability acc. UL - 94	V - 2			
Betriebstemperatur	Operating temperature	- 40°C /+ 85°C			
Nennstrom je Kontakt	Rated current p. cont.	4 A/7pol. 3 A			
Nennspannung nach VDE Standard 0110 ISO Gruppe C	Rated voltage according to VDE standard 0110 ISO group C	4pol. 125 V~ 150 V=/5pol. 30 V~36 V=/7pol. 5 V= bei Verwendung v. LED/using LED 10 - 30 V			
Prüfspannung nach VDE 0627 ungesteckt	Test Voltage acc. to VDE 0627 unmated	4 pol. 1250 V ~ 5 pol. 1000 V ~			
Durchgangswiderstand nach IEC 512 Teil 2	Volume resistance acc. to IEC 512 part 2	≤ 8 mΩ			
Isolationswiderstand nach IEC 512 Teil 2	Insulation resistance acc. to IEC 512 part 2	≥ 10 <sup>12</sup> Ω			

Polbilder/view on contacts Buchsenkontakte steckseitig/female mating side

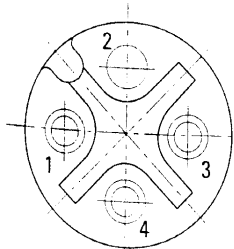

3 polig

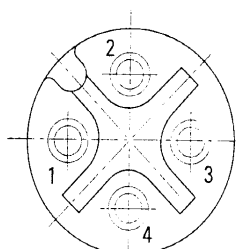

4 polig

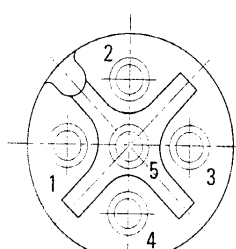

5 polig

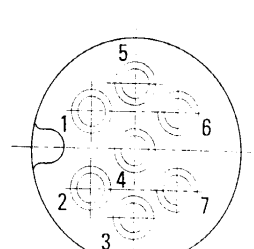

7 polig

Kontakt 2 nicht bestückt  
contact 2 not mated

3

cut

3

an

it  
rew

3

ng

ig



<b>Sensor Rundsteckverbinder</b> <b>konfektionierbar, schirmbar</b> <b>Serie 713 M12x1</b>	<b>Sensor Round Connectors</b> <b>assembly possible, shieldable</b> <b>Series 713 M12x1</b>
--	---

Bemerkungen  
Remarks