

OVERVIEW RSS, RSM, RSL ROCKER SWITCHES–LATCHING ACTION



All types are lettered to describe the switch state (see product photo).

RSS

RSM

RSL

FEATURES

Terminals	Quick-connect terminals 4.8 mm x 0.8 mm	Quick-connect terminals 4.8 mm x 0.8 mm	Quick-connect terminals 6.3 mm x 0.8 mm
PART NUMBER			
1 pole non-illuminated			
Actuator colour: black	1301.9206		
red	1301.9208		
2 pole non-illuminated			
Actuator colour: black	1301.9213	1301.9202	1301.9222
red			1301.9221
2 pole illuminated			
Actuator colour: red		1301.9201	1301.9224
green	1301.9211	1301.9212	1301.9215
Cover, transparent			
Degree of protection IP 65			1301.9214
Degree of protection IP 44	* 1301.9209	* 1301.9210	

Dimensions:

RSS 1 pole:

RSS 2 pole:

RSM:

RSL:

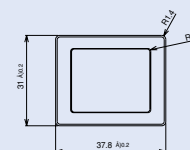
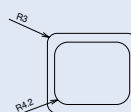
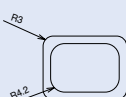
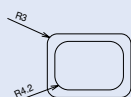
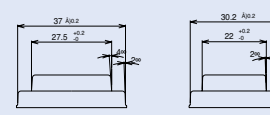
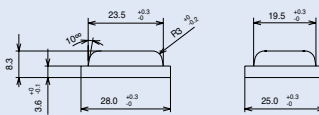
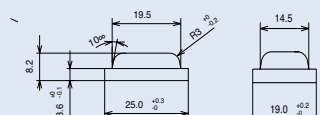
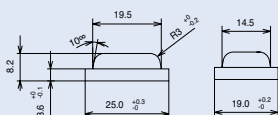

* Degree of protection IP 65 on request