

nominal voltage: 1,2V conditions
max. charge voltage: 1,5V at standard charge (0,1C / 20°C)

capacity
 nominal : 5000mAh discharge at 0,2C
 minimum: 5000mAh discharge at 0,2C
 4600mAh discharge at 0,5C
 1,0V end discharge voltage
 ambient temperature 20°C

max. continuous discharge current: 2500mA ambient temperature -20...60°C

charge
 standard charge: charge current 500mA charge time 16hrs
 rapid charge: 2500mA 2,2hrs

recommended charge -dV: 0...5mV
 termination control dT/dt: 0,8...1°C per min
 parameters: TCO: 45...50°C

trickle charge current: 50...250mA (recommended)

continuous overcharge: ≤500mA no conspicuous deformation, less than 1 year no leakage

internal resistance: ≤25mOhms at 1000Hz, battery fully charged

life expectancy: >500 cycles IEC standard

ambient temperature range: 0...45°C standard charge
 10...40°C rapid charge
 -20...60°C discharge
 -20...35°C storage less than 6 months

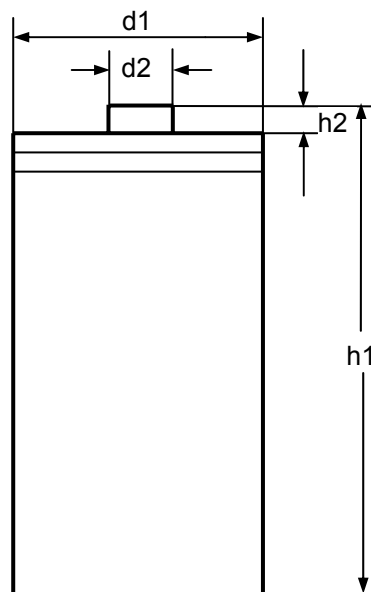
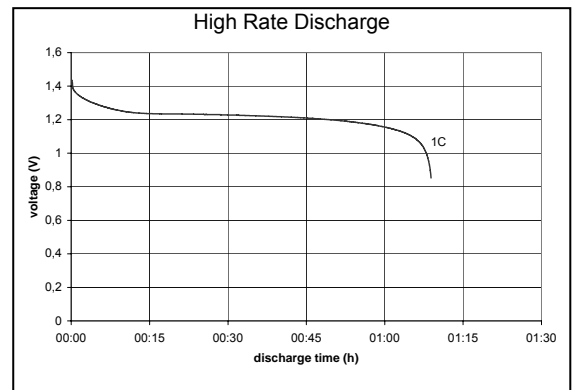
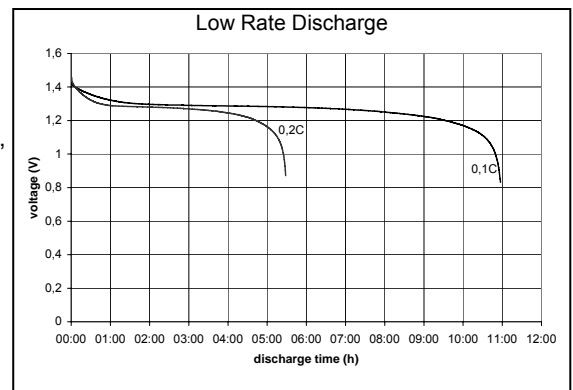
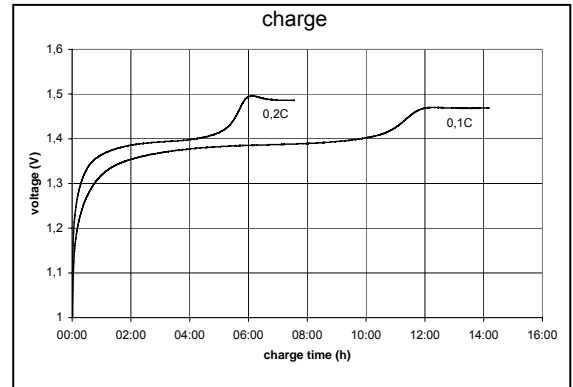

mechanical specifications
 cell dimensions (with sleeve)
 diameter d1: 33,0 -1,0mm
 diameter d2: 9,5 -2,5mm
 height h1: 61,5 -2,0mm
 height h2: min. 1,5mm
 weight: approx. 108g

	specifications for model/type:	D – NiMH 5000mAh
	Ansmann drawing number / part number:	5030921
	drawn by / date:	Brandt / 10.04.2006