

DC Fan Motors

Long Life Fan 80mm

SAN ACE 80L



Long Life Fans

General specifications

Life expectancy100,000 hours, indoor environment(survival rate: 90% at 60°C, rated voltage, and continuously run in a free air state)

Motor protection system ···Current cut system (with reverse-connection protection)

Dielectric strength ······50/60 Hz, 500 VAC, 1 minute
(between lead conductor and frame)

Operating thermally range -10°C to +70°C (non-condensing)

Fan power lead ········H and F speeds, ⊕ red, ⊖ black
M and L speeds, ⊕ red, ⊖ blue

25mm thick

Specifications

Model No	Rated voltage (V)	Operating voltage range (V)	Rated current (A)	Rated input (W)	Rated rotating speed (min ⁻¹)	Air flow (m ³ /min)	Static pressure (Pa)	Noise (dB[A])	Mass (g)
109L0812H402	12	10.2~13.8	0.18	2.16	3,000	1.06	37.4	39.2	150
109L0812F402			0.14	1.68	2,700	0.93	32.8	32.3	
109L0812M402			0.1	1.2	2,400	0.83	29.3	26.5	
109L0812L402			0.08	0.96	1,900	0.63	22.2	16.7	
109L0824H402			0.09	2.16	3,000	1.06	37.4	39.2	
109L0824F402			0.08	1.92	2,700	0.93	32.8	32.3	
109L0824M402	24	20.4~27.6	0.07	1.68	2,400	0.83	29.3	26.5	
109L0824L402			0.05	1.2	1,900	0.63	22.2	16.7	
109L0848H402			0.06	2.88	3,150	1.1	38.8	43.1	34

Typical air flow and static pressure characteristics

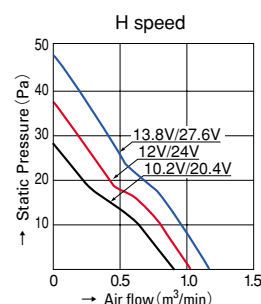

109L0812H402
109L0824H402

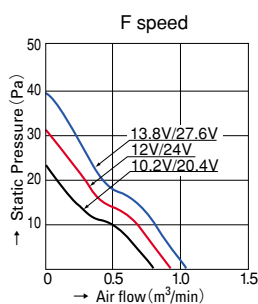

109L0812F402
109L0824F402

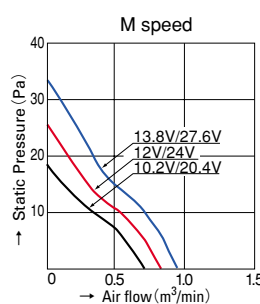

109L0812M402
109L0824M402

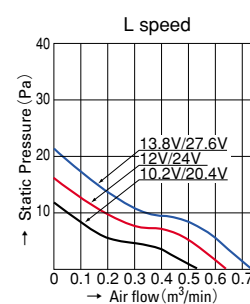

109L0812L402
109L0824L402

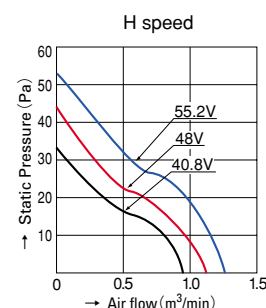

109L0848H402

80mm

Dimensions (unit : mm)

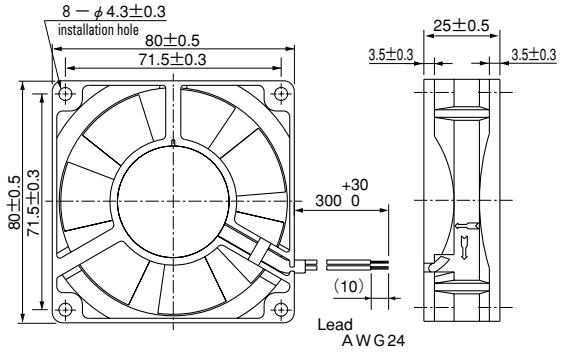

Long Life Fans

Reference dimensional diagram for installation holes (unit : mm)

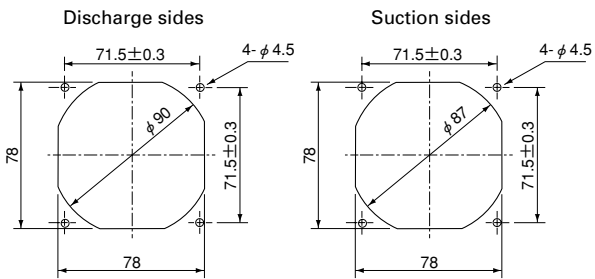

80mm

SANYO DENKI

1-15-1, Kita-otsuka, Toshima-ku, Tokyo 170-8451, Japan. PHONE : +81 3 3917 5151
Home Page: <http://www.sanyodenki.co.jp>