

# PC BOARD MOUNTING CONNECTORS

## 750 SERIES

### ■ FEATURES

- The 750 series connector is slim — only 7 mm (0.275 in.) high and wide — and takes up very little space.
- Pins are arranged in a 2.54 mm (0.100 in.) grid. The 750 series connector can be changed from a two-piece type connector to a one-piece dip soldering connection without changing the PC board pattern, because the mounting hole layout is the same as the 700 series.
- The series offers 10 to 64 contacts to match 700 series connectors.
- RoHS compliant.

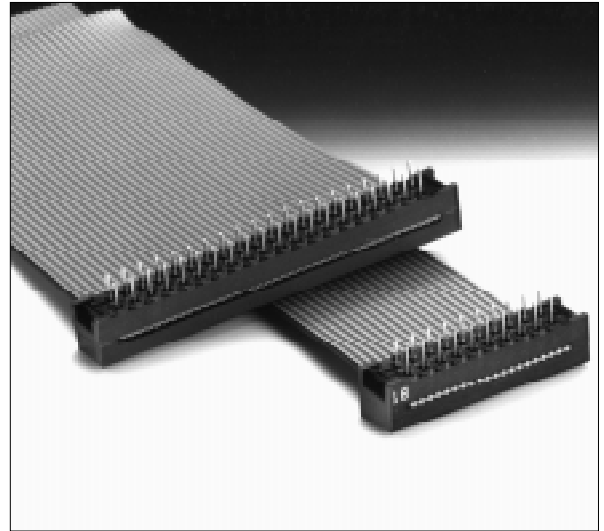

### ■ SPECIFICATIONS

Item	Specification
Operating temperature range	-55°C to +105°C
Current rating	DC 1 A
Voltage rating	AC 250 V
Insulation resistance	1000 MΩ min. (DC 500 V)
Dielectric strength	AC 500 V for 1 minute
Applicable wire	Flat cable: 1.27 mm (0.050 in.) pitch AWG #28 (stranded) or AWG #30 (solid)
Applicable PC board (standard)	1.6 mm

### ■ MATERIALS

Item	Materials
Insulating material	Polyester (UL94V-0)
Conductor	Copper alloy
Plating	Contact: Au Plating (PAGOS), Au over Pd-Ni plating

## ■ DIMENSIONS

[Cover]

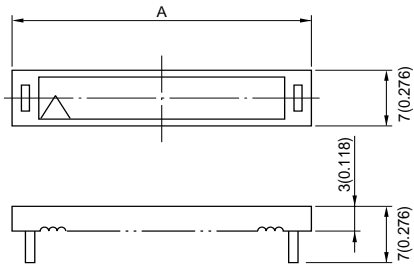

[Main body]

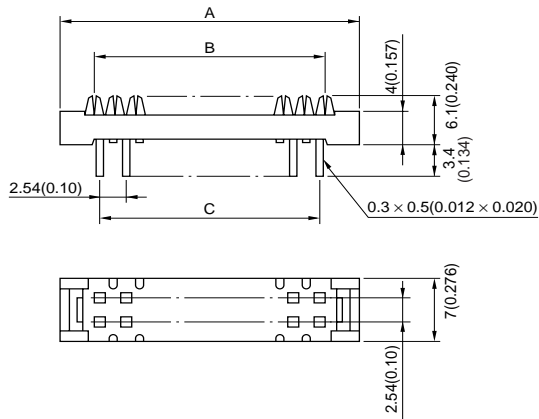

[With cable]

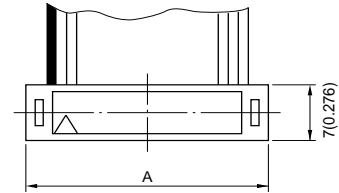
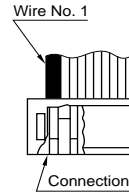

Note : The blue wire of the cable (wire No. 1) is connected to the pin (contact) under the  $\Delta$  mark.

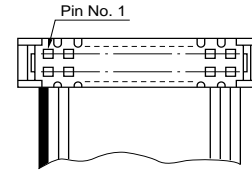
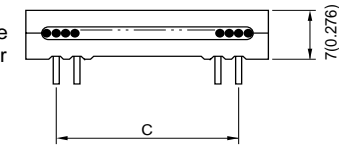

Unit: mm (in.)

## ■ MOUNTING HOLE LAYOUT

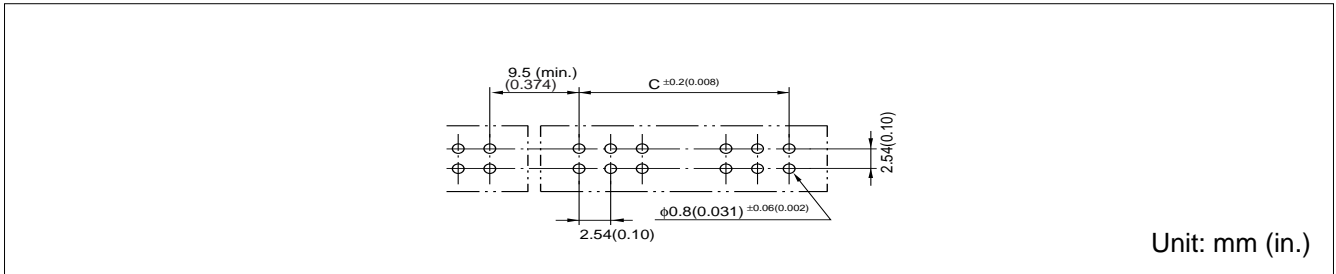

## ■ PART NUMBERS AND DIMENSIONS

Number of contacts	Part number	Dimensions: mm (in.)		
		A	B	C
10	FCN-754P010-AU/0	19.2 (0.756)	11.43 (0.450)	10.16 (0.400)
14	FCN-754P014-AU/0	24.3 (0.957)	16.51 (0.650)	15.24 (0.600)
16	FCN-754P016-AU/0	26.8 (1.055)	19.05 (0.750)	17.78 (0.700)
20	FCN-754P020-AU/0	31.9 (1.256)	24.13 (0.950)	22.86 (0.900)
24	FCN-754P024-AU/0	37.0 (1.457)	29.21 (1.150)	27.94 (1.100)
26	FCN-754P026-AU/0	39.5 (1.555)	31.75 (1.250)	30.48 (1.200)
30	FCN-754P030-AU/0	44.6 (1.756)	36.83 (1.450)	35.56 (1.400)
34	FCN-754P034-AU/0	49.7 (1.957)	41.91 (1.650)	40.64 (1.600)
40	FCN-754P040-AU/0	57.3 (2.256)	49.53 (1.950)	48.26 (1.900)
50	FCN-754P050-AU/0	70.0 (2.756)	62.23 (2.450)	60.96 (2.400)
60	FCN-754P060-AU/0	82.7 (3.256)	74.93 (2.950)	73.66 (2.900)
64	FCN-754P064-AU/0	87.8 (3.457)	80.01 (3.150)	78.74 (3.100)

Notes: • The last digit (0) of the part number is zero.

## IDC TOOLS

### ■ FEATURES

- Special IDC tools are used to assemble FCN-750 series connectors and flat cables.
- All tools are simple and easy to use, even for first-time users.
- Users who have IDC tools manufactured by us do not have to buy hand presses or cutting cables. They are compatible. Take care to buy the locator plate designed for your connectors.
- The number of pins can be changed easily by setting the connector guide to a specified pin hole.
- The cable cutter remains sharp, providing fast, easy cutting with a long life.

Notes:

- Please ask for an operation instruction manual if needed.
- If you have any questions about Fujitsu IDC tools, please contact your local Fujitsu office or your local Fujitsu distributor.

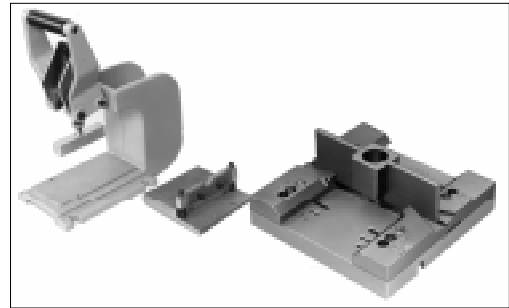

Hand press    Cable cutter    Locator plate (790 series)

### ■ CABLE TERMINATION

#### • Flat cable termination diagram

There are many ways to connect connectors to flat cables. Choose the connection method appropriate to your application from the figure below.

#### • Cable length

The length of a cable is indicated in units of cm, as shown in the figure below. The minimum length is 3 cm. The specified tolerance of the cable length is  $\pm 10\%$  for  $L \leq 10$  cm ( $\pm 5$  mm min.),  $\pm 1$  cm for  $10$  cm  $< L < 100$  cm,  $\pm(L/100$  cm  $+ 2$  cm) for  $100$  cm  $\leq L \leq 1800$  cm, and  $\pm 20$  cm for  $1800$  cm  $< L$ .

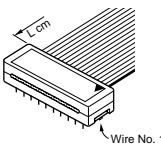
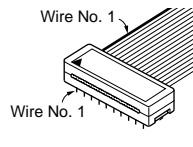
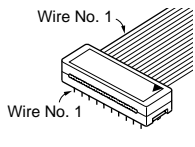
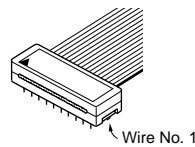
Type number	No. 1	No. 2	No. 3	No. 4
Connector model				
750 series				

### ■ PART NUMBERS FOR IDC TOOLS

Name	Part number
Cable cutter (common)	FCN-707T-T001/H
Hand press (common)	FCN-707T-T101/H
Locator plate (for 750 series connectors)	FCN-757T-T015/H

The hand press and the cable cutter can be used for other IDC connectors.

## **Fujitsu Components International Headquarter Offices**

### **Japan**

Fujitsu Component Limited  
Gotanda-Chuo Building  
3-5, Higashigotanda 2-chome, Shinagawa-ku  
Tokyo 141, Japan  
Tel: (81-3) 5449-7010  
Fax: (81-3) 5449-2626  
Email: [promothq@ft.ed.fujitsu.com](mailto:promothq@ft.ed.fujitsu.com)  
Web: [www.fcl.fujitsu.com](http://www.fcl.fujitsu.com)

### **North and South America**

Fujitsu Components America, Inc.  
250 E. Caribbean Drive  
Sunnyvale, CA 94089 U.S.A.  
Tel: (1-408) 745-4900  
Fax: (1-408) 745-4970  
Email: [marcom@fcai.fujitsu.com](mailto:marcom@fcai.fujitsu.com)  
Web: [www.fcai.fujitsu.com](http://www.fcai.fujitsu.com)

### **Europe**

Fujitsu Components Europe B.V.  
Diamantlaan 25  
2132 WV Hoofddorp  
Netherlands  
Tel: (31-23) 5560910  
Fax: (31-23) 5560950  
Email: [info.marketing@fceu.fujitsu.com](mailto:info.marketing@fceu.fujitsu.com)  
Web: [www.fceu.fujitsu.com](http://www.fceu.fujitsu.com)

### **Asia Pacific**

Fujitsu Components Asia Ltd.  
102E Pasir Panjang Road  
#04-01 Citilink Warehouse Complex  
Singapore 118529  
Tel: (65) 375-8560  
Fax: (65) 273-3021  
Email: [fcal@fcal.fujitsu.com](mailto:fcal@fcal.fujitsu.com)  
[www.fcal.fujitsu.com](http://www.fcal.fujitsu.com)

© 2004 Fujitsu Components America, Inc. All company and product names are trademarks or registered trademarks of their respective owners. Rev. 02/19/2004.