

Cup Brushes Record

These multi-purpose brushes with a crimped wire fill are ideally suited for use on bench machines, one-hand angle grinders, large angle grinders and pneumatic grinders. We can supply them with a threaded or plain arbor hole to suit your machine.

Type 1.6602 is produced with a plastic cap.

Fill types: RECORD

STD – Steel wire, natural hard, crimped.

INOX – Stainless steel wire, acid resistant, crimped.

MES – Brass wire (Cu-Zn), crimped.

Applications:

Removal of rust, corrosion, paint and primer and generally to produce clean surfaces.

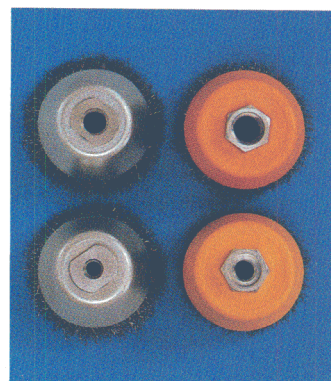
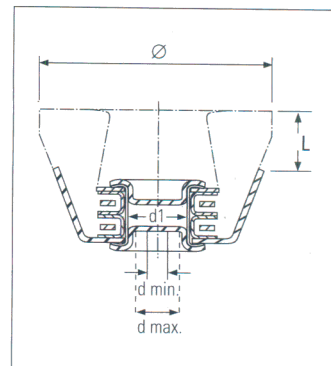

Cup Brushes Record



Wear eye protection!

Topfbürsten Record

Dimensions/
Abmessungen

RPM/
UPM

Type

Ø	L	d		Type	RPM/ UPM	0.30 MES		0.20 STD		0.30 STD		0.50 STD	
		min.	max.			Art.-No.	Art.-No.	Art.-No.	Art.-No.	Art.-No.	Art.-No.		
60 (2 3/8")	18	-	-	M 8	11000	T1.4602	9901.0562	9901.0493	9901.0547	9901.0501			
	16	-	-	M 10	11000	T1.6602	9901.0563	9901.0495	9901.0522	9901.0529			
	16	-	-	M 12 x 1,5	11000	T1.6602	9901.0230	9901.0494	9901.0027	9901.0515			
75 (3")	16	-	-	M 14	11000	T1.6602	9901.0094	9901.0032	9901.0005	9901.0072			
	20	-	-	M 14	9000	T1.8752	9901.0141	9901.0074	9901.0516	9901.0158			
80 (3")	20	-	-	UNC 5/8"	9000	T1.8752	9901.0565	9901.0497	9901.0498	9901.0531			
	25	10	16	d ₁ 20,0	8500	T282	9424.6513	9424.0313	9424.0513	9424.0813			
	25	-	-	M 14	8500	T282	9404.6513	9404.0313	9404.0513	9404.0813			
100 (4")	25	-	-	UNC 5/8"	8500	T282	9406.6513	9406.0313	9406.0513	9406.0813			
	30	10	25	d ₁ 22,2	8500	T3102	9434.6517	9434.0317	9434.0517	9434.0817			
	30	-	-	M 14	8500	T3102	9494.6517	9494.0317	9494.0517	9494.0817			
125 (5")	30	-	-	UNC 5/8"	8500	T3102	9496.6517	9496.0317	9496.0517	9496.0817			
	35	10	32	d ₁ 22,2	6500	T4122	9444.6522	9444.0322	9444.0522	9444.0822			
	35	-	-	M 14	6500	T3122	9494.6522	9494.0322	9494.0522	9494.0822			
150 (6")	35	-	-	UNC 5/8"	6500	T3122	9496.6522	9496.0322	9496.0522	9496.0822			
	55	10	32	d ₁ 22,2	6500	T4152	9444.6527	9444.0327	9444.0527	9444.0827			
	55	-	-	M 14	6500	T3152	9494.6527	9494.0327	9494.0527	9494.0827			
	55	-	-	UNC 5/8"	6500	T3152	9496.6527	9496.0327	9496.0527	9496.0827			