

## NOTES

MATERIAL: MOLDED USING EITHER FLAME RETARDANT ABS PLASTIC OR POLYSTYRENE  
 PARTS: COMES WITH 2 0.064" BRUSHED ALUMINUM PANELS, AND 4 RUBBER FEET, ABS VERSION COMES WITH M3 0.5 X 10MM PHILLIPS MACHINE SCREWS THREADED INTO BRASS INSERTS, STYRENE COMES WITH #4 X  $\frac{3}{8}$ " SELF TAPPING SCREWS.  
 COLOR: CHOICE OF BLACK OR GRAY  
 OPTIONS: PLASTIC FRONT & REAR PANELS, EMI/RFI SHIELDING.

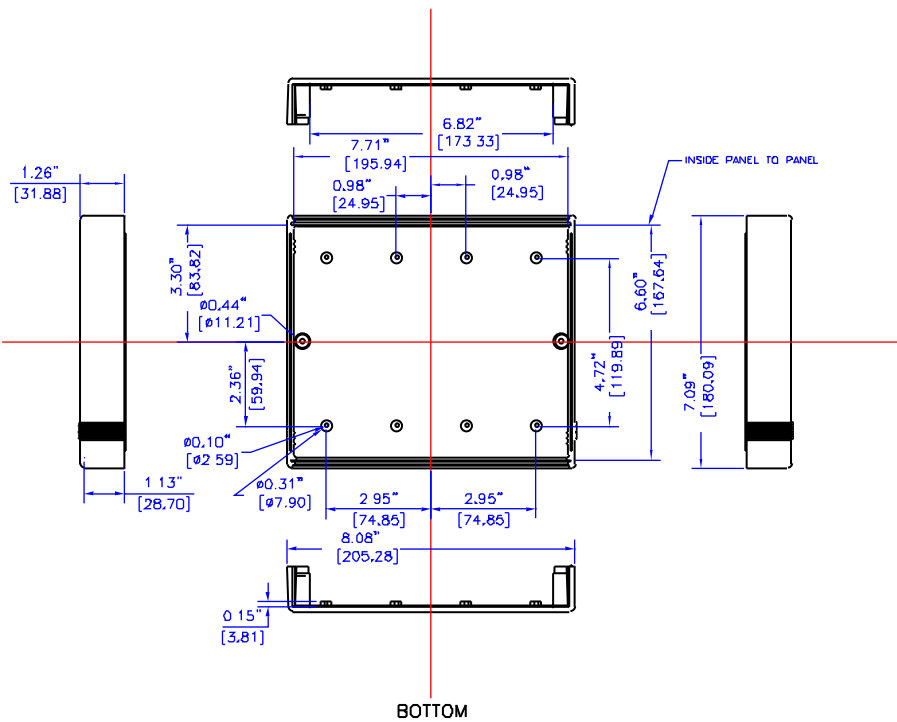

BOTTOM

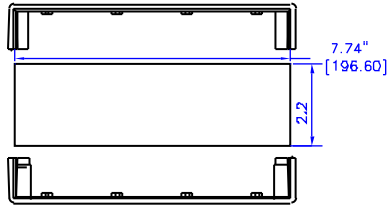
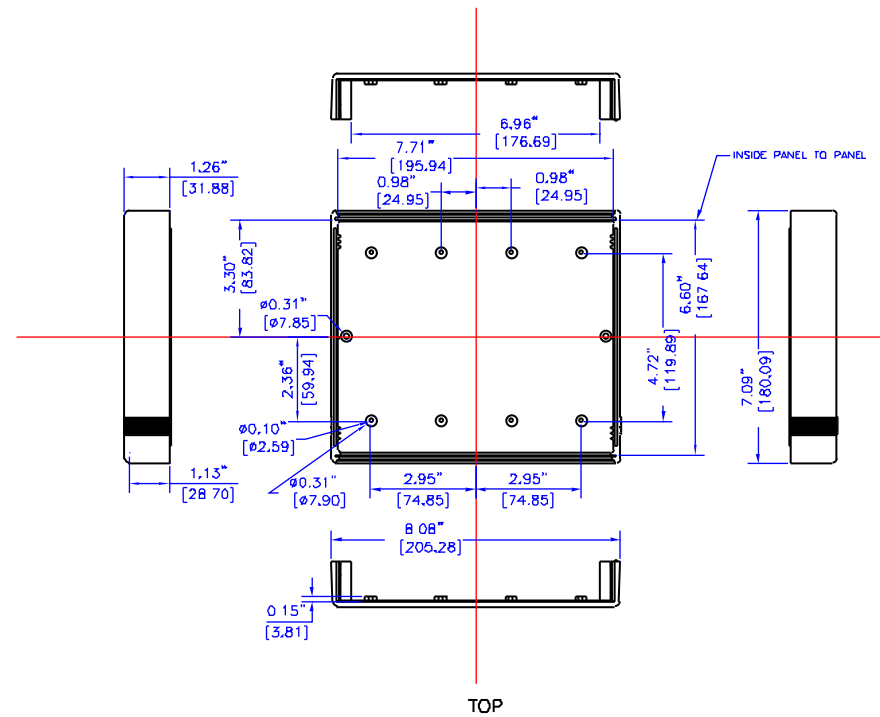

TOP

UNLESS OTHERWISE SPECIFIED  
 DIMENSIONS ARE IN INCHES  
 I +/- .1  
 II +/- .08  
 III +/- .015  
 CUTS +/- .005  
 HOLES +/- .002  
 UNLESS OTHERWISE SPECIFIED  
 DIMENSIONS ARE IN INCHES  
 I +/- .1  
 II +/- .08  
 III +/- .015  
 CUTS +/- .005  
 HOLES +/- .002



HAMMOND  
 MANUFACTURING

WEB: WWW.HAMMONDMFG.COM

TITLE HAMMOND 1598 SERIES  
 INSTRUMENT ENCLOSURE

DRAWN BY MJM DATE 06/18/00

SCALE PAGE 1 OF 1

PART NUMBER

1598D