

PRODUCT NO  
10046971-001LF

REV	ECR NUMBER	REV'D BY	DATE
E	DG06-0306	RYAN YUAN	08/04/06
F	DG06-0524	JULIA WANG	12/26/06
C	DG05-0287	Steven Wang	08/18/05
D	DG05-0461	JM Guo	11/14/05

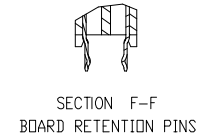
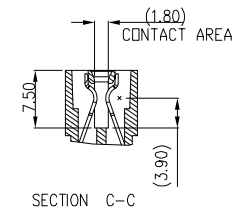
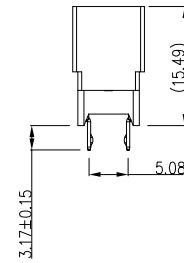
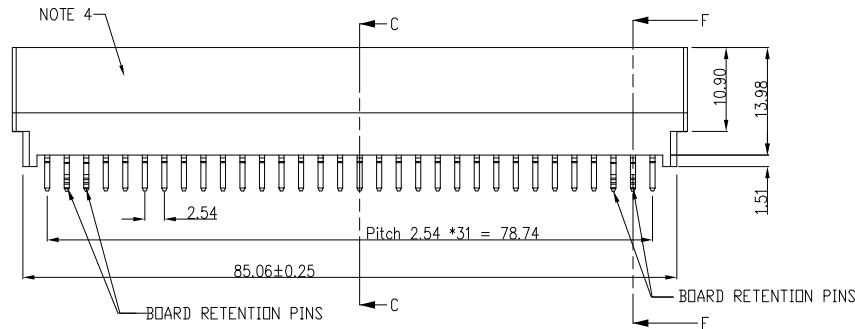
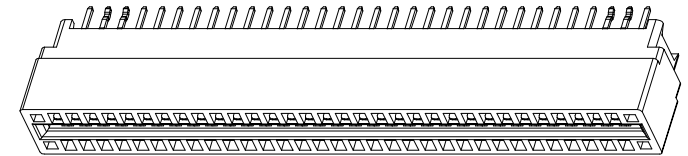
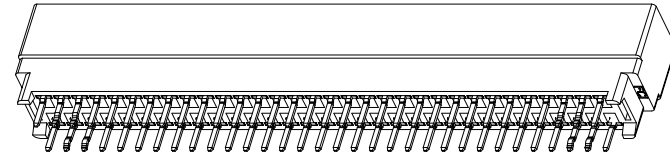
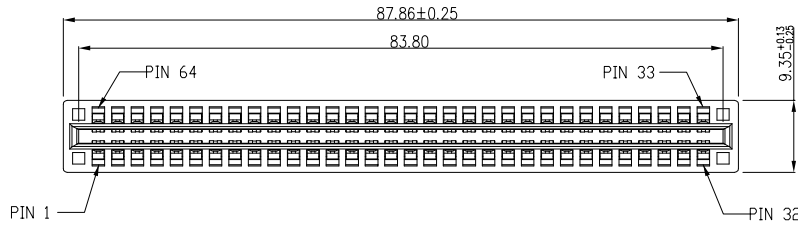

- NOTE:
- MATERIAL:  
HOUSING: HIGH TEMPERATURE THERMOPLASTIC,  
UL 94 V-0 FLAME RETARDANT, BLACK.  
TERMINAL: HIGH CONDUCTIVITY COPPER ALLOY.  
PLATING SPEC AS BELOW:  
Ni 50u" UNDER PLATED.  
Au 30u" OVER CONTACT AREA. (ONE SIDE)  
MATTE TIN 120u" OVER SOLDERING AREA.
  - PACKING SPEC. GS-14-937.
  - PRODUCT SPEC. GS-12-338.
  - MANUFACTURER'S NAME, P/N AND DATE CODE TO APPEAR ON THIS SURFACE AS PER GS-24-007.

- PART NUMBER 10046971-001LF MEETS EUROPEAN UNION DIRECTIVE AND OTHER COUNTRY REGULATIONS AS DESCRIBED IN GS-22-008.  
THE HOUSING WILL WITHSTAND EXPOSURE TO 260°C PEAK TEMPERATURE FOR 10 SECONDS IN A WAVE SOLDER APPLICATION WITH A CIRCUIT BOARD.

CUSTOMER COPY			THIRD ANGLE PROJECTION			FCI				
DO NOT SCALE DRAWING			DIMENSIONAL LIMITS APPLY AFTER PLATING (IF SPECIFIED)			DESCRIPTION				
GENERAL TOLERANCE			NAME			POWER EDGE CONNECTOR OF VERTICAL TYPE (32PX2)				
MILLIMETER	INCH	ANGLE	DRAWN	Benny Chen	DATE	SCALE	SIZE	DRAWING NO.	REV	SHEET
X.X ±0.8	.XX ±0.03	±3°	CHECKED	Paul Wang	03/20/05	1:1	A4	10046971	F	1 OF 4
X.XX ±0.25	.XXX ±0.010		APPROVED	Joseph Hsia	03/23/05					
X.XXX ±0.13	.XXXX ±0.005									

ALL RIGHT RESERVED. REPRODUCTION OR ISSUE TO THIRD PARTIES IN ANY FORM WHATEVER IS NOT PERMITTED WITHOUT WRITTEN AUTHORITY FROM THE PROPRIETOR. PROPERTY OF F C I. COPYRIGHT F C I.

PDM: Rev:F

STATUS:Released

Printed: Mar 14, 2007

PRODUCT NO  
10046971-001LF

4 3 2 1

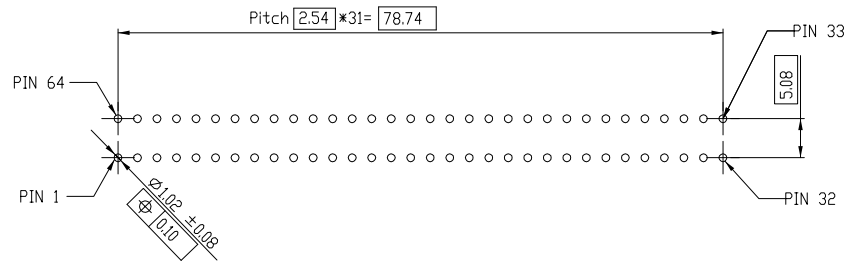
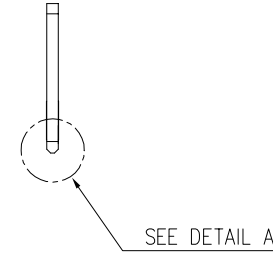
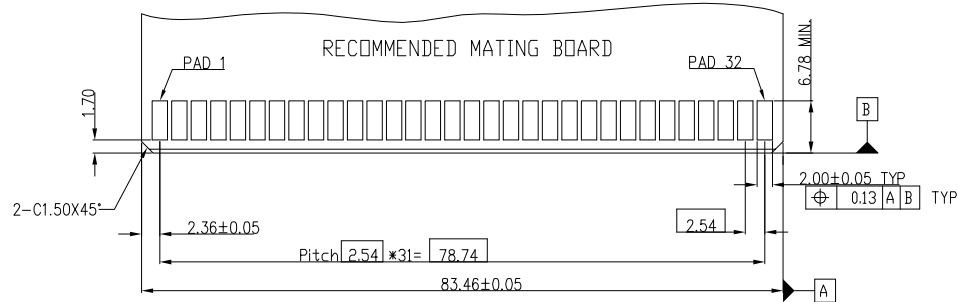

RECOMMENDED PCB BOARD LAYOUT  
AND THE THICKNESS IS 2.36mm

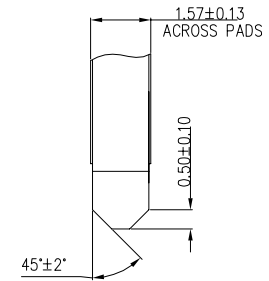

DETAIL A  
SCALE 5:1

ALL RIGHT RESERVED. REPRODUCTION OR ISSUE TO THIRD PARTIES IN ANY FORM WHATEVER IS NOT PERMITTED WITHOUT WRITTEN AUTHORITY FROM THE PROPRIETOR. PROPERTY OF F C I. COPYRIGHT F C I.

CUSTOMER COPY			THIRD ANGLE PROJECTION							
DO NOT SCALE DRAWING			DRAWN			NAME		DATE		
GENERAL TOLERANCE			CHECKED			Paul Wang		03/23/04		
MILLIMETER			APPROVED			Joseph Hsia		03/23/05		
INCH			NAME			Benny Chen		DATE		
ANGLE			DRAWN			Paul Wang		03/23/04		
XX ±0.8			.XX ±0.03			Joseph Hsia		03/23/05		
X.XX ±0.25			.XXX ±0.010			Paul Wang		03/23/04		
X.XXX ±0.13			.XXX ±0.005			Joseph Hsia		03/23/05		
±3°			DRAWN			Benny Chen		DATE		
			CHECKED			Paul Wang		03/23/04		
			APPROVED			Joseph Hsia		03/23/05		
DESCRIPTION						RECOMMENDED LAYOUT OF MATING AND PCB BOARD VERTICAL TYPE (32PX2)				
SCALE	SIZE	DRAWING NO.	REV	SHEET						
~	A4	10046971	F	2 OF 4						

4 3 2 1

PDM: Rev:F

STATUS: Released

1 Printed: Mar 14, 2007

PRODUCT NO  
10046971-003LF

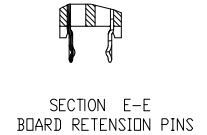
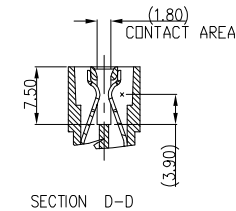
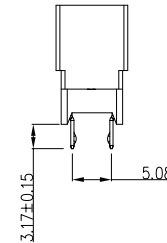
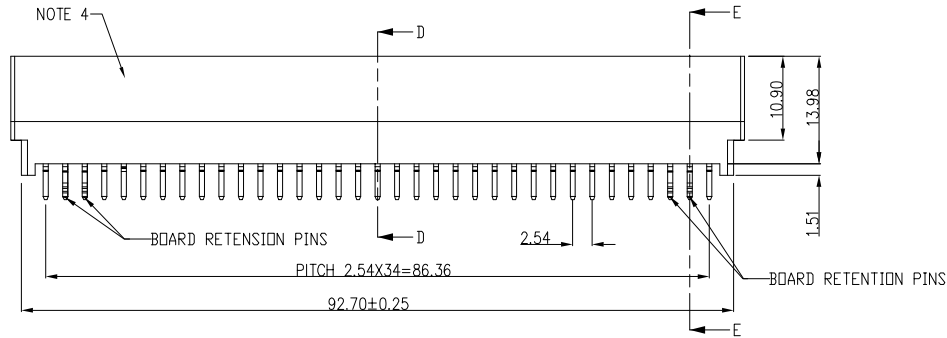
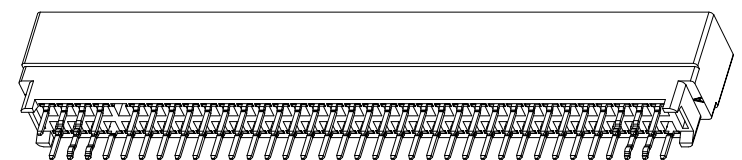
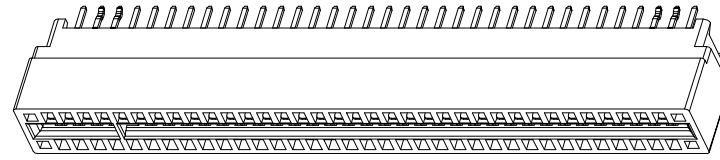
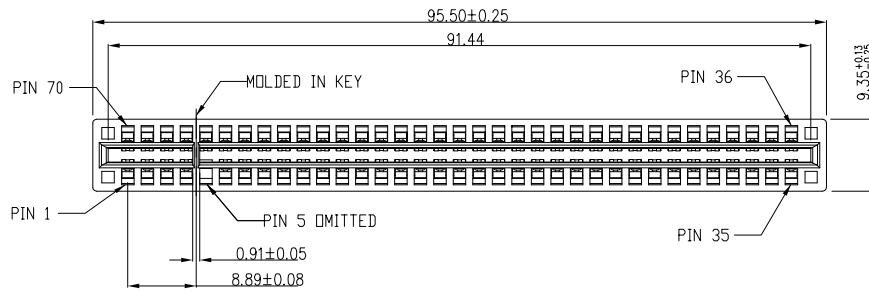

NOTE:

1. MATERIAL:

HOUSING: HIGH TEMPERATURE THERMOPLASTIC,  
UL 94 V-0 FLAME RETARDANT, BLACK.  
TERMINAL: HIGH CONDUCTIVITY COPPER ALLOY.  
PLATING SPEC AS BELOW:  
Ni 50u" UNDER PLATED.  
Au 30u" OVER CONTACT AREA. (ONE SIDE)  
MATTE TIN 120u" OVER SOLDERING AREA.

2. PACKING SPEC. GS-14-937.

3. PRODUCT SPEC. GS-12-338.

4. MANUFACTURER'S NAME, P/N AND DATE CODE TO APPEAR ON THIS SURFACE AS PER GS-24-007.

5. PART NUMBER 10046971-003LF MEETS EUROPEAN UNION DIRECTIVE AND OTHER COUNTRY REGULATIONS AS DESCRIBED IN GS-22-008. THE HOUSING WILL WITHSTAND EXPOSURE TO 260°C PEAK TEMPERATURE FOR 10 SECONDS IN A WAVE SOLDER APPLICATION WITH A CIRCUIT BOARD.

ALL RIGHT RESERVED. REPRODUCTION OR ISSUE TO THIRD PARTIES IN ANY FORM WHATEVER IS NOT PERMITTED WITHOUT WRITTEN AUTHORITY FROM THE PROPRIETOR. PROPERTY OF F C I. COPYRIGHT F C I.

CUSTOMER COPY			THIRD ANGLE PROJECTION													
											DIMENSIONAL LIMITS APPLY AFTER PLATING (IF SPECIFIED)					
DO NOT SCALE DRAWING			GENERAL TOLERANCE			DESCRIPTION										
MILLIMETER			INCH			DRAWN			NAME		DATE					
X.X ±0.8			.XX ±0.03			Benny Chen			Paul Wang		01/27/05					
X.XX ±0.25			.XXX ±0.010			CHECKED			Joseph Hsia		03/25/05					
X.XXX ±0.13			.XXX ±0.005			APPROVED			03/26/05		03/26/05					
±3°						SCALE			SIZE		DRAWING NO.		REV		SHEET	
						1:1			A4		10046971		F		3 OF	

PDM: Rev:F

STATUS: Released

1 Printed: Mar 14, 2007

PRODUCT NO  
10046971-003LF

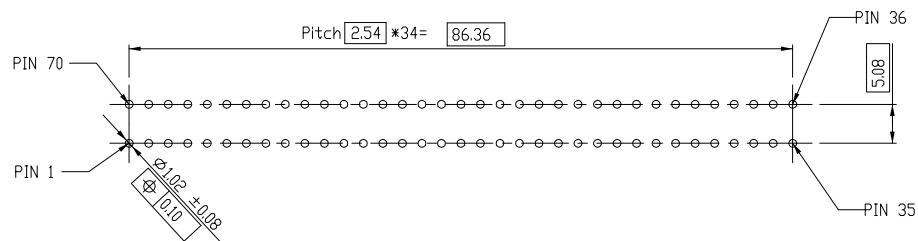
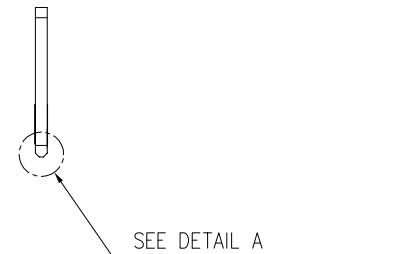
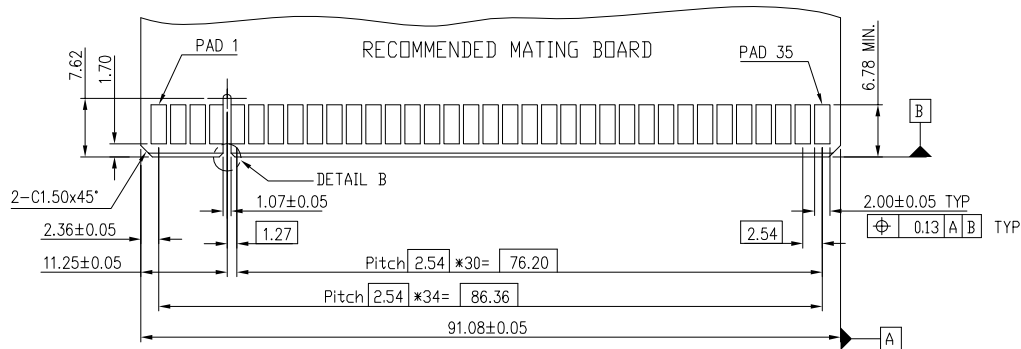

RECOMMENDED PC BOARD LAYOUT  
AND THE THICKNESS IS 2.36mm

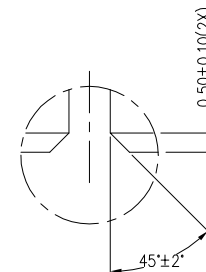

DETAIL B  
SCALE 5:1

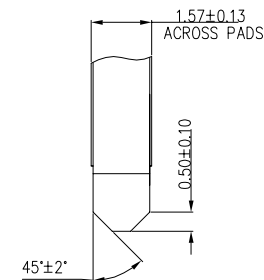

DETAIL A  
SCALE 5:1

ALL RIGHT RESERVED. REPRODUCTION OR ISSUE TO THIRD PARTIES IN ANY FORM WHATEVER IS NOT PERMITTED WITHOUT WRITTEN AUTHORITY FROM THE PROPRIETOR. PROPERTY OF F C I. COPYRIGHT F C I.

CUSTOMER COPY			THIRD ANGLE PROJECTION								
										DIMENSIONAL LIMITS APPLY AFTER PLATING (IF SPECIFIED)	
DO NOT SCALE DRAWING			NAME		DATE		DESCRIPTION				
GENERAL TOLERANCE			DRAWN		Benny Chen		01/27/05		RECOMMENDED LAYOUT OF MATING AND PCB BOARD VERTICAL TYPE (35PX2)		
MILLIMETER	INCH	ANGLE	CHECKED	Paul Wang	03/25/05	SCALE	SIZE	DRAWING NO.	REV	SHEET	
.XX ±0.8	.XX ±0.03	±3°	APPROVED	Joseph Hsia	03/26/05	~	A4	10046971	F	4 OF 4	
.XXX ±0.25	.XXX ±0.010										
.XXX ±0.13	.XXX ±0.005										