

SOLDER SUFFIX	CUSTOMER TERMINAL	RoHS	LEAD(Pb)-FREE
	Sn100%	No	No
LF3	Sn100%	Yes	Yes

TERM. NO.'s FOR REF. ONLY

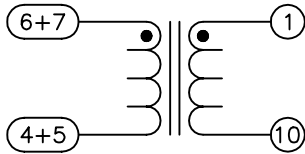

AREA REPRESENTS  
TERMINAL PAD DIMENSIONS

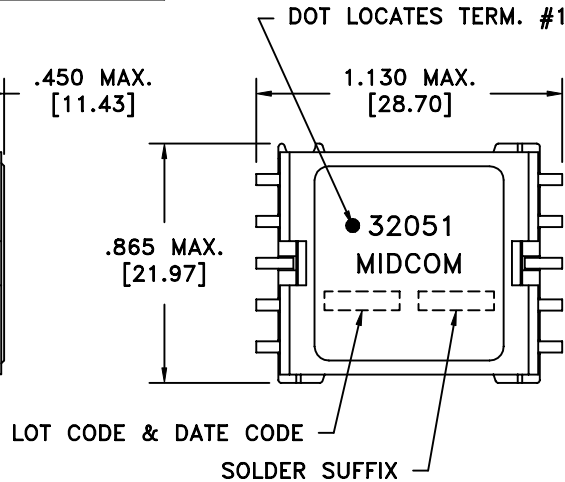
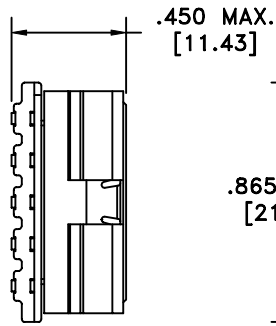
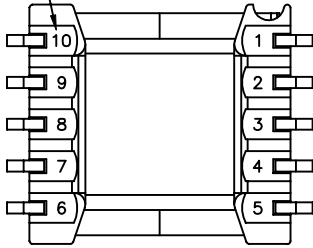
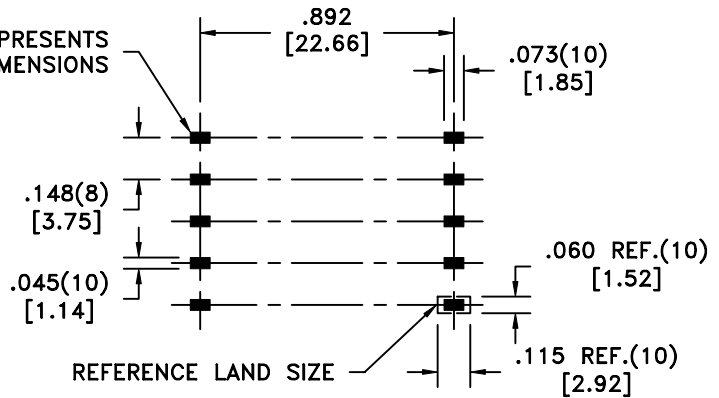

REFERENCE LAND SIZE  
CUSTOMER TO DETERMINE LAND LAYOUT

**ELECTRICAL SPECIFICATIONS @ 25°C unless otherwise noted:**

- D.C. RESISTANCE (@20°C):** 5-6(tie 4+5, 6+7), 0.015 ohms max.  
1-10, 0.70 ohms max.
- DIELECTRIC RATING:** 1000VDC, 1 minute tested by applying 1250VDC for 1 second between 1-6(tie 4+5).
- INDUCTANCE:** 10.0uH ±10%, 10kHz, 100mVAC, 5-6(tie 4+5, 6+7), Ls.
- LEAKAGE INDUCTANCE:** 0.05uH max., 100kHz, 10mAAC, 5-6(tie 1+10, 4+5, 6+7), Ls.
- TURNS RATIO:** (1-10):(6-5) = 10:1, tie(4+5, 6+7), ±2%.

**Midcom, Inc.**  
Watertown, SD USA  
Toll Free: 800-643-2661  
Fax: 605-886-4486

This drawing is dual dimensioned.  
Dimensions in brackets are in millimeters.

Unless otherwise specified:  
Tolerances: Fractions: ±1/64  
Angles: ±1° Decimals: ±.005[.13]

DRAWING TITLE

**TRANSFORMER**

REVISIONS: SEE SHEET 1

**Midcom**

DRAWING NO.

**32051R/-LF3**

SCALE ---

REV.

6A  
5/05

SHEET 2 OF 5

DWG # 32051R/-LF3