

● PROFESSIONAL LED INDICATORS Ø8.1mm Mounting

## FEATURES



### 524 SERIES

PACK QUANTITY = 10 PIECES

- Robust stainless steel housing
- Low profile styling, sunlight readable LEDs
- Sealed to IP67
- Wide viewing angle
- Suitable for high vibration applications
- Internal reverse protection diode fitted as standard in all voltage models.

## SPECIFICATION

Ordering Information & Typical Technical Characteristics (Ta = 25°C)

Mean Time Between Failure = 100,000 Hours. Luminous intensity figures refer to the unmodified discrete LED.

PART NUMBER	COLOUR	LENS	VOLTAGE DC (Vdc) Vopr	CURRENT DC (mA) Iopr	LUMINOUS INTENSITY Iv@20mA (mcd)	WAVE LENGTH λp (nm)	OPERATING TEMP Topr	STORAGE TEMP Tstg	
<b>HIGH INTENSITY</b>									
524-501-21	Red	Colour Diffused	12	20	11000	643	-40 ~ +95 <sup>^</sup>	-40 ~ +100	Yes
524-521-21	Yellow	Colour Diffused	12	20	16000	591	-40 ~ +95 <sup>^</sup>	-40 ~ +100	Yes
524-532-21	Green	Colour Diffused	12	20	23000	527	-40 ~ +95 <sup>^</sup>	-40 ~ +100	Yes
524-930-21	Blue	Colour Diffused	12	20	7000	470	-40 ~ +95 <sup>^</sup>	-40 ~ +100	Yes
524-997-21	Cool White	Colour Diffused	12	20	14000	see below	-40 ~ +95 <sup>^</sup>	-40 ~ +100	Yes
524-501-23	Red	Colour Diffused	24-28	20	11000	643	-40 ~ +95 <sup>^</sup>	-40 ~ +100	Yes
524-521-23	Yellow	Colour Diffused	24-28	20	16000	591	-40 ~ +95 <sup>^</sup>	-40 ~ +100	Yes
524-532-23	Green	Colour Diffused	24-28	20	23000	527	-40 ~ +95 <sup>^</sup>	-40 ~ +100	Yes
524-930-23	Blue	Colour Diffused	24-28	20	7000	470	-40 ~ +95 <sup>^</sup>	-40 ~ +100	Yes
524-997-23	Cool White	Colour Diffused	24-28	20	14000	see below	-40 ~ +95 <sup>^</sup>	-40 ~ +100	Yes
<b>UNITS</b>			<b>Vdc</b>	<b>mA</b>	<b>mcd</b>	<b>nm</b>	<b>°C</b>	<b>°C</b>	



Other voltages AC/DC available. Please contact our Technical Sales.

<sup>^</sup> = Products must be derated according to the derating information. Each derating graph refers to specific LEDs.

997F-C	*Typical emission colour cool white			
x	0.245	0.361	0.356	0.264
y	0.229	0.385	0.351	0.220

Intensities (Iv) and colour shades of white (x,y co-ordinates) may vary between LEDs within a batch.

### How to Order:

website: [www.marl.co.uk](http://www.marl.co.uk) • email: [sales@marl.co.uk](mailto:sales@marl.co.uk) •

• Telephone +44 (0)1229 582430 • Fax: +44 (0)1229 585155

The information contained in this datasheet does not constitute part of any order or contract and should not be regarded as a representation relating to either products or service. Marl International reserve the right to alter without notice the specification or any conditions of supply for products or service.

### 524 Series

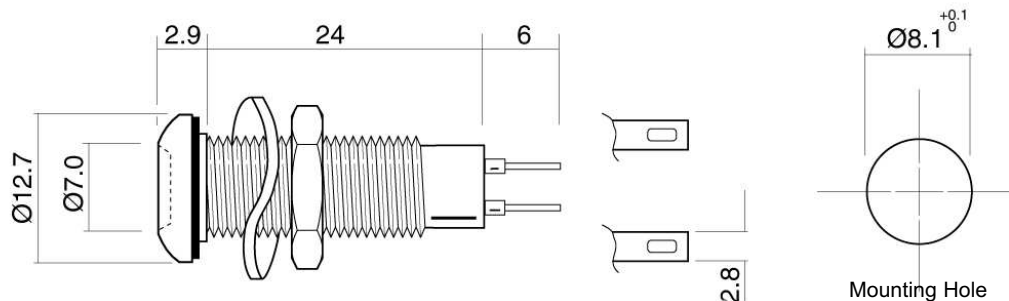

Dimensions in mm (Typical)  
Not to scale

Anode termination indicated by red sleeve  
Mounting hole to be clean and burr free

#### MATERIALS

Body	Stainless steel grade 303
Nut	Stainless steel grade 303
Panel Seal	Viton
Termination	Brass to BS 2874 CZ108 Copper flash undercoat with silver flash finish
Lock Washer	Stainless steel
Fresnel lens	Polycarbonate
Encapsulation	PC5430 resin

#### PUSH-ON CONNECTORS

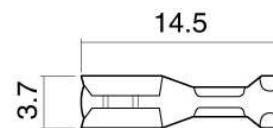

925-000-00 is brass tin plated.  
For use with 524 series lamps.

Dimensions in mm (Typical)  
Not to scale

#### TECHNICAL CHARACTERISTICS

SERIES	MAXIMUM POWER DISSIPATION	MAXIMUM REVERSE VOLTAGE	PANEL CUTOUT	NUT MOUNTING TORQUE	MINIMUM MOUNTING CENTRES	MIN/MAX. PANEL THICKNESS
524	825	1000	8.1	0.65	x,y=14.5	1.5-13.0
	mW	Vdc	mm	Nm	mm	mm

#### OPTIONAL FLYING LEAD TERMINATIONS

ORDER CODE SUFFIX	SUPPLY VOLTAGE	WIRE COLOUR	WIRE LENGTH	NO/DIAMETER OF CONDUCTORS	DIAMETER OVER INSULATION	COMMENTS
15	DC Products	Red-anode / Black-cathode	150mm	19/0.15mm	1.2mm	Customised lengths available
15	AC Products	Brown-live / Blue-neutral	150mm			
19	DC Products	Red-anode / Black-cathode	1000mm			
19	AC Products	Brown-live / Blue-neutral	1000mm			

website: [www.marl.co.uk](http://www.marl.co.uk) • email: [sales@marl.co.uk](mailto:sales@marl.co.uk) •

• Telephone +44 (0)1229 582430 • Fax: +44 (0)1229 585155

The information contained in this datasheet does not constitute part of any order or contract and should not be regarded as a representation relating to either products or service. Marl International reserve the right to alter without notice the specification or any conditions of supply for products or service.



BS EN ISO 9001:2000  
Approved Manufacturer

## DERATING INFORMATION

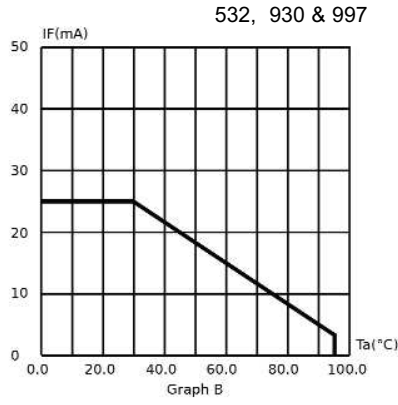
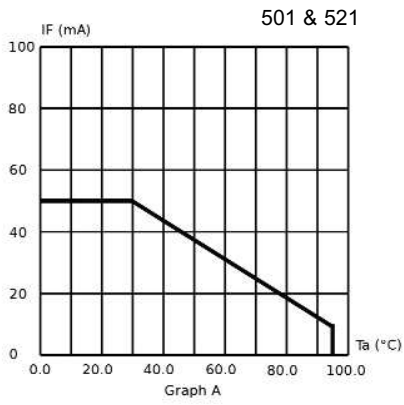

website: [www.marl.co.uk](http://www.marl.co.uk) • email: [sales@marl.co.uk](mailto:sales@marl.co.uk) •  
 • Telephone +44 (0)1229 582430 • Fax: +44 (0)1229 585155

The information contained in this datasheet does not constitute part of any order or contract and should not be regarded as a representation relating to either products or service. Marl International reserve the right to alter without notice the specification or any conditions of supply for products or service.



BS EN ISO 9001:2000  
Approved Manufacturer