

New!

# HDT Series Micro Mini Surface Mount Detect Switches

## Features/Benefits

- Low profile package sits just 3,35 mm off PCB
- Design allows top or side actuation
- Low actuation force, 30 grams max.
- Pick and place compatible, available in tape & reel packaging

## Typical Applications

- Consumer electronics
- Computers
- Medical devices



## Specifications

CONTACT RATING: 1 mA 5 VDC  
 MECHANICAL AND ELECTRICAL LIFE: 50,000 cycles min.  
 CONTACT RESISTANCE: 500 m Ω max. initial.  
 INSULATION RESISTANCE: 50 M Ω max. between adjacent contacts.  
 OPERATING TEMPERATURE: 10°C to +60°C  
 PACKAGING: Tape & reel, 3,000 per reel.

## Materials

HOUSING: LCP 30% GF  
 COVER: LCP 30% GF  
 STEM: LCP 30% GF  
 MOVABLE BLADE: Phosphor bronze.  
 TERMINALS: Phosphor bronze.

**NOTE:** Specifications and materials listed above are for switches with standard options. For information on specific and custom switches, consult Customer Service Center.

## Build-A-Switch

Complete part numbers for HDT Series are shown below.

PART NUMBER	PACKAGING	SCHEMATIC
<b>HDT0001</b>	TAPE & REEL	

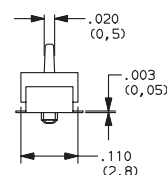
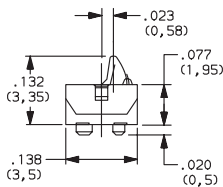

HDT0001

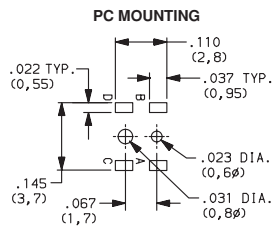
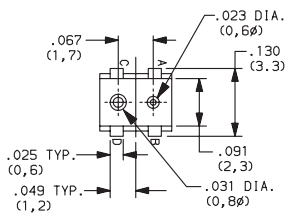

## TAPE & REEL

