

A01 - A02 SERIES

INDUSTRIAL CONTROLS

Distinctive features

A01 and A02 Series are designed and manufactured in the United Kingdom

The A01 and A02 series offer ranges of:

- pushbutton switches, illuminated or not
- indicators
- 2 or 3 position keylock switches
- 2 or 3 position rotary lever switches
- emergency stop switches

with rectangular, square or round operators.

- Environmental protection : IP65
- Modular construction
- Electrical life : 50.000 cycles min.
- Screen engraving or insertable legends on request
- Approvals



UL 1054



BS RIA 20
Shock & Vibration



VDE



EN 61058



Sub-assembly

For single part number assemblies please contact APEM Components

A01 Series

- Panel cut-out :
 - Ø 16mm (.630)
 - flush mount : Ø 22mm (.866)
- 1, 2, 3 and 4 poles
- Solder lug/quick-connect terminals
- Contacts : silver, gold plated
- Current/voltage rating :
 - 6A 250VAC max. - 10mA 5VAC min.
- Lamp : filament, neon or multi-chip LED

A02 Series

- Panel cut-out :
 - round or square : Ø 22mm (.866)
 - rectangular : 29,5 x 21,5mm (1.160 x .846)
 - flush mount : Ø30mm (1.378)
- 1 and 2 poles
- Screw terminals (optional : quick connect terminals)
- Contacts : silver
- Current/voltage rating :
 - 12A 380VAC - 16A 250VAC max.
 - 25mA 5VAC min.
- Lamp : filament, neon, multi-chip LED
or special multi-LED assembly

For back of panel safety, this series has a unique covered cable connection arrangement. See page 25.

A01 - A02 SERIES

INDUSTRIAL CONTROLS

Specifications

ELECTRICAL SPECIFICATIONS

	A01	A02
• Function :	Momentary or maintained action	Momentary or maintained action
• Current/voltage rating :	10mA 5VAC min. 6A 250VAC max. 6A/12VDC max.	25mA 5VAC min. 12A 380VAC - 16A 250VAC max. 12A/12VDC max.
• Contact gap :	>1mm (.039)	Double break 2 x 1,5mm (.059)
• Initial contact resistance :	10mΩ max. at 1A 4VDC	10mΩ max. at 1A 4VDC
• Insulation resistance :	50 MΩ min.	50 MΩ min.
• Dielectric strength :	750V between open contacts 5KV live to accessible	2KV between open contacts 4KV live to accessible
• Electrical life :	50.000 cycles min.	50.000 cycles min.
• Insulation :	Class 2	Class 2
• Lamp life :	LED : 60.000 h min. to 75% relative luminosity - Filament : approx. 5.000h Neon : approx. 10.000 h	LED : 60.000 h min. to 75% relative luminosity - Filament : approx. 5.000h Neon : approx. 10.000 h
• Lamp circuit diagrams	 	 

GENERAL SPECIFICATIONS

	A01	A02
• Min. mechanical life :	Pushbutton momentary : 1 million cycles Pushbutton maintained : 100.000 cycles Keylock and rotary : 100.000 cycles	Pushbutton momentary : 1 million cycles Pushbutton maintained : 100.000 cycles Keylock and rotary : 100.000 cycles
• Operating temperature :	-20°C to +55°C	-20°C to +85°C
• Solder heat resistance : (IEC 68-2-20Tb, method 2)	350°C, 5 sec.	350°C, 5 sec.
• Degree of environmental protection (IEC 529)	IP 65 front of panel IP 40 back of panel	IP 65 front of panel IP 40 back of panel
• Lamps :	Midget Grooved T1 ³ / ₄ filament, multi-chip LED or neon	Midget Grooved T1 ³ / ₄ filament, multi-chip LED or neon Special multi-LED assembly
• Switch terminals :	Solder/quick-connect 2,8mm (.110)	M3 screws - wire 2 x 0,75mm 2 max.
• Lamp terminals :	Solder/quick-connect 2,8mm (.110)	M3 screws Flexible wire 2 x 2,5mm ² max. Rigid wire 4mm ² max

For screen engraving or film legends, consult factory. For approved models consult APEM.

A01 SERIES

ILLUMINATED OR NON-ILLUMINATED PUSHBUTTON SWITCHES

Panel cut-out Ø16 (.630)

A pushbutton assembly requires:

screen + lamp (if illuminated) + operator + switchblock

To order these elements, select desired model numbers from tables below.

Example: IP65 rectangular pushbutton, single pole, maintained, red screen and 12V red LED = A0161B, A0142M1, A0101X and A0151B

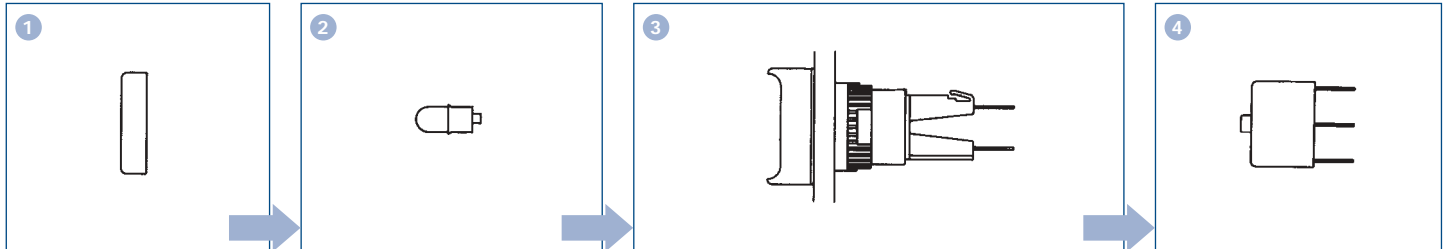
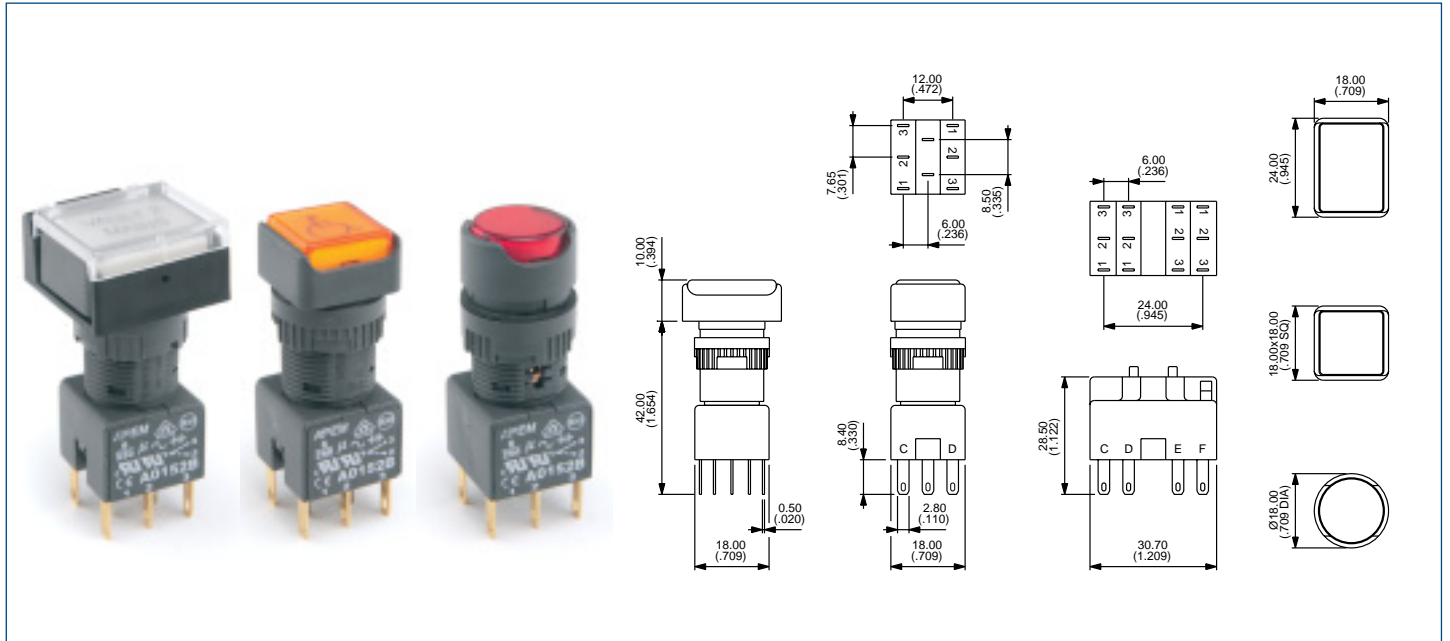
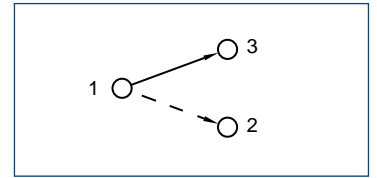

Screen

Lamp

Operator

Switch block

Bezel	Colour	Part No
<input type="checkbox"/>	black	A0161A
<input type="checkbox"/>	red	A0161B
<input type="checkbox"/>	amber	A0161C
<input type="checkbox"/>	yellow	A0161D
<input type="checkbox"/>	green	A0161E
<input type="checkbox"/>	blue	A0161F
<input type="checkbox"/>	clear	A0161G
<input type="checkbox"/>	white	A0161J
<input type="checkbox"/>	black	A0162A
<input type="checkbox"/>	red	A0162B
<input type="checkbox"/>	amber	A0162C
<input type="checkbox"/>	yellow	A0162D
<input type="checkbox"/>	green	A0162E
<input type="checkbox"/>	blue	A0162F
<input type="checkbox"/>	clear	A0162G
<input type="checkbox"/>	white	A0162J
<input type="checkbox"/>	black	A0163A
<input type="checkbox"/>	red	A0163B
<input type="checkbox"/>	amber	A0163C
<input type="checkbox"/>	yellow	A0163D
<input type="checkbox"/>	green	A0163E
<input type="checkbox"/>	blue	A0163F
<input type="checkbox"/>	clear	A0163G
<input type="checkbox"/>	white	A0163J

Lamp	Voltage	Part No
Filament	6.3V	A0141A
Filament	14V	A0141B
Filament	28V	A0141C
Filament	36V	A0141D
Filament	48V	A0141E
Filament	60V	A0141F
Neon	110V	A0143G
Neon	220V	A0143H
LED	6V red	A0142L1
LED	6V green	A0142L2
LED	6V amber	A0142L3
LED	12V red	A0142M1
LED	12V green	A0142M2
LED	12V amber	A0142M3
LED	12V blue	A0142M4
LED	12V white	A0142M5
LED	24V red	A0142N1
LED	24V green	A0142N2
LED	24V amber	A0142N3
LED	24V blue	A0142N4
LED	24V white	A0142N5
LED	48V red	A0142P1
LED	48V green	A0142P2
LED	48V amber	A0142P3

Pole	Bezel	Description	Part No
1 or 2	<input type="checkbox"/>	Illum, momentary	A0101Y
1 or 2	<input type="checkbox"/>	Illum, maintained	A0101X
1 or 2	<input type="checkbox"/>	Non-illum, momentary	A0102Y
1 or 2	<input type="checkbox"/>	Non-illum, maintained	A0102X
3 or 4	<input type="checkbox"/>	Illum, momentary	A0103Y
3 or 4	<input type="checkbox"/>	Illum, maintained	A0103X
3 or 4	<input type="checkbox"/>	Non-illum, momentary	A0104Y
3 or 4	<input type="checkbox"/>	Non-illum, maintained	A0104X
1 or 2	<input type="checkbox"/>	Illum, momentary	A0105Y
1 or 2	<input type="checkbox"/>	Illum, maintained	A0105X
1 or 2	<input type="checkbox"/>	Non-illum, momentary	A0106Y
1 or 2	<input type="checkbox"/>	Non-illum, maintained	A0106X
3 or 4	<input type="checkbox"/>	Illum, momentary	A0107Y
3 or 4	<input type="checkbox"/>	Illum, maintained	A0107X
3 or 4	<input type="checkbox"/>	Non-illum, momentary	A0108Y
3 or 4	<input type="checkbox"/>	Non-illum, maintained	A0108X
1 or 2	<input type="checkbox"/>	Illum, momentary	A0109Y
1 or 2	<input type="checkbox"/>	Illum, maintained	A0109X
1 or 2	<input type="checkbox"/>	Non-illum, momentary	A0110Y
1 or 2	<input type="checkbox"/>	Non-illum, maintained	A0110X
3 or 4	<input type="checkbox"/>	Illum, momentary	A0111Y
3 or 4	<input type="checkbox"/>	Illum, maintained	A0111X
3 or 4	<input type="checkbox"/>	Non-illum, momentary	A0112Y
3 or 4	<input type="checkbox"/>	Non-illum, maintained	A0112X

No of poles	Part No
Single pole	A0151B
Double pole	A0152B
Three pole	A0155B
Four pole	A0153B

Unsealed switches (IP40):
add '01' to end of
operator model number

Screen engraving/
insertable legends:
contact APEM Components

Bezel: rectangular square round. 'Illum' - illuminated, 'Non-illum' - non illuminated

A01 SERIES

INDICATORS

Panel cut-out Ø16 (.630)

An indicator assembly requires:

screen + lamp + operator

To order these elements, select desired model numbers from tables below.

Example: IP65 rectangular indicator with red screen and 12V red LED = A0161B, A0142M1 and A0171

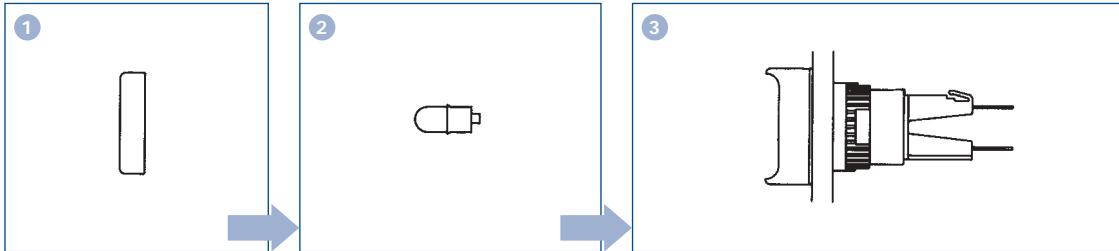
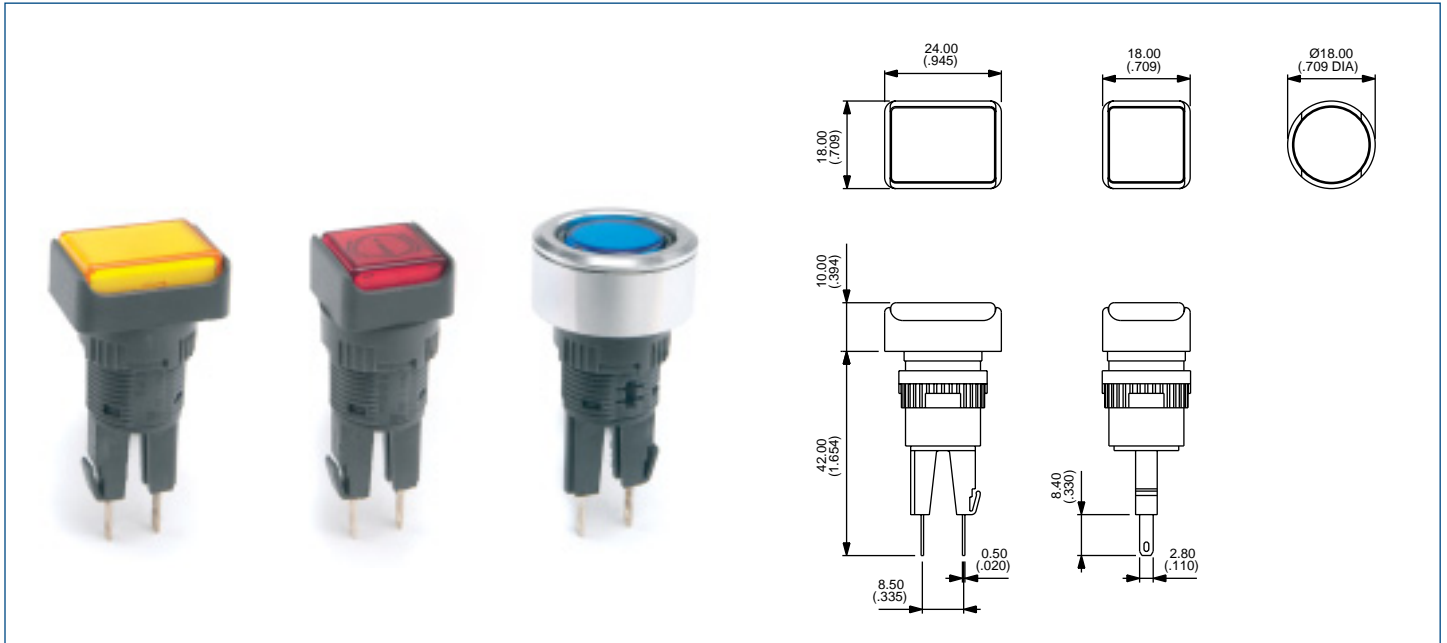

Screen

Bezel	Colour	Part No
<input type="checkbox"/>	black	A0161A
<input type="checkbox"/>	red	A0161B
<input type="checkbox"/>	amber	A0161C
<input type="checkbox"/>	yellow	A0161D
<input type="checkbox"/>	green	A0161E
<input type="checkbox"/>	blue	A0161F
<input type="checkbox"/>	clear	A0161G
<input type="checkbox"/>	white	A0161J
<input type="checkbox"/>	black	A0162A
<input type="checkbox"/>	red	A0162B
<input type="checkbox"/>	amber	A0162C
<input type="checkbox"/>	yellow	A0162D
<input type="checkbox"/>	green	A0162E
<input type="checkbox"/>	blue	A0162F
<input type="checkbox"/>	clear	A0162G
<input type="checkbox"/>	white	A0162J
<input type="checkbox"/>	black	A0163A
<input type="checkbox"/>	red	A0163B
<input type="checkbox"/>	amber	A0163C
<input type="checkbox"/>	yellow	A0163D
<input type="checkbox"/>	green	A0163E
<input type="checkbox"/>	blue	A0163F
<input type="checkbox"/>	clear	A0163G
<input type="checkbox"/>	white	A0163J

Lamp

Lamp	Voltage	Part No
Filament	6.3V	A0141A
Filament	14V	A0141B
Filament	28V	A0141C
Filament	36V	A0141D
Filament	48V	A0141E
Filament	60V	A0141F
Neon	110V	A0143G
Neon	220V	A0143H
LED	6V red	A0142L1
LED	6V green	A0142L2
LED	6V amber	A0142L3
LED	12V red	A0142M1
LED	12V green	A0142M2
LED	12V amber	A0142M3
LED	12V blue	A0142M4
LED	12V white	A0142M5
LED	24V red	A0142N1
LED	24V green	A0142N2
LED	24V amber	A0142N3
LED	24V blue	A0142N4
LED	24V white	A0142N5
LED	48V red	A0142P1
LED	48V green	A0142P2
LED	48V amber	A0142P3

Operator

Bezel	Description	Part No
<input type="checkbox"/>	Indicator	A0171
<input type="checkbox"/>	Indicator	A0172
<input type="checkbox"/>	Indicator	A0173

Unsealed switches (IP40):
add '01' to end of operator model number

Screen engraving/insertable legends:
contact APEM Components

Bezel: rectangular square round.

A01 SERIES

ROTARY LEVER SWITCHES

Panel cut-out Ø16 (.630)

A rotary level switch assembly requires:

operator + switchblock

To order these elements, select desired model numbers from tables below.

Example: IP65 rectangular rotary switch with long lever, single pole, 2 positions maintained = A019101 and A0151B

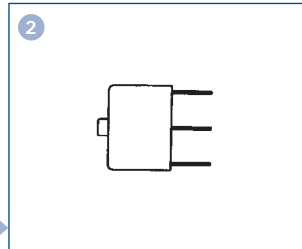
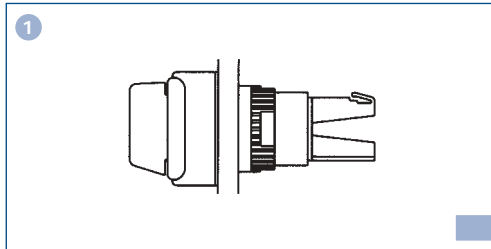
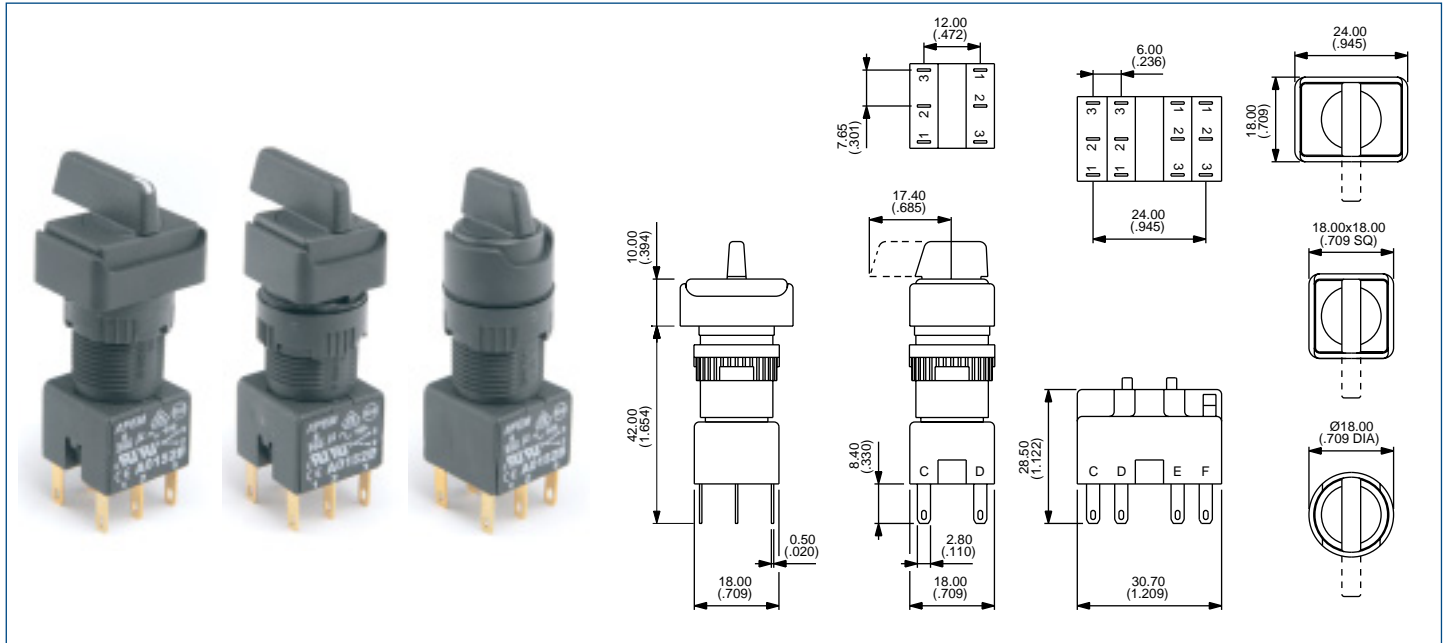
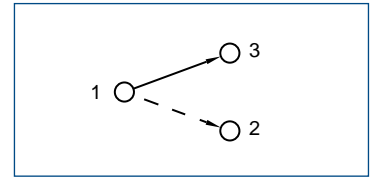

Operator

Pole	Bezel	Description	Short lever	Long lever
1 or 2	□	2 pos. maintained	A019201	A019101
1 or 2	□	2 pos. momentary	A019202	A019102
3 or 4	□	2 pos. maintained	A019203	A019103
3 or 4	□	2 pos. momentary	A019204	A019104
1 or 2	□	3 pos. maintained	A019205	A019105
1 or 2	□	3 pos. momentary	A019206	A019106
1 or 2	□	3 pos. mainL, momR	A019207	A019107
1 or 2	□	3 pos. momL, mainR	A019208	A019108
1 or 2	□	2 pos. maintained	A019401	A019301
1 or 2	□	2 pos. momentary	A019402	A019302
3 or 4	□	2 pos. maintained	A019403	A019303
3 or 4	□	2 pos. momentary	A019404	A019304
1 or 2	□	3 pos. maintained	A019405	A019305
1 or 2	□	3 pos. momentary	A019406	A019306
1 or 2	□	3 pos. mainL, momR	A019407	A019307
1 or 2	□	3 pos. momL, mainR	A019408	A019308
1 or 2	○	2 pos. maintained	A019601	A019501
1 or 2	○	2 pos. momentary	A019602	A019502
3 or 4	○	2 pos. maintained	A019603	A019503
3 or 4	○	2 pos. momentary	A019604	A019504
1 or 2	○	3 pos. maintained	A019605	A019505
1 or 2	○	3 pos. momentary	A019606	A019506
1 or 2	○	3 pos. mainL, momR	A019607	A019507
1 or 2	○	3 pos. momL, mainR	A019608	A019508

Switch block

No of poles	Part No
Single pole	A0151B
Double pole	A0152B
Three pole	A0155B
Four pole	A0153B

Lever Positions

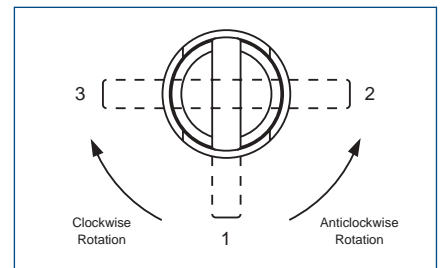

Lever Rotation – 2 position switches

The model numbers shown are for switches with anticlockwise lever rotation.

For clockwise rotation, replace:

01 with 09
02 with 10
03 with 11
04 with 12

at the end of the model number

A01 SERIES

KEYLOCK SWITCHES

Panel cut-out Ø16 (.630)

An keylock assembly requires:

operator + switchblock

To order these elements, select desired model numbers from tables below.

Example: rectangular keyswitch, single pole, 2 positions maintained
= A018101 and A0151B

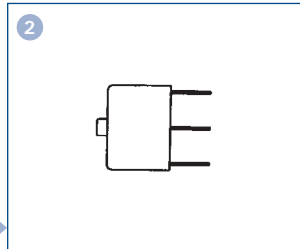
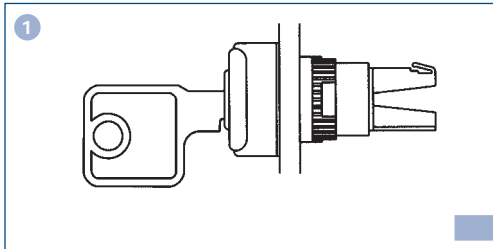
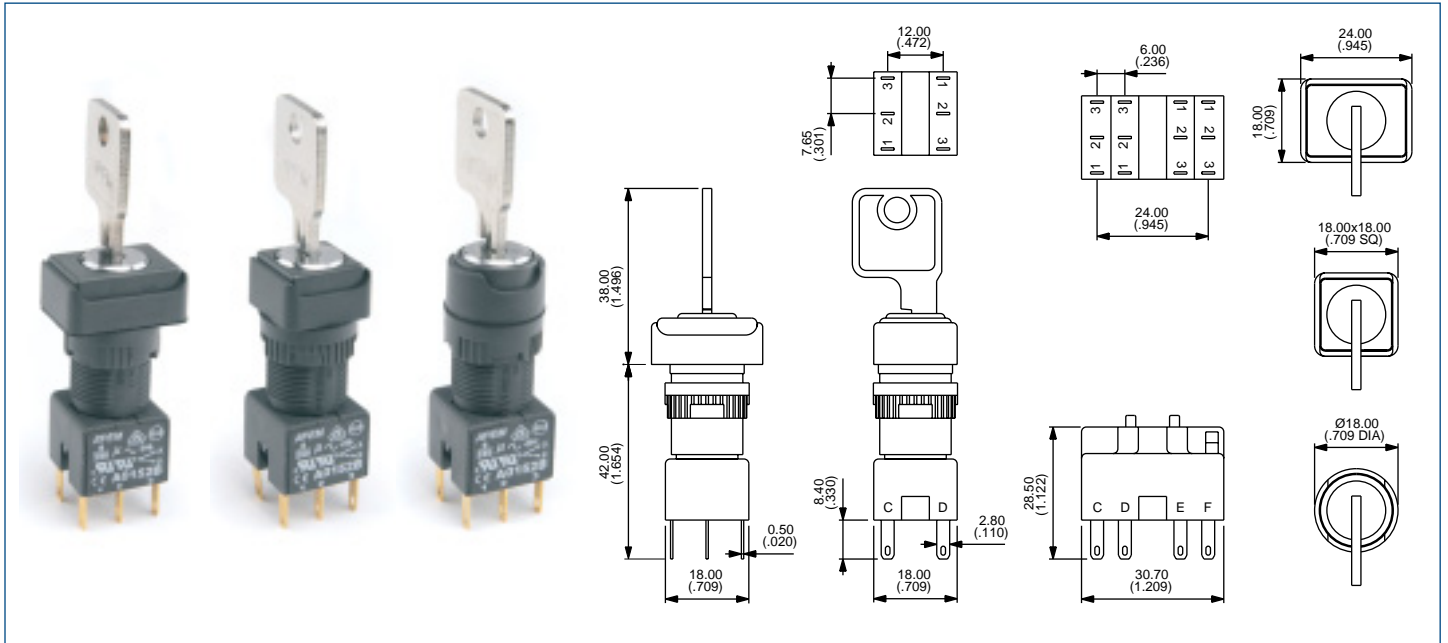
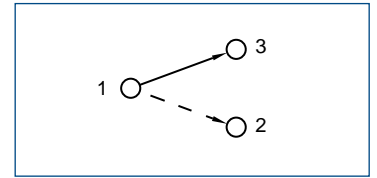

Operator

Pole	Bezel	Description	Part No.	Key removable
1 or 2	□	2 pos. maintained	A018101	A-C
1 or 2	□	2 pos. momentary	A018102	A
3 or 4	□	2 pos. maintained	A018103	A-C
3 or 4	□	2 pos. momentary	A018104	A
1 or 2	□	3 pos. maintained	A018105	A-B-C
1 or 2	□	3 pos. momentary	A018106	A
1 or 2	□	3 pos. mainL, momR	A018107	A-B
1 or 2	□	3 pos. momL, mainR	A018108	A-C
1 or 2	□	2 pos. maintained	A018201	A-C
1 or 2	□	2 pos. momentary	A018202	A
3 or 4	□	2 pos. maintained	A018203	A-C
3 or 4	□	2 pos. momentary	A018204	A
1 or 2	□	3 pos. maintained	A018205	A-B-C
1 or 2	□	3 pos. momentary	A018206	A
1 or 2	□	3 pos. mainL, momR	A018207	A-B
1 or 2	□	3 pos. momL, mainR	A018208	A-C
1 or 2	○	2 pos. maintained	A018301	A-C
1 or 2	○	2 pos. momentary	A018302	A
3 or 4	○	2 pos. maintained	A018303	A-C
3 or 4	○	2 pos. momentary	A018304	A
1 or 2	○	3 pos. maintained	A018305	A-B-C
1 or 2	○	3 pos. momentary	A018306	A
1 or 2	○	3 pos. mainL, momR	A018307	A-B
1 or 2	○	3 pos. momL, mainR	A018308	A-C

Switch block

No of poles	Part No
Single pole	A0151B
Double pole	A0152B
Three pole	A0155B
Four pole	A0153B

- Non-removable key positions: contact APEM components
- 2 standard keys are supplied
- 20 key barrel types available from stock
- For on-on-on function contact APEM components

Key Positions

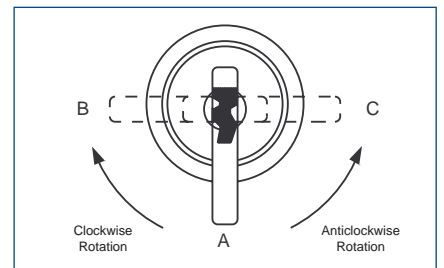

Key Rotation – 2 position switches

The model numbers shown are for switches with anticlockwise key rotation.

For clockwise rotation, replace:

- 01 with 25
- 02 with 24
- 03 with 27
- 04 with 28

at the end of the model number

A01 SERIES

EMERGENCY STOP SWITCHES

Panel cut-out Ø16 (.630)

- Prominent Ø 24mm (.944) or optional Ø 40mm (1.575) dia. red mushroom actuator
- Highly reliable positive break switch
- Push to shut off switch, twist to reset to ON

An emergency stop switch assembly requires:

operator + switch block

To order specify with single pole or double pole positive break switch block.

Approved to UL1054/EN 60947-5-1

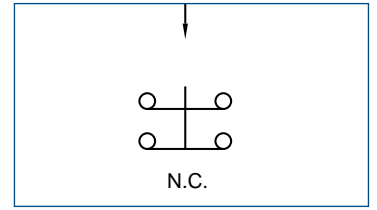

General Specifications

Min. Mechanical Life	: 6050 cycles (6 cycles per minute)
Operating Force	: 16N – 0.1Nm
Operating Temperature	: -20°C to +55°C
Solder Heat Resistance	: 350°C, 5 secs (IEC 68-2-2-20Tb, method 2)
Degree of Environmental Protection (IEC 529)	: IP65 front of panel IP40 back of panel
Switch Terminals	: Solder/quick-connect 2.8mm (.110) (IEC 68-2-20)

Electrical Specifications

Current/Voltage rating	: 1.5A 250 VAC AC-15
Contact Gap	: >3mm
Dielectric test voltage	: 2900V
Electrical Life	: >6050

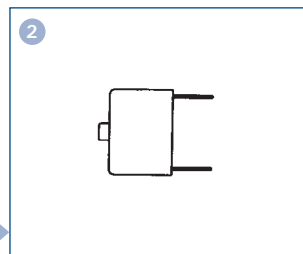
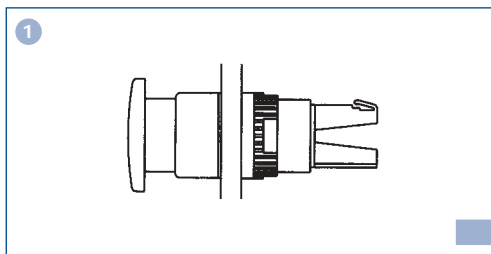
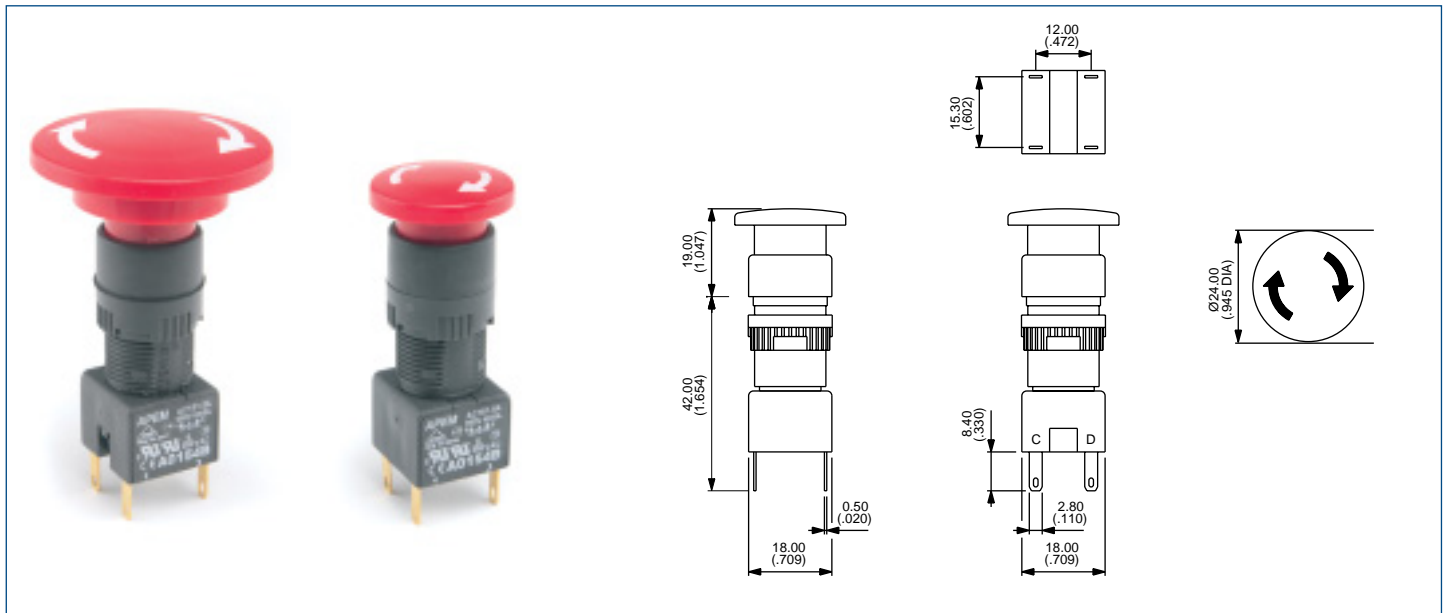

Operator

Bezel	Description	Part No
○	Emergency stop	A01ES
Option		
40Ømm	Emergency stop	A01ES SP3

Switch block

No of poles	Part No
Single pole	A0150B
Double pole	A0154B

Accessories



60Ø Self Adhesive Label

Description	Part No
Yellow label with text	A01YL1
Yellow label	A01YL2

A01 SERIES

EMERGENCY STOP SWITCHES/MUSHROOM HEAD PUSHBUTTON SWITCHES Fitted in Enclosures

- Prominent Ø 40mm (1.575) dia. red mushroom actuator, twist to release
- Robust polycarbonate enclosures
- Highly reliable positive break switching on E-stop
- Sealed to IP65
- 6A current rating
- Knockouts for popular conduit sizes
- Double pole changeover switch blocks available for momentary/maintained mushroom head pushbuttons

Technical Specifications

Contact Rating	: 6A 250 VAC/1.5A 250 VAC – E-Stop
Dimensions	: 65 x 65 x 57mm
Electrical Life	: 50,000 cycles/6050 cycles – E-Stop
Operating Temperature	: -20°C – +55°C

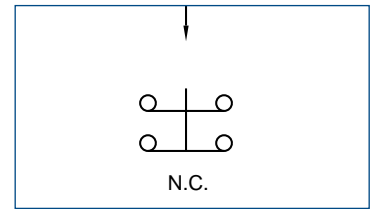

Emergency Stop

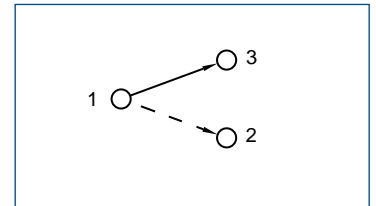

Momentary and Maintained

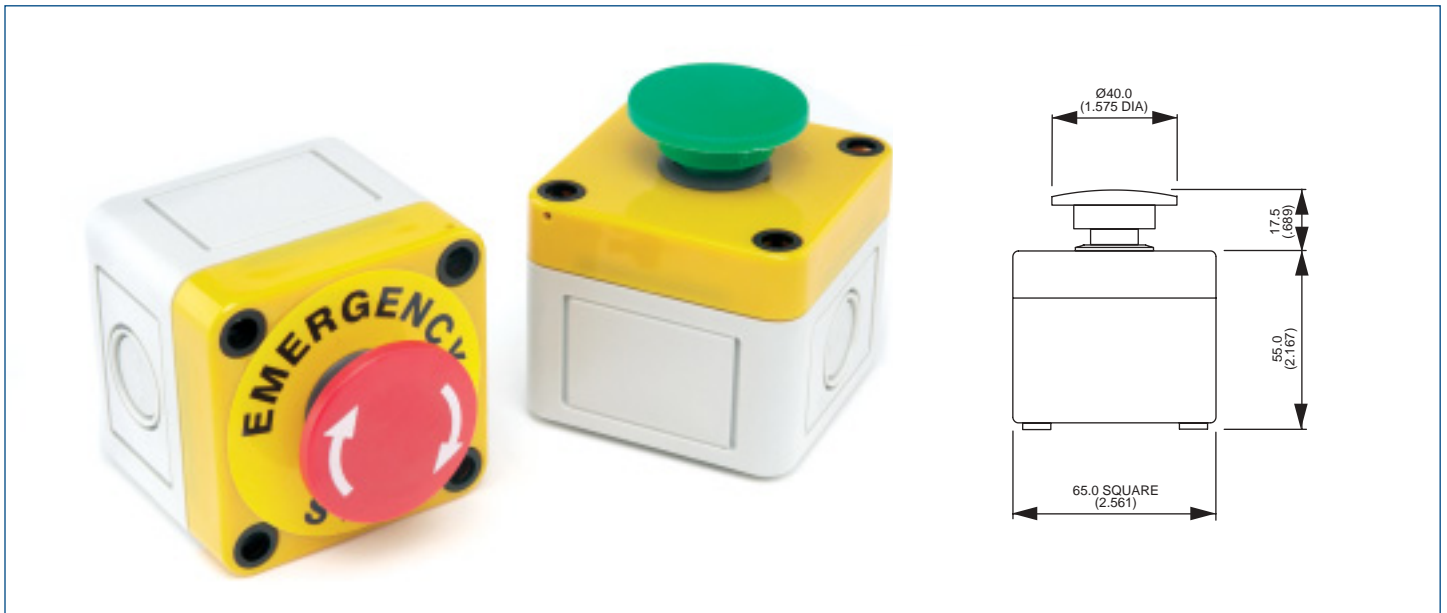

Description	Part No
Emergency Stop	A01ESSP354B + PEA01
Black Momentary	A01MMASP352B + PEA01
Red Momentary	A01MMBSP352B + PEA01
Yellow Momentary	A01MMDSP352B + PEA01
Green Momentary	A01MMESP352B + PEA01
Blue Momentary	A01MMFSP352B + PEA01
Black Maintained	A01MXASP352B + PEA01
Red Maintained	A01MXBSP352B + PEA01
Yellow Maintained	A01MXDSP352B + PEA01
Green Maintained	A01MXESP352B + PEA01
Blue Maintained	A01MXFSP352B + PEA01
Options	
12A 250V versions or custom printing on mushroom head actuators please contact APEM Components.	

A01 SERIES

MUSHROOM HEAD PUSHBUTTON SWITCHES

Panel cut-out Ø16 (.630)

- Prominent Ø 40mm (1.575) dia. mushroom actuators
- Momentary and maintained functions. Momentary function versions are unmarked, maintained function versions are twist release (arrows indicate direction of twist)
- Various coloured mushroom actuators are available

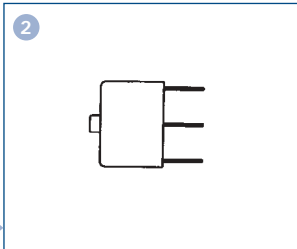
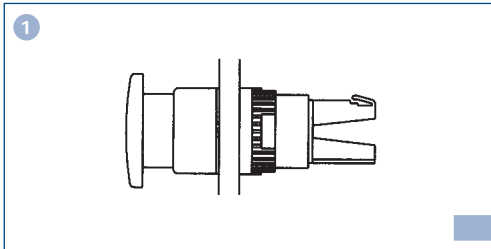
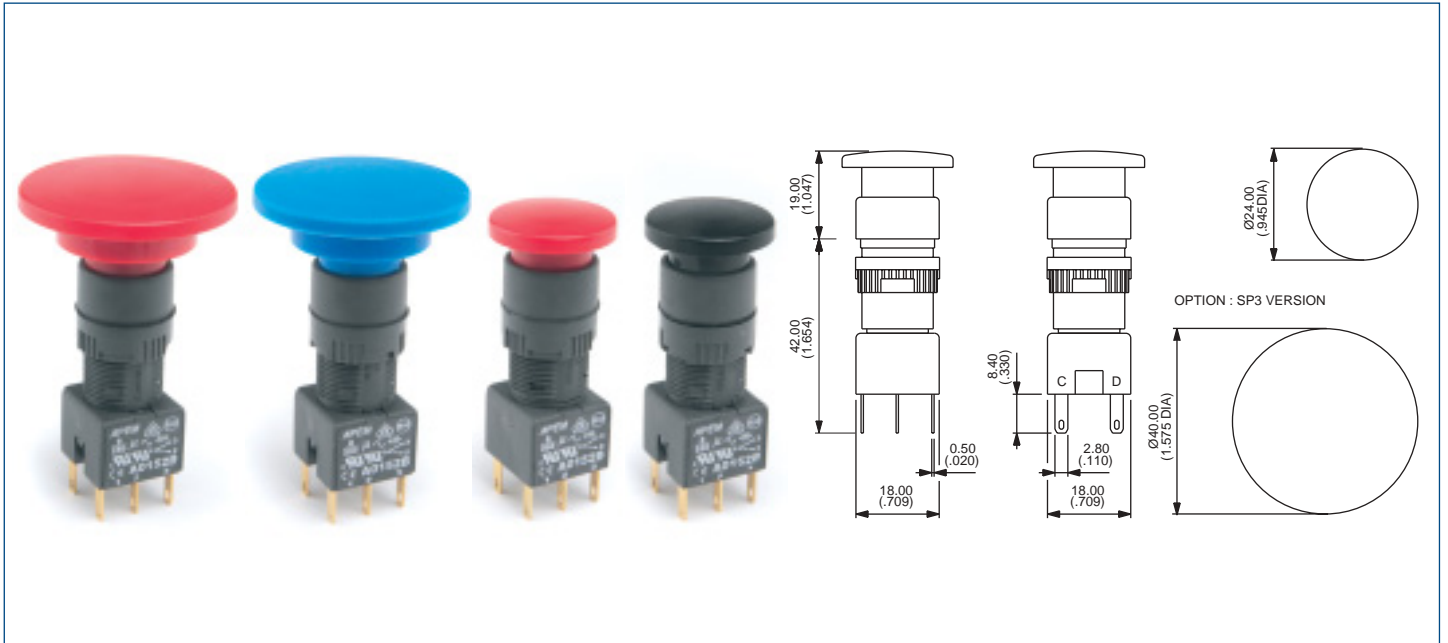
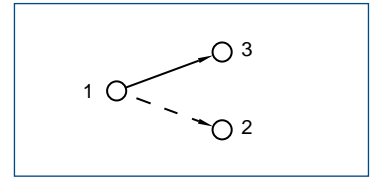

Operator

Switch block

Actuator	Description	Part No
24mmØ	Black Momentary	A01MMA
24mmØ	Red Momentary	A01MMB
24mmØ	Yellow Momentary	A01MMD
24mmØ	Green Momentary	A01MME
24mmØ	Blue Momentary	A01MMF
24mmØ	Black Maintained	A01MXA
24mmØ	Red Maintained	A01MXB
24mmØ	Yellow Maintained	A01MXD
24mmØ	Green Maintained	A01MXE
24mmØ	Blue Maintained	A01MXF
40mmØ	Black Momentary	A01MMA SP3
40mmØ	Red Momentary	A01MMB SP3
40mmØ	Yellow Momentary	A01MMD SP3
40mmØ	Green Momentary	A01MME SP3
40mmØ	Blue Momentary	A01MMF SP3
40mmØ	Black Maintained	A01MXA SP3
40mmØ	Red Maintained	A01MXB SP3
40mmØ	Yellow Maintained	A01MXD SP3
40mmØ	Green Maintained	A01MXE SP3
40mmØ	Blue Maintained	A01MXF SP3

No of poles	Part No
Single pole	A0151B
Double pole	A0152B
Three pole	A0155B
Four pole	A0153B

A1 SERIES

ENGRAVED ALUMINIUM FLUSH MOUNTING PUSHBUTTON SWITCHES & INDICATORS Panel cut-out Ø22

An pushbutton assembly requires:

Engraved screen + lamp (if illuminated) + operator + switch block + flush mount bezel
To order these elements, select desired model numbers from the table below.

Example: Pushbutton, round, illuminated, sealed to IP 65, latching, single pole with 'start' engraving, 24V blue LED and flush mounting bezel. A1PCA1X103K403.

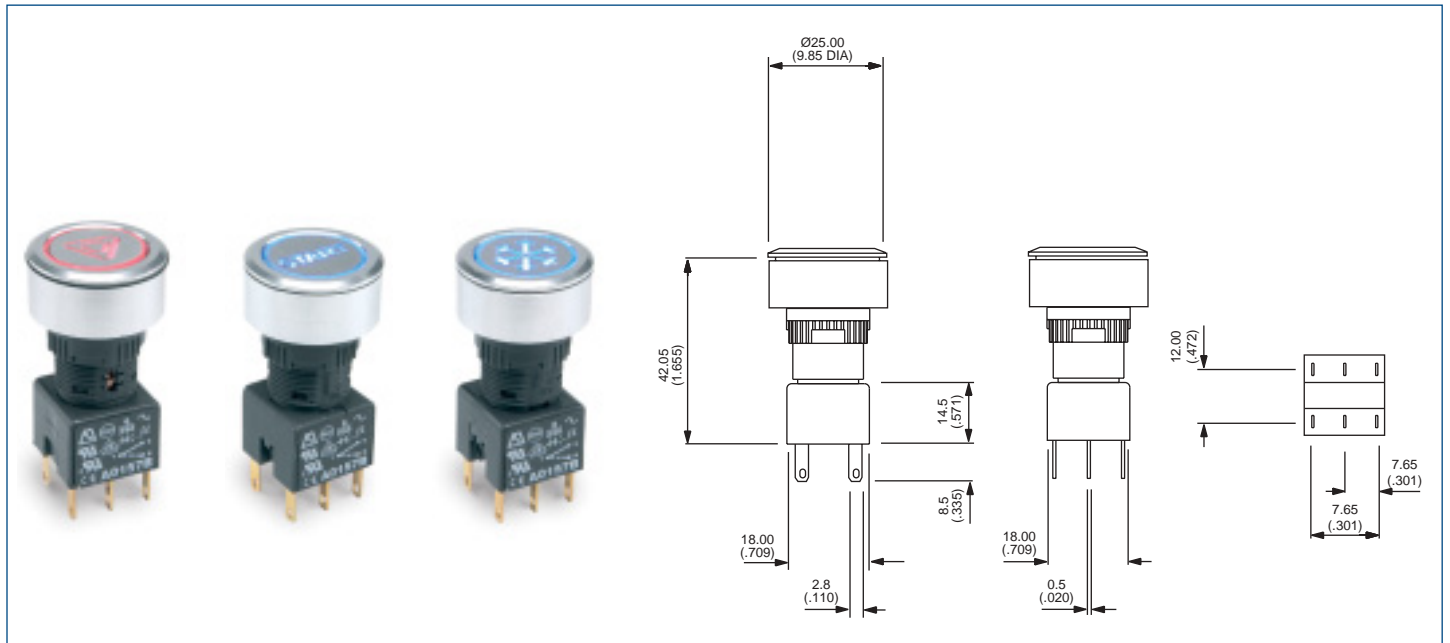
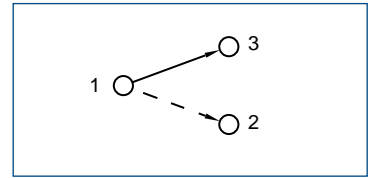

A1									
Switch Type	Bezel	Illumination	Sealing	Function	Switch Block	Accessories			
P - pushbutton I - indicator	C - round	A - illuminated B - non-illum.	0 - unsealed 1 - sealed IP65	0 - indicator X - latching Y - momentary	0 - indicator 1 - single pole 2 - double pole 5 - three pole 3 - four pole	03 - flushmount			
						Bulb			
						A1 - filament 6.3v B1 - filament 14v C1 - filament 28v D1 - filament 36v E1 - filament 48v F1 - filament 60v G1 - Neon 110v H1 - Neon 220v I1 - Led 6v red I2 - Led 6v green I3 - Led 6v amber J1 - Led 12v red J2 - Led 12v green J3 - Led 12v amber J4 - Led 12v blue J5 - Led 12v white K1 - Led 24v red K2 - Led 24v green K3 - Led 24v amber K4 - Led 24v blue K5 - Led 24v white L1 - Led 48v red L2 - Led 48v green L3 - Led 48v amber			

Engraved Screen Options

	01 - Front Fog Lights		11 - 'Lock'
	02 - Rear Fog Lights		12 - 'Unlock'
	03 - 'Start'		13 - Rear Window Heating
	04 - Interior Light		14 - Cooling
	05 - Boot Release		15 - Wipers
	06 - Hazard Warning		16 - Washers
	07 - Lights		17 - Fan
	08 - Heating and Ventilation		18 - Horn
	09 - Map Lights		19 - Air recirculation
	10 - Side Lights		20 - Blank

For other screen engraving options contact APEM Components

A01 SERIES

INDUSTRIAL CONTROLS

Installation – tools

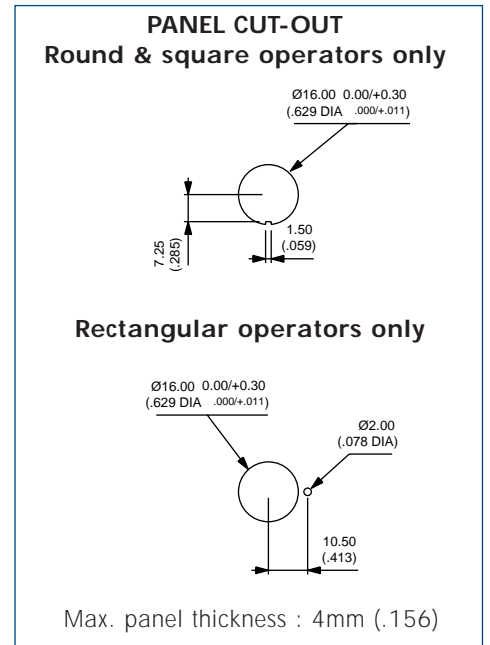
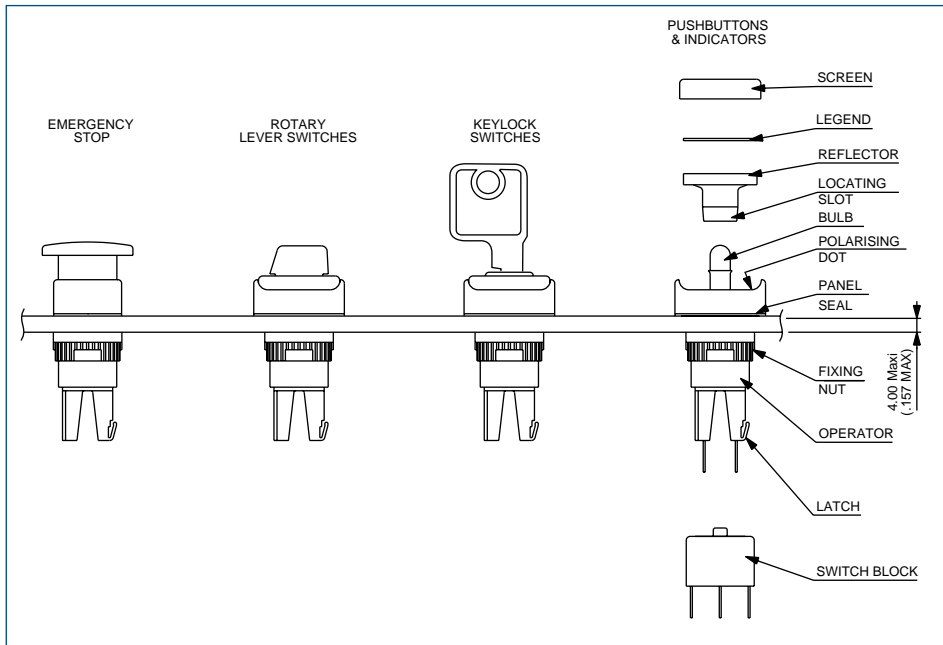

PANEL MOUNTING ASSEMBLY

- Drill/punch hole shaped as above.
- Assemble front operator through hole, fit fixing nut and tighten to a maximum torque of 0.8Nm using tool No. 30-0001.
- Wire chosen switch block as required and slide onto operator until latch engages.
- Fit bulb if required using tool No. 30-0002.
- Snap screen onto reflector assembly with legend in between if required and snap onto front operator TAKING CARE TO LINE UP THE LOCATING SLOT WITH THE POLARISING DOT, and not to damage the seal.

TO REMOVE BULB

Remove reflector/screen assembly. Use the bulb extractor 30-0002 to remove the bulb.

SWITCH BLOCK

To assemble switch block to front operator, firstly, TAKE CARE TO LINE UP SWITCH BLOCK WITH FRONT OPERATOR. Once in position slide on to front operator. N.B. Ensure latch is fully engaged correctly onto the switch block.

To remove switch block, depress the latch and slide the switch block off the operator.

FIXING NUT KEY



BULB REMOVER

