

ELCO EUROPE (A DIVISION OF AVX LTD.) CONFIDENTIAL PROPRIETARY
 THE DRAWING ON THIS PRINT AND INFORMATION THEREWITH ARE
 PROPRIETARY TO ELCO EUROPE (A DIVISION OF AVX LTD.) AND
 SHALL NOT BE USED OR DISCUSSED IN WHOLE OR IN PART
 WITHOUT ELCO EUROPE'S WRITTEN CONSENT.

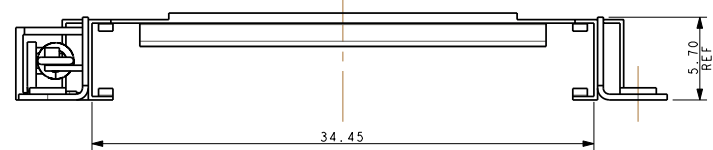

- NOTES :-
1. DIMENSIONS ARE REFERENCE DIMENSIONS UNLESS TOLERANCED.
 2. COMPONENT CAN ONLY BE USED WITH 26 WAY HEADER CONNECTOR 10-9185-026-001-002.
 3. THIS COMPONENT IS FULLY COMPATIBLE WITH PCI EXPRESS KITS OF 34mm WIDTH.
 4. CONNECTOR SHOWN FOR REFERENCE ONLY.
 5. AREA ON PCB COVERED BY THE GUIDERAIL AND CONNECTOR, NOT AVAILABLE FOR OTHER COMPONENTS.
 6. AREA OCCUPIED BY 34mm KIT IN LOCKED POSITION.
 7. 2 MOUNTING SCREWS REQUIRED, THREAD M2, MAXIMUM TORQUE 0.15Nm.
 8. PACKING IN TRAYS, 9 PARTS PER TRAY, 180 PARTS PER CARTON.

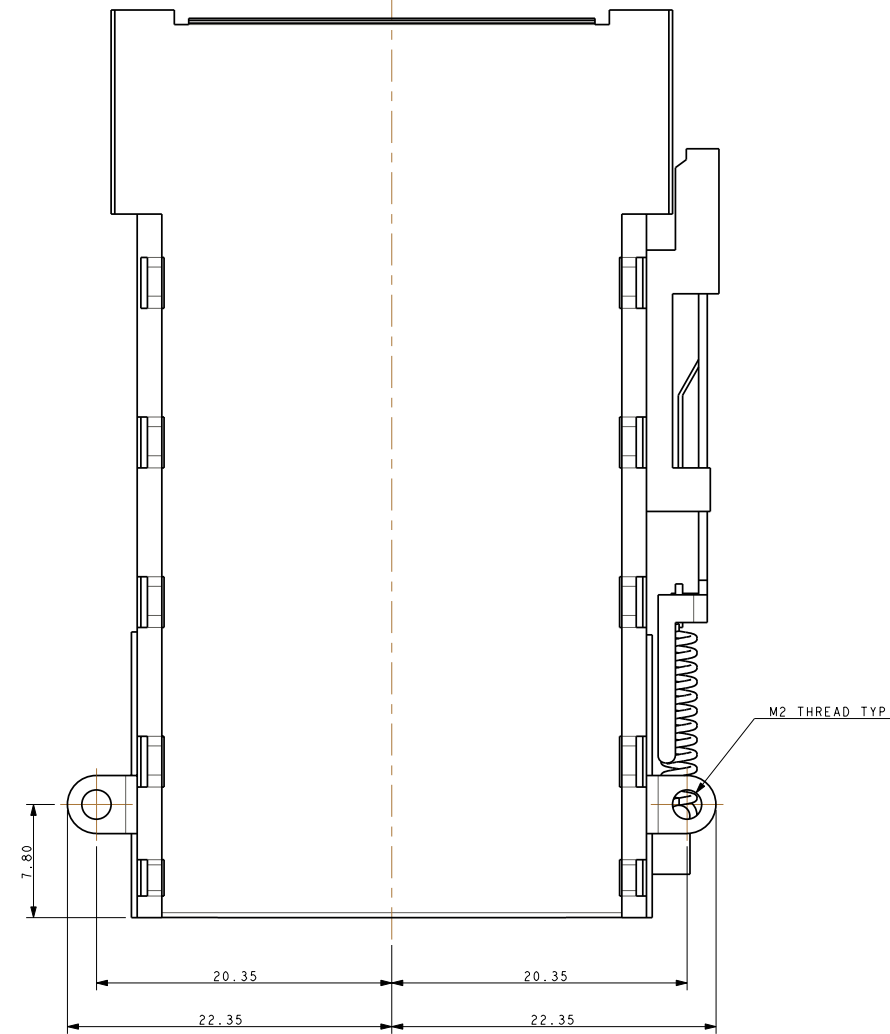
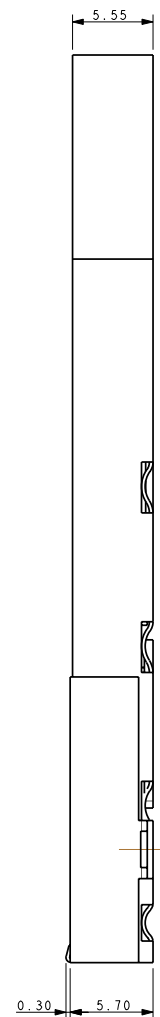
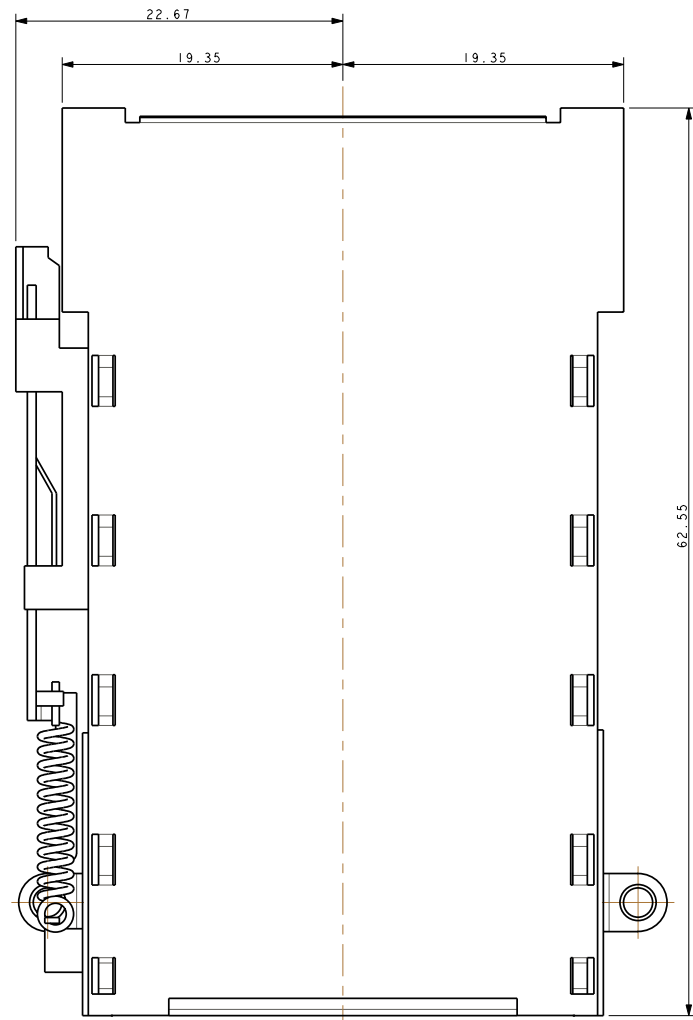
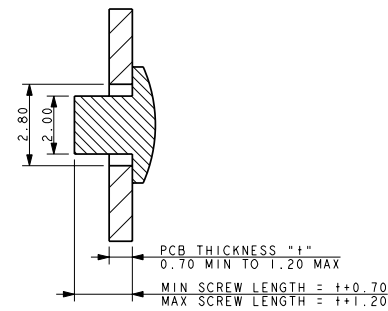

FORM-106-01-056-4 ISS-7
 RELEASE No
 HISTORY
 102402

ELCO EUROPE (A DIVISION OF AVX LTD.) CONFIDENTIAL PROPRIETARY THE DRAWING ON THIS PRINT AND INFORMATION THEREWITH ARE PROPRIETARY TO ELCO EUROPE (A DIVISION OF AVX LTD.) AND SHALL NOT BE USED OR DISCUSSED IN WHOLE OR IN PART WITHOUT ELCO EUROPE'S WRITTEN CONSENT.	3rd ANGLE ALL DIMENSIONS IN MILLIMETRES		Drawn N.C.H. Size DV	Description PCI EXPRESS - 54mm GUIDERAIL Part Number 11-9185-034-000-001S Issue A	DATE 19-JUL-05 SHEET 1 OF 2
--	---	--	-------------------------------	--	-----------------------------------

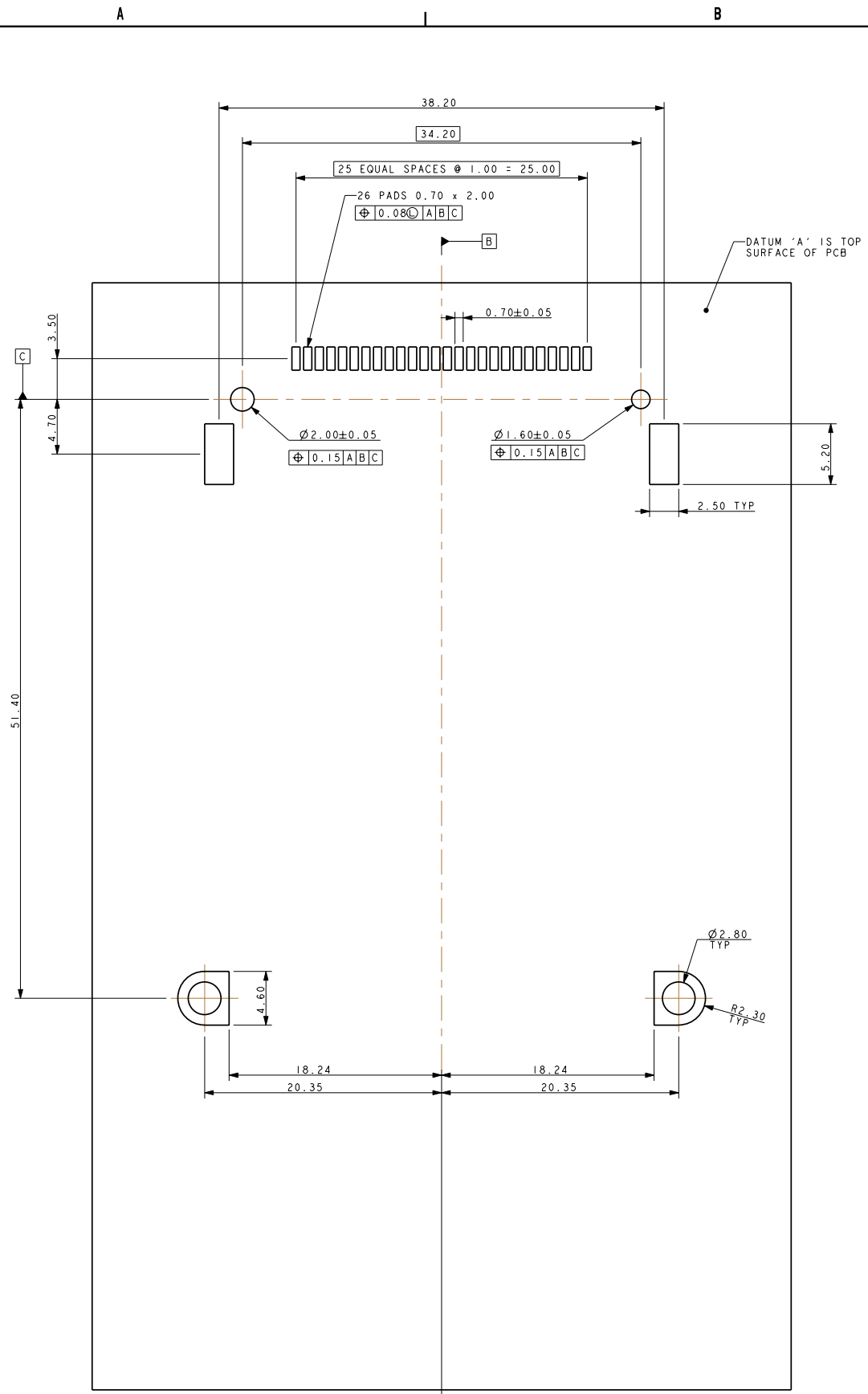

SUGGESTED PCB LAYOUT

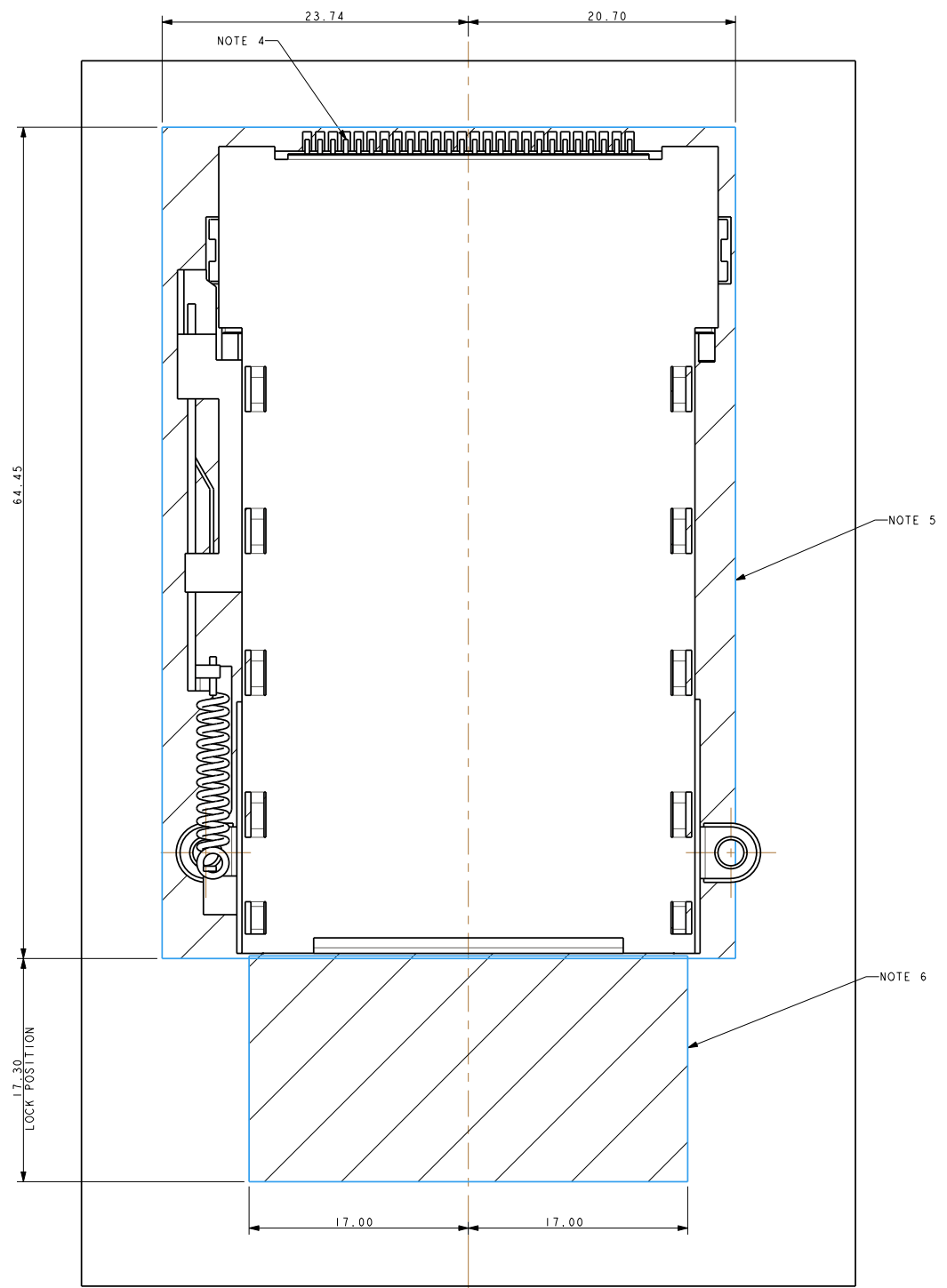

GUIDERAIL AND CONNECTOR MOUNTED ON A PCB

ELCO EUROPE (A DIVISION OF AVX LTD.) CONFIDENTIAL PROPRIETARY
THE DRAWING ON THIS PRINT AND INFORMATION THEREWITH ARE
PROPRIETARY TO ELCO EUROPE (A DIVISION OF AVX LTD.) AND
SHALL NOT BE USED OR DISCUSSED IN WHOLE OR IN PART
WITHOUT ELCO EUROPE'S WRITTEN CONSENT.



FORM-106-01-056-4 ISS-7
REV 1/17
102402

ELCO EUROPE (A DIVISION OF AVX LTD.) CONFIDENTIAL PROPRIETARY
THE DRAWING ON THIS PRINT AND INFORMATION THEREWITH ARE PROPRIETARY TO
ELCO EUROPE (A DIVISION OF AVX LTD.) AND SHALL NOT BE USED OR DISCUSSED
IN WHOLE OR IN PART WITHOUT ELCO EUROPE'S WRITTEN CONSENT.



Drawn
N.C.H.
Size
DV

Description
PCI EXPRESS - 54mm GUIDERAIL
Part Number
11-9185-034-000-001S

DATE
29-JUL-05
ISSUE
A

SHEET 2 OF 2